



Maryland
Department of
the Environment

Wes Moore, Governor
Aruna Miller, Lt. Governor

Serena McIlwain, Secretary
Suzanne E. Dorsey, Deputy Secretary

July 8, 2024

The Wharf at Handy's Point, Inc
c/o Robert (Buck) Nickerson
The Wharf at Handy's Point, Inc
23153 Green Point Rd
Worton, MD 21678

Re: Agency Interest Number: 109486
Tracking Number: 202361340
Tidal Authorization Number: 24-WQC-0017

Dear The Wharf at Handy's Point, Inc:

Your project did not qualify for approval under the Maryland State Programmatic General Permit (MDSPGP); therefore a separate review and issuance of the federal permit will be required by the U.S. Army Corps of Engineers. The federal permit is not attached.

Additionally, your project required a Wetlands License to be approved and issued by the Maryland Board of Public Works (BPW). The Wetlands License will be sent to you by BPW's Wetlands Administrator.

A project that does not qualify for approval under the MDSPGP requires an individual Water Quality Certification (WQC) to be issued by the Maryland Department of the Environment, which is attached. Please take a moment to read and review your WQC to ensure that you understand the limits of the authorized work and all of the general and special conditions.

You should not begin any work until you have obtained all necessary State, local, and federal authorizations. Please contact Matt Godbey at matt.godbey@maryland.gov or 410-901-4033 with any questions.

Sincerely,

Tammy Roberson

Tammy Roberson
Deputy Program Manager
Wetlands and Waterways Protection Program



STATE OF MARYLAND
DEPARTMENT OF THE ENVIRONMENT
WATER AND SCIENCE ADMINISTRATION
WATER QUALITY CERTIFICATION



24-WQC-0017

EFFECTIVE DATE: **July 8, 2024**
CERTIFICATION HOLDER: **The Wharf at Handy's Point, Inc**
ADDRESS: **23153 Green Point Road**
Worton, MD 21678
PROJECT LOCATION: **23153 Green Point Road**
Worton, MD 21678

UNDER AUTHORITY OF SECTION 401 OF THE FEDERAL WATER POLLUTION CONTROL ACT AND ITS AMENDMENTS AND IN ACCORDANCE WITH § 9-313 THROUGH § 9-323, INCLUSIVE, OF THE ENVIRONMENT ARTICLE, ANNOTATED CODE OF MARYLAND, THE MARYLAND DEPARTMENT OF THE ENVIRONMENT, WATER AND SCIENCE ADMINISTRATION HAS DETERMINED THAT THE REGULATED ACTIVITIES DESCRIBED IN THE REQUEST FOR CERTIFICATION FOR THE PROPOSED THE WHARF AT HANDY'S POINT, INC AND AS DESCRIBED IN THE ATTACHED PLAN SHEETS DATED MAY 13, 2024 AND ANY SUBSEQUENT MODIFICATIONS APPROVED BY THE DEPARTMENT WILL NOT VIOLATE MARYLAND'S WATER QUALITY STANDARDS, IF CONDUCTED IN ACCORDANCE WITH THE CONDITIONS OF THIS CERTIFICATION.

THIS CERTIFICATION DOES NOT RELIEVE THE APPLICANT OF RESPONSIBILITY FOR OBTAINING ANY OTHER APPROVALS, LICENSES, OR PERMITS IN ACCORDANCE WITH FEDERAL, STATE, OR LOCAL REQUIREMENTS AND DOES NOT AUTHORIZE COMMENCEMENT OF THE PROPOSED PROJECT. A COPY OF THIS REQUIRED CERTIFICATION HAS BEEN SENT TO THE CORPS OF ENGINEERS. THE CERTIFICATION HOLDER SHALL COMPLY WITH THE CONDITIONS LISTED BELOW.

The Maryland Department of the Environment satisfied the statutory and regulatory public notice requirements by placing the WQC on Public Notice from June 15, 2024, to July 1, 2024, on Maryland Department of the Environment's Public Notice webpage.

PROJECT DESCRIPTION

1. Remove an existing pier and associated structures;
2. Replace a 70-foot long by 7-foot wide timber pier, install a 30-foot long by 5-foot wide metal gangway, and construct a 20-foot long by 8-foot wide floating platform;
3. Construct a 140-foot long by 8-foot wide main timber pier, three 50-foot long by 5-foot wide floating finger piers, three 40-foot long by 5-foot wide floating finger piers, a 98-foot long by 5-foot wide floating "T" shaped pier, and six mooring piles. All within a maximum of 192 feet channelward of the mean high water line.

4. Mechanically maintenance dredge a 26,146 square foot irregularly shaped area to a depth of -5.0 feet at mean low water and mechanically maintenance dredge a 6,630 square foot irregularly shaped area to a depth of -7.0 feet at mean low water. Approximately 1,449 cubic yards of dredged material will be deposited at an approved upland disposal site located on-site; and to provide for periodic maintenance dredging for six years.

GENERAL CONDITIONS

1. All water quality-related performance standards and conditions required by the Department in any state issued authorization for activities in tidal wetlands, nontidal wetlands, their 100-year floodplains, nontidal wetlands buffers, or nontidal wetland expanded buffers to ensure that any discharges will not result in a failure to comply with water quality standards in COMAR 26.08.02 or any other water quality requirements of state law or regulation shall be met.
2. This Certification does not obviate the need to obtain required authorizations or approvals from other State, federal or local agencies as required by law.
3. All additional authorizations or approvals, including self-certifying General Permits issued by the Department, shall be obtained and all conditions shall be completed in compliance with such authorizations.
4. The proposed project shall be constructed in accordance with the approved final plan by the Department, or, if Department approval is not required, the plan approved by the U.S. Army Corps of Engineers, and its approved revisions.
5. All fill and construction materials not used in the project shall be removed and disposed of in a manner which will prevent their entry into waters of this State.
6. This Certification does not authorize any injury to private property, any invasion of rights, or any infringement of federal, state, or local laws or regulations.
7. The Certification Holder shall allow authorized representatives of the Department access to the site of authorized activities during normal business hours to conduct inspections and evaluations of the operations and records necessary to assure compliance with this Certification.
8. No stockpiles of any material shall be placed in Waters of the U.S. or state or private tidal wetlands.
9. Temporary construction trailers or structures, staging areas and stockpiles shall not be located within tidal wetlands, nontidal wetlands, nontidal wetlands buffers, or the 100-year floodplain unless specifically included on the Approved Plan.
10. This Certification is valid for the project identified herein and the associated U.S. Army Corps of Engineers authorization NAB-2023-61340 (The Wharf at Handy's Point, Inc/Marina Expansion) until such time that it expires or is not administratively extended.

SPECIAL CONDITIONS

1. All Critical Area requirements shall be followed and all necessary authorizations from the Critical Area Commission (“Commission”) shall be obtained. This Certificate does not constitute authorization for disturbance in the 100-foot Critical Area Buffer. “Disturbance” in the Buffer means clearing, grading, construction activities, or removal of any size of tree or vegetation. Any anticipated Buffer disturbance requires prior written approval, before commencement of land disturbing activity, from local jurisdiction in the form of a Buffer Management Plan.
2. All work performed under this Water Quality Certificate shall be conducted by a marine contractor licensed by the Marine Contractors Licensing Board (MCLB) in accordance with Title 17 of the Environment Article of Annotated Code of Maryland. Licensing by MCLB shall occur prior to the beginning of construction activities. A list of licensed marine contractors may be obtained by contacting the MCLB at 410-537- 3249, by e-mail at MDE.MCLB@maryland.gov or by accessing the Maryland Department of the Environment, Environmental Boards webpage.
3. The issuance of this Certificate is not a validation or authorization by the Department for any of the existing structures depicted on the plan sheets on the subject property that is not part of the authorized work description, nor does it relieve the Certificate Holder of the obligation to resolve any existing noncompliant structures and activities within tidal wetlands.
4. The Certificate Holder shall remove an existing pier and associated structures prior to the commencement of the construction of a new pier.
5. The Certificate Holder shall install chocks, stoppers, bracing or similar devices to prevent the floating structure from resting on the bottom substrate during periods of low water.
6. The Certificate Holder shall transport all dredged material in watertight trucks or barges. No dredged material shall be discharged onto the roadways or into waters of the State.
7. The Certificate Holder shall dispose of dredged material only at the dredge disposal site approved by the tidal wetlands license. The Certificate Holder shall submit an application for modification of the tidal wetlands license to MDE for approval of any dredge disposal site not authorized within the license.
8. The Certificate Holder shall conduct subsequent maintenance dredging within the scope of this license in terms of authorized dredge area and authorized depths. The Certificate Holder shall:
 1. Dredge no more than 500 cubic yards of material at each maintenance dredging.
 2. Comply with all applicable conditions of this license.
 3. Submit a detailed dredged material disposal plan to be approved by the Water and Science Administration, Tidal Wetlands Division prior to the start of dredging.
 4. Notify and receive approval from the Water and Science Administration, Compliance Program a minimum of 10 days prior to the start of each maintenance dredging operation.
9. The Certificate Holder shall conduct maintenance dredging within the scope of this Certification in terms of authorized dredged area, volume of material and authorized depths.
10. The Certificate Holder shall stake the dredge area and receive approval from the Water and Science Administration’s, Compliance Division prior to the start of dredging.

11. The Certificate Holder shall conduct a post dredge bathymetric survey and forward to the Water and Science Administration, Tidal Wetlands Division within 45 days after the termination of any phase of dredging.
12. The Certificate Holder shall not perform any dredging from February 15th through June 15th of any year to protect spawning yellow perch.

STATEMENT OF NECESSITY & CITATIONS

1. Statement of Necessity for General Conditions 1, 2, 3, 4, and Special Conditions 1, 3: These conditions are necessary to ensure that water quality standards are met, and designated uses are maintained.

Citations: Federal and state laws which authorize this condition include but are not limited to: 33 U.S.C. § 1341(a), (b), & (d); 33 U.S.C. § 1251(b); 33 U.S.C. § 1370; Md. Ann. Code, Env. Article, Title 1, Subtitles 3 and 4; Md. Ann. Code, Env. Article, Title 5, Subtitles 5 and 9; Md. Ann. Code, Env. Article, Title 9, Subtitle 3; Md. Ann. Code, Env. Article, Title 16; COMAR 26.08; COMAR 26.08.02.10G(3); COMAR 26.23.02.06; COMAR 26.17.01; COMAR 26.23; COMAR 26.24

2. Statement of Necessity for General Conditions 5, 8, 9: Fill or construction material within or adjacent to regulated resources may cause discharges resulting in turbidity in excess of water quality standards and interfere with designated uses of growth and propagation of fish, other aquatic life, wildlife; and other designated uses; and fail to meet general water quality criteria that waters not be polluted by substances in amounts sufficient to be unsightly or create a nuisance.

Citation: 26.08.02.03B(1)-B(2); COMAR 26.23; COMAR 26.24; COMAR 26.17.04

3. Statement of Necessity for General Condition 6: This condition is necessary to clarify the scope of this certification to ensure compliance with water quality regulations, without limiting restrictions through other requirements.

Citation: Federal and state laws which authorize this condition include but are not limited to: 33 U.S.C. § 1341(a), (b), & (d); 33 U.S.C. § 1251(b); 33 U.S.C. § 1370; Md. Ann. Code, Env. Article, Title 1, Subtitles 3 and 4; Md. Ann. Code, Env. Article, Title 5, Subtitles 5 and 9; Md. Ann. Code, Env. Article, Title 9, Subtitle 3; Md. Ann. Code, Env. Article, Title 16; COMAR 26.08, COMAR 26.08.02.10E; COMAR 26.23.02.06; COMAR 26.17.04; COMAR 26.23; COMAR 26.24

4. Statement of Necessity for General Condition 7: Conditions of certification involve precise actions to comply with water quality standards. Site inspection may be necessary to ensure that limits, methods, and other requirements are met to ensure that water quality standards are met and designated uses are maintained. These conditions are necessary to ensure that the activity was conducted, and project completed according to terms of the authorization/certification, while allowing for review of in-field modifications which may have resulted in discharges to ensure that water quality standards were met. Designated uses include support of estuarine and marine aquatic life and shellfish harvesting and for growth and propagation of fish, other aquatic life, and wildlife

Citation: Federal and state laws that authorize this condition include but are not limited to: 33 U.S.C. § 1341(a), (b), & (d); 33 U.S.C. § 1251(b); 33 U.S.C. § 1370; Md. Ann. Code, Env. Article, Title 1, Subtitles 3 and 4; Md. Ann. Code, Env. Article, Title 5, Subtitles 5 and 9; Md. Ann. Code, Env. Article, Title 9, Subtitle 3; Md. Ann. Code, Env. Article, Title 16; COMAR 26.08; COMAR 26.08.02.03B(1)(b); COMAR 26.08.02.03B(2); COMAR 26.23.02.06; COMAR 26.23; COMAR 26.24; COMAR 26.17.04

5. Statement of Necessity for General Condition 10: This condition is necessary to qualify the period of applicability of the terms and conditions of this Certification to be protective of Maryland water quality standards.

Citations: Federal and state laws which authorize this condition include but are not limited to: 33 U.S.C. § 1341(a), (b), & (d); 33 U.S.C. § 1251(b); 33 U.S.C. § 1370; 40 C.F.R. 121, 15 C.F.R. 930, Md. Ann. Code, Env. Article, Title 1, Subtitles 3 and 4; Md. Ann. Code, Env. Article, Title 5, Subtitles 5 and 9; Md. Ann. Code, Env. Article, Title 9, Subtitle 3; Md. Ann. Code, Env. Article, Title 16; COMAR 26.08; COMAR 26.17.04; COMAR 26.23; COMAR 26.24

6. Statement of Necessity for Special Condition 2: Expertise for conducting certain activities is required to ensure that there is no violation of water quality standards nor interference with designated uses. This condition is necessary to ensure that discharges will be conducted in a manner which does not violate water quality criteria nor interfere with designated uses.

Citation: COMAR 26.08.02.02B(2)- B(4); COMAR 26.08 02.03B(2)(d) – (e); COMAR 26.08.02.03B(1)(b); 26.08.02.03B(2); COMAR 23.02.04.04

7. Statement of Necessity for Special Condition 4: The Certificate Holder shall remove an existing pier and associated structures prior to the commencement of the construction of a new pier.

Citation: COMAR 26.08.02.02B(1)(d); COMAR 26.08.02.02B(3); COMAR 26.08.02.03B COMAR 26.08.02.01B(1) and B(2) COMAR 26.08.02.03B(1)(a); COMAR 26.08.02.03B(2)(d)

8. Statement of Necessity for Special Condition 5: The Certificate Holder shall install chocks, stoppers, bracing or similar devices to prevent the floating structure from resting on the bottom substrate during periods of low water.

Citation: COMAR 26.08.02.02B(1)(d); COMAR 26.08.02.02B(3); COMAR 26.08.02.03B COMAR 26.08.02.01B(1) and B(2) COMAR 26.08.02.03B(1)(a); COMAR 26.08.02.03B(2)(d)

9. Statement of Necessity for Special Conditions 6, 7, 8 Unauthorized discharges may enter regulated waters as result of activity or structural failure. A plan to address inadvertent discharges will prevent or address further violations of water quality standards and failure of water to meet designated uses, including uses of growth and propagation of fish, other aquatic life, wildlife; and other designated uses; and fail to meet general water quality criteria that waters not be polluted by substances in amounts sufficient to be unsightly or create a nuisance.

Citation COMAR 26.08.02.02B(1)d; COMAR 26.08.02.02B(3); COMAR 26.08.02.03B(1) and B(2); 26.08.02.01B(2); 26.08.02.02B(1)

10. Statement of Necessity for Special Condition 9: The limits on the scope of maintenance dredging are necessary to ensure that no discharges would violate water quality standards and designated uses for water clarify, turbidity, growth and propagation of fish, other aquatic life, and wildlife; and water contact recreation

Citations: COMAR 26.08.02.02B(1)(d); COMAR 26.08.02.02B(3); COMAR 26.08.02.03B

11. Statement of Necessity for Special Conditions 10: The condition is necessary to ensure that no dredged material will result in a violation of water quality standards for turbidity and interfere with designated uses.

Citations: Federal and state laws which authorize this condition include but are not limited to: 33 U.S.C. § 1341(a), (b), & (d); 33 U.S.C. § 1251(b); 33 U.S.C. § 1370; Md. Ann. Code, Env. Article, Title 1, Subtitles 3 and 4; Md. Ann. Code, Md. Ann. Code, Env. Article, Title 9, Subtitle 3; Md. Ann. Code, Env. Article, Title 16; COMAR 26.08; COMAR 26.08.02.10G(3); COMAR 26.24; COMAR 26.08.02.03B(1)(b); COMAR 26.08.02.03B(2)

12. Statement of Necessity for Special Condition 11: The condition is necessary to ensure that the dredging results in water depths which are appropriate to support designated uses of fishing and water contact recreation and propagation of fish, other aquatic life and wildlife; and ensure that no discharges are unsightly, create a nuisance, change to an objectionable color or interferes with designated uses.

Citations: COMAR 26.08.02.01B(2); COMAR 26.08.02.02B(1); 26.08.02.02B(3); COMAR 26.08.02.03B

13. Statement of Necessity for Special Condition 12: A time of year restriction is necessary to maintain the designated use for support of estuarine and marine aquatic life.

Citation: Federal and state laws which authorize this condition include but are not limited to: COMAR: 26.08.02.02B(1)(d); 26.08.02.02B(3); COMAR 26.08.02.02-16.

CERTIFICATION APPROVED

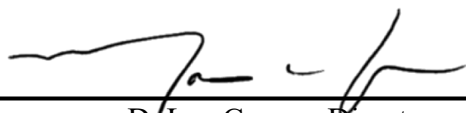

D. Lee Currey, Director
Water and Science Administration

7/11/2024

Date

Tracking Number: 202361340
Agency Interest Number: 109486

Effective Date: **July 8, 2024**

Enclosure: Plan Sheets dated **May 13, 2024**

cc: WSA Inspection & Compliance Program
Army Corps of Engineers

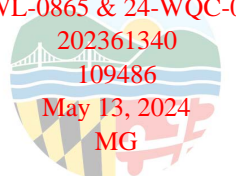

VICINITY MAP
 OF THE LANDS OF
THE WHARF AT HANDYS POINT, INC.
 THIRD ELECTION DISTRICT, KENT COUNTY
 MARYLAND
 MAP 19 PARCEL 102

EXTREME MEASURES
 LAND SURVEYORS
 Chestertown, MD 21620 PHONE 410-778-0147
 www.extrememeasuresllc.com

SCALE
 NTS
 DRAWN BY
 WJE
 JOB NO.
 1221-B

23-WL-0865 & 24-WQC-0017

202361340

109486

May 13, 2024

MG



WORTON CREEK
FLOOD
EBB

GREEN POINT
PUBLIC
LANDING

GREEN POINT ROAD

EXISTING
PIERS & MARSH
WALKWAY

EXISTING
2 1/2 STORY
OFFICE
BUILDING

EXISTING
POLE BARN

EXISTING
1 STORY
BATH
HOUSE

APPROXIMATE
EDGE OF
MARSH

APPROXIMATE
MEAN HIGH
WATER LINE

p.102
LANDS OF
THE WHARF at HANDY'S POINT, Inc
S.L.K. 1310/19
PLAT BOOK: S.L.K. 6/117

p.15
LANDS OF
GREEN POINT FARMS, L.L.C.
M.L.M. 109/582
PLAT BOOK: E.H.P. 2/161

PROPERTY LINE

APPROXIMATE
MEAN HIGH WATER LINE

NOTES:

DEED REFERENCE: S.L.K. 1310/19
PREMISES ADDRESS: 23153 GREEN POINT RD
WORTON, MD. 21678

LATITUDE: 39°16'53" N
LONGITUDE: 76°10'11" W

APPROXIMATE WIDTH OF WATERWAY: 400'±
APPROXIMATE DISTANCE TO CHANNEL: 87'±

MILL CREEK

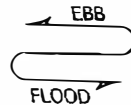

70 EXISTING BOAT SLIPS TOTAL
70 PROPOSED BOAT SLIPS TOTAL



OVERALL SITE PLAN
OF THE LANDS OF
THE WHARF AT HANDYS POINT, INC.
THIRD ELECTION DISTRICT, KENT COUNTY
MARYLAND
MAP 19 PARCEL 102

EXTREME MEASURES
LAND SURVEYORS
Chestertown, MD 21620 PHONE 410-778-0147
www.extrememeasuresllc.com

SCALE 1"=300'
DRAWN BY WJE
DATE 5/13/24
JOB NO. 1221F

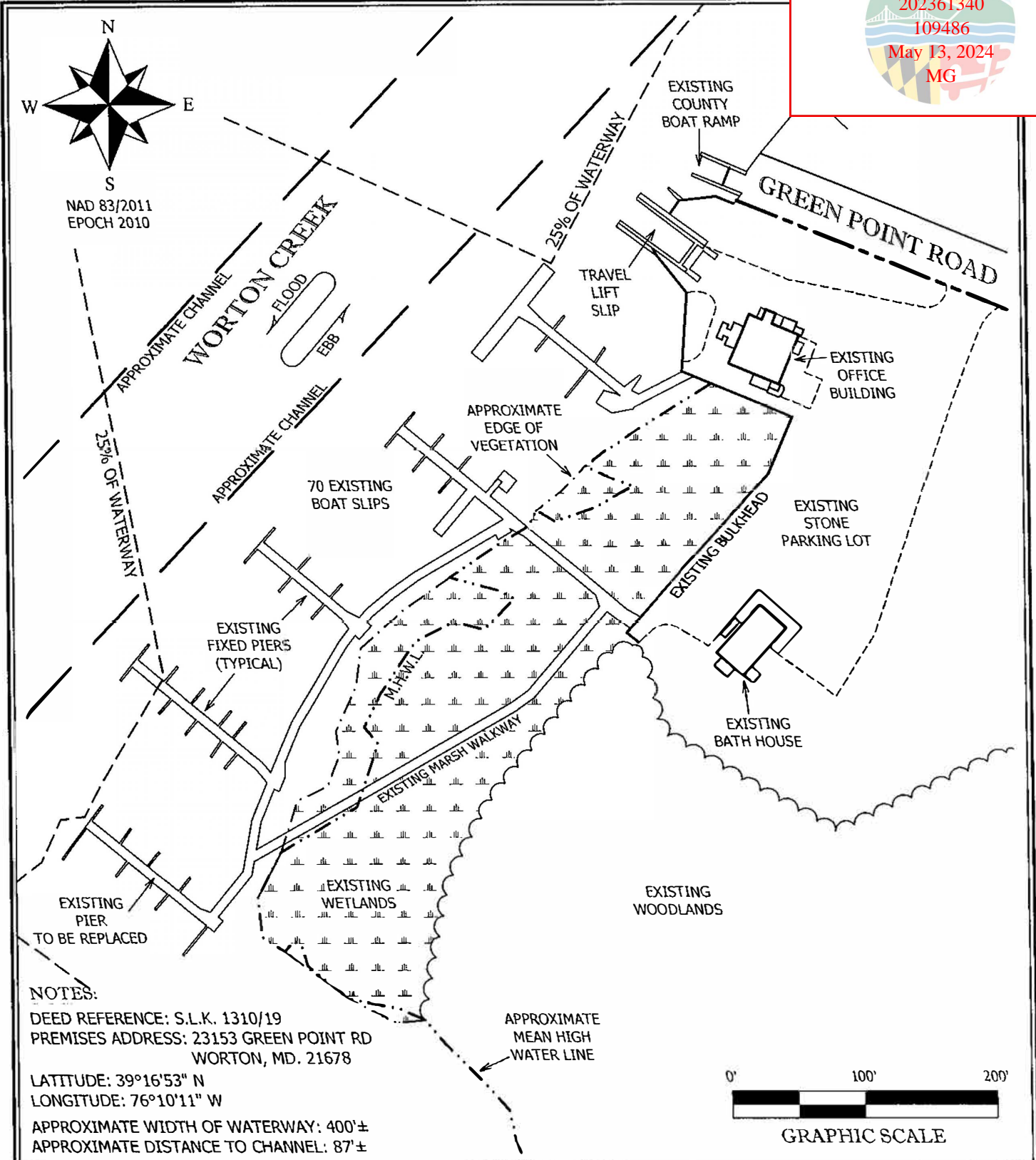
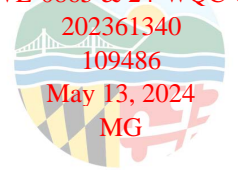

NOTES:

DEED REFERENCE: S.L.K. 1310/19
 PREMISES ADDRESS: 23153 GREEN POINT RD
 WORTON, MD. 21678
 LATITUDE: 39°16'53" N
 LONGITUDE: 76°10'11" W
 APPROXIMATE WIDTH OF WATERWAY: 400'±
 APPROXIMATE DISTANCE TO CHANNEL: 87'±

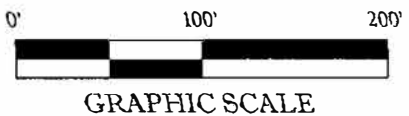

EXISTING CONDITIONS
OF THE LANDS OF
THE WHARF AT HANDYS POINT, INC.
THIRD ELECTION DISTRICT, KENT COUNTY
MARYLAND
MAP 19 PARCEL 102

EXTREME MEASURES
 LAND SURVEYORS
 Chestertown, MD 21620 PHONE 410-778-0147
 www.extrememeasuresllc.com

SCALE	1"=100'
DRAWN BY	WJE
DATE	5/13/24
JOB NO.	1221F

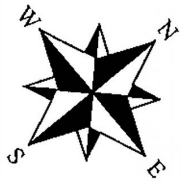

NAD 83/2011

23-WL-0865 & 24-WQC-0017
 202361340
 109486
 May 13, 2024
 MG

WORTON CREEK

WATER DEPTHS
 SHOWN HEREDN
 BASED ON M.L.W. = 0.0'

EXISTING
 PILING
 (TYPICAL)

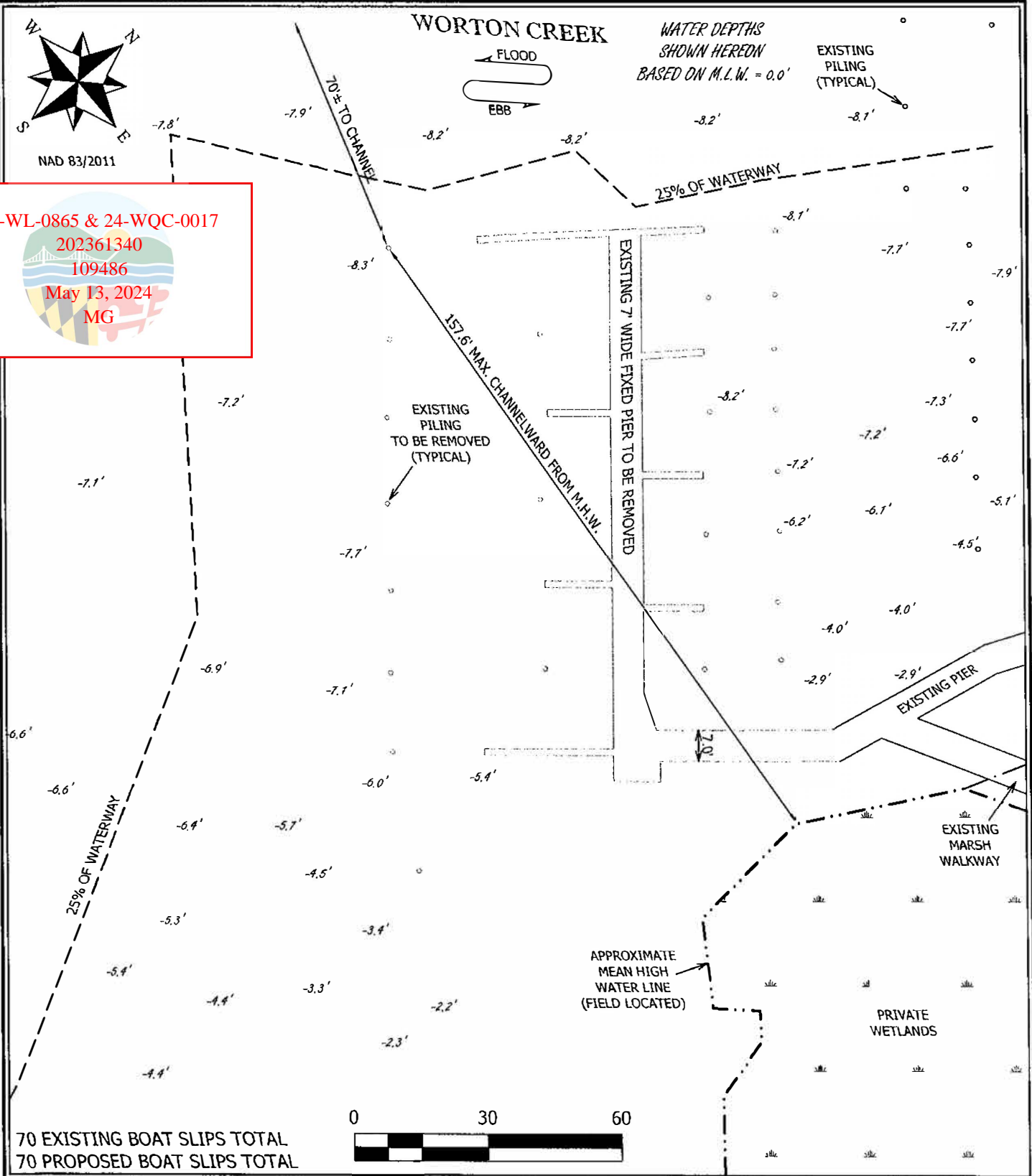
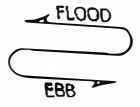

70 EXISTING BOAT SLIPS TOTAL
 70 PROPOSED BOAT SLIPS TOTAL

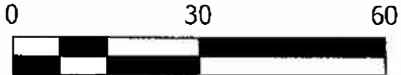

EXISTING CONDITIONS
OF THE LANDS OF
THE WHARF AT HANDYS POINT, INC.
THIRD ELECTION DISTRICT, KENT COUNTY
MARYLAND
MAP 19 PARCEL 102

EXTREME MEASURES
 LAND SURVEYORS
 Chestertown, MD 21620 PHONE 410-778-0147
 www.extrememeasuresllc.com

SCALE 1" = 30'
DRAWN BY RAN
DATE 5/13/24
JOB NO. 1221F

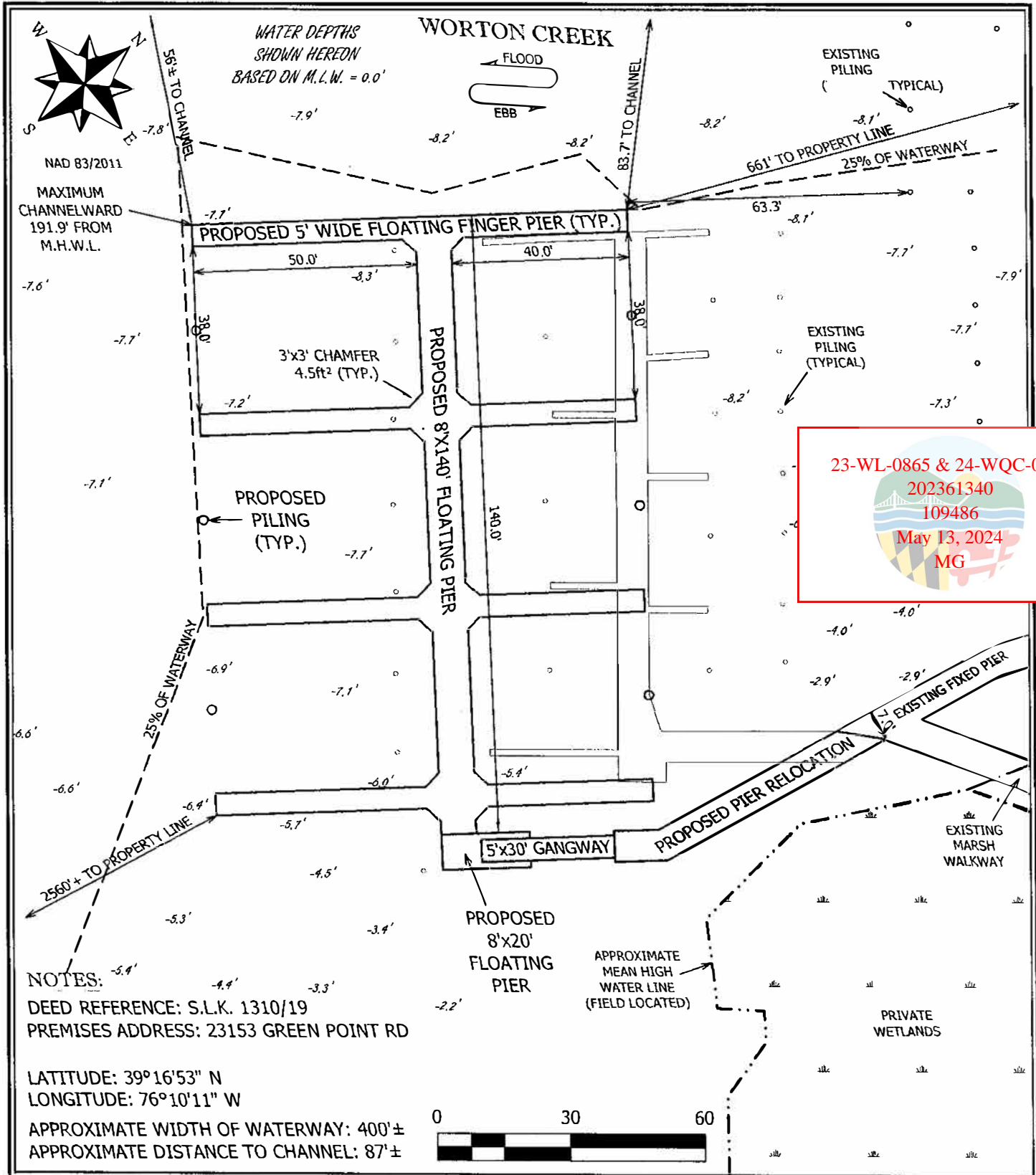

23-WL-0865 & 24-WQC-0017
202361340
109486
May 13, 2024
MG

PROPOSED CONDITIONS
OF THE LANDS OF
THE WHARF AT HANDYS POINT, INC.
THIRD ELECTION DISTRICT, KENT COUNTY
MARYLAND
MAP 19 PARCEL 102

EXTREME MEASURES
LAND SURVEYORS
Chestertown, MD 21620 PHONE 410-778-0147
www.extrememeasuresllc.com

SCALE
1"=30'
DRAWN BY
RAN
DATE
5/13/24
JOB NO.
1221F

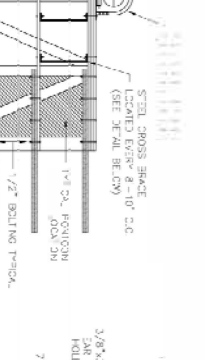
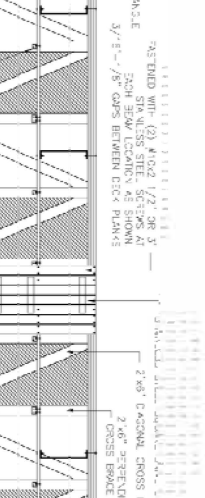
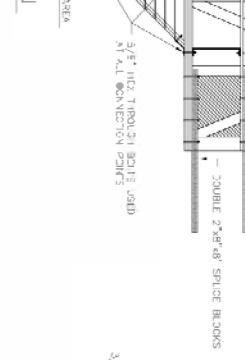
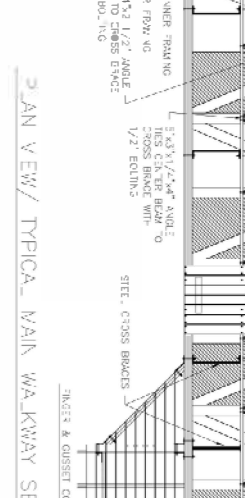
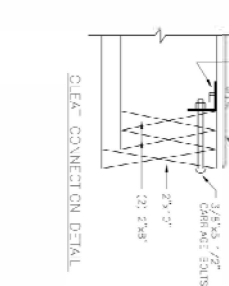
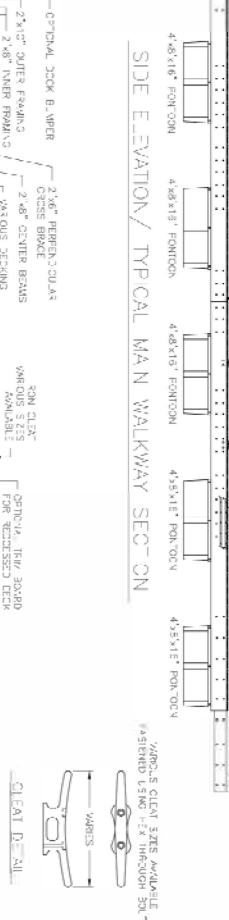
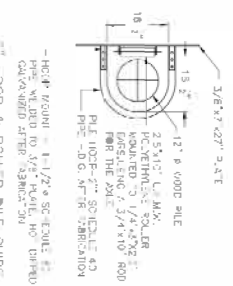
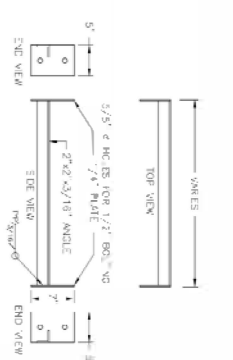
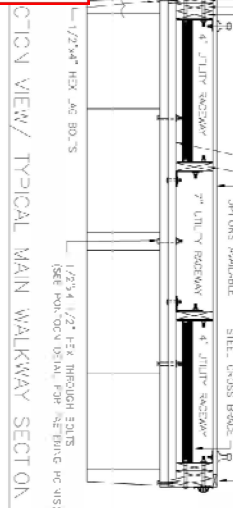
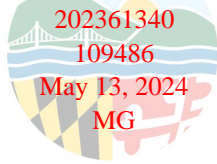

NO.	REVISION	BY	DATE

SCALE: 1/8" = 1'-0"

DATE: 11/13/24

DRAWN BY: W.N.S.

APPROVED BY: [Signature]

PROJECT: #

GENERAL NOTES:

- ALL DIMENSIONS UNLESS OTHERWISE SPECIFIED.
- ALL DIMENSIONS SHALL BE TO CENTER UNLESS OTHERWISE SPECIFIED.
- ALL DIMENSIONS SHALL BE TO FACE UNLESS OTHERWISE SPECIFIED.
- ALL DIMENSIONS SHALL BE TO CENTER UNLESS OTHERWISE SPECIFIED.
- ALL DIMENSIONS SHALL BE TO FACE UNLESS OTHERWISE SPECIFIED.
- ALL DIMENSIONS SHALL BE TO CENTER UNLESS OTHERWISE SPECIFIED.
- ALL DIMENSIONS SHALL BE TO FACE UNLESS OTHERWISE SPECIFIED.
- ALL DIMENSIONS SHALL BE TO CENTER UNLESS OTHERWISE SPECIFIED.
- ALL DIMENSIONS SHALL BE TO FACE UNLESS OTHERWISE SPECIFIED.
- ALL DIMENSIONS SHALL BE TO CENTER UNLESS OTHERWISE SPECIFIED.
- ALL DIMENSIONS SHALL BE TO FACE UNLESS OTHERWISE SPECIFIED.
- ALL DIMENSIONS SHALL BE TO CENTER UNLESS OTHERWISE SPECIFIED.
- ALL DIMENSIONS SHALL BE TO FACE UNLESS OTHERWISE SPECIFIED.
- ALL DIMENSIONS SHALL BE TO CENTER UNLESS OTHERWISE SPECIFIED.
- ALL DIMENSIONS SHALL BE TO FACE UNLESS OTHERWISE SPECIFIED.

PROJECT: THE MARINA COMPANY

PROJECT TITLE: TYPICAL MAIN WALKWAY SECTION & DETAILS

PROJECT ADDRESS: 2000 N. W. 11th Ave., Miami, FL 33136

PROJECT PHONE: (305) 555-1234

PROJECT WEBSITE: WWW.MARINACOMPANY.COM

EXTREME MEASURES LAND SURVEYORS

Chestertown, MD 21620

PHONE 410-778-0147

www.extrememeasuresllc.com

MAIN PIER DETAIL
 OF THE LANDS OF
THE WHARF AT HANDY'S POINT Inc.
 THIRD ELECTION DISTRICT, KENT COUNTY,
 MARYLAND
 TAX MAP 19, PARCEL 102

SCALE: NTS

DRAWN BY: RAN

JOB NO.: 1221F

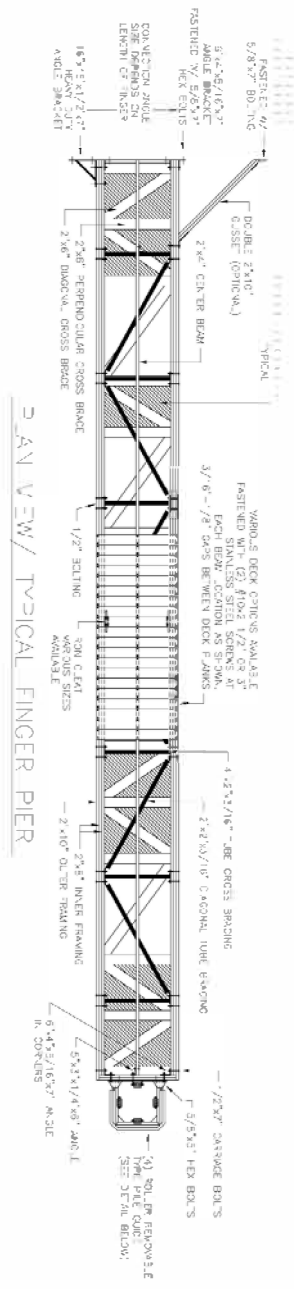

GENERAL NOTES:
 1. ALL STEEL SHALL BE A36 UNLESS OTHERWISE SPECIFIED.
 2. ALL WELDS SHALL BE E70XX UNLESS OTHERWISE SPECIFIED.
 3. ALL DIMENSIONS SHALL BE IN FEET AND INCHES.
 4. ALL DIMENSIONS SHALL BE TO FACE UNLESS OTHERWISE SPECIFIED.
 5. ALL DIMENSIONS SHALL BE TO CENTER UNLESS OTHERWISE SPECIFIED.
 6. ALL DIMENSIONS SHALL BE TO SURFACE UNLESS OTHERWISE SPECIFIED.
 7. ALL DIMENSIONS SHALL BE TO CENTERLINE UNLESS OTHERWISE SPECIFIED.
 8. ALL DIMENSIONS SHALL BE TO CENTERLINE UNLESS OTHERWISE SPECIFIED.
 9. ALL DIMENSIONS SHALL BE TO CENTERLINE UNLESS OTHERWISE SPECIFIED.
 10. ALL DIMENSIONS SHALL BE TO CENTERLINE UNLESS OTHERWISE SPECIFIED.

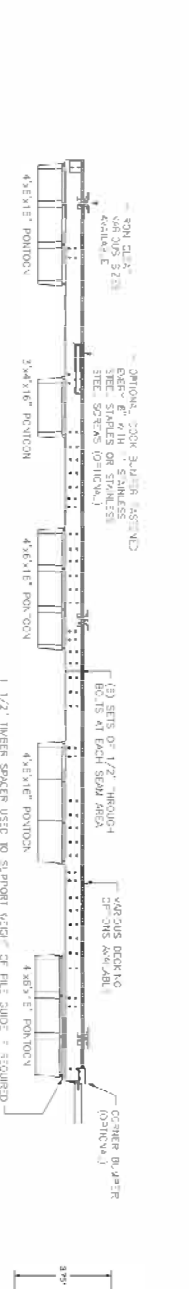

GENERAL NOTES:
 1. ALL STEEL SHALL BE A36 UNLESS OTHERWISE SPECIFIED.
 2. ALL WELDS SHALL BE E70XX UNLESS OTHERWISE SPECIFIED.
 3. ALL DIMENSIONS SHALL BE IN FEET AND INCHES.
 4. ALL DIMENSIONS SHALL BE TO FACE UNLESS OTHERWISE SPECIFIED.
 5. ALL DIMENSIONS SHALL BE TO CENTER UNLESS OTHERWISE SPECIFIED.
 6. ALL DIMENSIONS SHALL BE TO SURFACE UNLESS OTHERWISE SPECIFIED.
 7. ALL DIMENSIONS SHALL BE TO CENTERLINE UNLESS OTHERWISE SPECIFIED.
 8. ALL DIMENSIONS SHALL BE TO CENTERLINE UNLESS OTHERWISE SPECIFIED.
 9. ALL DIMENSIONS SHALL BE TO CENTERLINE UNLESS OTHERWISE SPECIFIED.
 10. ALL DIMENSIONS SHALL BE TO CENTERLINE UNLESS OTHERWISE SPECIFIED.

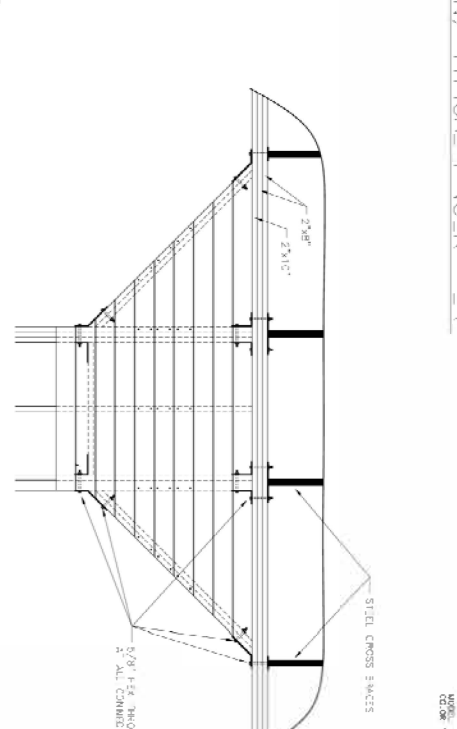
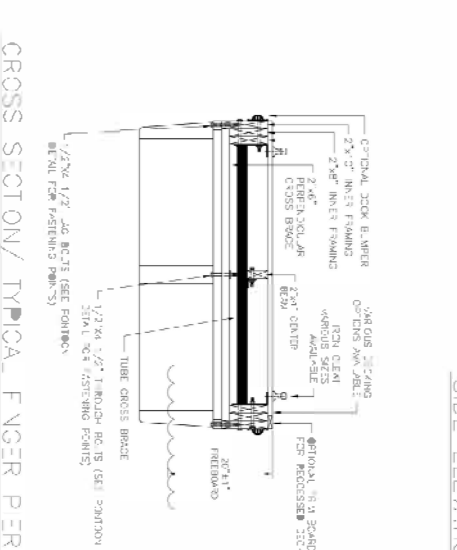

THE MARINA COMPANY	
PROJECT:	FINGER PIER & DETAILS
DRAWING TITLE:	TYPICAL FINGER PIER & DETAILS
DATE:	05/13/2024
SCALE:	AS SHOWN
BY:	WMS
CHECKED BY:	WMS
APPROVED BY:	WMS
PROJECT #:	SDF

FLOATING PIER DETAIL
 OF THE LANDS OF
THE WHARF at HANDY'S POINT Inc.
 THIRD ELECTION DISTRICT, KENT COUNTY,
 MARYLAND
 TAX MAP 19, PARCEL 102

EXTREME MEASUREMENTS
 LAND SURVEYORS
 Chestertown, MD 21620
 www.extrememeasuresllc

23-WL-0865 & 24-WQC-0017
 202361340
 109486
 May 13, 2024
 MG

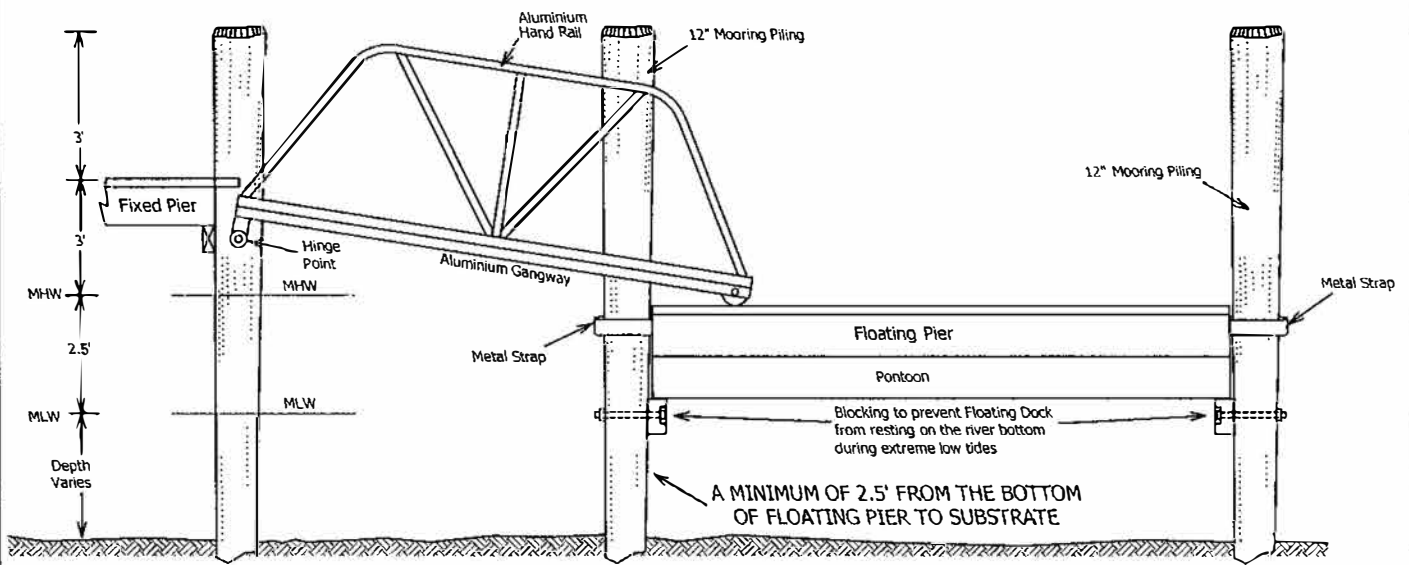

TYPICAL DETAIL FOR GANGWAYS

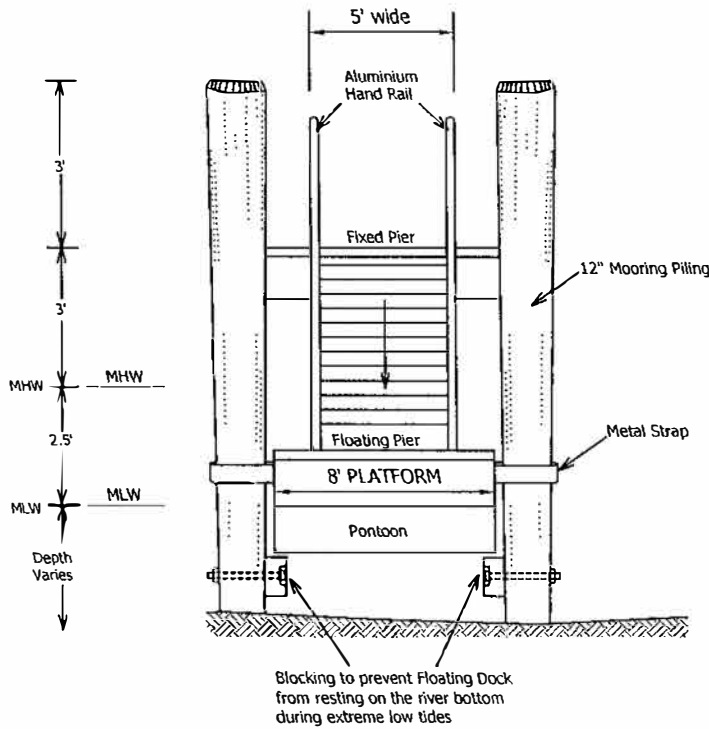

23-WL-0865 & 24-WQC-0017

202361340

109486

May 13, 2024

MG

GANGWAY DETAIL
 OF THE LANDS OF
THE WHARF at HANDY'S POINT Inc.
 THIRD ELECTION DISTRICT, KENT COUNTY,
 MARYLAND
 TAX MAP 19, PARCEL 102

EXTREME
MEASURES
 LAND SURVEYORS
 Chestertown, MD 21620 PHONE 410-778-0147
 www.extrememeasuresllc.com

SCALE
 NTS
 DRAWN BY
 RAN
 DATE
 5/13/24
 JOB NO.
 1221F

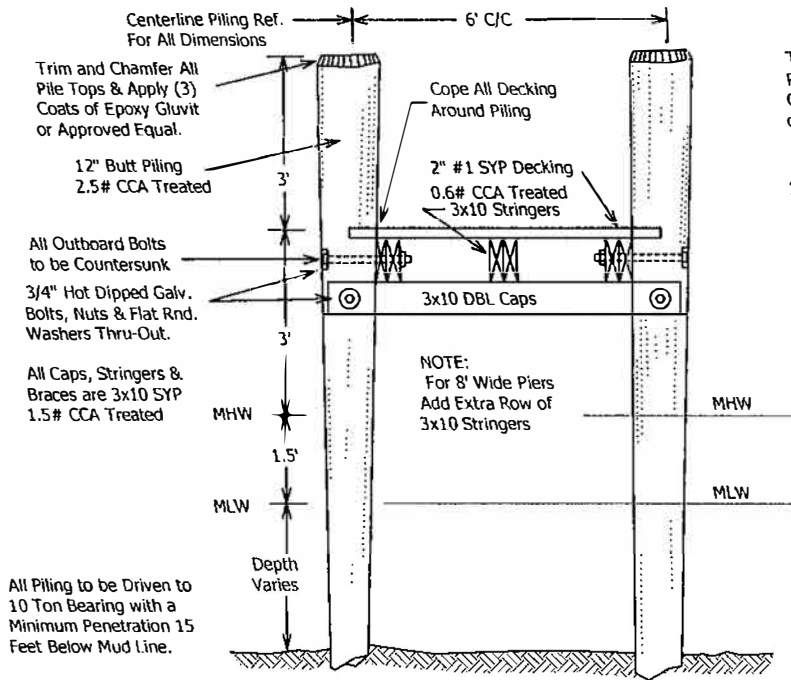

TYPICAL PIER DETAIL
(Not to Scale)

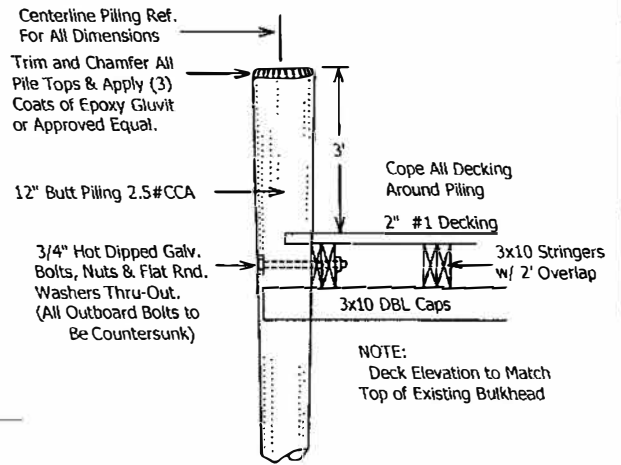

TYPICAL DETAIL
(Not to Scale)

23-WL-0865 & 24-WQC-0017
202361340
109486
May 13, 2024
MG

PIER DETAIL
OF THE LANDS OF
THE WHARF at HANDY'S POINT Inc.
THIRD ELECTION DISTRICT, KENT COUNTY,
MARYLAND
TAX MAP 19, PARCEL 102

EXTREME MEASURES
LAND SURVEYORS

Chestertown, MD 21620 PHONE 410 778-0147
www.extrememeasuresllc.com

SCALE NTS
DRAWN BY RAN
DATE 5/13/24
JOB NO. 1221F

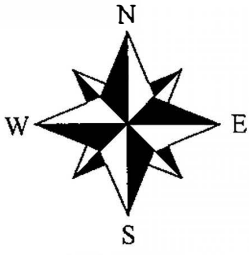

NAD 83/2011
EPOCH 2010

WATER DEPTHS SHOWN
HEREON ARE BASED
ON M.L.W. = 0.0'

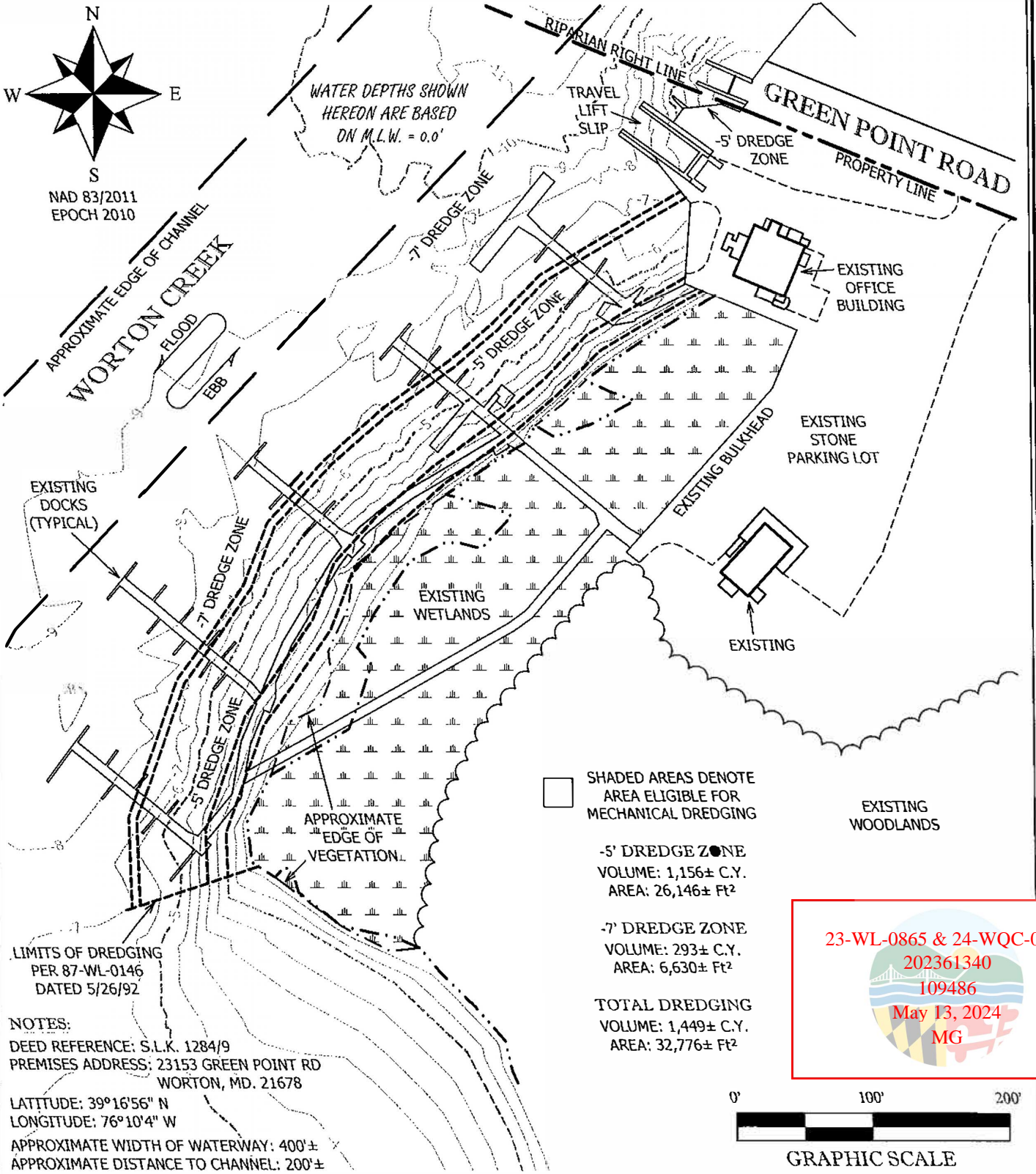

23-WL-0865 & 24-WQC-0017
202361340
109486
May 13, 2024
MG

PROPOSED CONDITIONS
OF THE LANDS OF
THE WHARF AT HANDYS POINT, INC.
THIRD ELECTION DISTRICT, KENT COUNTY
MARYLAND
MAP 19 PARCEL 102

EXTREME MEASURES
LAND SURVEYORS

Chestertown, MD 21620 PHONE 410-778-0147
www.extrememeasuresllc.com

SCALE 1"=100'
DRAWN BY WJE
DATE 5/13/24
JOB NO. 1221-B

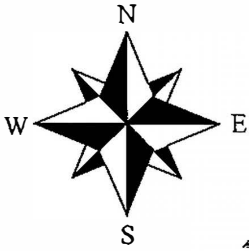

NAD 83/2011
EPOCH 2010

WORTON CREEK
FLOOD
EBB

EXISTING DOCKS (TYPICAL)
WATER DEPTHS SHOWN
HEREON ARE BASED
ON M.L.W. = 0.0'

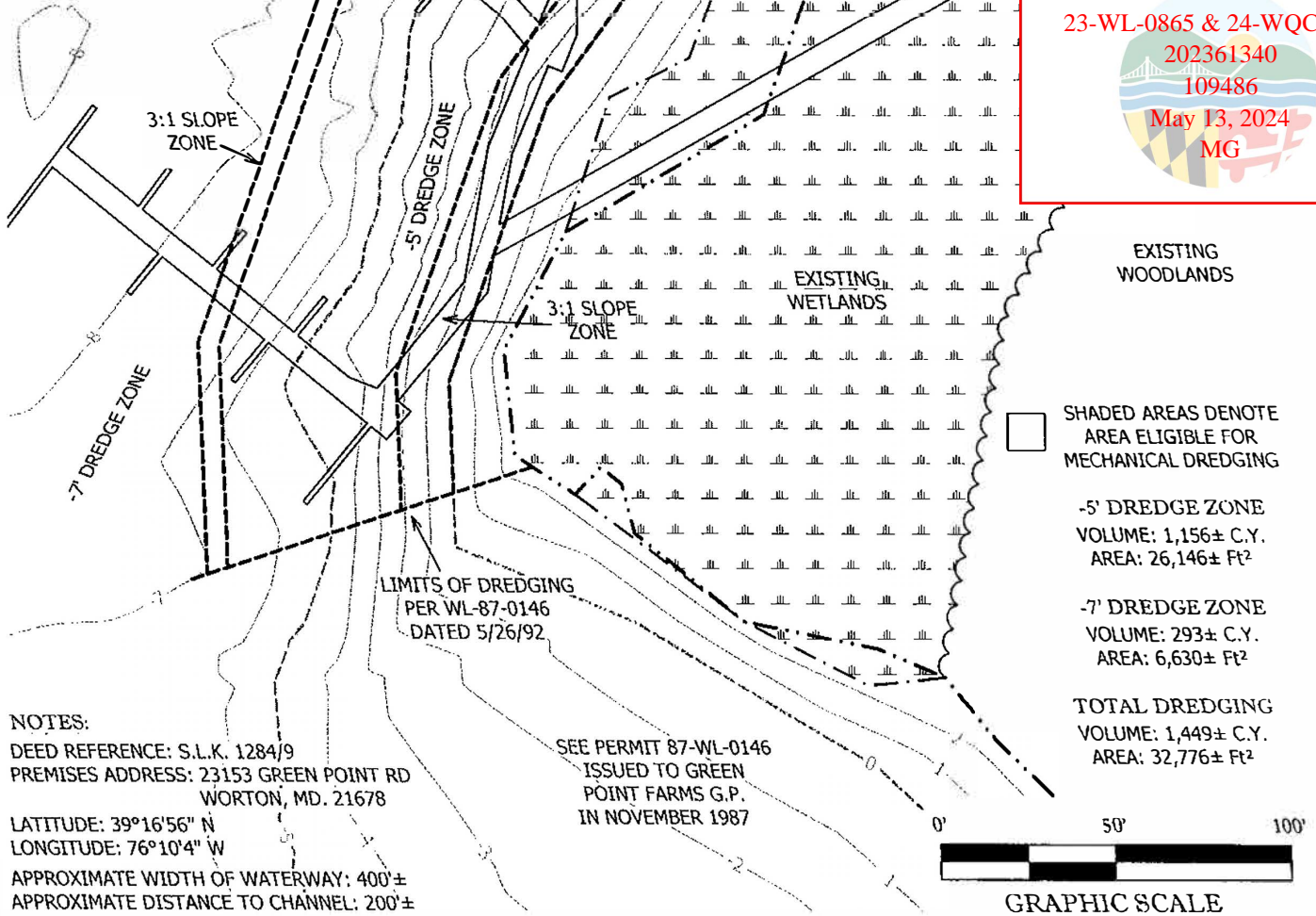

23-WL-0865 & 24-WQC-0017
202361340
109486
May 13, 2024
MG

EXISTING WOODLANDS

SHADED AREAS DENOTE
AREA ELIGIBLE FOR
MECHANICAL DREDGING

-5' DREDGE ZONE
VOLUME: 1,156± C.Y.
AREA: 26,146± Ft²

-7' DREDGE ZONE
VOLUME: 293± C.Y.
AREA: 6,630± Ft²

TOTAL DREDGING
VOLUME: 1,449± C.Y.
AREA: 32,776± Ft²

NOTES:
DEED REFERENCE: S.L.K. 1284/9
PREMISES ADDRESS: 23153 GREEN POINT RD
WORTON, MD. 21678
LATITUDE: 39°16'56" N
LONGITUDE: 76°10'4" W
APPROXIMATE WIDTH OF WATERWAY: 400'±
APPROXIMATE DISTANCE TO CHANNEL: 200'±

SEE PERMIT 87-WL-0146
ISSUED TO GREEN
POINT FARMS G.P.
IN NOVEMBER 1987

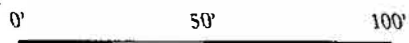

GRAPHIC SCALE

PROPOSED CONDITIONS
OF THE LANDS OF
THE WHARF AT HANDYS POINT, INC.
THIRD ELECTION DISTRICT, KENT COUNTY
MARYLAND
MAP 19 PARCEL 102

EXTREME MEASURES
LAND SURVEYORS
Chestertown, MD 21620 PHONE 410-778-0147
www.extrememeasuresllc.com

SCALE 1"=50'
DRAWN BY WJE
DATE 5/13/24
JOB NO. 1221-B

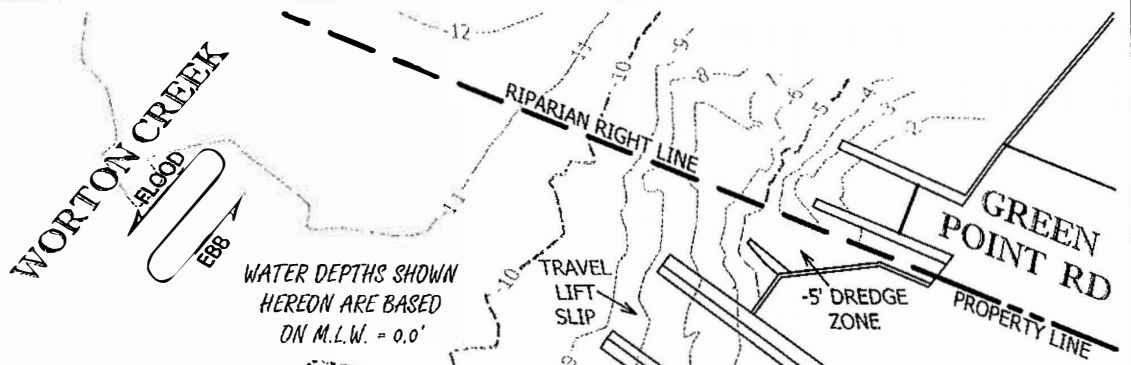

NOTES:
DEED REFERENCE: S.L.K. 1284/9
PREMISES ADDRESS: 23153 GREEN POINT RD
WORTON, MD. 21678
LATITUDE: 39°16'56" N
LONGITUDE: 76°10'4" W
APPROXIMATE WIDTH OF WATERWAY: 400'±
APPROXIMATE DISTANCE TO CHANNEL: 200'±

WATER DEPTHS SHOWN
HEREON ARE BASED
ON M.L.W. = 0.0'

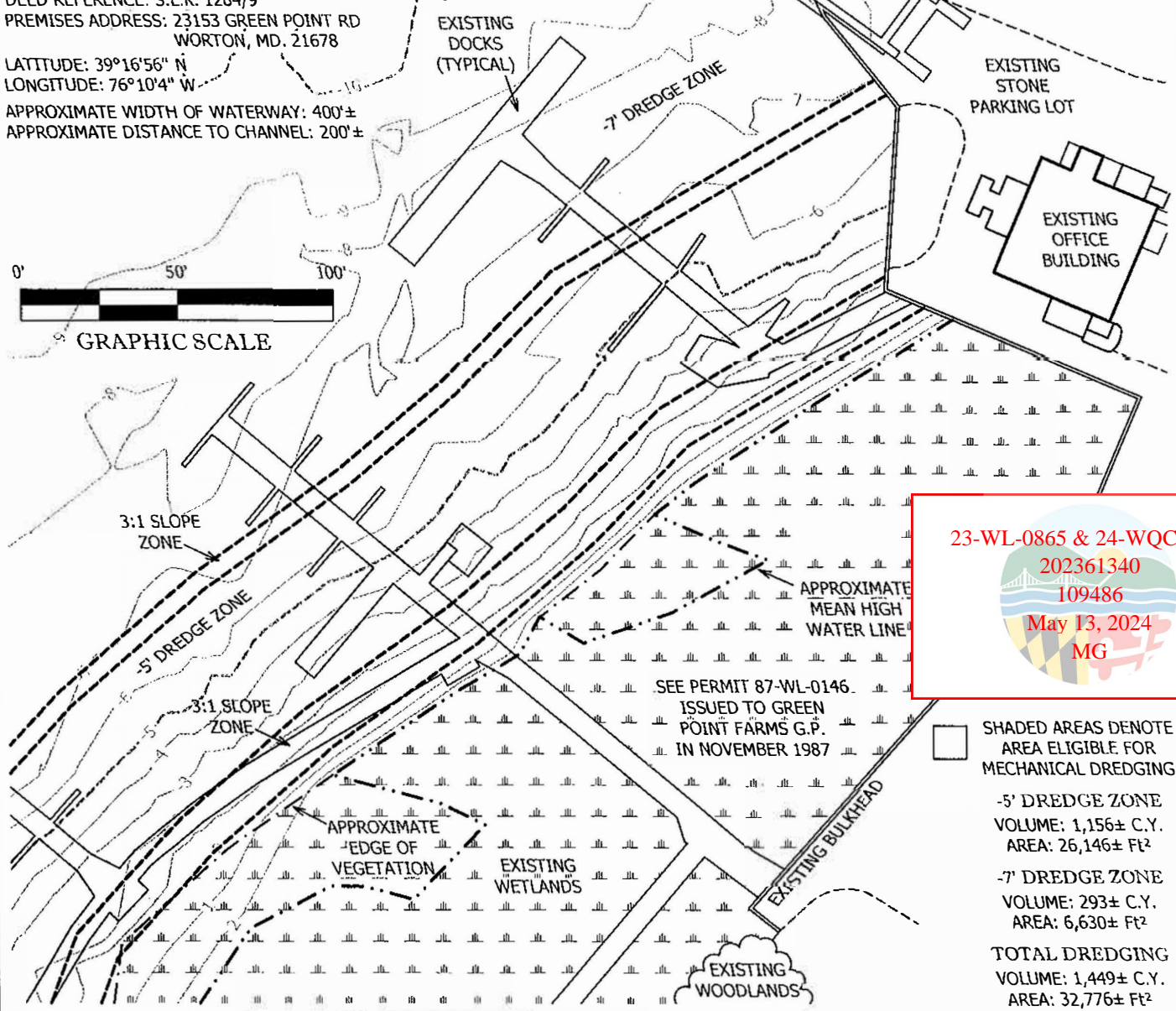
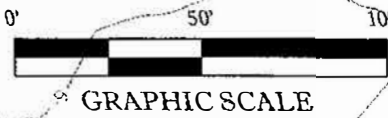

SEE PERMIT 87-WL-0146.
ISSUED TO GREEN
POINT FARMS G.P.
IN NOVEMBER 1987

23-WL-0865 & 24-WQC-0017
202361340
109486
May 13, 2024
MG

- SHADED AREAS DENOTE AREA ELIGIBLE FOR MECHANICAL DREDGING
- 5' DREDGE ZONE
VOLUME: 1,156± C.Y.
AREA: 26,146± Ft²
- 7' DREDGE ZONE
VOLUME: 293± C.Y.
AREA: 6,630± Ft²
- TOTAL DREDGING
VOLUME: 1,449± C.Y.
AREA: 32,776± Ft²

PROPOSED CONDITIONS
OF THE LANDS OF
THE WHARF AT HANDYS POINT, INC.
THIRD ELECTION DISTRICT, KENT COUNTY
MARYLAND
MAP 19 PARCEL 102

EXTREME MEASURES
LAND SURVEYORS
Chestertown, MD 21620 PHONE 410-778-0147
www.extrememeasuresllc.com

SCALE
1"=50'
DRAWN BY
WJE
DATE
5/13/24
JOB NO.
1221-B

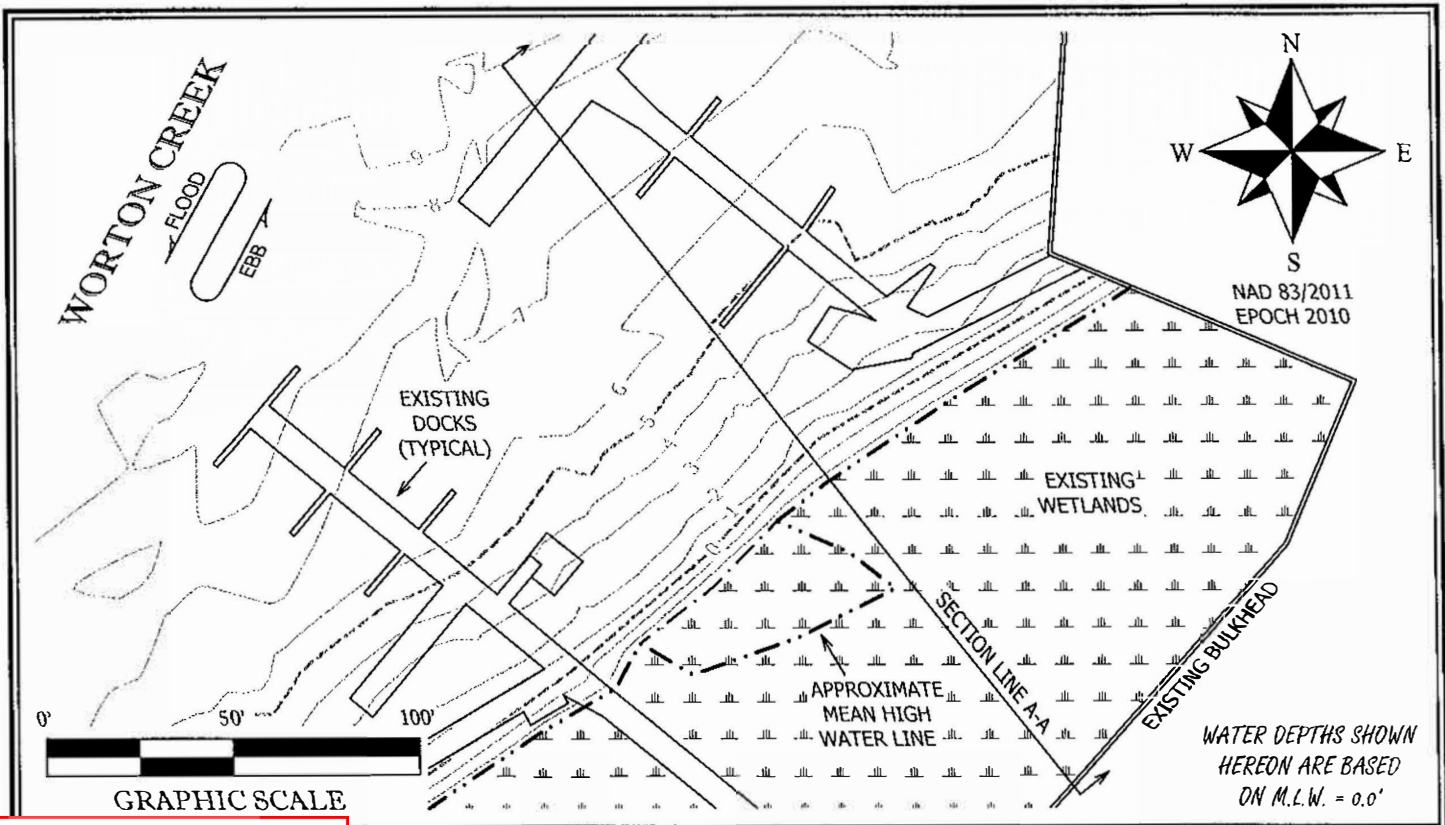

23-WL-0865 & 24-WQC-0017

202361340

109486

May 13, 2024

MG

PROFILE VIEW
SECTION A-A

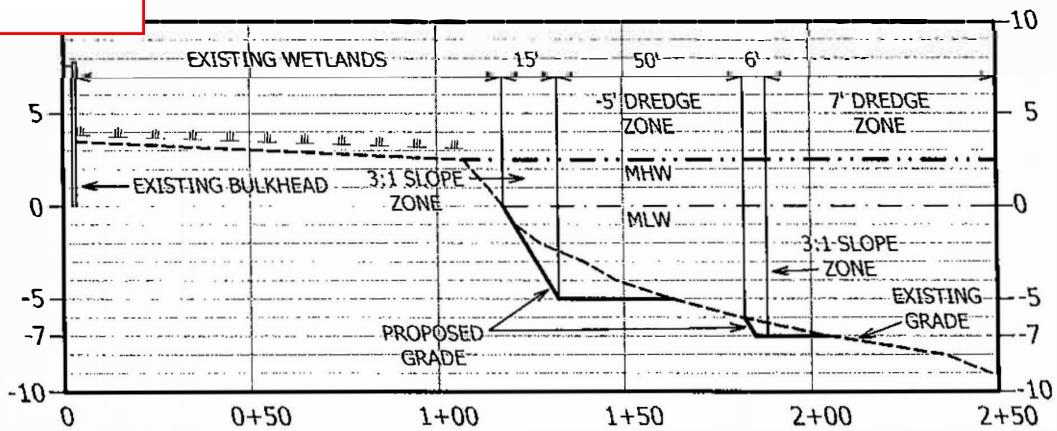

HORIZONTAL SCALE: 1"=50'
VERTICAL SCALE: 1"=10'

PROFILE VIEW
OF THE LANDS OF
THE WHARF AT HANDYS POINT, INC.
THIRD ELECTION DISTRICT, KENT COUNTY
MARYLAND
MAP 19 PARCEL 102

EXTREME MEASURES
LAND SURVEYORS
Chestertown, MD 21620 PHONE 410-778-0147
www.extrememeasuresllc.com

SCALE AS SHOWN
DRAWN BY WJE
DATE 5/13/24
JOB NO. 1221-B



23-WL-0865 & 24-WQC-0017
 202361340
 109486
 May 13, 2024
 MG

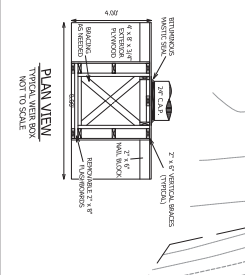
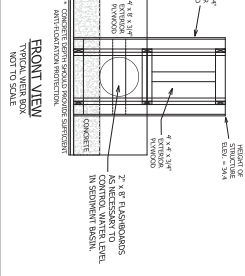
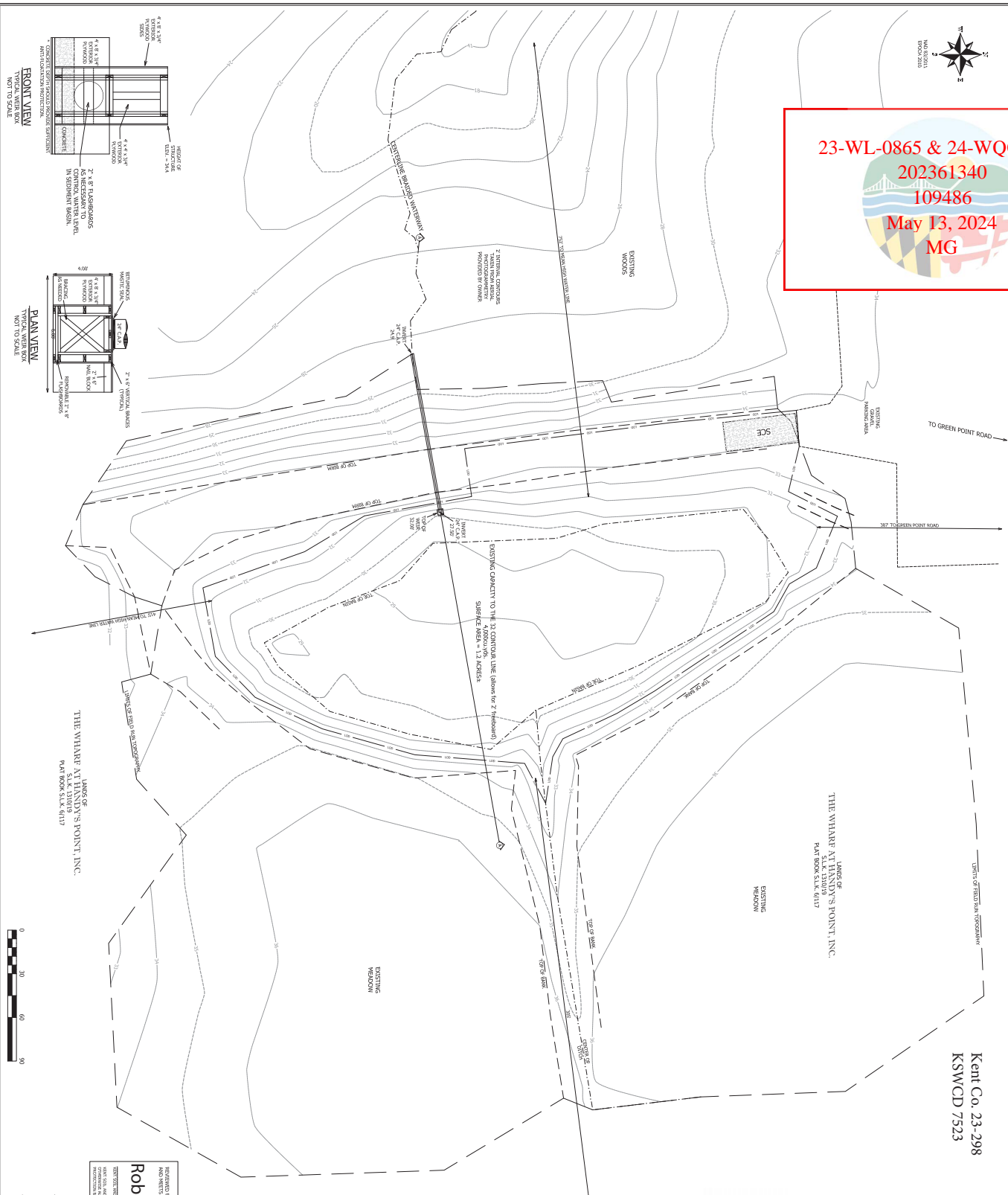

THE WHARF AT HANDY'S POINT, INC.
 LANDS OF
 S.L.K. TRUDY S.P. 6117

THE WHARF AT HANDY'S POINT, INC.
 LANDS OF
 S.L.K. TRUDY S.P. 6117

Kent Co. 23-298
 KSWCD 7523

ROBBERED FOR THE MARYLAND AND WATER CONSERVATION DISTRICT
 AND WATER CONSERVATION DISTRICT
 Robert Baldwin
 Digitally signed by Robert Baldwin
 DN: cn=Robert Baldwin, o=Robert Baldwin, ou=Robert Baldwin, email=robert@robertbaldwin.com, c=US
 DATE: 2023.07.28 10:16:39 -0400

LEGEND
 --- DROUGHT EXISTING CONTOUR
 --- 1:00 --- DENOTES LIMIT OF DISTURBANCE (34-4) CONTOUR LINE
 --- DROUGHT SOILS LINE
 ELEVATIONS SHOWN HEREON ARE BASED ON MAND 88 DATUM

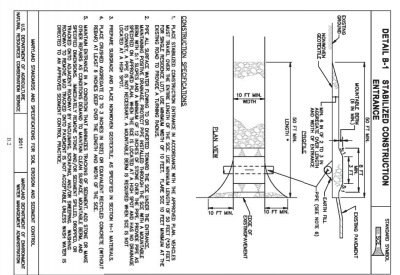

SEDIMENT & EROSION CONTROL PLAN
 OF THE LANDS OF
THE WHARF AT HANDY'S POINT, INC.
 THIRD ELECTION DISTRICT, KENT COUNTY, MARYLAND
 MAP 19 PARCEL 102

SCALE	1\"/>
-------	-------

EXTREME MEASURES
 LAND SURVEYORS
 CHESTEROWN, MD 21620
 PHONE 410-778-0147
 www.extrememeasuresllc.com

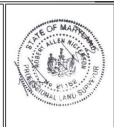

STATE OF MARYLAND
 DEPARTMENT OF THE ENVIRONMENT
 DIVISION OF WATER CONTROL

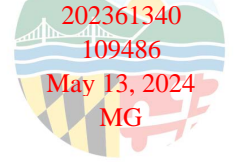

Kent Co. 23-298
KSWCD 7523

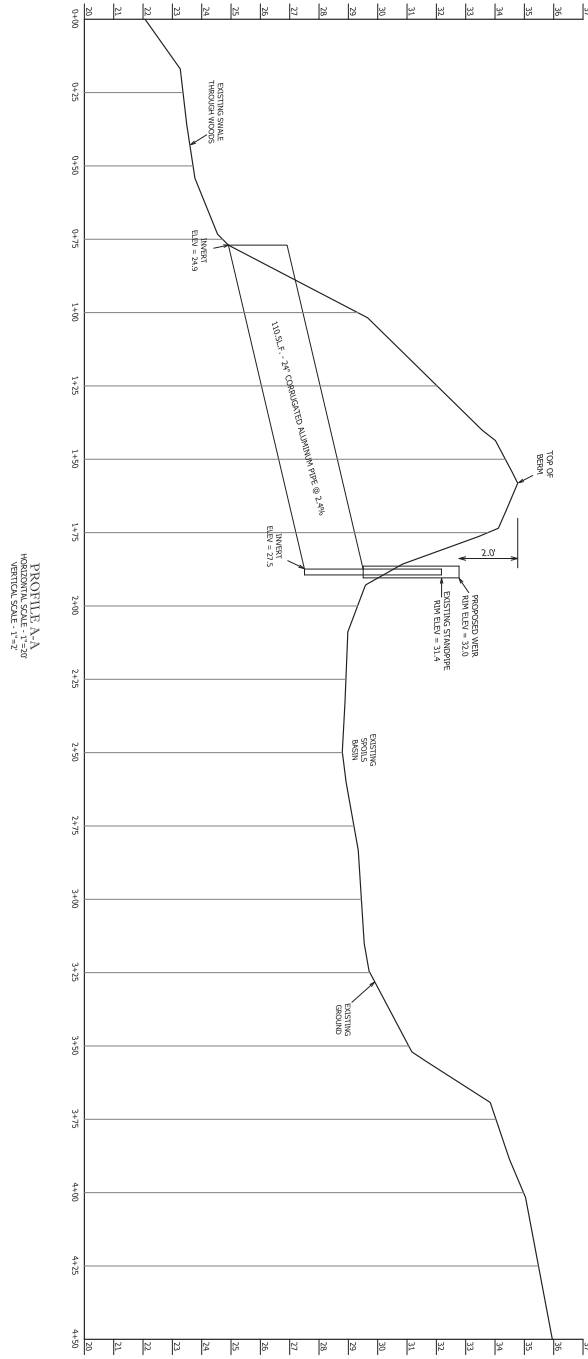

REFERENCED FOR THE KENT SOIL AND WATER CONSERVATION DISTRICT AND PROJECTS TECHNICAL REQUIREMENTS

Robert Baldwin Digitally signed by Robert Baldwin
 Date: 2023.07.28 10:16:26 -0400

THIS SEAL AND THESE REQUIREMENTS CONSTITUTE A WARNING TO THE PUBLIC THAT ANYONE WHO PROVIDES A SERVICE TO THE PUBLIC IN THE STATE OF MARYLAND IS SUBJECT TO THE REQUIREMENTS OF THE PROFESSIONAL SERVICE REGULATION ACT, CHAPTER 11, TITLE 14, SUBTITLE 10, OF THE MARYLAND CODE.

PROFILE OF THE LANDS OF THE WHARF AT HANDY'S POINT, INC. THIRD ELECTION DISTRICT, KENT COUNTY, MARYLAND MAP 19 PARCEL 102	SCALE 1"=20' GRADE & PLAN 1"=100' 6/23/23 JOB NO. 2311 REVISIONS	EXTREME MEASURES LAND SURVEYORS Chestertown, MD 21620 PHONE 410-778-0147 www.extrememeasuresllc.com	
	SHEET 3 OF 3		