



Maryland
Department of
the Environment

Wes Moore, Governor
Aruna Miller, Lt. Governor

Serena McIlwain, Secretary
Suzanne E. Dorsey, Deputy Secretary

July 8, 2024

Re: Agency Interest Number: 178872
Tracking Number: 202460043
Tidal Authorization Number: 24-WQC-0016

Dear Sean Krebs:

Your project did not qualify for approval under the Maryland State Programmatic General Permit (MDSPGP); therefore a separate review and issuance of the federal permit will be required by the U.S. Army Corps of Engineers. The federal permit is not attached.

Additionally, your project required a Wetlands License to be approved and issued by the Maryland Board of Public Works (BPW). The Wetlands License will be sent to you by BPW's Wetlands Administrator.

A project that does not qualify for approval under the MDSPGP requires an individual Water Quality Certification (WQC) to be issued by the Maryland Department of the Environment, which is attached. Please take a moment to read and review your WQC to ensure that you understand the limits of the authorized work and all of the general and special conditions.

You should not begin any work until you have obtained all necessary State, local, and federal authorizations. Please contact Matt Godbey at 410-901-4033 or matt.godbey@maryland.gov with any questions.

Sincerely,

Tammy Roberson

Tammy Roberson
Deputy Program Manager
Wetlands and Waterways Protection Program



STATE OF MARYLAND
DEPARTMENT OF THE ENVIRONMENT
WATER AND SCIENCE ADMINISTRATION
WATER QUALITY CERTIFICATION



24-WQC-0016

EFFECTIVE DATE: **July 8, 2024**
CERTIFICATION HOLDER: **Sean Krebs**
ADDRESS: **7965 Fishel Creek Rd
Seven Valley, PA 17360**
PROJECT LOCATION: **Hooper Neck Rd Lot 1 Parcel 0024
Taylors Island, MD 21669**

UNDER AUTHORITY OF SECTION 401 OF THE FEDERAL WATER POLLUTION CONTROL ACT AND ITS AMENDMENTS AND IN ACCORDANCE WITH § 9-313 THROUGH § 9-323, INCLUSIVE, OF THE ENVIRONMENT ARTICLE, ANNOTATED CODE OF MARYLAND, THE MARYLAND DEPARTMENT OF THE ENVIRONMENT, WATER AND SCIENCE ADMINISTRATION HAS DETERMINED THAT THE REGULATED ACTIVITIES DESCRIBED IN THE REQUEST FOR CERTIFICATION FOR THE PROPOSED SEAN & NICOLLE KREBS AND AS DESCRIBED IN THE ATTACHED PLAN SHEETS DATED DECEMBER 19, 2023 AND ANY SUBSEQUENT MODIFICATIONS APPROVED BY THE DEPARTMENT WILL NOT VIOLATE MARYLAND'S WATER QUALITY STANDARDS, IF CONDUCTED IN ACCORDANCE WITH THE CONDITIONS OF THIS CERTIFICATION.

THIS CERTIFICATION DOES NOT RELIEVE THE APPLICANT OF RESPONSIBILITY FOR OBTAINING ANY OTHER APPROVALS, LICENSES, OR PERMITS IN ACCORDANCE WITH FEDERAL, STATE, OR LOCAL REQUIREMENTS AND DOES NOT AUTHORIZE COMMENCEMENT OF THE PROPOSED PROJECT. A COPY OF THIS REQUIRED CERTIFICATION HAS BEEN SENT TO THE CORPS OF ENGINEERS. THE CERTIFICATION HOLDER SHALL COMPLY WITH THE CONDITIONS LISTED BELOW.

The Maryland Department of the Environment satisfied the statutory and regulatory public notice requirements by placing the WQC on Public Notice from May 15, 2024, to June 15, 2024, on Maryland Department of the Environment's Public Notice webpage.

PROJECT DESCRIPTION

Construct a 320-foot long by 14-foot wide stone breakwater, with three ten-foot wide vents, within a maximum of 29 feet channelward of the mean high water line.

GENERAL CONDITIONS

1. All water quality-related performance standards and conditions required by the Department in any state issued authorization for activities in tidal wetlands, nontidal wetlands, their 100-year floodplains, nontidal wetlands buffers, or nontidal wetland expanded buffers to ensure that any discharges will not result in a failure to comply with water quality standards in COMAR 26.08.02 or

any other water quality requirements of state law or regulation shall be met.

2. This Certification does not obviate the need to obtain required authorizations or approvals from other State, federal or local agencies as required by law.
3. All additional authorizations or approvals, including self-certifying General Permits issued by the Department, shall be obtained and all conditions shall be completed in compliance with such authorizations.
4. The proposed project shall be constructed in accordance with the approved final plan by the Department, or, if Department approval is not required, the plan approved by the U.S. Army Corps of Engineers, and its approved revisions.
5. All fill and construction materials not used in the project shall be removed and disposed of in a manner which will prevent their entry into waters of this State.
6. This Certification does not authorize any injury to private property, any invasion of rights, or any infringement of federal, state, or local laws or regulations.
7. The Certification Holder shall allow authorized representatives of the Department access to the site of authorized activities during normal business hours to conduct inspections and evaluations of the operations and records necessary to assure compliance with this Certification.
8. No stockpiles of any material shall be placed in Waters of the U.S. or state or private tidal wetlands.
9. Temporary construction trailers or structures, staging areas and stockpiles shall not be located within tidal wetlands, nontidal wetlands, nontidal wetlands buffers, or the 100-year floodplain unless specifically included on the Approved Plan.
10. This Certification is valid for the project identified herein and the associated U.S. Army Corps of Engineers authorization NAB-2024-60043 P33 (Sean & Nicolle Krebs) until such time that it expires or is not administratively extended.

SPECIAL CONDITIONS

1. All Critical Area requirements shall be followed and all necessary authorizations from the Critical Area Commission (“Commission”) shall be obtained. This Certificate does not constitute authorization for disturbance in the 100-foot Critical Area Buffer. “Disturbance” in the Buffer means clearing, grading, construction activities, or removal of any size of tree or vegetation. Any anticipated Buffer disturbance requires prior written approval, before commencement of land disturbing activity, from local jurisdiction in the form of a Buffer Management Plan.
2. All work performed under this Water Quality Certificate shall be conducted by a marine contractor licensed by the Marine Contractors Licensing Board (MCLB) in accordance with Title 17 of the Environment Article of Annotated Code of Maryland. Licensing by MCLB shall occur prior to the beginning of construction activities. A list of licensed marine contractors may be obtained by contacting the MCLB at 410-537- 3249, by e-mail at MDE.MCLB@maryland.gov or by accessing the Maryland Department of the Environment, Environmental Boards webpage.

3. The issuance of this Certificate is not a validation or authorization by the Department for any of the existing structures depicted on the plan sheets on the subject property that is not part of the authorized work description, nor does it relieve the Certificate Holder of the obligation to resolve any existing noncompliant structures and activities within tidal wetlands.

STATEMENT OF NECESSITY & CITATIONS

1. Statement of Necessity for General Conditions 1, 2, 3, 4, and Special Conditions 1, 3: These conditions are necessary to ensure that water quality standards are met, and designated uses are maintained.

Citations: Federal and state laws which authorize this condition include but are not limited to: 33 U.S.C. § 1341(a), (b), & (d); 33 U.S.C. § 1251(b); 33 U.S.C. § 1370; Md. Ann. Code, Env. Article, Title 1, Subtitles 3 and 4; Md. Ann. Code, Env. Article, Title 5, Subtitles 5 and 9; Md. Ann. Code, Env. Article, Title 9, Subtitle 3; Md. Ann. Code, Env. Article, Title 16; COMAR 26.08; COMAR 26.08.02.10G(3); COMAR 26.23.02.06; COMAR 26.17.01; COMAR 26.23; COMAR 26.24

2. Statement of Necessity for Special Condition 2: Expertise for conducting certain activities is required to ensure that there is no violation of water quality standards nor interference with designated uses. This condition is necessary to ensure that discharges will be conducted in a manner which does not violate water quality criteria nor interfere with designated uses.

Citation: COMAR 26.08.02.02B(2)- B(4); COMAR 26.08 02.03B(2)(d) – (e); COMAR 26.08.02.03B(1)(b); 26.08.02.03B(2); COMAR 23.02.04.04

3. Statement of Necessity for General Conditions 5, 8, 9: Fill or construction material within or adjacent to regulated resources may cause discharges resulting in turbidity in excess of water quality standards and interfere with designated uses of growth and propagation of fish, other aquatic life, wildlife; and other designated uses; and fail to meet general water quality criteria that waters not be polluted by substances in amounts sufficient to be unsightly or create a nuisance.

Citation: 26.08.02.03B(1)-B(2); COMAR 26.23; COMAR 26.24; COMAR 26.17.04

4. Statement of Necessity for General Condition 6: This condition is necessary to clarify the scope of this certification to ensure compliance with water quality regulations, without limiting restrictions through other requirements.

Citation: Federal and state laws which authorize this condition include but are not limited to: 33 U.S.C. § 1341(a), (b), & (d); 33 U.S.C. § 1251(b); 33 U.S.C. § 1370; Md. Ann. Code, Env. Article, Title 1, Subtitles 3 and 4; Md. Ann. Code, Env. Article, Title 5, Subtitles 5 and 9; Md. Ann. Code, Env. Article, Title 9, Subtitle 3; Md. Ann. Code, Env. Article, Title 16; COMAR 26.08, COMAR 26.08.02.10E; COMAR 26.23.02.06; COMAR 26.17.04; COMAR 26.23; COMAR 26.24

5. Statement of Necessity for General Condition 7: Conditions of certification involve precise actions to comply with water quality standards. Site inspection may be necessary to ensure that limits, methods, and other requirements are met to ensure that water quality standards are met and designated uses are maintained. These conditions are necessary to ensure that the activity was conducted, and project completed according to terms of the authorization/certification, while allowing for review of in-field

modifications which may have resulted in discharges to ensure that water quality standards were met. Designated uses include support of estuarine and marine aquatic life and shellfish harvesting and for growth and propagation of fish, other aquatic life, and wildlife

Citation: Federal and state laws that authorize this condition include but are not limited to: 33 U.S.C. § 1341(a), (b), & (d); 33 U.S.C. § 1251(b); 33 U.S.C. § 1370; Md. Ann. Code, Env. Article, Title 1, Subtitles 3 and 4; Md. Ann. Code, Env. Article, Title 5, Subtitles 5 and 9; Md. Ann. Code, Env. Article, Title 9, Subtitle 3; Md. Ann. Code, Env. Article, Title 16; COMAR 26.08; COMAR 26.08.02.03B(1)(b); COMAR 26.08.02.03B(2); COMAR 26.23.02.06; COMAR 26.23; COMAR 26.24; COMAR 26.17.04

6. Statement of Necessity for General Condition 10: This condition is necessary to qualify the period of applicability of the terms and conditions of this Certification to be protective of Maryland water quality standards.

Citations: Federal and state laws which authorize this condition include but are not limited to: 33 U.S.C. § 1341(a), (b), & (d); 33 U.S.C. § 1251(b); 33 U.S.C. § 1370; 40 C.F.R. 121, 15 C.F.R. 930, Md. Ann. Code, Env. Article, Title 1, Subtitles 3 and 4; Md. Ann. Code, Env. Article, Title 5, Subtitles 5 and 9; Md. Ann. Code, Env. Article, Title 9, Subtitle 3; Md. Ann. Code,

CERTIFICATION APPROVED



D. Lee Currey, Director
Water and Science Administration

7/11/2024

Date

Tracking Number: 202460043
Agency Interest Number: 178872

Effective Date: **July 8, 2024**

Enclosure: Plan Sheets dated **12/19/2023**

cc: WSA Inspection & Compliance Program
Army Corps of Engineers

**SHORELINE STABILIZATION PERMIT DRAWINGS
 PREPARED FOR
 SEAN KREBS & NICOLLE KREBS
 IN THE FOURTH ELECTION DISTRICT
 DORCHESTER COUNTY, MARYLAND**

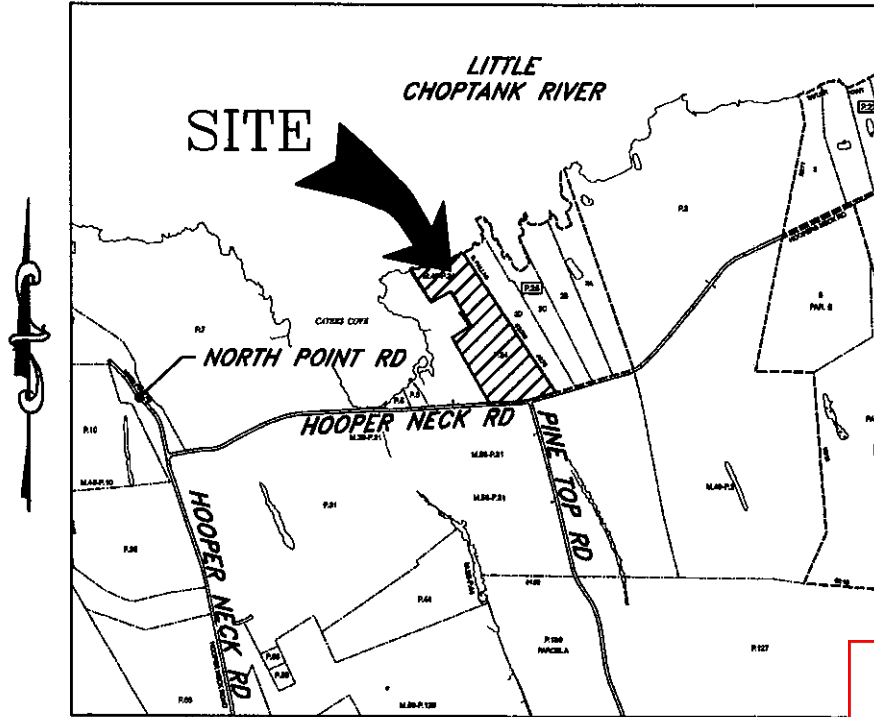

VICINITY MAP
 SCALE: 1" = 2,000'

24-WL-0027 & 24-WQC-0016
 202460043
 178872
 12/19/2023
 MG

ENGINEER

OWNER/DEVELOPER

PROJECT LOCATION

Lane Engineering, LLC
 117 BAY STREET
 EASTON, MARYLAND 21601
 (410) 822-8003

SEAN KREBS
 NICOLLE KREBS
 7965 FISHEL CREEK ROAD
 SEVEN VALLEYS, PA 17360
 (717) 309-3866

HOOPER NECK ROAD
 TAYLORS ISLAND, MD 21669

ISSUE FOR:	DATE:	BY:	No.	DATE:	REVISION:	BY:
MDE SUBMITTAL	12/19/23	DSR				

FILE No. B923
 JOB No. 210498
 SCALE: AS NOTED
 DATE: AS NOTED
 SHEET No. 1 OF 6

TITLE SHEET
ON THE LANDS OF
SEAN KREBS & NICOLLE KREBS
TAYLORS ISLAND, MARYLAND
IN THE FOURTH ELECTION DISTRICT, DORCHESTER COUNTY
TAX MAP 49, GRID 19, PARCEL 24, LOT 1

Lane Engineering, LLC
 Established 1986
 Civil Engineers • Land Planning • Land Surveyors



E-mail: general@leinc.com
 117 Bay St. Easton, MD 21801 (410) 822-8003
 15 Washington St. Cambridge, MD 21613 (410) 221-0818
 354 Pennsylvania Ave. Centreville, MD 21617 (410) 758-2095



LEGEND & ABBREVIATIONS

MHW MEAN HIGH WATER (APPROXIMATE)
 MLW MEAN LOW WATER (APPROXIMATE)
 SAV SUBMERGED AQUATIC VEGETATION
 TYP TYPICAL

PROPERTY LINE _____
 TOP OF BANK _____
 2018 MAPPED SAV _____SAV18_____
 2019 MAPPED SAV _____SAV19_____
 SPOT ELEVATION/SOUNDING x -2.15

PROJECT NOTES

1. THE PROPERTY BOUNDARY SHOWN HEREON WAS COMPUTED USING AVAILABLE DEED AND PLAT RECORDS, A BOUNDARY SURVEY WAS NOT PERFORMED. EXISTING CONDITIONS SHOWN HEREON WERE SURVEY LOCATED BY LANE ENGINEERING, LLC IN OCTOBER, 2021.
2. THESE DRAWINGS ARE FOR PERMIT PURPOSES ONLY AND ARE NOT TO BE USED AS AN ACCURATE CONSTRUCTION DOCUMENT.
3. TIDAL DATUM, I.E. MEAN LOW WATER ELEVATION, IS ESTIMATED FROM ENVIRONMENTAL INDICATORS SUCH AS RACK LINES, WATER MARKS, PLANT COMMUNITY COMPOSITIONS.
4. UNLESS OTHERWISE NOTED, ELEVATIONS SHOWN HEREIN ARE REFERENCED TO MEAN LOW WATER = 0.0'.
5. MEAN TIDAL RANGE = 1.22' (PER NOAA VDATUM)
6. LOT SIZE = 22.10 AC± (PER SDAT)
7. MAXIMUM CHANNELWARD ENCROACHMENT = 29'±
8. ZONING CLASSIFICATION = RC (RESOURCE CONSERVATION)
9. 911 ADDRESS = HOOPER NECK ROAD TAYLORS ISLAND, MD 21669

FILE No. B923
 JOB No. 210498
 SCALE: AS NOTED
 DATE: AS NOTED
 SHEET No. 2 OF 6

SITE & PROJECT NOTES
 ON THE LANDS OF
SEAN KREBS & NICOLLE KREBS
TAYLORS ISLAND, MARYLAND
 IN THE FOURTH ELECTION DISTRICT, DORCHESTER COUNTY
 TAX MAP 49, GRID 19, PARCEL 24, LOT 1

Lane Engineering, LLC
 Established 1986
 Civil Engineers • Land Planning • Land Surveyors

 E-mail: general@leinc.com
 117 Bay St. Easton, MD 21601 (410) 822-8003
 15 Washington St. Cambridge, MD 21613 (410) 221-0818
 354 Pennsylvania Ave. Centreville, MD 21617 (410) 758-2095

24-WL-0027 & 24-WQC-0016
 202460043
 178872
 12/19/2023
 MG

**LITTLE
 CHOPTANK RIVER**

P/O PARCEL 24, LOT 1

TAX MAP 49, PARCEL 25, LOT 2D
 DEBRA BURBAGE WILKINS
 30565 FOXCHASE DRIVE
 SALISBURY, MD 21804

TAX MAP 58, PARCEL 31
 JOHN S. NEILD, JR. TRUSTEE
 ANN J. NEILD, TRUSTEE
 5110 NORTH DRIVE
 CAMBRIDGE, MD 21613

**PARCEL 24, LOT 1
 (APPLICANT)**

HOOPER NECK ROAD

NAD 83 (CORS)
 MARYLAND STATE PLANE

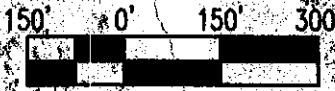

SCALE IN FEET

SITE OVERVIEW

**ON THE LANDS OF
 SEAN KREBS & NICOLLE KREBS
 TAYLORS ISLAND, MARYLAND**

**IN THE FOURTH ELECTION DISTRICT, DORCHESTER COUNTY
 TAX MAP 49, GRID 19, PARCEL 24, LOT 1**

Lane Engineering, LLC

Established 1986
 Civil Engineers • Land Planning • Land Surveyors



E-mail: general@leinc.com
 117 Bay St. Easton, MD 21601 (410) 822-8003
 15 Washington St. Cambridge, MD 21613 (410) 221-0818
 354 Pennsylvania Ave. Centreville, MD 21617 (410) 758-2095

SHEET No. **3 OF 6**
 DATE: AS NOTED
 SCALE: AS NOTED
 JOB No. 210498
 FILE No. B923

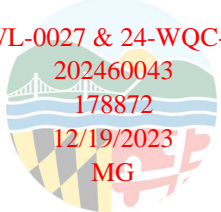

LITTLE CHOPTANK RIVER

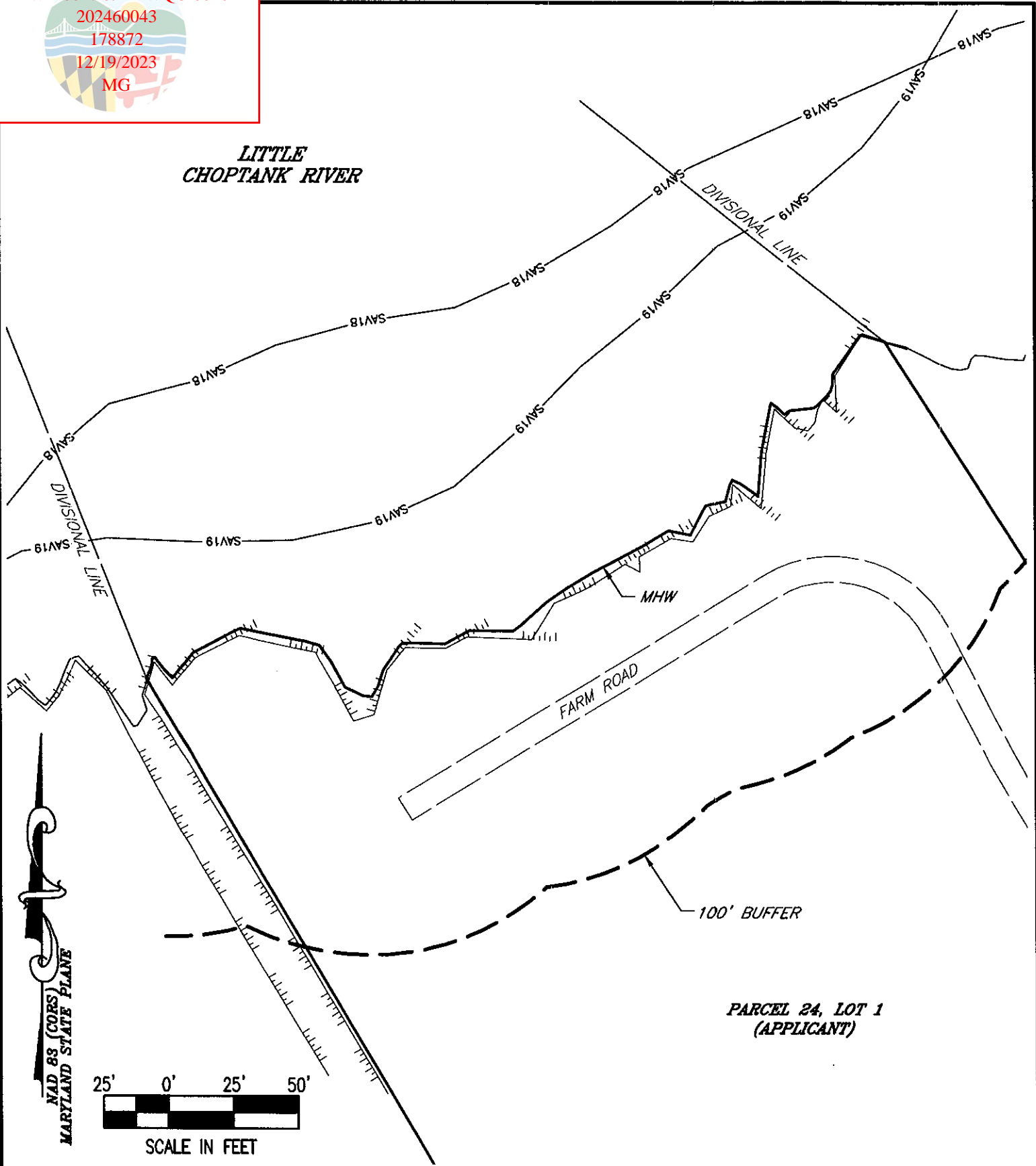

**PARCEL 24, LOT 1
(APPLICANT)**

MARYLAND STATE PLANE
NAD 83 COORS
88 FWD

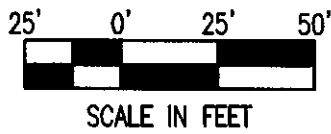

DATE: AS NOTED
 SCALE: AS NOTED
 JOB No. 210498
 FILE No. B923

SHEET No.
4 OF 6

EXISTING CONDITIONS
 ON THE LANDS OF
SEAN KREBS & NICOLLE KREBS
TAYLORS ISLAND, MARYLAND
 IN THE FOURTH ELECTION DISTRICT, DORCHESTER COUNTY
 TAX MAP 49, GRID 19, PARCEL 24, LOT 1

Lane Engineering, LLC
 Established 1986
 Civil Engineers • Land Planning • Land Surveyors

E-mail: general@laneinc.com
 117 Bay St. Easton, MD 21601 (410) 822-8003
 15 Washington St. Cambridge, MD 21613 (410) 221-0818
 354 Pennsylvania Ave. Centreville, MD 21617 (410) 758-2095



LITTLE CHOPTANK RIVER

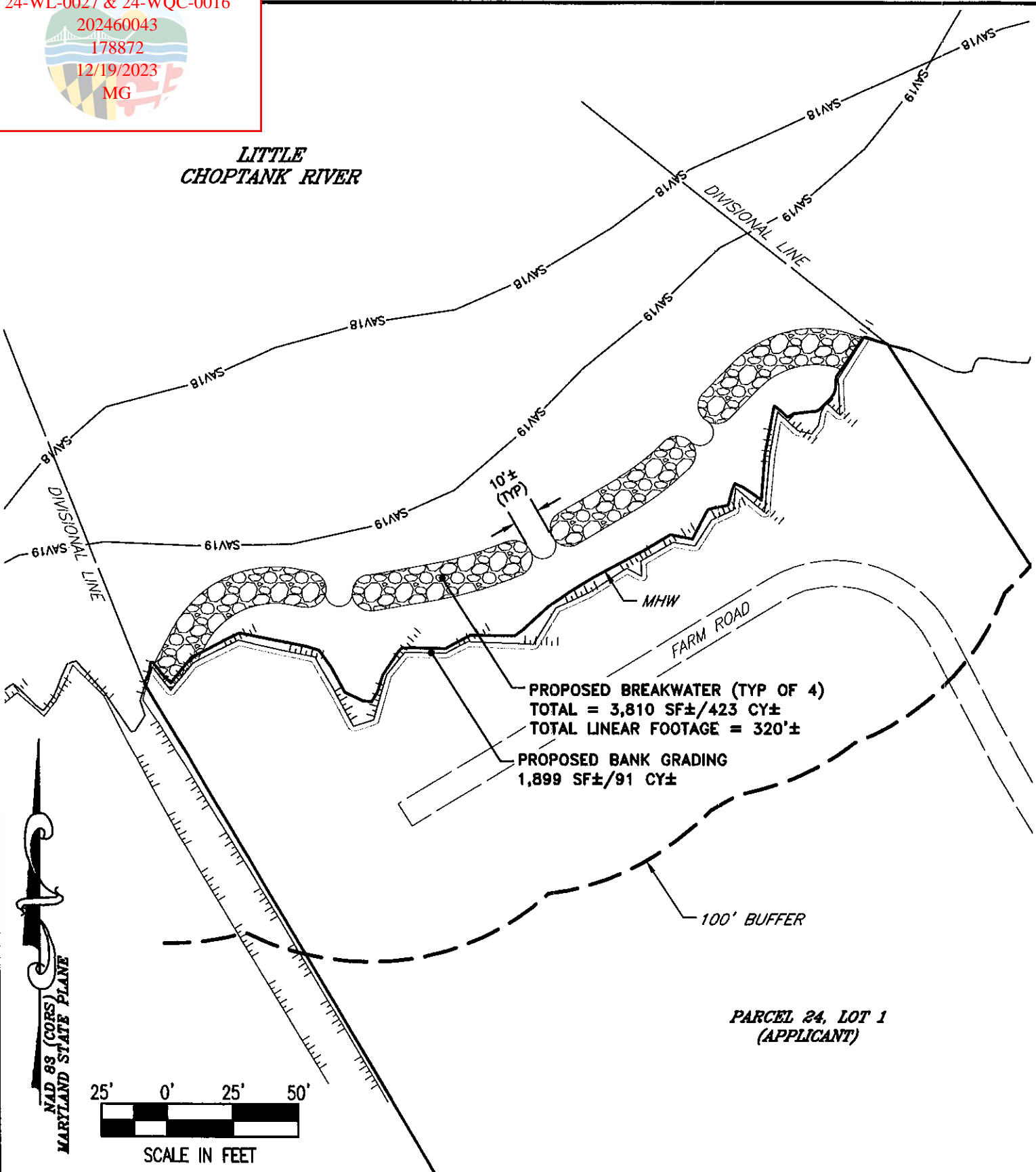

PROPOSED BREAKWATER (TYP OF 4)
 TOTAL = 3,810 SF±/423 CY±
 TOTAL LINEAR FOOTAGE = 320'±

PROPOSED BANK GRADING
 1,899 SF±/91 CY±

100' BUFFER

PARCEL 24, LOT 1
(APPLICANT)

MARYLAND STATE PLANE
NAD 83
CORS

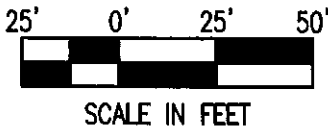

SHEET No.
5 OF 6

DATE: AS NOTED

SCALE: AS NOTED

JOB No. 210498

FILE No. B923

PROPOSED IMPROVEMENTS

ON THE LANDS OF

SEAN KREBS & NICOLLE KREBS

TAYLORS ISLAND, MARYLAND

IN THE FOURTH ELECTION DISTRICT, DORCHESTER COUNTY

TAX MAP 49, GRID 19, PARCEL 24, LOT 1

Lane Engineering, LLC

Established 1986

Civil Engineers • Land Planning • Land Surveyors

E-mail: general@leinc.com

117 Bay St. Easton, MD 21601 (410) 822-8003

15 Washington St. Cambridge, MD 21613 (410) 221-0818

354 Pennsylvania Ave. Centreville, MD 21617 (410) 758-2095

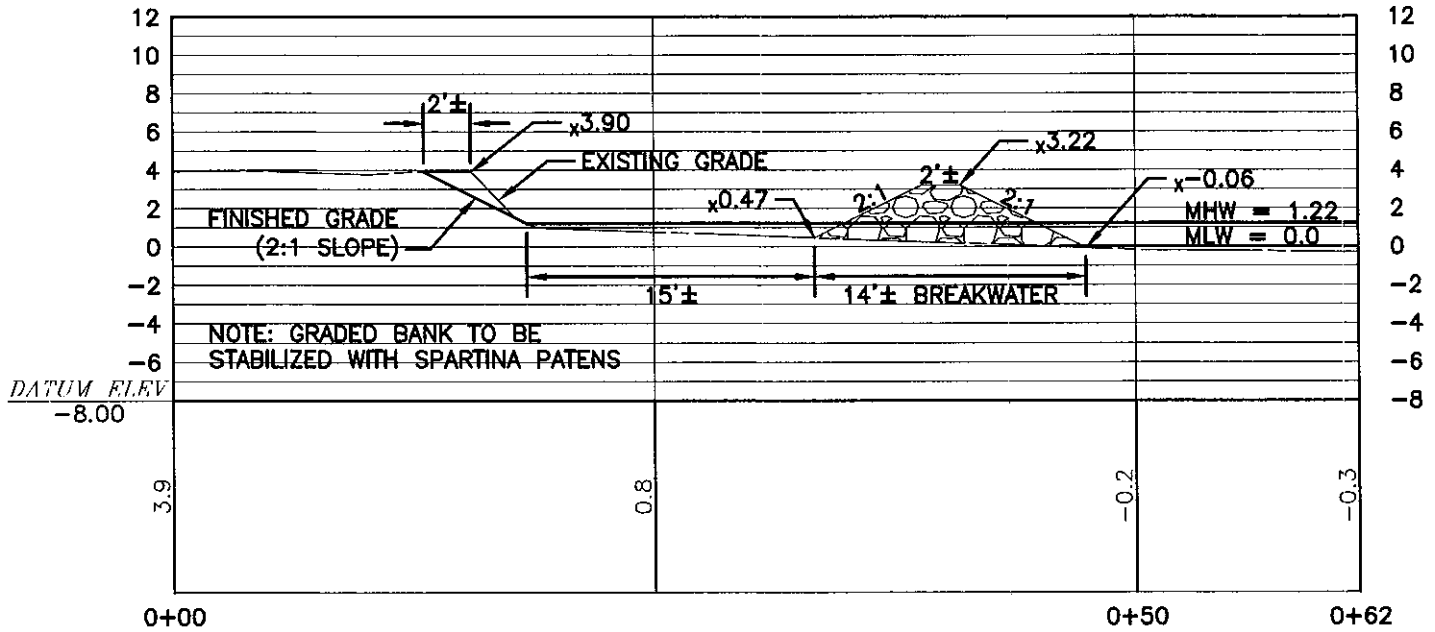

BREAKWATER SECTION A-A
SCALE: 1" = 10'

24-WL-0027 & 24-WQC-0016
202460043
178872
12/19/2023
MG

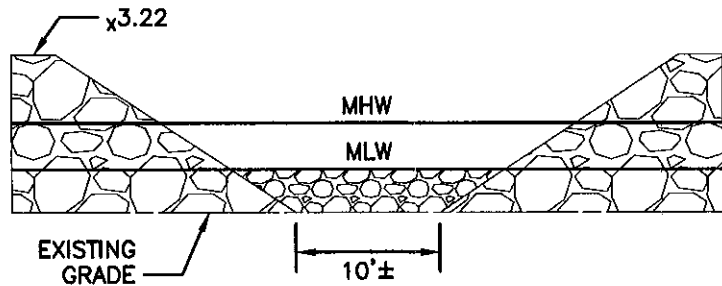

BREAKWATER VENT DETAIL
NOT TO SCALE

FILE No. B923
JOB No. 210498
SCALE: AS NOTED
DATE: AS NOTED
SHEET No. 6 OF 6

DETAILS
ON THE LANDS OF
SEAN KREBS & NICOLLE KREBS
TAYLORS ISLAND, MARYLAND
IN THE FOURTH ELECTION DISTRICT, DORCHESTER COUNTY
TAX MAP 49, GRID 19, PARCEL 24, LOT 1

Lane Engineering, LLC
Established 1986
Civil Engineers • Land Planning • Land Surveyors



E-mail: general@leinc.com
117 Bay St. Easton, MD 21601 (410) 822-8003
15 Washington St. Cambridge, MD 21613 (410) 221-0818
354 Pennsylvania Ave. Centreville, MD 21617 (410) 758-2095