



Maryland
Department of
the Environment

Wes Moore, Governor
Aruna Miller, Lt. Governor

Serena McIlwain, Secretary
Suzanne E. Dorsey, Deputy Secretary

October 03, 2023

EMT Investments LLC
448 Mauldin Ave
North East, MD 21901

Via email: baypiledriver@aol.com

Re: Agency Interest Number: 174118
Tracking Number: 202260125
Tidal Authorization Number: 23-WQC-0020

Dear EMT Investments LLC:

Your project did not qualify for approval under the Maryland State Programmatic General Permit (MDSPGP); therefore a separate review and issuance of the federal permit will be required by the U.S. Army Corps of Engineers. The federal permit is not attached.

Additionally, your project required a Wetlands License to be approved and issued by the Maryland Board of Public Works (BPW). The Wetlands License will be sent to you by BPW's Wetlands Administrator.

A project that does not qualify for approval under the MDSPGP requires an individual Water Quality Certification (WQC) to be issued by the Maryland Department of the Environment, which is attached. Please take a moment to read and review your WQC to ensure that you understand the limits of the authorized work and all of the general and special conditions.

You should not begin any work until you have obtained all necessary State, local, and federal authorizations. Please contact R. Miles Simmons at robertm.simmons@maryland.gov or 410-901-4044 with any questions.

Sincerely,

Tammy Roberson

Tammy Roberson, Division Chief
Wetlands and Waterways Protection Program
Tidal Wetlands Division



STATE OF MARYLAND
DEPARTMENT OF THE ENVIRONMENT
WATER AND SCIENCE ADMINISTRATION
WATER QUALITY CERTIFICATION



23-WQC-0020

EFFECTIVE DATE: **October 3, 2023**
CERTIFICATION HOLDER: **EMT Investments LLC**
ADDRESS: **448 Mauldin Ave
North East, MD 21901**
PROJECT LOCATION: **Hance Point Rd
Parcel 77, 39.572912° N, -75.953666° W
North East, MD 21901**

UNDER AUTHORITY OF SECTION 401 OF THE FEDERAL WATER POLLUTION CONTROL ACT AND ITS AMENDMENTS AND IN ACCORDANCE WITH § 9-313 THROUGH § 9-323, INCLUSIVE, OF THE ENVIRONMENT ARTICLE, ANNOTATED CODE OF MARYLAND, THE MARYLAND DEPARTMENT OF THE ENVIRONMENT, WATER AND SCIENCE ADMINISTRATION HAS DETERMINED THAT THE REGULATED ACTIVITIES DESCRIBED IN THE REQUEST FOR CERTIFICATION FOR THE PROPOSED BOAT RAMP AND AS DESCRIBED IN THE ATTACHED PLAN SHEETS DATED JANUARY 2, 2022 AND ANY SUBSEQUENT MODIFICATIONS APPROVED BY THE DEPARTMENT WILL NOT VIOLATE MARYLAND'S WATER QUALITY STANDARDS, IF CONDUCTED IN ACCORDANCE WITH THE CONDITIONS OF THIS CERTIFICATION.

THIS CERTIFICATION DOES NOT RELIEVE THE APPLICANT OF RESPONSIBILITY FOR OBTAINING ANY OTHER APPROVALS, LICENSES, OR PERMITS IN ACCORDANCE WITH FEDERAL, STATE, OR LOCAL REQUIREMENTS AND DOES NOT AUTHORIZE COMMENCEMENT OF THE PROPOSED PROJECT. A COPY OF THIS REQUIRED CERTIFICATION HAS BEEN SENT TO THE CORPS OF ENGINEERS. THE CERTIFICATION HOLDER SHALL COMPLY WITH THE CONDITIONS LISTED BELOW.

PROJECT DESCRIPTION

Construct an 80-foot long by 28-foot wide boat ramp with two 45-foot bulkhead returns, and two 80-foot long by 6-foot wide floating pier with associated support piles and two 16-foot long by 3-foot wide gangways, all extending a maximum of 80 feet channelward of the mean high water line.

GENERAL CONDITIONS

1. All water quality-related performance standards and conditions required by the Department in any state issued authorization for activities in tidal wetlands, nontidal wetlands, their 100-year

floodplains, nontidal wetlands buffers, or nontidal wetland expanded buffers to ensure that any discharges will not result in a failure to comply with water quality standards in COMAR 26.08.02 or any other water quality requirements of state law or regulation shall be met.

2. This Certification does not obviate the need to obtain required authorizations or approvals from other State, federal or local agencies as required by law.
3. All additional authorizations or approvals, including self-certifying General Permits issued by the Department, shall be obtained and all conditions shall be completed in compliance with such authorizations.
4. The proposed project shall be constructed in accordance with the approved final plan by the Department, or, if Department approval is not required, the plan approved by the U.S. Army Corps of Engineers, and its approved revisions.
5. All fill and construction materials not used in the project shall be removed and disposed of in a manner which will prevent their entry into waters of this State.
6. This Certification does not authorize any injury to private property, any invasion of rights, or any infringement of federal, state, or local laws or regulations.
7. Authorized representatives of the Department shall be provided access to the site of authorized activities during normal business hours to conduct inspections and evaluations of the operations and records necessary to assure compliance with this Certification.
8. No stockpiles of any material shall be placed in Waters of the U.S. or state or private tidal wetlands.
9. Temporary construction trailers or structures, staging areas and stockpiles shall not be located within tidal wetlands, nontidal wetlands, nontidal wetlands buffers, or the 100-year floodplain unless specifically included on the Approved Plan.
10. This Certification is valid for the project identified herein and the associated U.S. Army Corps of Engineers authorization NAB-2022-60125 (EMT Investments LLC) until such time that it expires or is not administratively extended.

SPECIAL CONDITIONS

1. All Critical Area requirements shall be followed and all necessary authorizations from the Critical Area Commission (“Commission”) shall be obtained. This Certificate does not constitute authorization for disturbance in the 100-foot Critical Area Buffer. “Disturbance” in the Buffer means clearing, grading, construction activities, or removal of any size of tree or vegetation. Any anticipated Buffer disturbance requires prior written approval, before commencement of land disturbing activity, from local jurisdiction in the form of a Buffer Management Plan.
2. All work performed under this Water Quality Certificate shall be conducted by a marine contractor licensed by the Marine Contractors Licensing Board (MCLB) in accordance with Title 17 of the Environment Article of Annotated Code of Maryland. Licensing by MCLB shall occur prior to the beginning of construction activities. A list of licensed marine contractors may be obtained by

contacting the MCLB at 410-537- 3249, by e-mail at MDE.MCLB@maryland.gov or by accessing the Maryland Department of the Environment, Environmental Boards webpage.

3. The issuance of this Certificate is not a validation or authorization by the Department for any of the existing structures depicted on the plan sheets on the subject property that is not part of the authorized work description, nor does it relieve the Certificate Holder of the obligation to resolve any existing noncompliant structures and activities within tidal wetlands.
4. The Certificate Holder shall complete construction of the bulkhead prior to filling behind the bulkhead. The bulkhead shall be designed and constructed to prevent the loss of fill material to waters of the State of Maryland. Only clean fill, which is free of organic, toxic, contaminated, or deleterious materials, shall be used.
5. The Certificate Holder, to reduce any potential adverse effects to aquatic resources, shall construct and maintain a cofferdam or similar containment structure around and channelward of the boat ramp area prior to any excavation and backfilling along the shoreline through completion of any excavation and backfilling along the shoreline and concrete work.

STATEMENTS OF NECESSITY

1. Statement of Necessity for General Conditions 1, 2, 3, 4, and Special Conditions 1, 3: These conditions are necessary to ensure that water quality standards are met, and designated uses are maintained.

Citations: Federal and state laws which authorize this condition include but are not limited to: 33 U.S.C. § 1341(a), (b), & (d); 33 U.S.C. § 1251(b); 33 U.S.C. § 1370; Md. Ann. Code, Env. Article, Title 1, Subtitles 3 and 4; Md. Ann. Code, Env. Article, Title 5, Subtitles 5 and 9; Md. Ann. Code, Env. Article, Title 9, Subtitle 3; Md. Ann. Code, Env. Article, Title 16; COMAR 26.08; COMAR 26.08.02.10G(3); COMAR 26.23.02.06; COMAR 26.17.01; COMAR 26.23; COMAR 26.24

2. Statement of Necessity for General Conditions 5, 8, 9, and Special Condition 4, 5: Fill or construction material within or adjacent to regulated resources may cause discharges resulting in turbidity in excess of water quality standards and interfere with designated uses of growth and propagation of fish, other aquatic life, wildlife; and other designated uses; and fail to meet general water quality criteria that waters not be polluted by substances in amounts sufficient to be unsightly or create a nuisance.

Citation: 26.08.02.03B(1)-B(2); COMAR 26.23; COMAR 26.24; COMAR 26.17.04

3. Statement of Necessity for General Condition 6: This condition is necessary to clarify the scope of this certification to ensure compliance with water quality regulations, without limiting restrictions through other requirements.

Citation: Federal and state laws which authorize this condition include but are not limited to: 33 U.S.C. § 1341(a), (b), & (d); 33 U.S.C. § 1251(b); 33 U.S.C. § 1370; Md. Ann. Code, Env. Article, Title 1, Subtitles 3 and 4; Md. Ann. Code, Env. Article, Title 5, Subtitles 5 and 9; Md. Ann. Code, Env. Article, Title 9, Subtitle 3; Md. Ann. Code, Env. Article, Title 16; COMAR 26.08, COMAR

4. Statement of Necessity for General Condition 7: Conditions of certification involve precise actions to comply with water quality standards. Site inspection may be necessary to ensure that limits, methods, and other requirements are met to ensure that water quality standards are met and designated uses are maintained. These conditions are necessary to ensure that the activity was conducted, and project completed according to terms of the authorization/certification, while allowing for review of in-field modifications which may have resulted in discharges to ensure that water quality standards were met. Designated uses include support of estuarine and marine aquatic life and shellfish harvesting and for growth and propagation of fish, other aquatic life, and wildlife

Citation: Federal and state laws that authorize this condition include but are not limited to: 33 U.S.C. § 1341(a), (b), & (d); 33 U.S.C. § 1251(b); 33 U.S.C. § 1370; Md. Ann. Code, Env. Article, Title 1, Subtitles 3 and 4; Md. Ann. Code, Env. Article, Title 5, Subtitles 5 and 9; Md. Ann. Code, Env. Article, Title 9, Subtitle 3; Md. Ann. Code, Env. Article, Title 16; COMAR 26.08; COMAR 26.08.02.03B(1)(b); COMAR 26.08.02.03B(2); COMAR 26.23.02.06; COMAR 26.23; COMAR 26.24; COMAR 26.17.04

5. Statement of Necessity for General Condition 10: This condition is necessary to qualify the period of applicability of the terms and conditions of this Certification to be protective of Maryland water quality standards.

Citations: Federal and state laws which authorize this condition include but are not limited to: 33 U.S.C. § 1341(a), (b), & (d); 33 U.S.C. § 1251(b); 33 U.S.C. § 1370; 40 C.F.R. 121, 15 C.F.R. 930, Md. Ann. Code, Env. Article, Title 1, Subtitles 3 and 4; Md. Ann. Code, Env. Article, Title 5, Subtitles 5 and 9; Md. Ann. Code, Env. Article, Title 9, Subtitle 3; Md. Ann. Code, Env. Article, Title 16; COMAR 26.08; COMAR 26.17.04; COMAR 26.23; COMAR 26.24

6. Statement of Necessity for Special Condition 2: Expertise for conducting certain activities is required to ensure that there is no violation of water quality standards nor interference with designated uses. This condition is necessary to ensure that discharges will be conducted in a manner which does not violate water quality criteria nor interfere with designated uses.

Citation: COMAR 26.08.02.02B(2)- B(4); COMAR 26.08 02.03B(2)(d) – (e); COMAR 26.08.02.03B(1)(b); 26.08.02.03B(2); COMAR 23.02.04.04

CERTIFICATION APPROVED

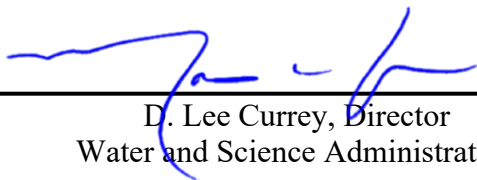

D. Lee Currey, Director
Water and Science Administration

10/5/2023

Date

Tracking Number: 202260125
Agency Interest Number: 174118

Effective Date: **October 3, 2023**

Enclosure: Plan Sheets dated **January 2, 2022**

cc: WSA Inspection & Compliance Program
Army Corps of Engineers

21914
Stone Wharf
CHARLESTOWN

SITE

**EMT Investments LLC
Hances Point Rd
Parcel 77
Ed Trainer Agent**

NORTHEAST

630,000 FT

Joins-Map 15

39°32'30"

MD GRID 620,000 FT

10

22-WL-0060 & 23-WQC-0020
202260125
174118
01/02/2022
RMS



Existing Conditions

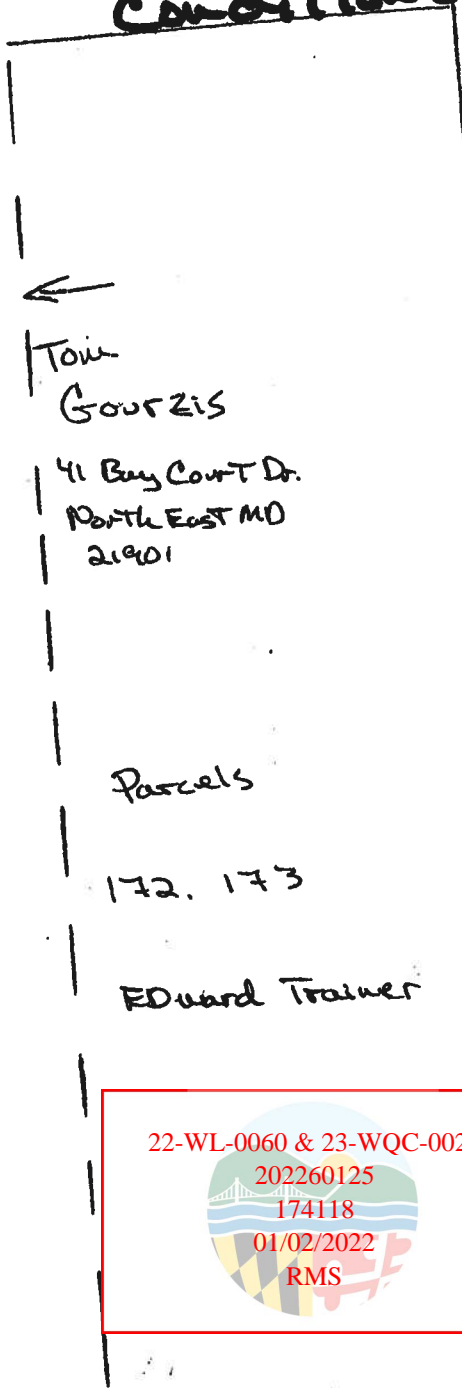

41 Bay Court Dr.
North East MD
21901

Parcels

172, 173

Edward Trainer

22-WL-0060 & 23-WQC-0020
202260125
174118
01/02/2022
RMS

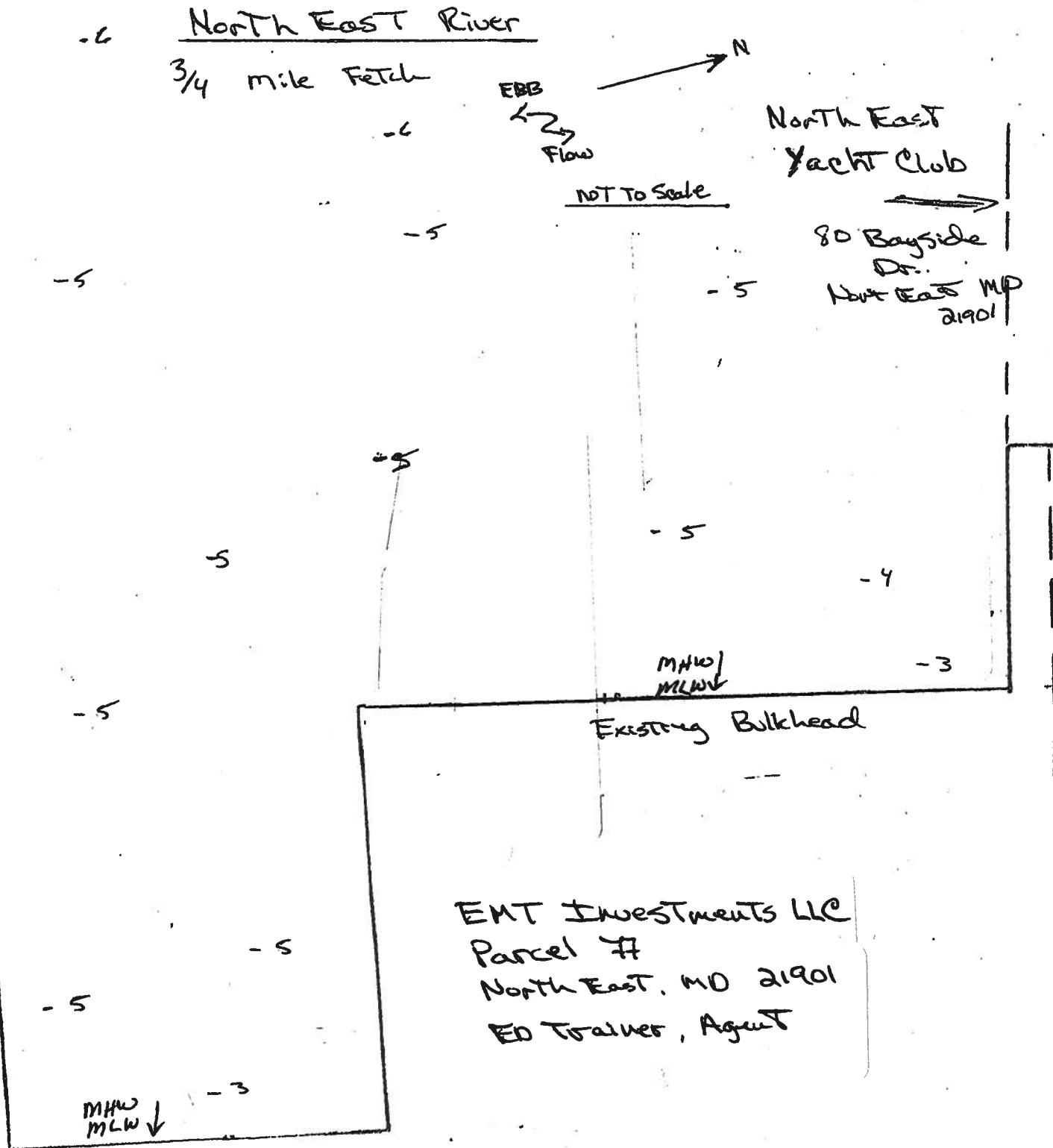

Proposed

North East River

3/4 mile Fetch

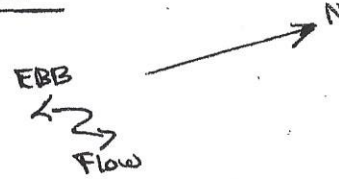

NOT TO SCALE

North East Yacht Club

80 BaySide Dr.
North East MD 21901



Town

Gourzis

41 Bay Court Dr.
North East MD 21901

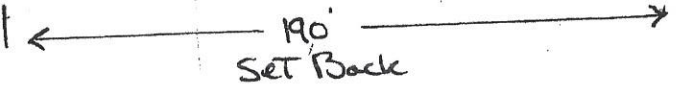
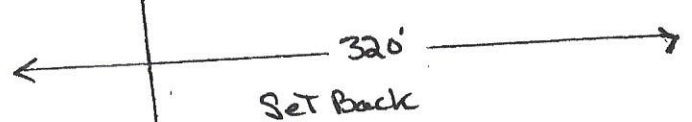

*
* Water Depths referenced TO MLLW

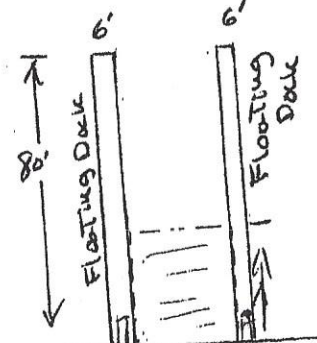

MLW
MHW

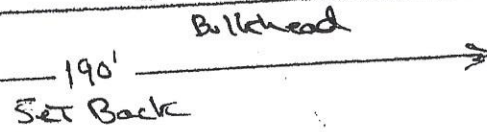

(2) 45° Timber Returns

Parcels

172, 173

Edward Trainer

22-WL-0060 & 23-WQC-0020

202260125

174118

01/02/2022

RMS



EMT Investments LLC
Parcel 77
North East, MD 2190
ED Trainer, Agent

MHW
MLW

Boat Ramp

EWT Investments
Parcel F4
North East, MD 21901
ED Trainer, Agent

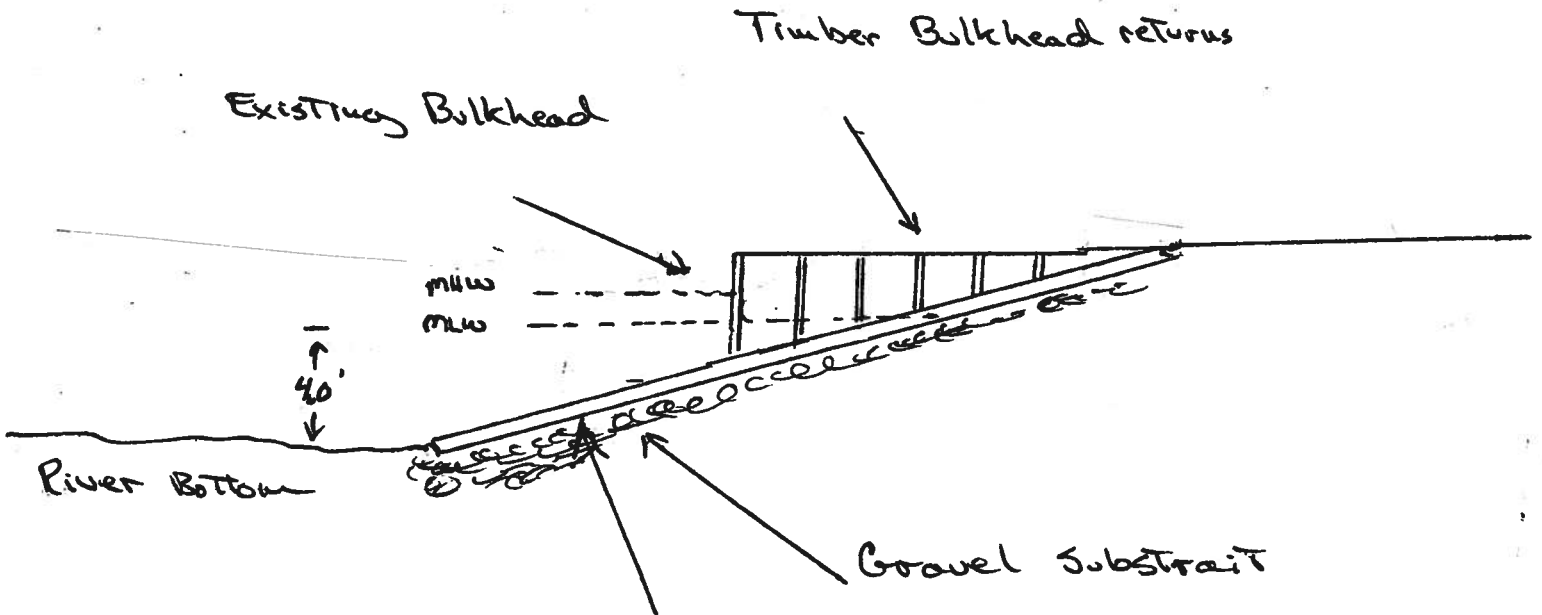

80' x 28' x 6" Thick Concrete Slab
reinforced with 1/2 rebar and woven wire

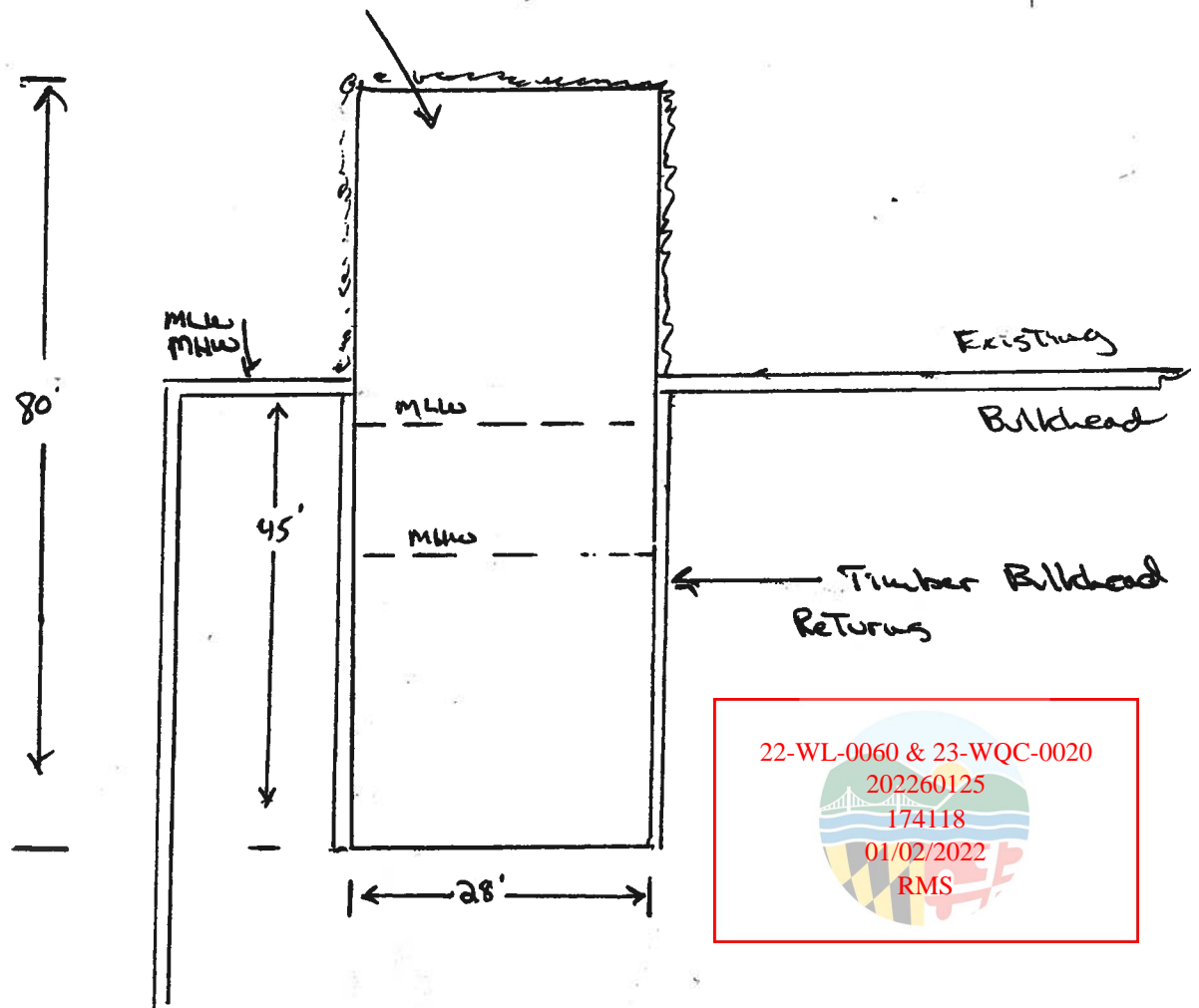

22-WL-0060 & 23-WQC-0020

202260125

174118

01/02/2022

RMS

NAB-2022-60125-1749

FMT Investments LLC
Parcel 77
NorthEast, MD 21901

Ramp CROSS SECTION

ED Falwer
Agent

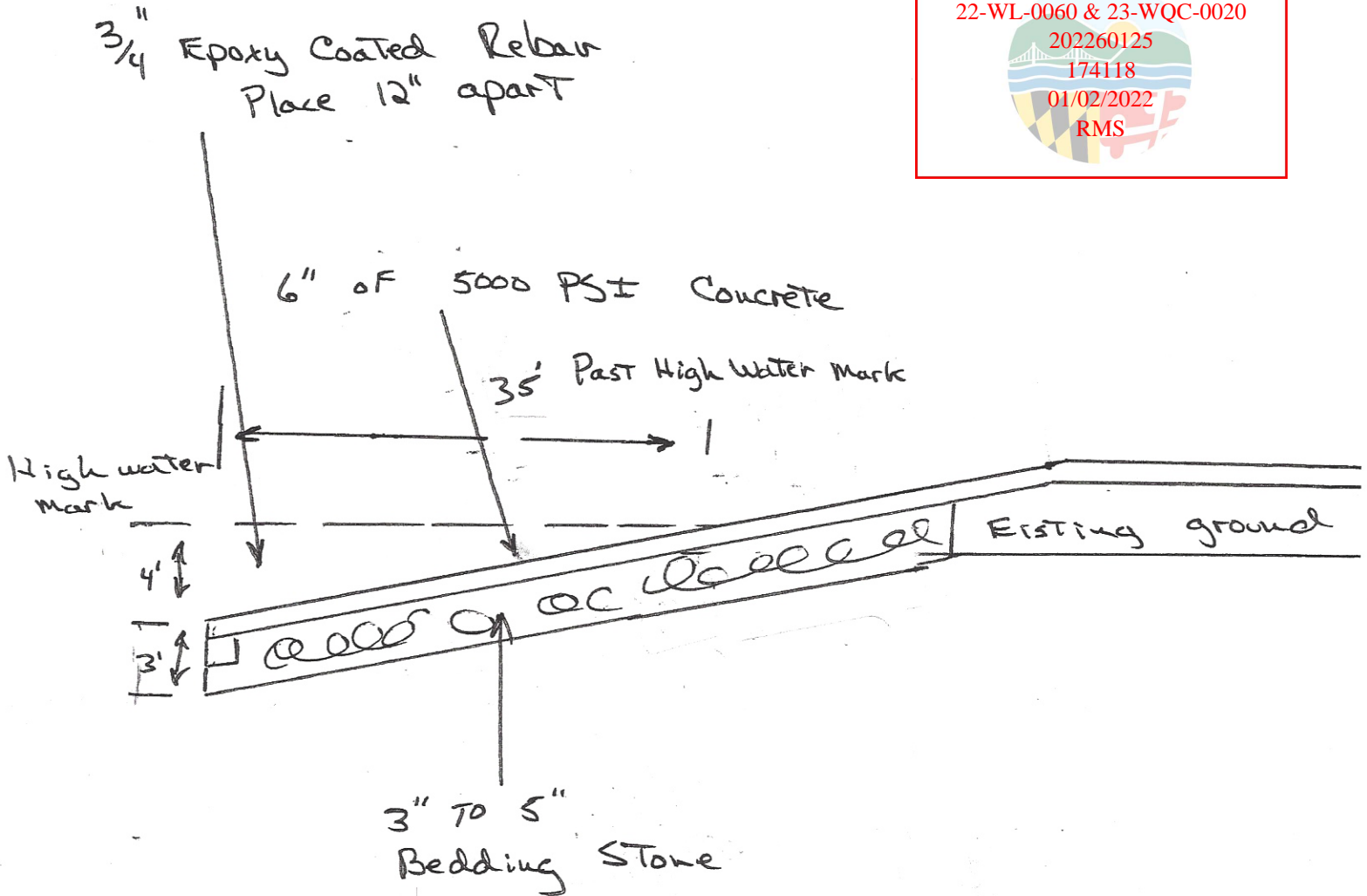

Beat Ramp returns

22-WL-0060 & 23-WQC-0020
 202260125
 174118
 01/02/2022
 RMS

2- 5/8" DIA. GALV. BOLTS WITH HD. NUT & WASHER COUNTERSUNK. TYPICAL.

5/8" DIA. GALV. BOLT
 12" LONG. TYPICAL.

TO BE FILLED WITH CLEAN SAND
 0.5 C.Y./L.F. MAXIMUM.

2" x 8" CAP

10% MAX. SLOPE

GRADE

18" MAX.

5/8" DIA. GALV. ROD W/ OGEE WASHER & HD. NUT BOTH ENDS COUNTERSUNK. TYPICAL

3'-0" MAXIMUM

6" x 6" WALERS STAGGERED, LAP AT PILE. TYPICAL

M.H.W.

M.L.W.

EXISTING SHORELINE

2" X 10" TONGUE & GROOVE SHEET PILING 8' LENGTH SPIKED FROM BEHIND WITH 30d GALVANIZED SPIKE. TYPICAL

2'-0" MIN.

6'-0" MIN. PENETRATION

12'-0" MINIMUM

BULKHEAD

EXISTING

DEAD MAN PILE 8" DIA. MIN. 8' MIN. LENGTH PENETRATE VIRGIN SOIL, 6' ON CENTER.

8" DIA. PILING ON 6' ON CENTERS.
 NOTE: ALL PILES TO BE 10 TON BEARING CAPACITY E.N.R. FORMULA. TYPICAL.



PERMITS AND DEVELOPMENT MANAGEMENT

TIMOTHY M. KOTROCO
 DIRECTOR

EMT INVESTMENTS LLC
 Parcel 77
 North East MD 21901
 Ed Trainer, Agent

REVISION
 06-29-05

DRAWN BY
 JOS VENTURINA

22-WL-0060 & 23-WQC-0020

202260125

174118

01/02/2022

RMS



Proposed Floating

Dock

Platform Dimension =
6' wide by 80' long

Minimum Height above
Substrate = 2.0'

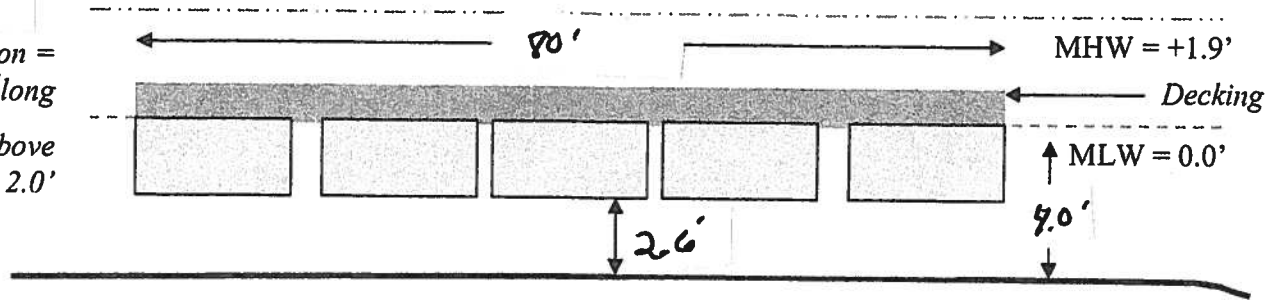

EMT Investments LLC
Parcel 7f
North East, MD 21901
ED Trainer, Agent

GANGWAY CROSS SECTION

EMT INVESTMENTS
LLC
PARCEL 77
NORTHEAST MD 21901
ED TRAINER AGENT

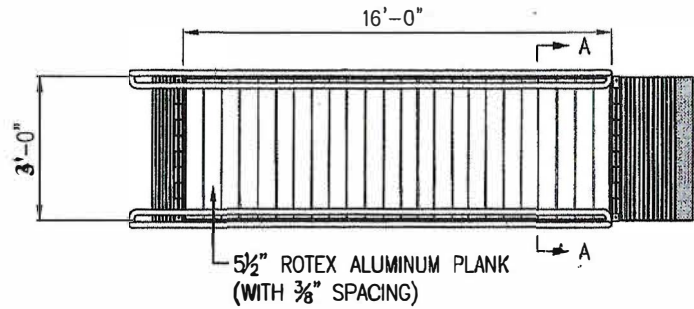

PLAN VIEW OF ALUMINUM GANGWAY

SCALE: N.T.S.

22-WL-0060 & 23-WQC-0020
202260125
174118
01/02/2022
RMS

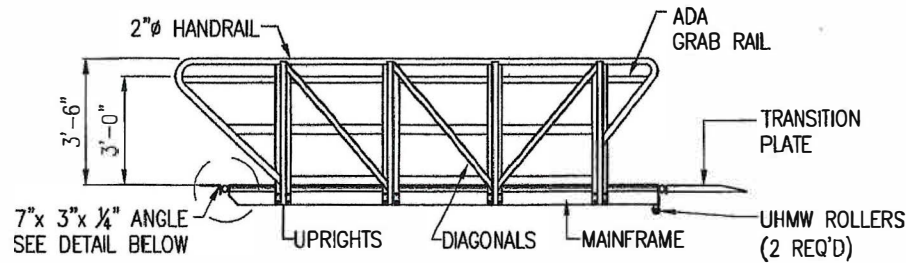

ELEVATION VIEW OF ALUMINUM GANGWAY

SCALE: N.T.S.

7" x 3" x 1/4" HINGE WIDTH
6061 ALUM. ANGLE

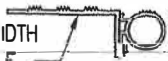

PIANO HINGE DETAIL

SCALE: N.T.S.

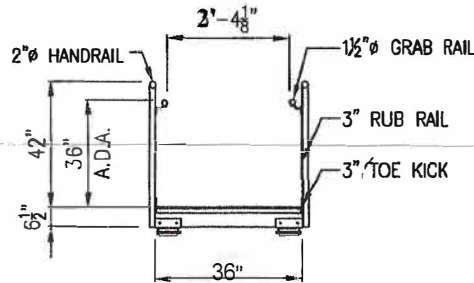

SECTION A-A

SCALE: N.T.S.

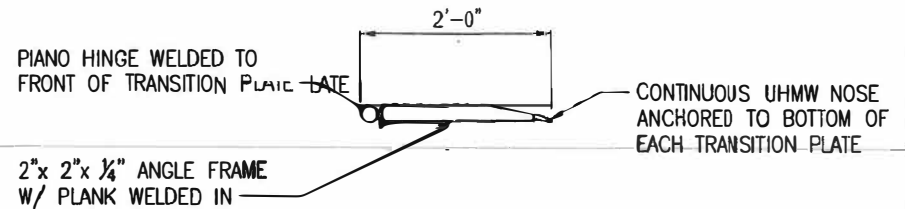

TYP. TRANSITION PLATE DETAIL

SCALE: N.T.S.

NOTES:

- BRISTOL INDUSTRIES OF PENNSYLVANIA, INC. GANGWAYS ARE FABRICATED FROM 6000 SERIES EXTRUDED ALUMINUM - INDICATED BY THE ALUMINUM ASSOCIATION OF AMERICA AS THE MOST DURABLE ALLOY IN A SALT MARINE ENVIRONMENT. ALL FASTENERS ARE STAINLESS STEEL.
- HANDRAILS ARE DESIGNED TO WITHSTAND A 200 POUND LOADING APPLIED FROM ANY DIRECTIONS AT ANY POINT ON THE HANDRAIL.
- DESIGN LIVE LOAD EXCEEDS 100 PSF.
- WALKWAY SURFACE HAS INTEGRAL "ROTEX" NON-SKID PLANKING WITH 3/8" SPACING BETWEEN PLANKS.

APPROVED	
<input type="checkbox"/> AS IS	
<input type="checkbox"/> WITH CHANGES	
SIGN: _____	DATE: _____

DISCLAIMER
INFORMATION CONTAINED HEREIN IS PROPRIETARY TO BRISTOL INDUSTRIES OF PENNSYLVANIA, INC. AND IS NOT TO BE COPIED, ALTERED, USED OR DISCLOSED IN ANY MANNER WITHOUT WRITTEN CONSENT OF BRISTOL INDUSTRIES OF PENNSYLVANIA, INC.

NUM:	DATE:	REVISIONS:
BRISTOL INDUSTRIES OF PENNSYLVANIA INC.		
PROJECT:		
TITLE:		SCALE: N.T.S.
3' x 16' ADA GANGWAY		DRAWN BY: G.T.C.
		DWG NUM:
		3x16

