

NOTE: LEGEND ON SHEET SC08

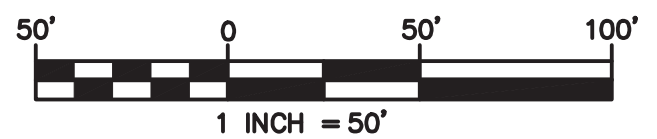

CONTRACTOR:
 GILBANE BUILDING COMPANY
 1215 EAST FORT AVENUE
 BALTIMORE, MD 21230
 email: MRICKETTS@GILBANE.CO

OWNER:
 THE BOARD OF EDUCATION OF
 PRINCE GEORGE'S COUNTY
 C/O JASON WASHINGTON
 LOUIS WILSON SR., FACILITIES ADMIN BUILDING
 13300 OLD MARLBORO PIKE
 UPPER MARLBORO, MD 20772
 email: JASON.WASHINGTON@PGCPS.ORG

PROFESSIONAL CERTIFICATION
 I HEREBY CERTIFY THAT THESE DOCUMENTS WERE PREPARED OR APPROVED BY ME, AND THAT I AM A DULY LICENSED PROFESSIONAL ENGINEER UNDER THE LAWS OF THE STATE OF MARYLAND.
 LICENSE NO. 11391 EXPIRATION DATE: 03-25-2023

No.	REVISION	DATE	BY

6110 Frost Place
 Laurel, MD 20707-2927
 tel: 301-992-2829
 ol.amold@stantec.com
 www.stantec.com

The Contractor shall verify and be responsible for all dimensions. DO NOT scale the drawing or any errors or omissions shall be reported to Stantec without delay. The Copyrights to all designs and drawings are the property of Stantec. Reproduction or use for any purpose other than that authorized by Stantec is forbidden.

PRINCE GEORGE'S COUNTY PUBLIC SCHOOL
NEW SOUTHERN AREA K-8
 COMBINED CONCEPT AND ENVIRONMENTAL SITE DEVELOPMENT
 GRADING, EROSION AND SEDIMENT CONTROL
INITIAL PHASE
 PRINCE GEORGE'S COUNTY, MARYLAND

RLP/GMHA DESIGN	SCALE	1"=50'
GMHA DRAWN	SC02	
KHN/AKA		
CHECKED	SHEET	2 OF 10
DATE	APR 2021	PROJ No.
	218320533	FILE No.

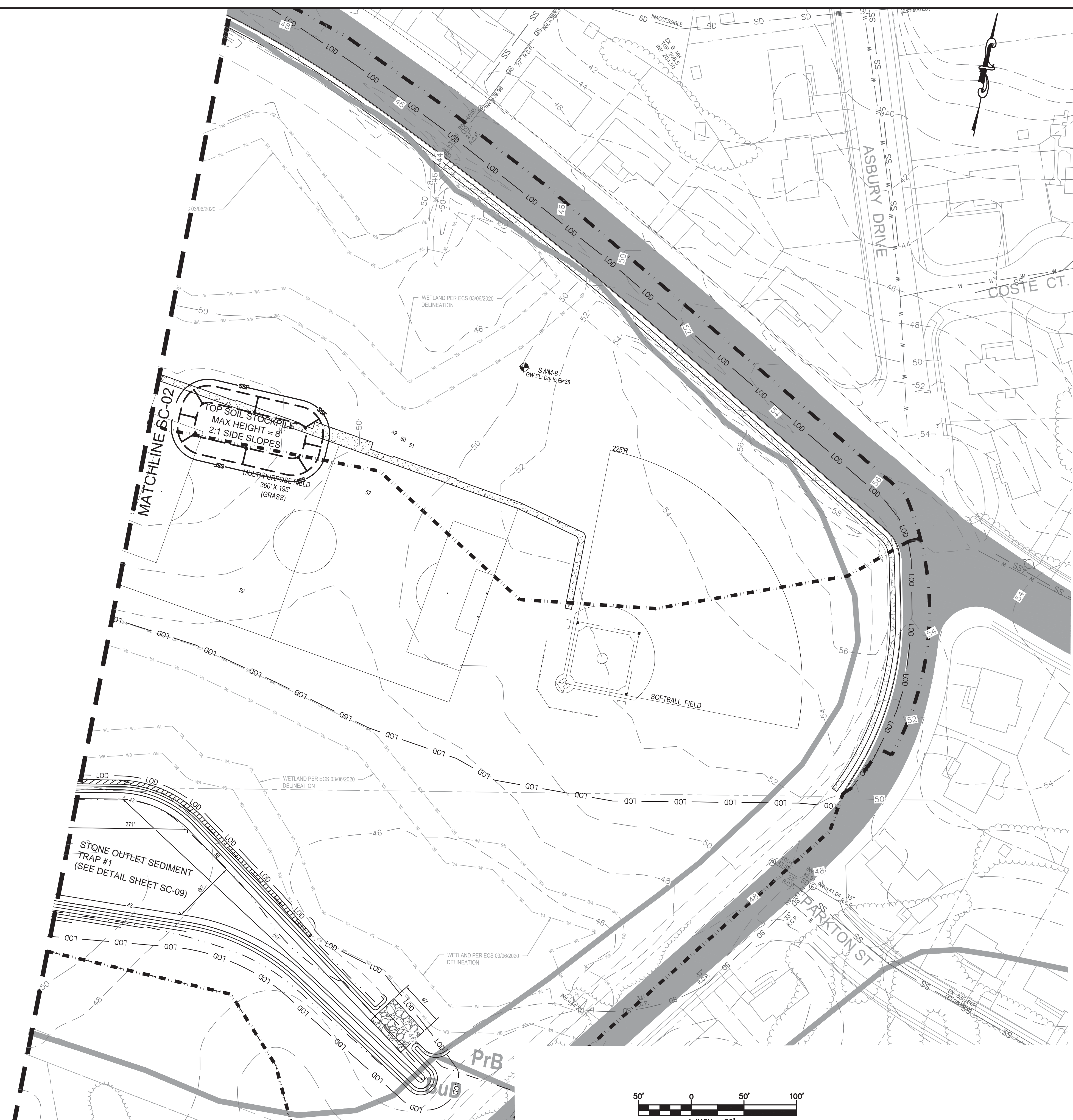

V:\2024\MISCELLANEOUS\182024\PGCS\88P\DCP12A\700 CAD\DRAWINGS_SOUTHERN AREA K8_SCS_EROSION AND SEDIMENT CONTROL INITIAL.DWG

CONTRACTOR:
 GILBANE BUILDING COMPANY
 1215 EAST FORT AVENUE
 BALTIMORE, MD 21230
 email: MRICKETTS@GILBANE.CO

OWNER:
 THE BOARD OF EDUCATION OF
 PRINCE GEORGE'S COUNTY
 C/O JASON WASHINGTON
 LOUIS WILSON SR., FACILITIES ADMIN BUILDING
 13300 OLD MARLBORO PIKE
 UPPER MARLBORO, MD 20772
 email: JASON.WASHINGTON@PGCS.ORG

PROFESSIONAL CERTIFICATION
 I HEREBY CERTIFY THAT THESE DOCUMENTS WERE PREPARED OR APPROVED BY ME, AND THAT I AM A DULY LICENSED PROFESSIONAL ENGINEER UNDER THE LAWS OF THE STATE OF MARYLAND.
 LICENSE NO. 11391 EXPIRATION DATE: 03-25-2023

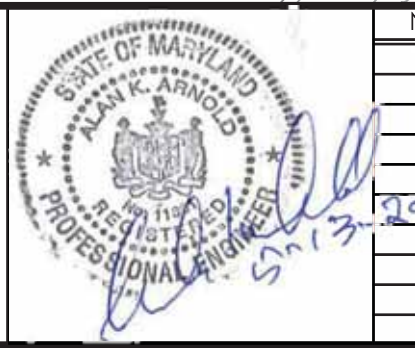

No.	REVISION	DATE	BY

6110 Frost Place
 Laurel, MD 20707-2927
 tel: 301-992-2829
 ol.amold@stantec.com
 www.stantec.com

The Contractor shall verify and be responsible for all dimensions. DO NOT scale the drawing or any errors or omissions that are reported to Stantec without delay. The Copyright to all designs and drawings are the property of Stantec. Reproduction or use for any purpose other than that authorized by Stantec is forbidden.

PRINCE GEORGE'S COUNTY PUBLIC SCHOOL
NEW SOUTHERN AREA K-8
 COMBINED CONCEPT AND ENVIRONMENTAL SITE DEVELOPMENT
 GRADING, EROSION AND SEDIMENT CONTROL
INITIAL PHASE
 PRINCE GEORGE'S COUNTY, MARYLAND

RLP/GMHA DESIGN	SCALE	1"=50'
GMHA DRAWN	SC03	
KHN/AKA		
CHECKED	SHEET	3 OF 10
DATE	PROJ No.	FILE No.

BMP No.	Proposed Drainage Area (AC)
ESD-1	0.36
ESD-2	0.47
ESD-3	0.44
ESD-4	0.44
ESD-5	0.42
ESD-6	0.42
ESD-7	0.53
BMP-8	3.98
BMP-9	9.14

NOTE: SGW#2 PRETREATMENT CELL #2 CONTROL STRUCTURE IS A 6' X 6' RISER W/ 24' OF WEIR, CREST AT 49.5
10-YR WSEL = 49.79
100-YR WSEL = 49.94

NOTE: SGW #1 LOW FLOW CENTRAL CONSISTS OF A PERFORATED 12" PVC LOCATED WITHIN THE GRAVEL BED CONNECTED TO A VERTICAL 12" PVC CONNECTED TO A HORIZONTAL 12" PVC (INV = 49.0) THAT OUTLETS INTO ONE OF THE 3 INLET STRUCTURES. THE 3 - 4'X4' INLET STRUCTURES EACH WITH SLAB ON 3 SIDES PROVIDE THE OVERFLOW CENTRAL.

EMBANKMENT, 6' TOP WIDTH, CONSTRUCTED TOP ELEV = 48.9

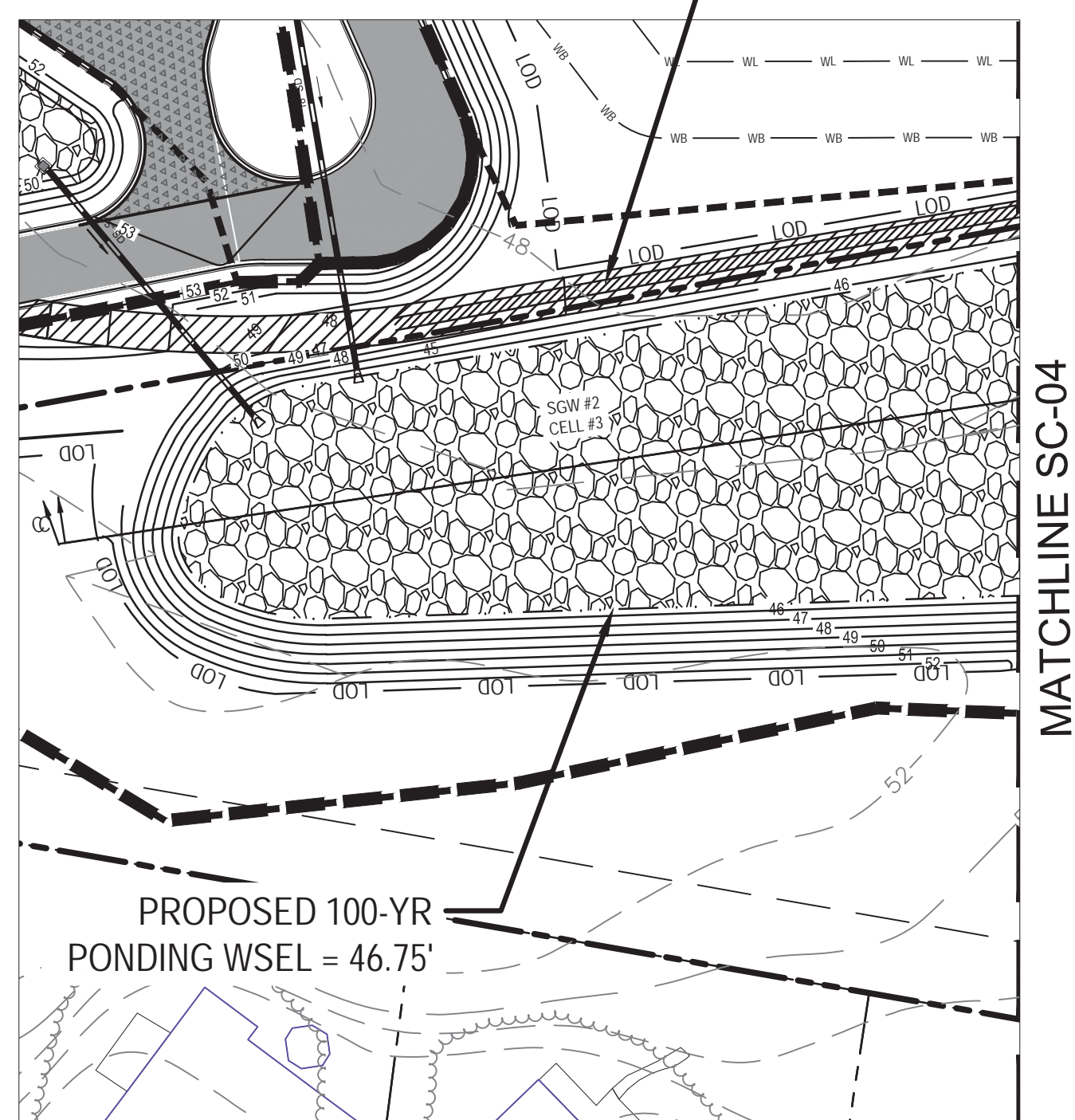

NOTE: ENTIRE SUBMERGED GRAVEL WETLAND IS IN CUT. SEDIMENT TRAP BOTTOM = 43.0
SURFACE OF SGW = 45.33
BOTTOM OF EXCAVATION = 42.0
10-YR WSEL = 46.51
100-YR WSEL = 46.75

NOTE: SGW #2 PRETREATMENT CELL #1. CONTROL STRUCTURE IS 2.5' X 2.5' INLET W/ 10' WEIR, CREST AT ELEV 50.0.
10-YR WSEL = 50.23
100-YR WSEL = 50.35

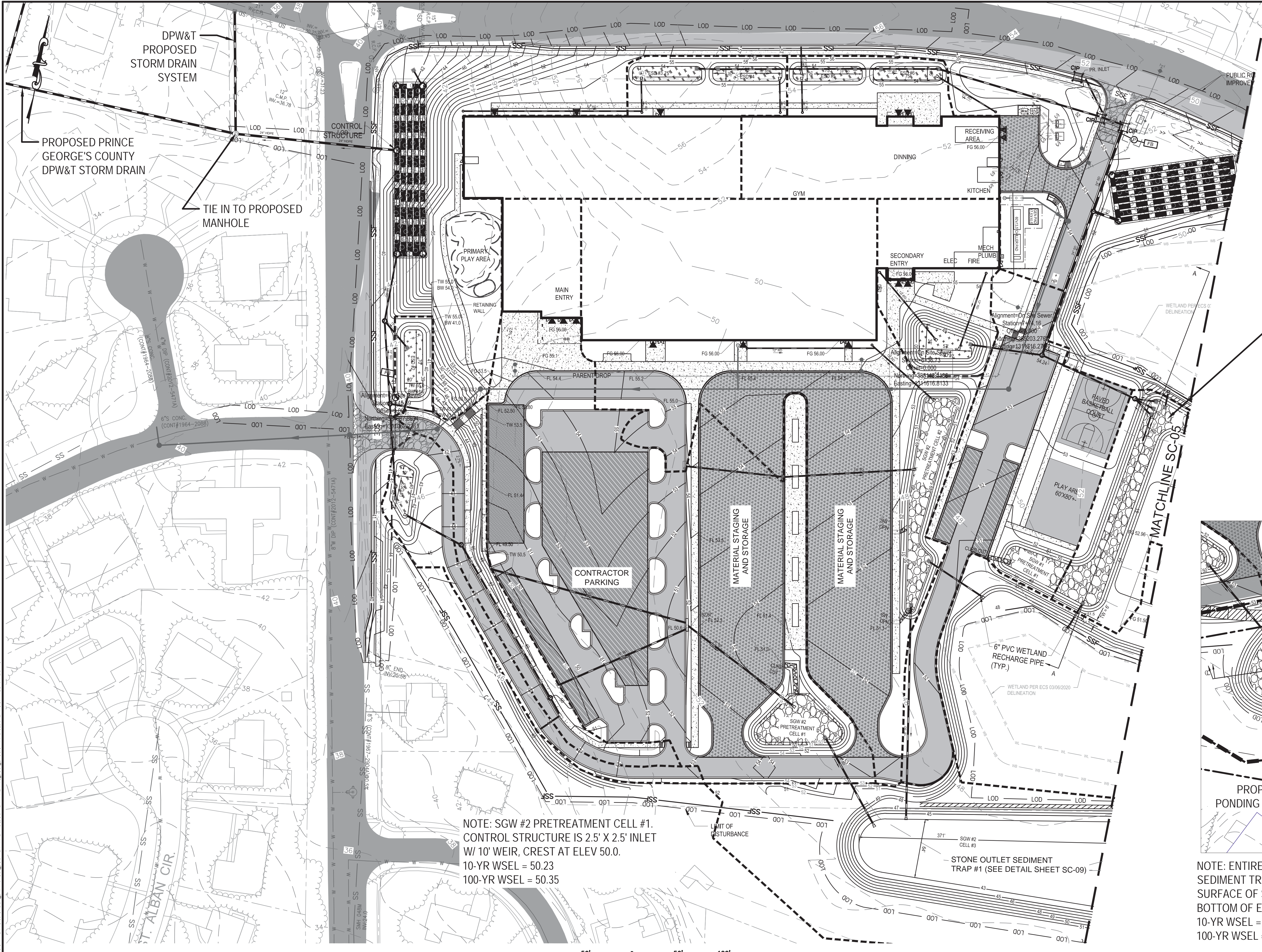
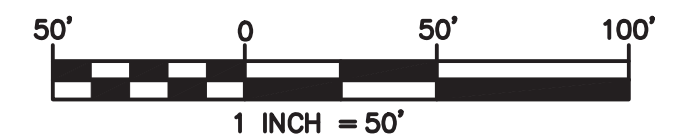

CONTRACTOR:
GILBANE BUILDING COMPANY
1215 EAST FORT AVENUE
BALTIMORE, MD 21230
email: MRICKETTS@GILBANECO.COM

OWNER:
THE BOARD OF EDUCATION OF
PRINCE GEORGE'S COUNTY
C/O JASON WASHINGTON
LOUIS WILSON SR., FACILITIES ADMIN BUILDING
13300 OLD MARLBORO PIKE
UPPER MARLBORO, MD 20772
email: JASON.WASHINGTON@PGPCS.ORG

PROFESSIONAL CERTIFICATION
I HEREBY CERTIFY THAT THESE DOCUMENTS WERE PREPARED OR APPROVED BY ME, AND THAT I AM A DULY LICENSED PROFESSIONAL ENGINEER UNDER THE LAWS OF THE STATE OF MARYLAND.
LICENSE NO. 11391 EXPIRATION DATE: 03-25-2033



No.	REVISION	DATE	BY

Stantec
6110 Frost Place
Laurel, MD 20707-2927
tel: 301-992-2829
ol.amold@stantec.com
www.stantec.com

The Contractor shall verify and be responsible for all dimensions. DO NOT scale the drawing or any errors or omissions shall be reported to Stantec without delay. The Copyright to all designs and drawings are the property of Stantec. Reproduction or use for any purpose other than that authorized by Stantec is forbidden.

PRINCE GEORGE'S COUNTY PUBLIC SCHOOL
NEW SOUTHERN AREA K-8
COMBINED CONCEPT AND ENVIRONMENTAL SITE DEVELOPMENT
GRADING, EROSION AND SEDIMENT CONTROL
FINAL PHASE
PRINCE GEORGE'S COUNTY, MARYLAND

RLP/GMHA DESIGN	SCALE 1"=50'
GMHA DRAWN	SC04
KHN/AKA CHECKED	
APR 2021 DATE	SHEET 4 OF 10
218320533 PROJ No.	FILE No.

V:\2020\MICELANOVIC\118320533\118320533.DWG\118320533.DWG (SOUTHERN AREA K-8) SCW EROSION AND SEDIMENT CONTROL FINAL.DWG

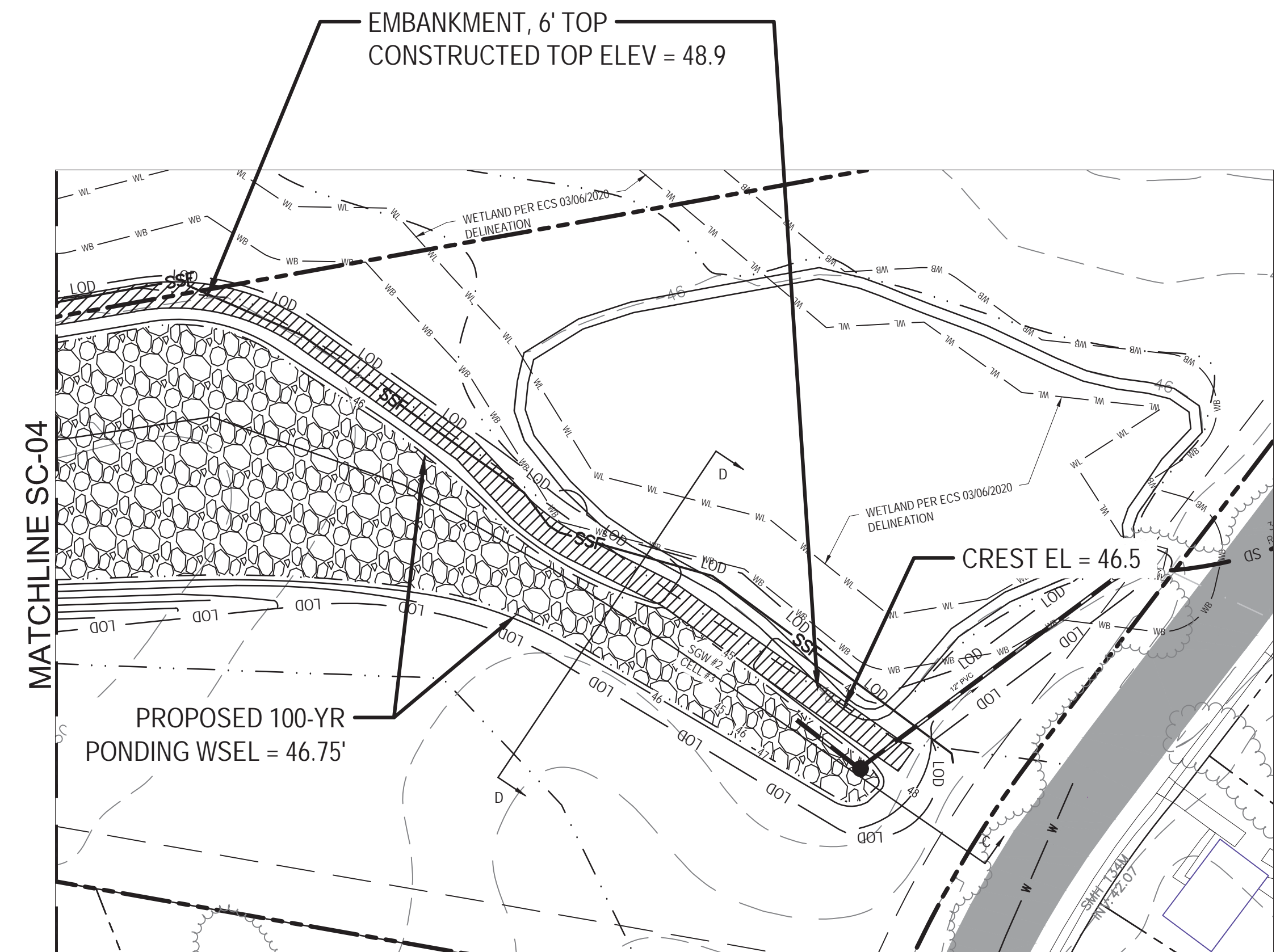
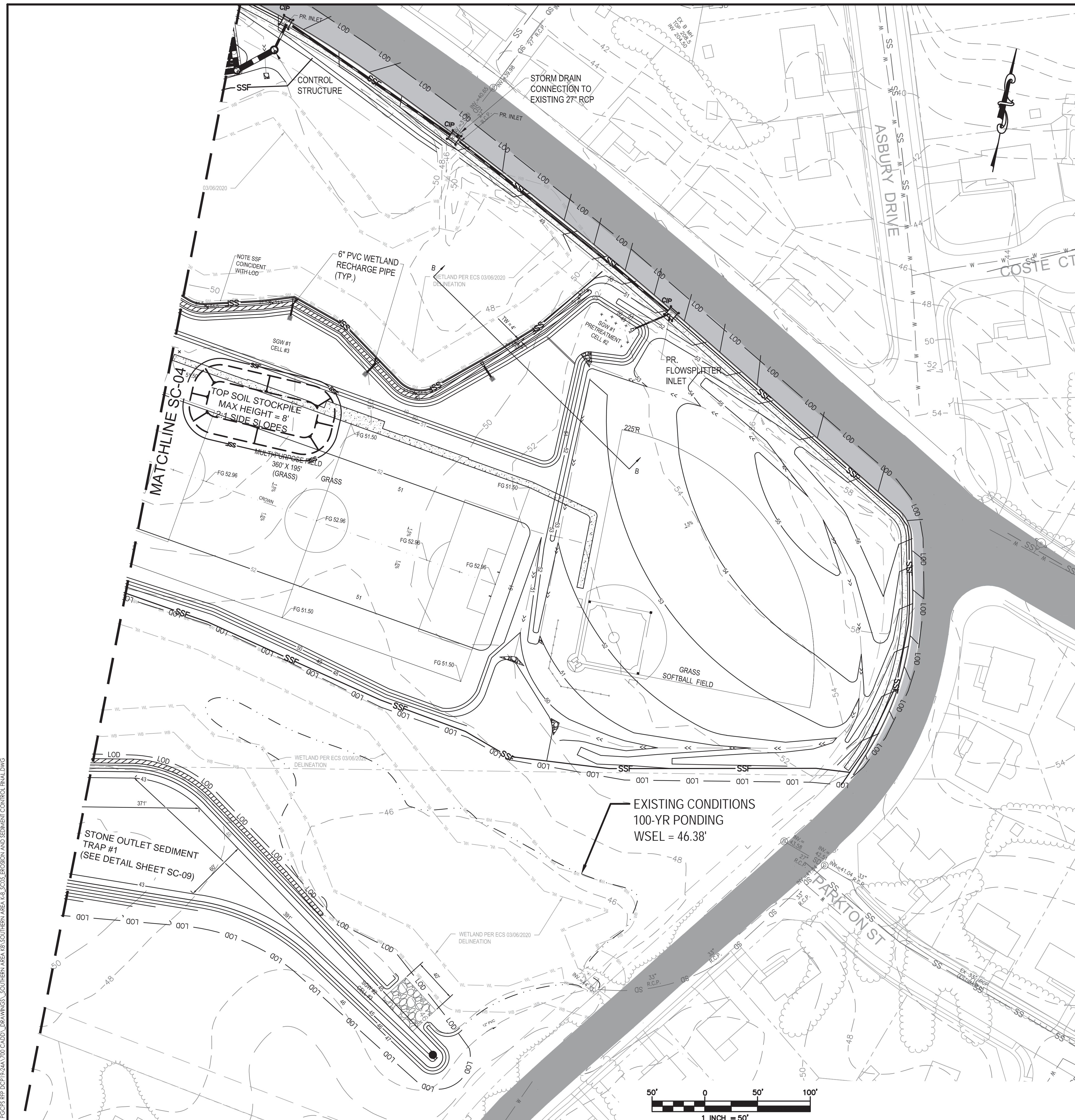

NOTE: ENTIRE SUBMERGED GRAVEL WETLAND IS IN CUT. SEDIMENT TRAP BOTTOM = 43.0
 SURFACE OF SGW = 45.33
 BOTTOM OF EXCAVATION = 42.0
 10-YR WSEL = 46.51
 100-YR WSEL = 46.75

NOTE: SGW #2 LOW FLOW CENTRAL CONSISTS OF A PERFORATED 12" PVC LOCATED WITHIN THE GRAVEL BED CONNECTED TO A VERTICAL 12" PVC, CONNECTED TO A HORIZONTAL 12" PVC

CONTRACTOR:
 GILBANE BUILDING COMPANY
 1215 EAST FORT AVENUE
 BALTIMORE, MD 21230
 email: MRICKETTS@GILBANE.CO

OWNER:
 THE BOARD OF EDUCATION OF
 PRINCE GEORGE'S COUNTY
 C/O JASON WASHINGTON
 LOUIS WILSON SR., FACILITIES ADMIN BUILDING
 13300 OLD MARLBORO PIKE
 UPPER MARLBORO, MD 20772
 email: JASON.WASHINGTON@PGPCS.ORG

PROFESSIONAL CERTIFICATION
 I HEREBY CERTIFY THAT THESE DOCUMENTS WERE PREPARED OR APPROVED BY ME, AND THAT I AM A DULY LICENSED PROFESSIONAL ENGINEER UNDER THE LAWS OF THE STATE OF MARYLAND.
 LICENSE NO. 11391 EXPIRATION DATE: 03-25-2023

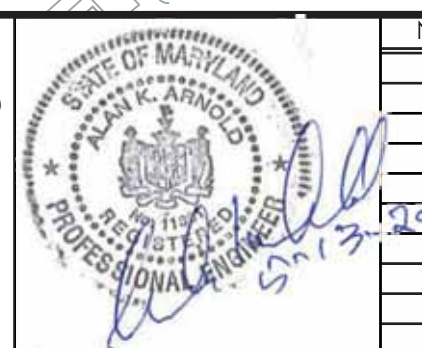

No.	REVISION	DATE	BY

Stantec
 6110 Frost Place
 Laurel, MD 20707-2927
 tel: 301-992-2829
 ol.amold@stantec.com
 www.stantec.com

The Contractor shall verify and be responsible for all dimensions. DO NOT scale the drawing or any errors or omissions shall be reported to Stantec without delay. The Copyright to all designs and drawings are the property of Stantec. Reproduction or use for any purpose other than that authorized by Stantec is forbidden.

PRINCE GEORGE'S COUNTY PUBLIC SCHOOL
NEW SOUTHERN AREA K-8
 COMBINED CONCEPT AND ENVIRONMENTAL SITE DEVELOPMENT
 GRADING, EROSION AND SEDIMENT CONTROL
FINAL PHASE
 PRINCE GEORGE'S COUNTY, MARYLAND

RLP/GMHA DESIGN	SCALE	1"=50'
GMHA DRAWN	SC05	
KHN/AKA		
CHECKED	SHEET	5 OF 10
DATE	PROJ No	218320533
	FILE No.	