



Maryland
Department of
the Environment

Wes Moore, Governor
Aruna Miller, Lt. Governor

Serena McIlwain, Secretary
Suzanne E. Dorsey, Deputy Secretary

September 29, 2023

United States Coast Guard
Facilities Engineering, Coast Guard Yard
2401 Hawkins Point Road
Baltimore, MD 21226
Attn. LT Holly Moore

Via email: holly.m.moore@uscg.mil

Re: Agency Interest Number: 173604
Tracking Number: 202261295
Water Quality Certification Number: 23-WQC-0012

Dear LT Moore:

After examination and consideration of the documents received and evidence in the file and record for dredging at the US Coast Guard Yard, the Water and Science Administration has determined that the project meets the statutory and regulatory criteria necessary for issuance of an individual Water Quality Certification (WQC).

The individual WQC for this project issued by the Maryland Department of the Environment (Department) is attached. Please read and review the WQC for this project to ensure that you understand the limits of the certified project and all of the general and special conditions. The attached WQC is a final agency decision. Any person aggrieved by the Department's decision to issue this WQC may appeal such a decision in accordance with COMAR 26.08.02.10F(4). A request for appeal shall be filed with the Department within 30 days of publication of the final decision and specify in writing the reason why the final decision should be reconsidered. A request for appeal shall be submitted to: Secretary of the Environment, Maryland Department of the Environment, 1800 Washington Boulevard, Baltimore, MD 21230. Any request for an appeal does not stay the effectiveness of this WQC.

You should not begin any work until you have obtained all necessary State, local, and federal authorizations. Please do not hesitate to contact me at danielle.spendiff1@maryland.gov or 410-537-4023 with any questions.

Sincerely,

Danielle A. Spendiff, Chief
Regulatory and Customer Service Division



STATE OF MARYLAND
DEPARTMENT OF THE ENVIRONMENT
WATER AND SCIENCE ADMINISTRATION



WATER QUALITY CERTIFICATION
23-WQC-0012

EFFECTIVE DATE: **September 28, 2023**

CERTIFICATION HOLDER: **United States Coast Guard
Facilities Engineering, Coast Guard Yard
2401 Hawkins Point Road
Baltimore, MD 21226
Attn: LT Holly Moore**

PROJECT LOCATION: **Coast Guard Yard
2401 Hawkins Point Road
Baltimore, MD 21226
(Anne Arundel County, Maryland)**

UNDER AUTHORITY OF SECTION 401 OF THE FEDERAL WATER POLLUTION CONTROL ACT AND ITS AMENDMENTS AND IN ACCORDANCE WITH §9-313 THROUGH §9-323, INCLUSIVE, OF THE ENVIRONMENT ARTICLE, ANNOTATED CODE OF MARYLAND, THE WATER AND SCIENCE ADMINISTRATION (“ADMINISTRATION”) HAS DETERMINED THAT THE REGULATED ACTIVITY DESCRIBED IN THE REQUEST FOR CERTIFICATION OF DREDGING AT THE US COAST GUARD YARD WILL NOT VIOLATE MARYLAND’S WATER QUALITY STANDARDS IF CONDUCTED IN ACCORDANCE WITH ALL TERMS AND CONDITIONS OF THIS CERTIFICATION.

THIS CERTIFICATION DOES NOT RELIEVE THE APPLICANT OF RESPONSIBILITY FOR OBTAINING ANY OTHER APPROVALS, LICENSES, OR PERMITS IN ACCORDANCE WITH FEDERAL, STATE, OR LOCAL REQUIREMENTS AND DOES NOT AUTHORIZE COMMENCEMENT OF THE PROPOSED PROJECT. A COPY OF THIS REQUIRED CERTIFICATION HAS BEEN SENT TO THE US ARMY CORPS OF ENGINEERS (CORPS). THE CERTIFICATION HOLDER SHALL COMPLY WITH THE CONDITIONS LISTED BELOW.

PROJECT DESCRIPTION

The US Coast Guard (USCG) proposes maintenance and improvement dredging of the existing federal channel, turning basin, vessel berths and shiplift area in an area extending from the Interstate 695 bridge (i.e., the Bascule Bridge) to USCG Yard’s Pier 3 in Curtis Creek/Bay, Arundel Cove, for improved navigable access to the USCG Yard. USCG proposes to mechanically dredge approximately 53.04 acres of the existing federal channel, the turning basin,

23-WQC-0012

and vessel berths to -28.75 feet below mean low water and to hydraulically dredge approximately 1.28 acres of shiplift area to -35.50 feet below mean low water and deposit approximately 479,117 cubic yards of dredged material at either Masonville or Cox Creek Dredged Material Containment Facility (DMCF). The following activities are proposed:

- 1) Hydraulic dredging (shiplift): To hydraulically dredge the approximately 1.28 acre shiplift area to an approximate depth of -35.50 feet below mean low water and deposit approximately 9,294 cubic yards of material to the above DMCF.
- 2) Mechanical dredging (channel): To mechanically dredge the approximately 21.79 acre federal channel to an approximate depth of -28.75 feet below mean low water and deposit approximately 180,389 cubic yards of material to the above DMCF.
- 3) Mechanical dredging (turning basin): To mechanically dredge the approximately 26.81 acre turning basin to an approximate depth of -28.75 feet below mean low water and deposit approximately 273,508 cubic yards of material to the above DMCF.
- 4) Mechanical dredging (berths): To mechanically dredge the approximately 4.44 acre berthing areas to an approximate depth of -28.75 feet below mean low water and deposit approximately 15,926 cubic yards of material to the above DMCF.

This Water Quality Certification (Certification) is issued under authority of Section 401 of the Federal Water Pollution Control Act and its Amendments, Title 9, Subtitle 3 of the Environment Article, and Code of Maryland Regulations (COMAR) 26.08.02.10. The Maryland Department of the Environment (Department) has determined from a review of the request application file that the project activities described in the above will not violate Maryland's water quality standards, provided that the following conditions are satisfied.

The Certification Holder shall comply with the following conditions:

SPECIAL CONDITIONS

1. Dredging activities are prohibited from February 15th through June 15th of any year to protect spawning fish.
2. Dredging may not exceed the scope of this Certification in terms of authorized dredge area, volume of material, and authorized depths.
3. Conduct a post dredge bathymetric survey and forward to the Water and Science Administration, Regulatory and Customer Service Division within 45 days after the termination of dredging operations and submit documentation to the Corps that the Certification Holder has satisfied the Departments requirements.
4. Transport all dredged material in watertight trucks. No dredged material shall be discharged onto the roadways of the State.
5. If work is not conducted by the Certification Holder, all work performed under this Water Quality Certification shall be conducted by a marine contractor licensed by the Marine Contractors Licensing Board (MCLB) in accordance with Title 17 of the Environment Article of Annotated Code of Maryland. Licensing by MCLB shall occur prior to the

beginning of dredging activities. A list of licensed marine contractors may be obtained by contacting the MCLB at 410-537- 3249, by e-mail at MDE.MCLB@maryland.gov or by accessing the Maryland Department of the Environment, Environmental Boards webpage.

6. Dredged material pipelines shall be installed, marked and maintained in accordance with all requirements for navigational safety. Dredge material pipelines and associated equipment shall be removed as soon as practicable, upon completion of activities authorized under this Certification.
7. In the event of any inadvertent returns resulting from failure of any dredge material pipeline and associated equipment, the Certification Holder shall cease operations immediately and shall:
 - a) Take steps to stop all dredged material from entering State waters; and
 - b) Notify the Compliance Program immediately at 410-537-3510.
8. Dredged material shall only be disposed of at the dredge disposal site approved by this Certificate. The Certification Holder shall submit an application for modification of the Certification to MDE for approval of any dredge disposal site not authorized within the Certification.

GENERAL CONDITIONS

1. Meet all water quality-related performance standards and conditions required by the Department in any State-issued authorization for activities in Waters of the United States to ensure that any discharges will comply with water quality standards in COMAR 26.08.02 and other water quality requirements of State law or regulation.
2. Avoid placing structures or conducting activities that entangle or interfere with the movement of aquatic life, fish, or other wildlife.
3. Prevent the spread of non-native species that may cause adverse effects on the aquatic ecosystem.
4. Implement and comply with all final approved plans, permits, and modifications that are approved by the State and/or the Corps, as applicable. The approved plans, permits and modifications by MDE and/or the Corps are incorporated by reference into this Certification.
5. Meet the requirements in Annotated Code of Maryland, Environment Article, Title 4 and COMAR 26.17.01, including obtaining and complying with an approved erosion and sediment control plan, and following the stabilization requirements set forth in COMAR 26.17.01.07 and the “2011 Maryland Standards and Specifications for Soil Erosion and Sediment Control (2011 Standards)” as amended.
6. Limit any disturbance of the substrate to the authorized area and prevent sediment transport into adjacent State waters.
7. Remove and dispose of all unused fill and construction materials in a manner which will prevent their entry into waters of this State.
8. Avoid placing stockpiles of any material in Waters of the U.S. or waters of the state, unless otherwise authorized by the approving authority.

9. Obtain any other authorizations or approvals that the Department requires, including General Permits, and comply with all conditions of such authorizations or approvals.
10. Obtain any required authorizations or approvals from other State, federal, or local agencies.
11. Refrain from causing any injury to private property, invasion of rights, or infringement of federal, State, or local laws or regulations.
12. Inspection and entry. The Certification Holder shall allow the Department, or an authorized representative, upon the presentation of credentials and other documents as may be required by law, to:
 - a. Enter upon the Certification Holder's premises where a certified activity or operation is located or conducted, or where records must be kept under the conditions of this Certification;
 - b. Have access to and copy, at reasonable times, any records that must be kept under the conditions of this Certification;
 - c. Inspect at reasonable times any facilities, equipment (including monitoring and control equipment), practices, or operations regulated or required under this Certification; and
 - d. Sample or monitor at reasonable times, for the purposes of assuring compliance or as otherwise authorized by the Department, any substances or parameters at any location.
 - e. Allow the Department's authorized representatives access to the Project during normal business hours to conduct inspections and evaluations of operations and records to verify compliance with this Certification.

STATEMENTS OF NECESSITY AND CITATIONS

1. Statement of Necessity for Special Condition 1: The time of year restriction is necessary to maintain the designated use- support of estuarine and marine aquatic life and shellfish harvesting.

Citation: Federal and state laws which authorize this condition include but are not limited to: COMAR: 26.08.02.02B(1)(d); 26.08.02.02B(3); COMAR 26.08.02.02-1

2. Statement of Necessity for Special Conditions 2 & 3: The limits on the scope of dredging are necessary to ensure that no discharges would violate water quality standards and designated uses for water clarify, turbidity, growth and propagation of fish, other aquatic life, and wildlife; and water contact recreation

Citations: COMAR 26.08.02.02B(1)(d); COMAR 26.08.02.02B(3); COMAR 26.08.02.03B

3. Statement of Necessity for Special Condition 3: The condition is necessary to ensure that discharges associated with dredging result in water depths which are appropriate to support designated uses of fishing and water contact recreation and propagation of fish, other aquatic life and wildlife; and ensure that no discharges are unsightly, create a nuisance, change to an objectionable color or interferes with designated uses.

Citations: COMAR 26.08.02.01B(2); COMAR 26.08.02.02B(1); 26.08.02.02B(3); COMAR 26.08.02.03B

4. Statement of Necessity for Special Conditions 4 & 7: Unauthorized discharges may enter regulated waters as result of activity or structural failure. The condition is necessary to ensure that water quality standards are met under unique circumstances for inadvertent discharges and that designated uses of waters are maintained. Releases of significant amounts of sediment can impact aquatic environments and if unchecked can alter them to an uninhabitable state.

Citation: Federal and state laws that authorize this condition include but are not limited to: 33 U.S.C. § 1341(a), (b), & (d); 33 U.S.C. § 1251(b); 33 U.S.C. § 1370; Md. Ann. Code, Env. Article, Title 1, Subtitles 3 & 4; Md. Ann. Code, Env. Article, Title 9, Subtitle 3; Md. Ann. Code, Env. Article, Title 9, Subtitle 3; Md. Ann. Code, Env. Article, Title 5, Subtitles 5 and 9; Md. Ann. Code, Env. Article, Title 9, Subtitle 3; Md. Ann. Code, Env. Article, Title 16; COMAR 26.08; COMAR 26.08.02.10G(3); COMAR 26.17.04; COMAR 26.23; COMAR 26.24; COMAR 26.23.02.06, COMAR 26.08, COMAR 26.08.02.10E; COMAR 26.08.02.09C(3); COMAR 26.08.02.03B(1)(b); COMAR 26.08.02.03B(2); COMAR 26.08.02.03-3; COMAR 26.08.02.02B(2); COMAR 26.08.02.02B(4); COMAR 26.08.02.02B(6); COMAR 26.08.02.02B(8)

5. Statement of Necessity for Special Condition 5: Expertise for conducting certain activities is required to ensure that there is no violation of water quality standards nor interference with designated uses. This condition is necessary to ensure that discharges will be conducted in a manner which does not violate water quality criteria nor interfere with designated uses.

Citation: COMAR 26.08.02.02B(2)- B(4); COMAR 26.08 02.03B(2)(d) – (e); COMAR 26.08.02.03B(1)(b); 26.08.02.03B(2); COMAR 23.02.04.04

6. Statement of Necessity for Special Condition 6: The condition is necessary to ensure that the discharge does not interfere with navigational safety and designated uses for water contact recreation and fishing, nor create a nuisance.

Citation: COMAR 26.08.02.01B(1) and B(2); COMAR 26.08.02.03B(1)(a); COMAR 26.08.02.03B(2)(d)

7. Statement of Necessity for Special Condition 8 & General Conditions 4, 9, 10, 11: These conditions are necessary to clarify the scope of this certification to ensure compliance with water quality regulations, without limiting restrictions through other requirements that also affect water quality.

Citation: Federal and state laws which authorize this condition include but are not limited to: 33 U.S.C. § 1341(a), (b), & (d); 33 U.S.C. § 1251(b); 33 U.S.C. § 1370; Md. Ann. Code, Env. Article, Title 1, Subtitles 3 and 4; Md. Ann. Code, Env. Article, Title 5, Subtitles 5 and 9; Md. Ann. Code, Env. Article, Title 9, Subtitle 3; Md. Ann. Code, Env.

Article, Title 16; COMAR 26.08, COMAR 26.08.02.10E; COMAR 26.23.02.06; COMAR 26.17.04; COMAR 26.23; COMAR 26.24

8. Statement of Necessity for General Condition 1, 2, 3: The condition is necessary to ensure that water quality standards are met and designated uses are maintained.

Citations: Federal and state laws which authorize this condition include but are not limited to: 33 U.S.C. § 1341(a), (b), & (d); 33 U.S.C. § 1251(b); 33 U.S.C. § 1370; Md. Ann. Code, Env. Article, Title 1, Subtitles 3 and 4; Md. Ann. Code, Env. Article, Title 5, Subtitles 5 and 9; Md. Ann. Code, Env. Article, Title 9, Subtitle 3; Md. Ann. Code, Env. Article, Title 16; COMAR 26.08; COMAR 26.08.02.10G(3); COMAR 26.23.02.06; COMAR 26.17.01; COMAR 26.23; COMAR 26.24

9. Statement of Necessity for General Condition 5: Erosion and sediment control plans are necessary to ensure that sediment discharges from construction activities will not enter waters of the United States. Sediment discharges from earth disturbance or discharges at erosive rates within or adjacent to regulated resources may cause discharges resulting in turbidity in excess of water quality standards and interfere with designated uses of growth and propagation of fish, other aquatic life, wildlife; and other designated uses; and fail to meet general water quality criteria that waters not be polluted by substances in amounts sufficient to be unsightly or create a nuisance

Citation: Env. Article, Title 4, Subtitle 1 COMAR 26.17.01; 26.08.02.03B(1)-B(2)

10. Statement of Necessity for General Conditions 6, 7, 8: Fill or construction material within or adjacent to regulated resources may cause discharges resulting in turbidity in excess of water quality standards and interfere with designated uses of growth and propagation of fish, other aquatic life, wildlife; and other designated uses; and fail to meet general water quality criteria that waters not be polluted by substances in amounts sufficient to be unsightly or create a nuisance.

Citation: 26.08.02.03B(1)-B(2); COMAR 26.23; COMAR 26.24; COMAR 26.17.04

11. Statement of Necessity for General Condition 12: Conditions of certification involve precise actions to comply with water quality standards. Site inspection may be necessary to ensure that limits, methods, and other requirements are met to ensure that water quality standards are met and designated uses are maintained.

Citation: Federal and state laws that authorize this condition include but are not limited to: 33 U.S.C. § 1341(a), (b), & (d); 33 U.S.C. § 1251(b); 33 U.S.C. § 1370; Md. Ann. Code, Env. Article, Title 1, Subtitles 3 and 4; Md. Ann. Code, Env. Article, Title 5, Subtitles 5 and 9; Md. Ann. Code, Env. Article, Title 9, Subtitle 3; Md. Ann. Code, Env. Article, Title 16; COMAR 26.08; COMAR 26.23.02.06; COMAR 26.23; COMAR 26.24; COMAR 26.17.04

23-WQC-0012

This Certification is valid for the Project identified herein and the associated U.S. Army Corps of Engineers authorization until such time that it expires. Failure to comply with these conditions may subject the Certification Holder to criminal and/or civil penalties or other enforcement action in accordance with applicable law.

CERTIFICATION APPROVED:



DATE:

Sep 29, 2023

D. Lee Currey, Director
Water and Science Administration

Tracking Number: 202261295
Agency Interest Number: 173604

Effective Date: September 28, 2023

Enclosure: Plan Sheets 1 through 13

cc: WSA Inspection & Compliance Program
US Army Corps of Engineers, Baltimore District



PROJECT
UNITED STATES COAST GUARD
ARUNDEL COVE YARD

CLIENT
United States Coast Guard
2401 Hawkins Point Road
Baltimore, MD 21226

CONSULTANT
AECOM
430 National Business Pkwy
Suite 190
Annapolis Junction, MD 20701
410.379.6635 tel
www.aecom.com

23-WQC-0012; 1 of 13

REFERENCE
0 350 700 Feet



ISSUE/REVISION

1	CMD	12/20/2022
2	RAB	7/14/2023

PROJECT NUMBER
60660293

SHEET TITLE
USCG Arundel Impact Plates
Proposed Extents of Dredge

FIGURE NUMBER
1 of 6

Data Sources:
Coastal and harbor features accessed from the National Oceanic and Atmospheric Administration (NOAA) Electronic Navigational Chart (ENC) GIS database; from charts US5BALBA and US5BALBB for Baltimore Harbor. Limits of dredge work shown here reflect the loe of the proposed dredge prism. Northing and easting coordinates provided here are presented in feet, and refer to the NAD83 Maryland State Plane.

- Dredge Area**
- Basin
 - Berth
 - Channel
 - Shiplift
- Dredge Bounding Points**
- Toe of Proposed Dredge
 - Channel Marker Buoy
 - NOAA Shoreline
 - Navigational Channel Boundary
 - Riverine Area

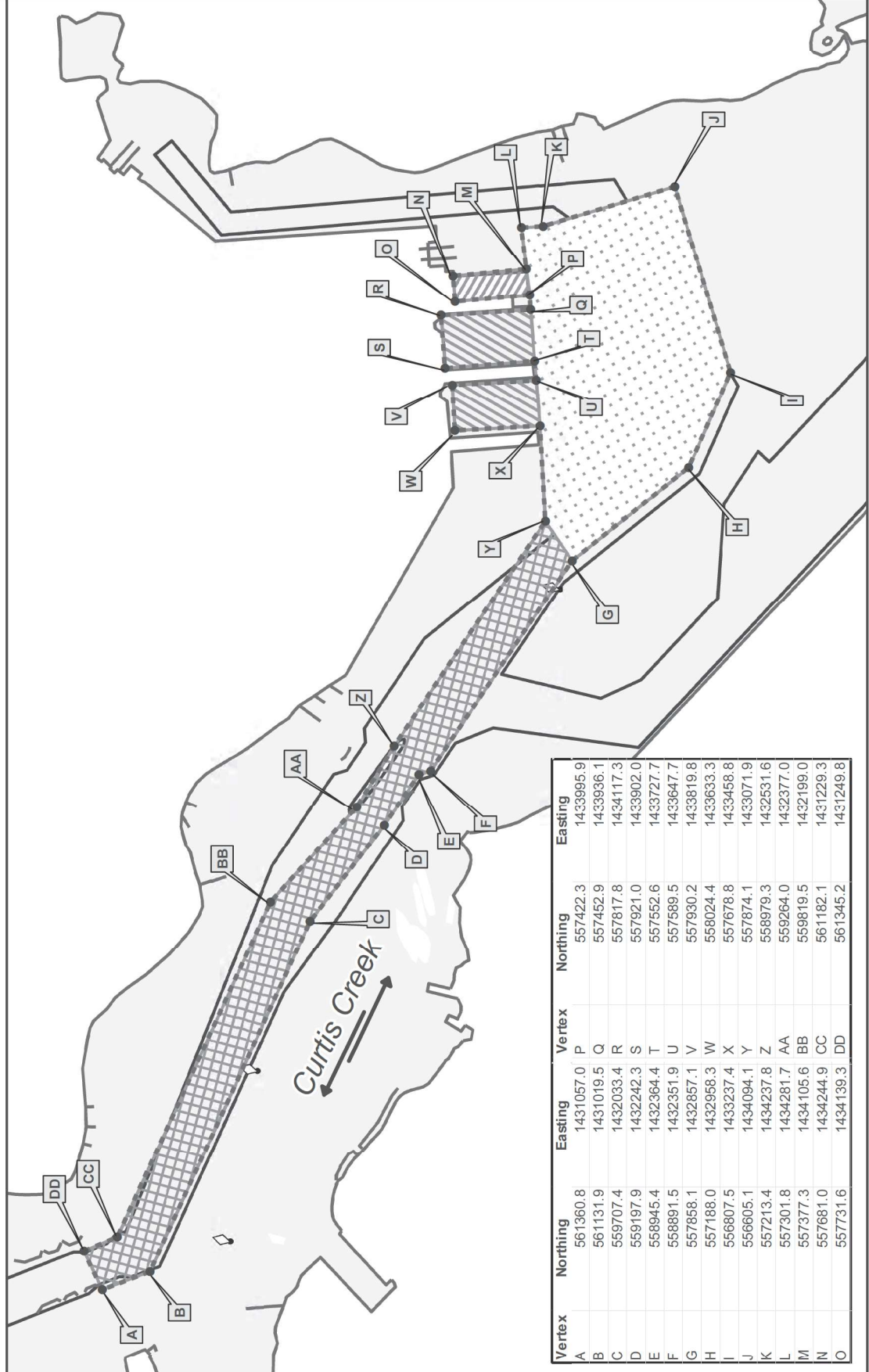

Vertex	Northing	Easting	Vertex	Northing	Easting
A	561360.8	1431057.0	P	557422.3	1433995.9
B	561131.9	1431019.5	Q	557452.9	1433936.1
C	559707.4	1432033.4	R	557817.8	1434117.3
D	559197.9	1432242.3	S	557921.0	1433902.0
E	558945.4	1432364.4	T	557552.6	1433727.7
F	558891.5	1432351.9	U	557589.5	1433647.7
G	557858.1	1432857.1	V	557930.2	1433819.8
H	557188.0	1432958.3	W	558024.4	1433633.3
I	556807.5	1433237.4	X	557678.8	1433458.8
J	556605.1	1434094.1	Y	557874.1	1433071.9
K	557213.4	1434237.8	Z	558979.3	1432531.6
L	557301.8	1434281.7	AA	559264.0	1432377.0
M	557377.3	1434105.6	BB	559819.5	1432199.0
N	557681.0	1434244.9	CC	561182.1	1431229.3
O	557731.6	1434139.3	DD	561345.2	1431249.8

ISSUE/REVISION

1	CMD	12/10/2021
2	CMD	12/13/2022
3	RAB	7/14/2023

PROJECT NUMBER
60660293

SHEET TITLE
USCG Arundel Impact Plates
Proposed Conditions Panel 1 of 3

Data Sources:
Bathymetric survey of Curtis Creek conducted by Gahagan & Bryant Associates, Inc. on June 15-16, 2021. Bathymetric contours shown here in feet using the Mean Lower-Low Water (MLLW) datum. Coastal and harbor features accessed from the National Oceanic and Atmospheric Administration (NOAA) Electronic Navigational Chart (ENC) GIS database, from charts US5BALBA and US5BALBB for Baltimore Harbor. Property line data set referenced from the Maryland Department of Planning. Proposed conditions reflect the overdredge condition and assume final dredge side slopes of 3H:1V. Waterbody and wetland limits referenced from the USFWS National Wetlands Inventory, accessed December 10, 2021.

- Proposed Bathymetric Contours**
- Minor Contours (2'), ft MLLW
 - Major Contours (10'), ft MLLW
- Legend:**
- Property Lines
 - Channel Marker Buoy
 - NWI Wetlands
 - NWI Waterbody Limit
 - NOAA Shoreline
 - Riverine Area
 - Cross-Section Lines
 - Limit of Disturbance
 - Navigation Channel Boundary
 - Abutter Properties (See Table)

Map No.	Owner	Street Address	City	State	Zip
1	6212 PENNINGTON AVENUE LLC	6212-6218 PENNINGTON AVE	BALTIMORE	MD	21226
2	WHITTING-TURNER CONTRACTING CO INC	300 E JOPPA RD	BALTIMORE	MD	21286
3	CURTIS CREEK LAND COMPANY LLC	32 STAHL'S POINT RD	BALTIMORE	MD	21226
4	33 STAHL-POINT LLC	33 STAHL'S POINT RD, STE 1	BALTIMORE	MD	21226
5	CURTIS CREEK PROPERTIES LLC	705 ORDINANCE RD, #107	BALTIMORE	MD	21226
6	STERICYCLE INC	18161 N KEITH DR	LAKE FOREST	IL	60045
7	JENSTAR OF BALTIMORE LLC	PO BOX 1400	VOORHEES	NJ	08403
8	CHEMICAL ROAD LLC	2700 LOCH RAVEN	BALTIMORE	MD	21218

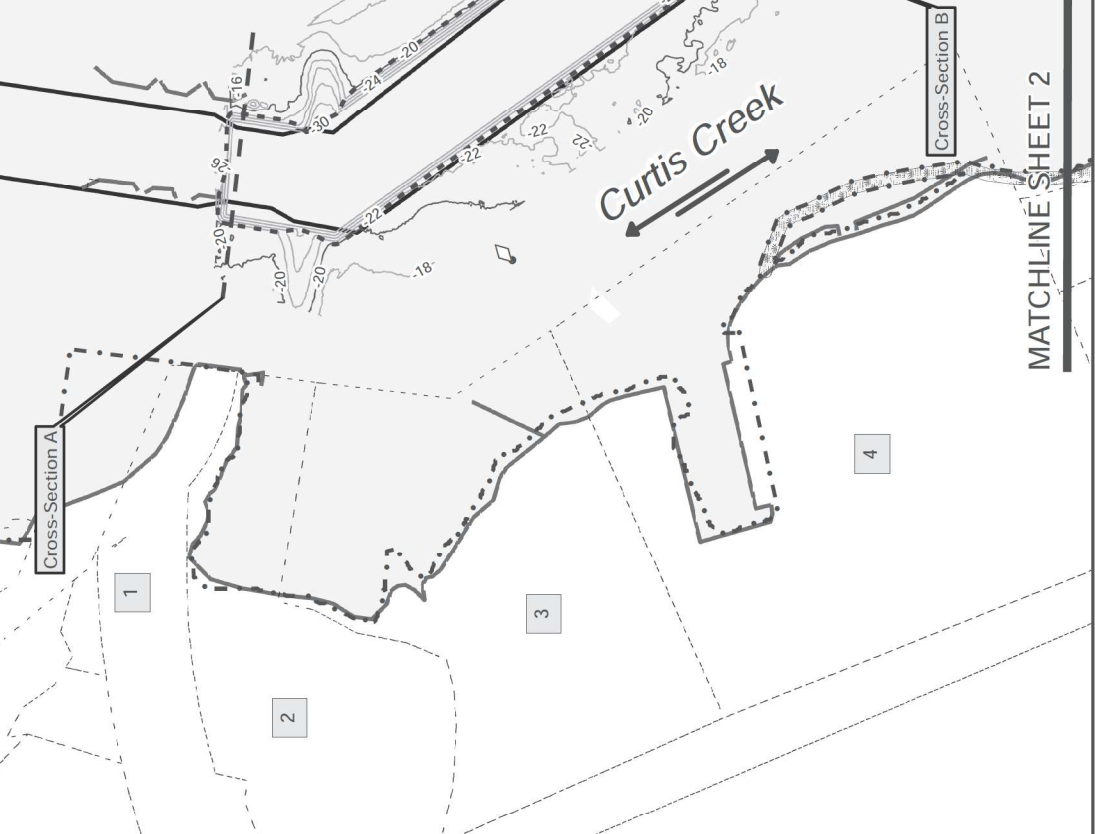



PROJECT
UNITED STATES COAST GUARD
ARUNDEL COVE YARD

CLIENT
United States Coast Guard
2401 Hawkins Point Road
Baltimore, MD 21226

CONSULTANT
AECOM
430 National Business Pkwy
Suite 190
Annapolis Junction, MD 20701
410.379.6835 tel
www.aecom.com

23-WQC-0012; 3 of 13

REFERENCE



ISSUE/REVISION

1	CMD	12/10/2021
2	CMD	12/13/2022
3	RAB	7/14/2023

PROJECT NUMBER
60660293

SHEET TITLE
USCG Arundel Impact Plates
Proposed Conditions Panel 2 of 3

FIGURE NUMBER
3 of 6

Data Sources:
Bathymetric survey of Curtis Creek conducted by Gahagan & Bryant Associates, Inc. on June 15-16, 2021. Bathymetric contours shown here in feet using the Mean Lower-Low Water (MLLW) datum. Coastal and harbor features accessed from the National Oceanic and Atmospheric Administration (NOAA) Electronic Navigational Chart (ENC) GIS database, from charts US5BALBA and US5BALBB for Baltimore Harbor. Property line data set referenced from the Maryland Department of Planning. Proposed conditions reflect the overdrudge condition and assume final dredge side slopes of 3H:1V. Waterbody and wetland limits referenced from the USFWS National Wetlands Inventory, accessed December 10, 2021.

Proposed Bathymetric Contours

- Minor Contours (2'), ft MLLW
- Major Contours (10'), ft MLLW

Proposed Bathymetric Contours

- Property Lines
- Channel Marker Buoy
- NWI Wetlands
- NWI Waterbody Limit
- NOAA Shoreline
- Riverine Area

Abutter Properties (See Table)

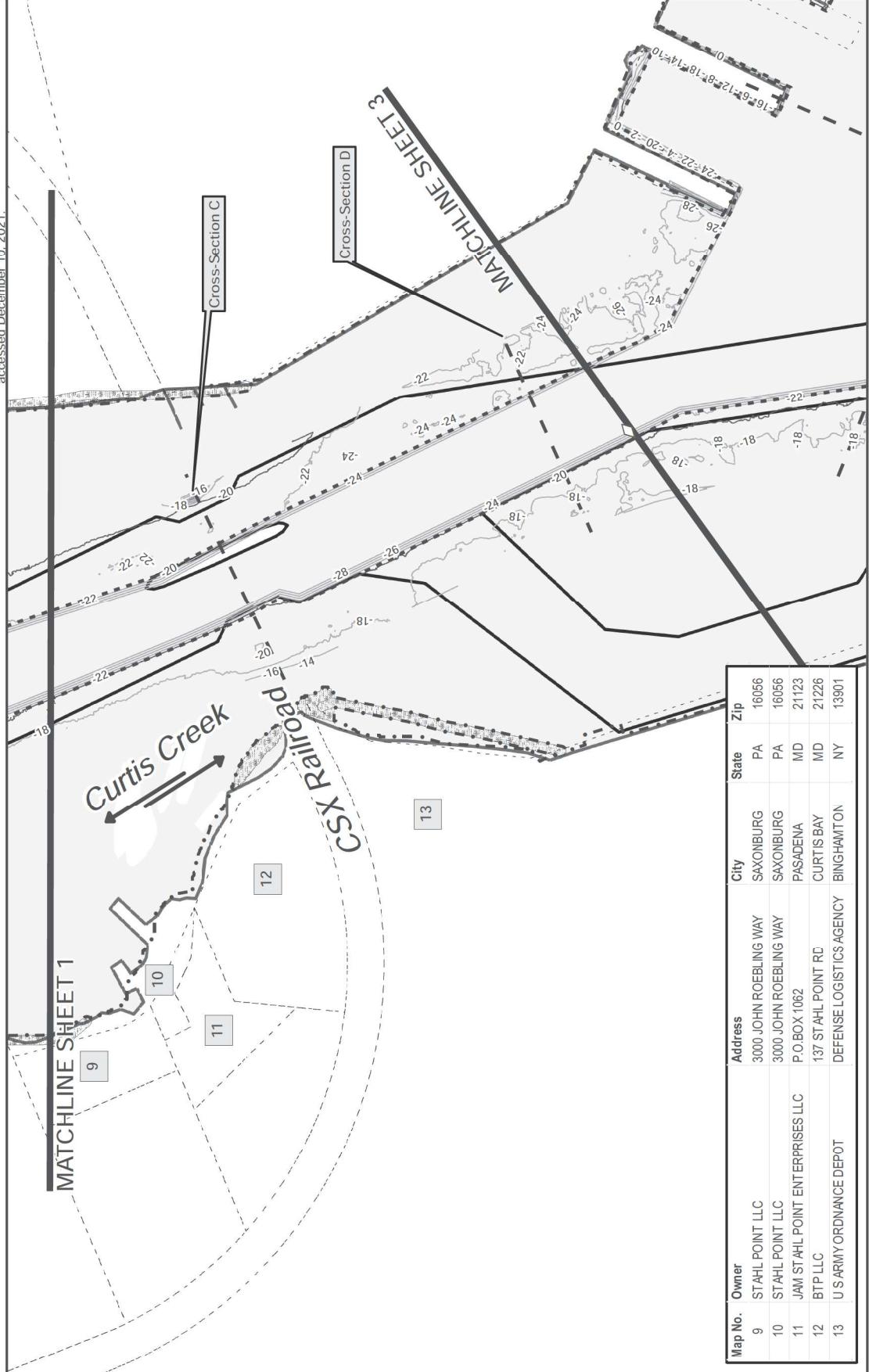

Map No.	Owner	Address	City	State	Zip
9	STAHL POINT LLC	3000 JOHN ROEBLING WAY	SAXONBURG	PA	16056
10	STAHL POINT LLC	3000 JOHN ROEBLING WAY	SAXONBURG	PA	16056
11	JAM STAHL POINT ENTERPRISES LLC	P.O. BOX 1062	PASADENA	MD	21123
12	BTP LLC	137 STAHL POINT RD	CURTIS BAY	MD	21226
13	U S ARMY ORDNANCE DEPOT	DEFENSE LOGISTICS AGENCY	BINGHAMTON	NY	13901



PROJECT
UNITED STATES COAST GUARD
ARUNDEL COVE YARD

CLIENT
United States Coast Guard
2401 Hawkins Point Road
Baltimore, MD 21226

CONSULTANT
AECOM
430 National Business Pkwy
Suite 190
Annapolis Junction, MD 20701
410.379.6835 tel
www.aecom.com

23-WQC-0012; 4 of 13

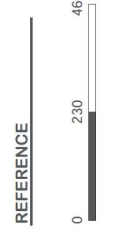

ISSUE/REVISION

1	CMD	12/10/2021
2	CMD	12/20/2022
3	RAB	7/14/2023

PROJECT NUMBER
60660293

SHEET TITLE
USCG Arundel Impact Plates
Proposed Conditions Panel 3 of 3

FIGURE NUMBER
4 of 6

Data Sources:

Bathymetric survey of Curtis Creek conducted by Gahagan & Bryant Associates, Inc. on June 15-16, 2021. Bathymetric contours shown here in feet using the Mean Lower-Low Water (MLLW) datum. Coastal and harbor features accessed from the National Oceanic and Atmospheric Administration (NOAA) Electronic Navigational Chart (ENC) GIS database, from charts US5BALBA and US5BALBB for Baltimore Harbor. Property line data set referenced from the Maryland Department of Planning. Proposed conditions reflect the over-dredge condition and assume final dredge side slopes of 3H:1V. Waterbody and wetland limits referenced from the USFWS National Wetlands Inventory, accessed December 10, 2021.

Proposed Bathymetric Contours

- Minor Contours (2'), ft MLLW
- Major Contours (10'), ft MLLW

Property Lines

- Cross-Section Lines
- Limit of Disturbance
- Navigational Channel Boundary
- Abutter Properties (See Table)

Channel Marker Buoy

- NWI Wetlands
- NWI Waterbody Limit
- NOAA Shoreline
- Riverine Area

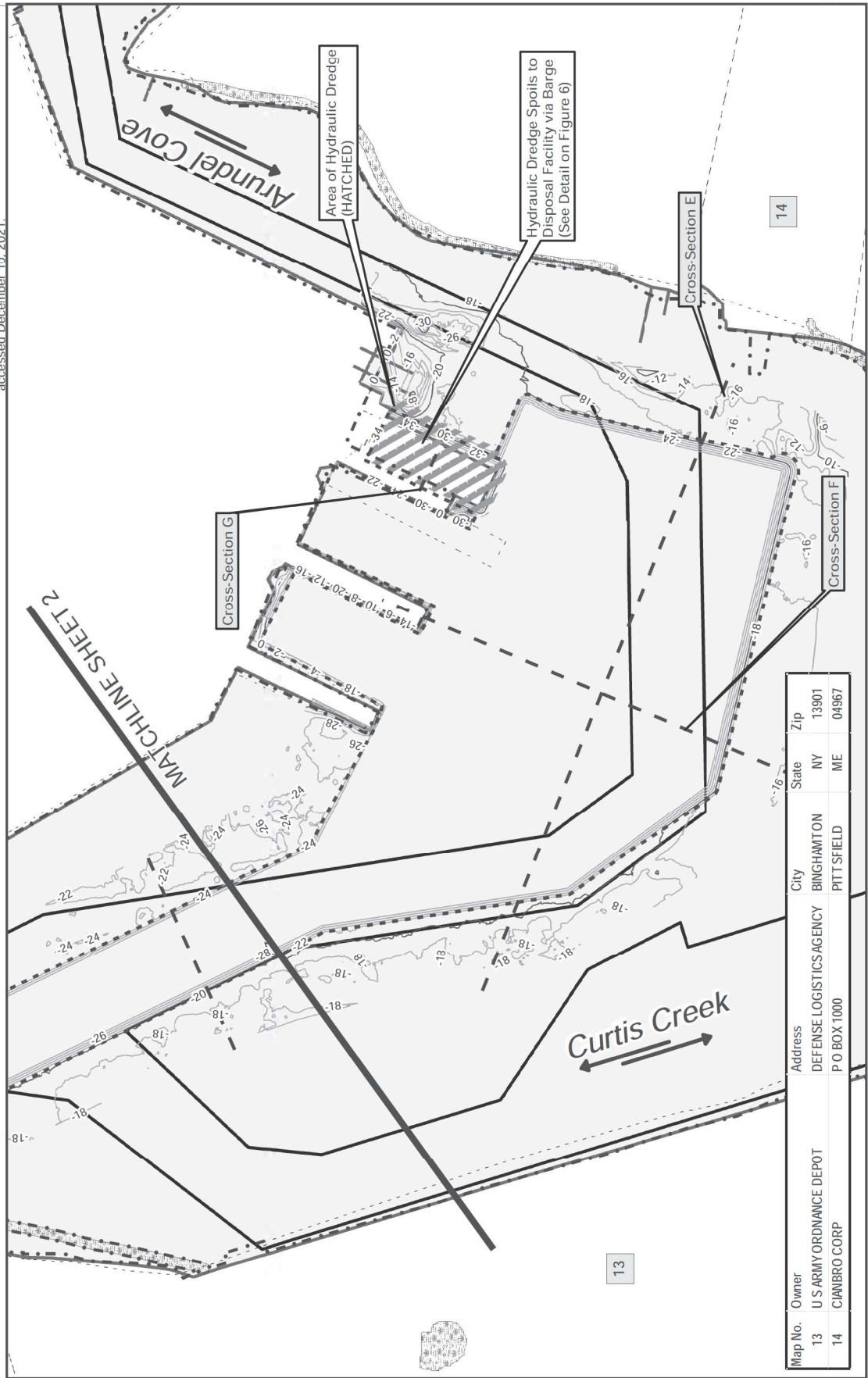

Map No.	Owner	Address	City	State	Zip
13	U S ARMY ORDNANCE DEPOT	DEFENSE LOGISTICS AGENCY	BINGHAMTON	NY	13901
14	CIAMBRO CORP	P O BOX 1000	PITTSFIELD	ME	04967

Data Sources:



PROJECT
 UNITED STATES COAST GUARD
 ARUNDEL COVE YARD

CLIENT
 United States Coast Guard
 2401 Hawkins Point Road
 Baltimore, MD 21126

CONSULTANT
 AECOM
 430 National Business Pkwy
 Suite 190
 Annapolis Junction, MD 20701
 410.379.6835 tel
 www.aecom.com

23-WQC-0012; 5 of 13

REFERENCE

ISSUE/REVISION

1	CMD	12/15/2022
2	RAB	7/14/2023

PROJECT NUMBER
 60660293

SHEET TITLE
 USCG Arundel Impact Plates
 WOTUS Impact Table

FIGURE NUMBER

	Target Dredge Scenario		1' Overdredge Scenario			
	SF	AC	CY	SF	AC	CY
Permanent Impacts						
Hydraulic Dredge						
Shiplift	51,341	1.18	7,449	55,690	1.28	9,294
Mechanical Dredge						
Channel	922,677	21.18	146,143	949,099	21.79	180,389
Turning Basin	1,156,798	26.56	231,931	1,167,892	26.81	273,508
Berths	193,216	4.44	11,872	193,348	4.44	15,926
Total	2,324,032	53.35	397,395	2,366,029	54.32	479,117

Data Sources:



PROJECT
UNITED STATES COAST GUARD
ARUNDEL COVE YARD

CLIENT
United States Coast Guard
2401 Hawkins Point Road
Baltimore, MD 21226

CONSULTANT
AECOM
430 National Business Pkwy
Suite 190
Annapolis Junction, MD 20701
410.379.6835 tel
www.aecom.com

23-WQC-0012; 6 of 13

REFERENCE

ISSUE/REVISION

NO.	DESCRIPTION	DATE
1	RAB	7/14/2023

PROJECT NUMBER
60660293

SHEET TITLE
USCG Arundel Impact Plates
Hydraulic Dredge Figure

FIGURE NUMBER

6 of 6

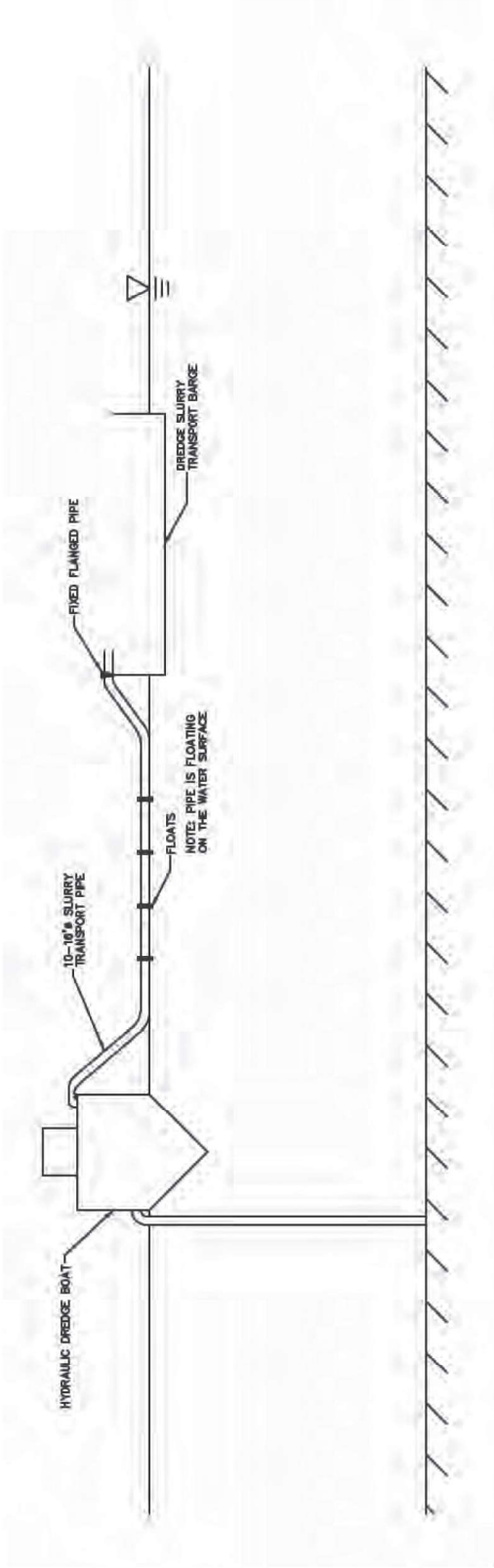

Legend

- EXISTING CHANNEL BOTTOM
- PROPOSED DREDGE DEPTH (STANDARD): -27.50' MLLW (-27.75' MLW)
- 1-FOOT OVERDREDGE: -28.50' MLLW (-28.75' MLW)

NOTES:

1. THE INFORMATION DEPICTED ON THIS MAP REPRESENTS THE RESULTS OF SURVEYS MADE ON THE DATES SHOWN AND CAN ONLY INDICATE THE GENERAL CONDITION EXISTING AT THAT TIME.
2. SURVEY DATA COLLECTED BY GAHAGAN & BRYANT ASSOCIATES, INC. ON JUNE 15-16, 2021 USING SURVEY VESSEL 'SEA FIX'.
3. DESIGN DREDGE PRISMS REFLECT TARGET DREDGE ELEVATIONS OF -27.5 AND OVERDREDGE ELEVATIONS OF -28.5 FEET IN THE MLLW DATUM.
4. INFORMATION SHOWN HERE IS FOR PERMITTING PURPOSES ONLY, AND MAY NOT BE USED FOR CONSTRUCTION.

SECTION A: HIGHWAY BRIDGE

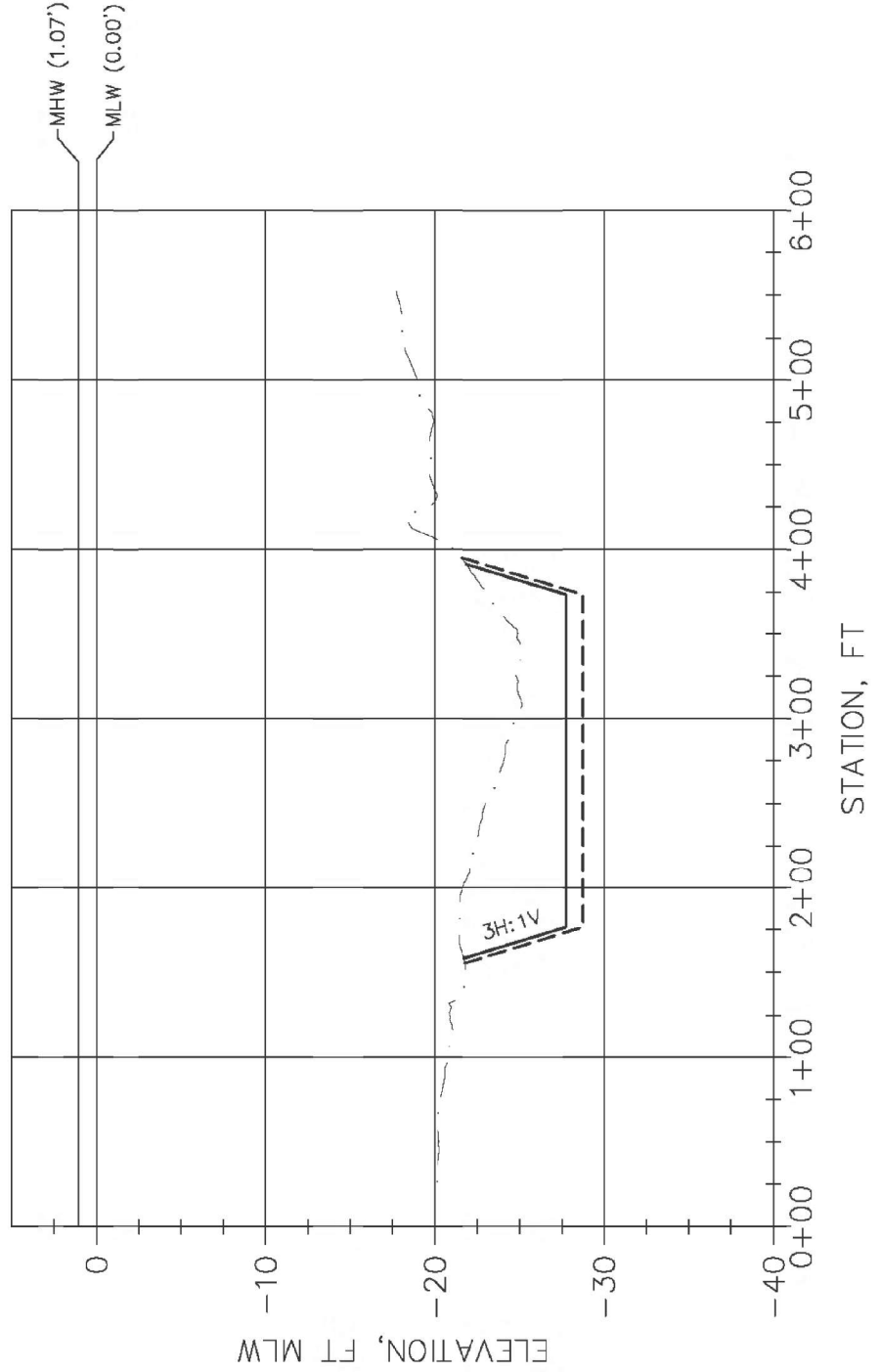

PROJECT
UNITED STATES COAST GUARD
ARUNDEL COVE YARD

CLIENT
United States Coast Guard
2401 Hawkins Point Road
Baltimore, MD 21226

CONSULTANT
AECOM
430 National Business Pkwy
Suite 190
Annapolis Junction, MD 20701
410.379.6835 tel
www.aecom.com

23-WQC-0012; 7 of 13

REFERENCE

ISSUE/REVISION

1	CMD	12/02/2021
2	CMD	12/13/2022

PROJECT NUMBER
60660293

SHEET TITLE
USCG Arundel Impact Plates
Proposed Cross-Section Panel 1 of 7

FIGURE NUMBER

Legend

- EXISTING CHANNEL BOTTOM
- PROPOSED DREDGE DEPTH (STANDARD): -27.50' MLLW (-27.75' MLW)
- 1-FOOT OVERDREDGE: -28.50' MLLW (-28.75' MLW)

NOTES:

1. THE INFORMATION DEPICTED ON THIS MAP REPRESENTS THE RESULTS OF SURVEYS MADE ON THE DATES SHOWN AND CAN ONLY INDICATE THE GENERAL CONDITION EXISTING AT THAT TIME.
2. SURVEY DATA COLLECTED BY GAHAGAN & BRYANT ASSOCIATES, INC. ON JUNE 15-16, 2021 USING SURVEY VESSEL 'SEA FIX'.
3. DESIGN DREDGE PRISMS REFLECT TARGET DREDGE ELEVATIONS OF -27.5 AND OVERDREDGE ELEVATIONS OF -28.5 FEET IN THE MLLW DATUM.
4. INFORMATION SHOWN HERE IS FOR PERMITTING PURPOSES ONLY, AND MAY NOT BE USED FOR CONSTRUCTION.

SECTION B: CHANNEL

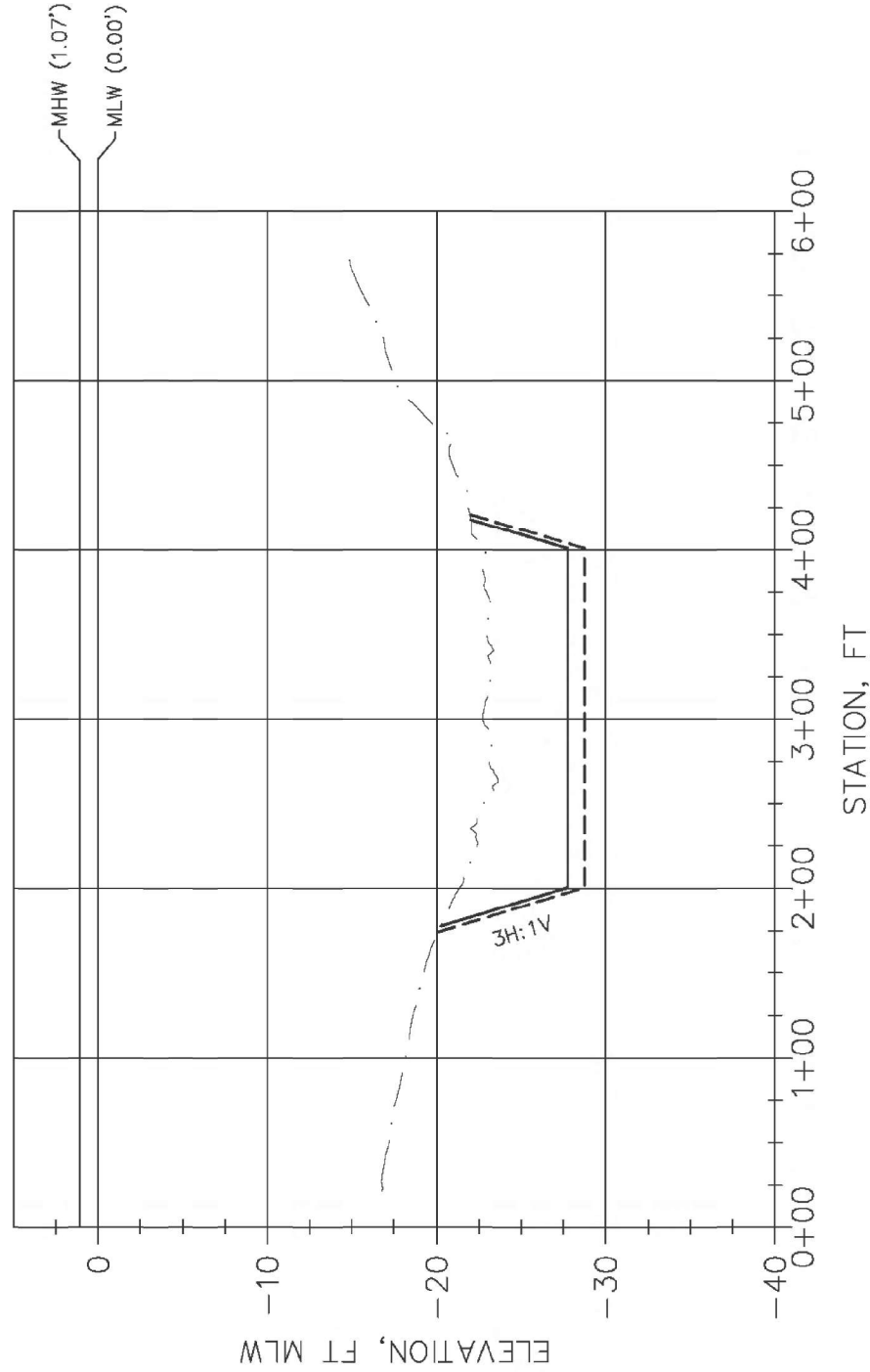

PROJECT
UNITED STATES COAST GUARD
ARUNDEL COVE YARD

CLIENT
United States Coast Guard
2401 Hawkins Point Road
Baltimore, MD 21226

CONSULTANT
AECOM
430 National Business Pkwy
Suite 190
Annapolis Junction, MD 20701
410.379.6835 tel
www.aecom.com

23-WQC-0012; 8 of 13

REFERENCE

ISSUE/REVISION

1	CMD	12/02/2021
2	CMD	12/13/2022

PROJECT NUMBER
60660293

SHEET TITLE
USCG Arundel Impact Plates
Proposed Cross-Section Panel 2 of 7

FIGURE NUMBER

Legend

- EXISTING CHANNEL BOTTOM
- PROPOSED DREDGE DEPTH (STANDARD): -27.50' MLLW (-27.75' MLW)
- 1-FOOT OVERDREDGE: -28.50' MLLW (-28.75' MLW)

NOTES:

1. THE INFORMATION DEPICTED ON THIS MAP REPRESENTS THE RESULTS OF SURVEYS MADE ON THE DATES SHOWN AND CAN ONLY INDICATE THE GENERAL CONDITION EXISTING AT THAT TIME.
2. SURVEY DATA COLLECTED BY GAHAGAN & BRYANT ASSOCIATES, INC. ON JUNE 15-16, 2021 USING SURVEY VESSEL 'SEA FIX'.
3. DESIGN DREDGE PRISMS REFLECT TARGET DREDGE ELEVATIONS OF -27.5 AND OVERDREDGE ELEVATIONS OF -28.5 FEET IN THE MLLW DATUM.
4. INFORMATION SHOWN HERE IS FOR PERMITTING PURPOSES ONLY, AND MAY NOT BE USED FOR CONSTRUCTION.

SECTION C: CSX BRIDGE

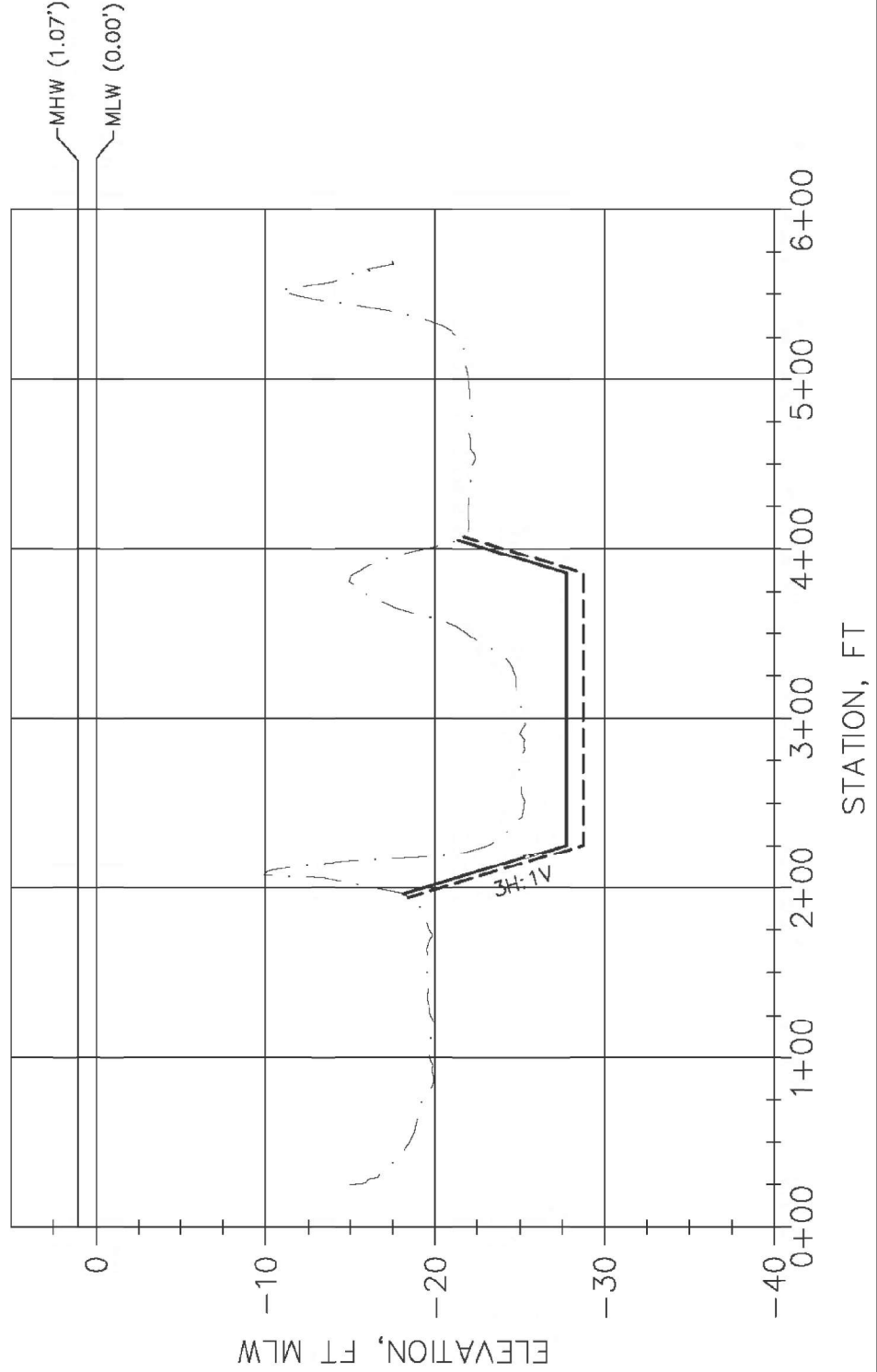

AECOM
 UNITED STATES COAST GUARD
 ARUNDEL COVE YARD

CLIENT
 United States Coast Guard
 2401 Hawkins Point Road
 Baltimore, MD 21226

CONSULTANT
 AECOM
 430 National Business Pkwy
 Suite 190
 Annapolis Junction, MD 20701
 410.379.6835 tel
 www.aecom.com

23-WQC-0012; 9 of 13

REFERENCE

ISSUE/REVISION

1	CMD	12/02/2021
2	CMD	12/13/2022

PROJECT NUMBER
 60660293

SHEET TITLE
 USCG Arundel Impact Plates
 Proposed Cross-Section Panel 3 of 7

FIGURE NUMBER

Legend

- EXISTING CHANNEL BOTTOM
- PROPOSED DREDGE DEPTH (STANDARD): -27.50' MLLW (-27.75' MLW)
- 1-FOOT OVERDREDGE: -28.50' MLLW (-28.75' MLW)

NOTES:

1. THE INFORMATION DEPICTED ON THIS MAP REPRESENTS THE RESULTS OF SURVEYS MADE ON THE DATES SHOWN AND CAN ONLY INDICATE THE GENERAL CONDITION EXISTING AT THAT TIME.
2. SURVEY DATA COLLECTED BY GAHAGAN & BRYANT ASSOCIATES, INC. ON JUNE 15-16, 2021 USING SURVEY VESSEL 'SEA FIX'.
3. DESIGN DREDGE PRISMS REFLECT TARGET DREDGE ELEVATIONS OF -27.5 AND OVERDREDGE ELEVATIONS OF -28.5 FEET IN THE MLLW DATUM.
4. INFORMATION SHOWN HERE IS FOR PERMITTING PURPOSES ONLY, AND MAY NOT BE USED FOR CONSTRUCTION.

SECTION D: CHANNEL

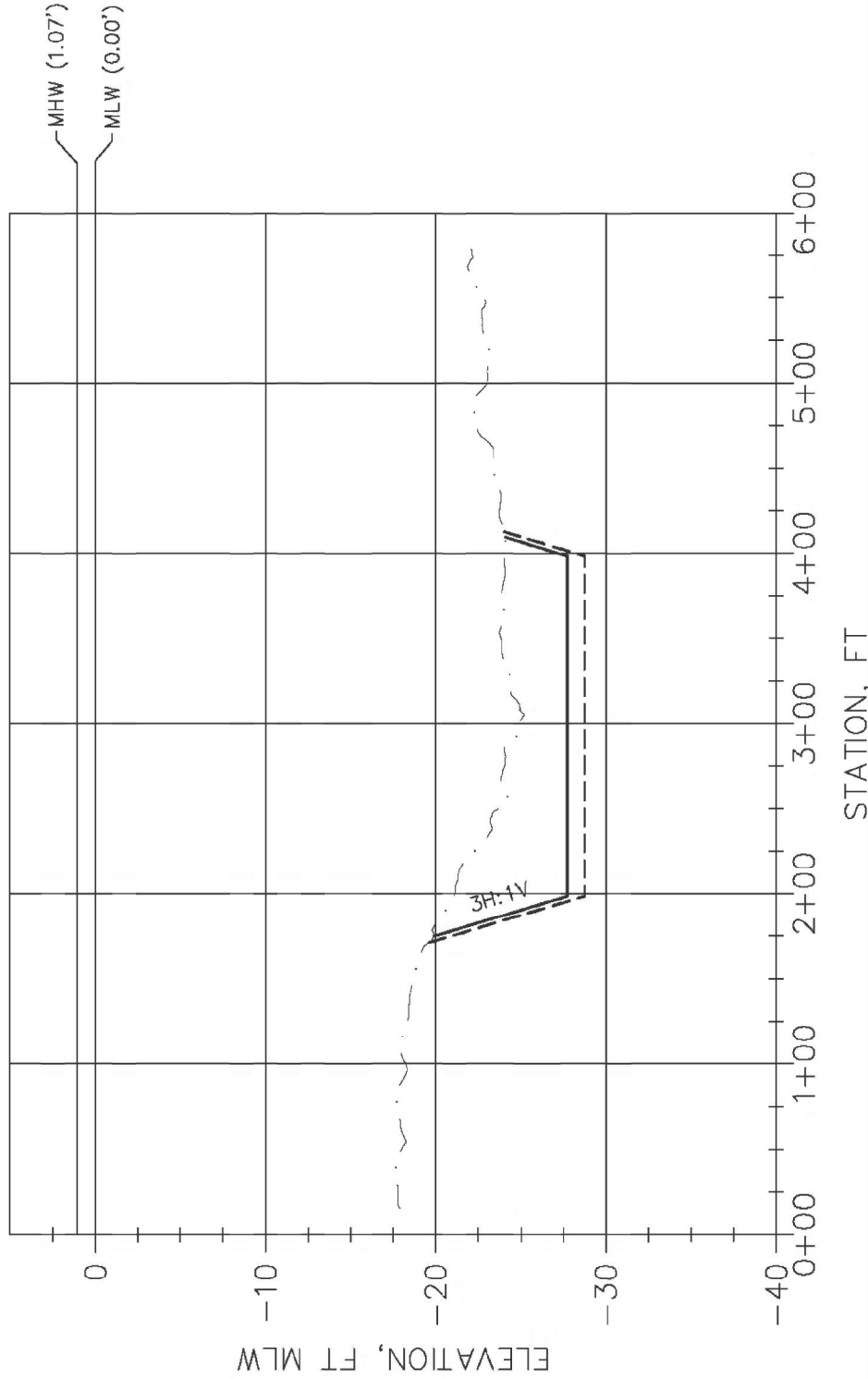

AECOM
 UNITED STATES COAST GUARD
 ARUNDEL COVE YARD

CLIENT
 United States Coast Guard
 2401 Hawkins Point Road
 Baltimore, MD 21226

CONSULTANT
 AECOM
 430 National Business Pkwy
 Suite 190
 Annapolis Junction, MD 20701
 410.379.6835 tel
 www.aecom.com

23-WQC-0012; 10 of 13

REFERENCE

ISSUE/REVISION

1	CMD	12/02/2021
2	CMD	12/13/2022

PROJECT NUMBER
60660293

SHEET TITLE
USCG Arundel Impact Plates
Proposed Cross-Section Panel 4 of 7

FIGURE NUMBER
4 of 7

Legend

- EXISTING CHANNEL BOTTOM
- PROPOSED DREDGE DEPTH (STANDARD): -27.50' MLLW (-27.75' MLW)
- 1-FOOT OVERDREDGE: -28.50' MLLW (-28.75' MLW)

NOTES:

1. THE INFORMATION DEPICTED ON THIS MAP REPRESENTS THE RESULTS OF SURVEYS MADE ON THE DATES SHOWN AND CAN ONLY INDICATE THE GENERAL CONDITION EXISTING AT THAT TIME.
2. SURVEY DATA COLLECTED BY GAHAGAN & BRYANT ASSOCIATES, INC. ON JUNE 15-16, 2021 USING SURVEY VESSEL 'SEA FIX'.
3. DESIGN DREDGE PRISMS REFLECT TARGET DREDGE ELEVATIONS OF -27.5 AND OVERDREDGE ELEVATIONS OF -28.5 FEET IN THE MLLW DATUM.
4. INFORMATION SHOWN HERE IS FOR PERMITTING PURPOSES ONLY, AND MAY NOT BE USED FOR CONSTRUCTION.



PROJECT
UNITED STATES COAST GUARD
ARUNDEL COVE YARD

CLIENT

United States Coast Guard
2401 Hawkins Point Road
Baltimore, MD 21226

CONSULTANT

AECOM
430 National Business Pkwy
Suite 190
Annapolis Junction, MD 20701
410.379.6835 tel
www.aecom.com

23-WQC-0012; 11 of 13

REFERENCE

SECTION E: TURNING BASIN

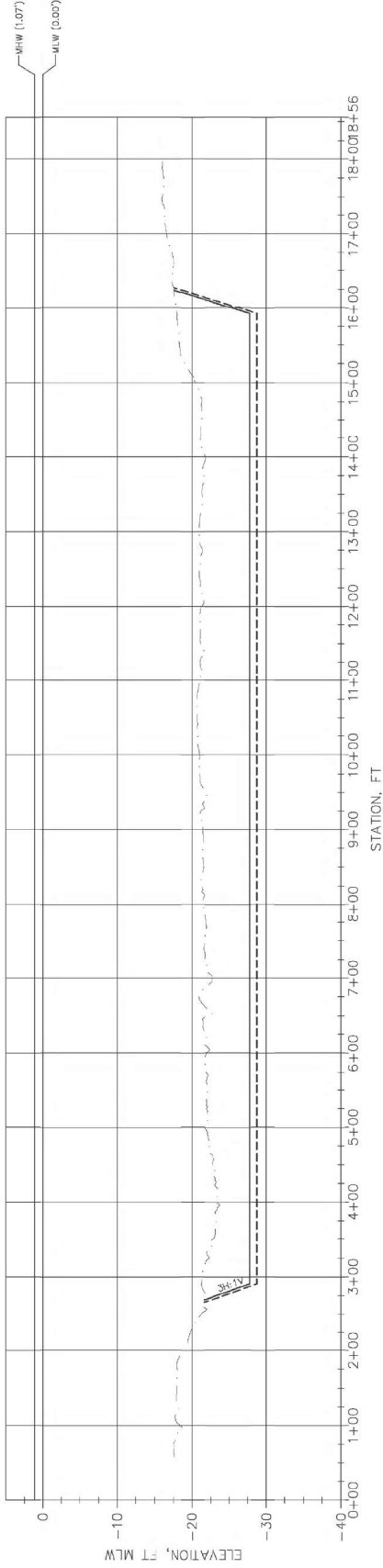

ISSUE/REVISION

1	CMD	12/02/2021
2	CMD	12/13/2022

PROJECT NUMBER

60660293

SHEET TITLE

USCG Arundel Impact Plates
Proposed Cross-Section Panel 5 of 7

FIGURE NUMBER

5 of 7

Legend

- EXISTING CHANNEL BOTTOM
- PROPOSED DREDGE DEPTH (STANDARD): -27.50' MLLW (-27.75' MLW)
- 1-FOOT OVERDREDGE: -28.50' MLLW (-28.75' MLW)

NOTES:

1. THE INFORMATION DEPICTED ON THIS MAP REPRESENTS THE RESULTS OF SURVEYS MADE ON THE DATES SHOWN AND CAN ONLY INDICATE THE GENERAL CONDITION EXISTING AT THAT TIME.
2. SURVEY DATA COLLECTED BY GAHAGAN & BRYANT ASSOCIATES, INC. ON JUNE 15-16, 2021 USING SURVEY VESSEL 'SEA FIX'.
3. DESIGN DREDGE PRISMS REFLECT TARGET DREDGE ELEVATIONS OF -27.5 AND OVERDREDGE ELEVATIONS OF -28.5 FEET IN THE MLLW DATUM.
4. INFORMATION SHOWN HERE IS FOR PERMITTING PURPOSES ONLY, AND MAY NOT BE USED FOR CONSTRUCTION.

SECTION F: TURNING BASIN

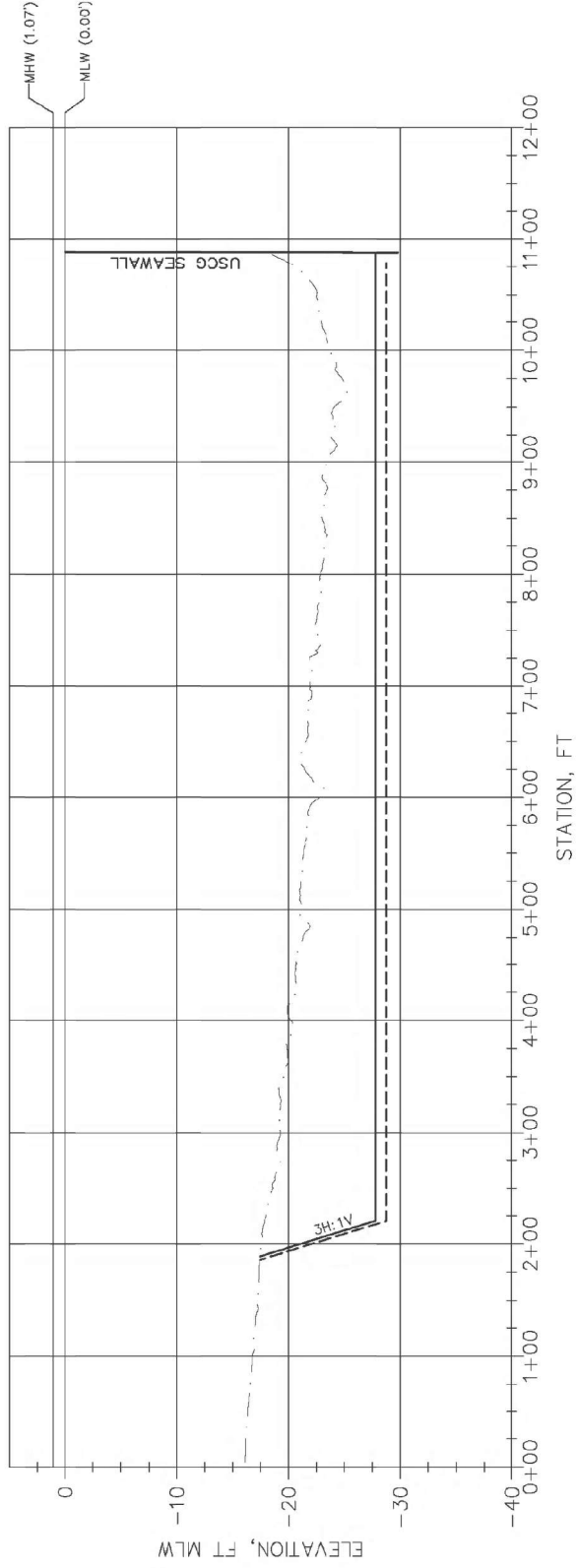

CLIENT

United States Coast Guard
 2401 Hawkins Point Road
 Baltimore, MD 21226

CONSULTANT

AECOM
 430 National Business Pkwy
 Suite 190
 Annapolis Junction, MD 20701
 410.379.6835 tel
 www.aecom.com

23-WQC-0012; 12 of 13

REFERENCE

ISSUE/REVISION

1	CMD	12/02/2021
2	CMD	12/13/2022

PROJECT NUMBER

60660293

SHEET TITLE

USCG Arundel Impact Plates
 Proposed Cross-Section Panel 6 of 7

FIGURE NUMBER

6 of 7

Legend

- EXISTING CHANNEL BOTTOM
- PROPOSED DREDGE DEPTH (STANDARD): -27.50' MLW (-27.75' MLW)
- 1-FOOT OVERDREDGE: -28.50' MLW (-28.75' MLW)

- NOTES:**
1. THE INFORMATION DEPICTED ON THIS MAP REPRESENTS THE RESULTS OF SURVEYS MADE ON THE DATES SHOWN AND CAN ONLY INDICATE THE GENERAL CONDITION EXISTING AT THAT TIME.
 2. SURVEY DATA COLLECTED BY GAHAGAN & BRYANT ASSOCIATES, INC. ON JUNE 15-16, 2021 USING SURVEY VESSEL 'SEA FIX'.
 3. DESIGN DREDGE PRISMS REFLECT TARGET DREDGE ELEVATIONS OF -27.5 AND OVERDREDGE ELEVATIONS OF -28.5 FEET IN THE MLW DATUM.
 4. INFORMATION SHOWN HERE IS FOR PERMITTING PURPOSES ONLY, AND MAY NOT BE USED FOR CONSTRUCTION.



PROJECT
UNITED STATES COAST GUARD
ARUNDEL COVE YARD

CLIENT
United States Coast Guard
2401 Hawkins Point Road
Baltimore, MD 21226

CONSULTANT
AECOM
430 National Business Pkwy
Suite 190
Annapolis Junction, MD 20701
410.379.6835 tel
www.aecom.com

23-WQC-0012; 13 of 13

REFERENCE

ISSUE/REVISION

1	CMD	12/02/2021
2	CMD	12/13/2022

PROJECT NUMBER
60660293

SHEET TITLE
USCG Arundel Impact Plates
Proposed Cross-Section Panel 7 of 7

FIGURE NUMBER

7 of 7

SECTION C: SHIPLIFT

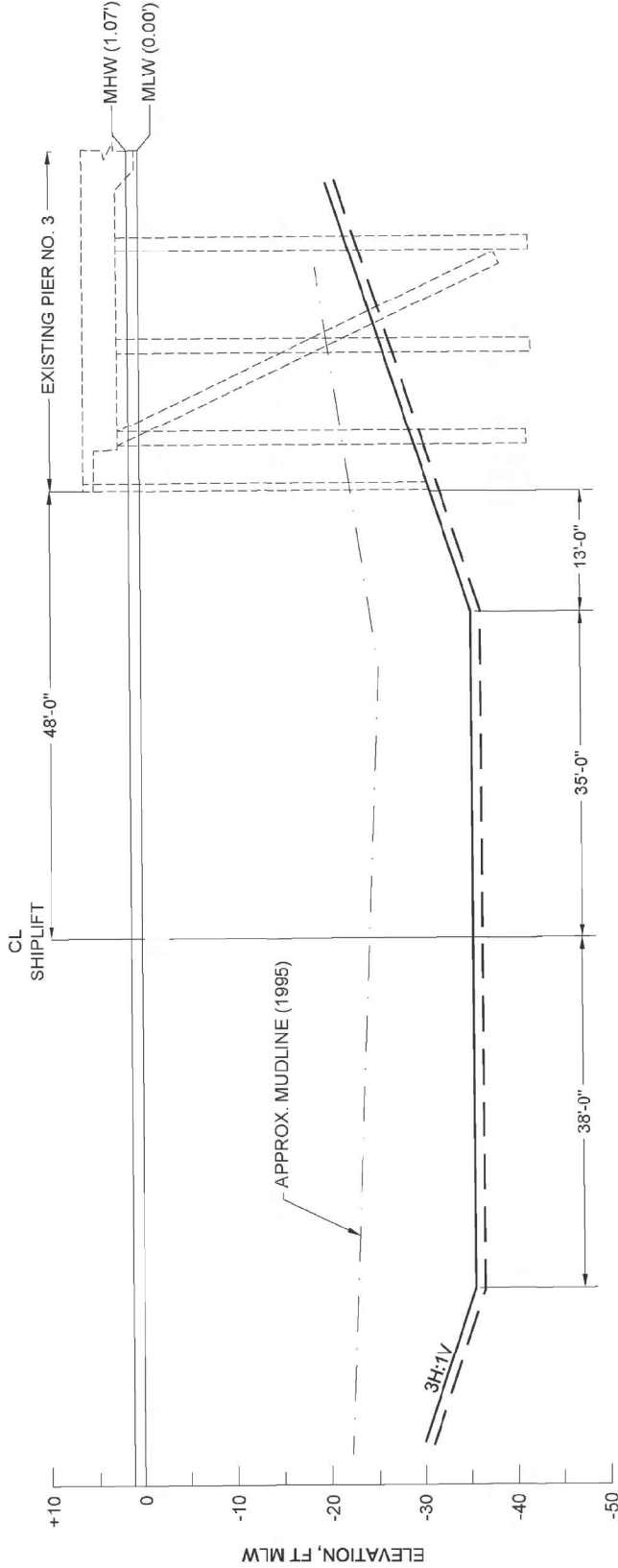

23-WQC-0012_USCG Curtis Creek Dredging

Final Audit Report

2023-09-29

Created:	2023-09-28
By:	Danielle Spendiff (danielle.spendiff1@maryland.gov)
Status:	Signed
Transaction ID:	CBJCHBCAABAAwqy0pjkkYXj65kMVq4jlqGrUfhqi8Slz

"23-WQC-0012_USCG Curtis Creek Dredging" History

-  Document created by Danielle Spendiff (danielle.spendiff1@maryland.gov)
2023-09-28 - 7:18:23 PM GMT- IP address: 167.102.133.161
-  Document emailed to mde.wsaepermits@maryland.gov for signature
2023-09-28 - 7:19:48 PM GMT
-  Email viewed by mde.wsaepermits@maryland.gov
2023-09-28 - 8:01:09 PM GMT- IP address: 167.102.133.161
-  Signer mde.wsaepermits@maryland.gov entered name at signing as D Lee Currey
2023-09-29 - 7:57:38 PM GMT- IP address: 167.102.133.161
-  Document e-signed by D Lee Currey (mde.wsaepermits@maryland.gov)
Signature Date: 2023-09-29 - 7:57:40 PM GMT - Time Source: server- IP address: 167.102.133.161
-  Agreement completed.
2023-09-29 - 7:57:40 PM GMT