

WATER WELL ABANDONMENT-SEALING REPORT FORM

SUBMIT COPIES OF COMPLETED FORM TO:

- \* COUNTY ENVIRONMENTAL AGENCY (contact MDE, WMA if address needed)
- \* WELL OWNER
- \* MDE, WATER MANAGEMENT ADMINISTRATION, WELL PROGRAM

DATE WELL ABANDONED: 4/8/2024 (month/day/year)

\* PERMIT NUMBER OF ABANDONED WELL (if any)

BA - 95 - 1053

\* PERMIT NUMBER OF REPLACEMENT WELL:

\* PERSON ABANDONING WELL: Steve Venios WELL DRILLER'S LICENSE NUMBER: JGD087

\* OWNER'S NAME: Griffen Steven B. Natasha R. Henderson CIRCLE: MWD / MSD / MGD (MSD)

\* WELL LOCATION:

SITE LOCATION MAP

COUNTY: Baltimore  
NEAREST TOWN: Phoenix  
TAX MAP 0035 BLOCK - PARCEL 0322  
SUBDIVISION: 0000  
SECTION: 3 LOT: 4  
STREET ADDRESS: 14219 Robraste Rd.

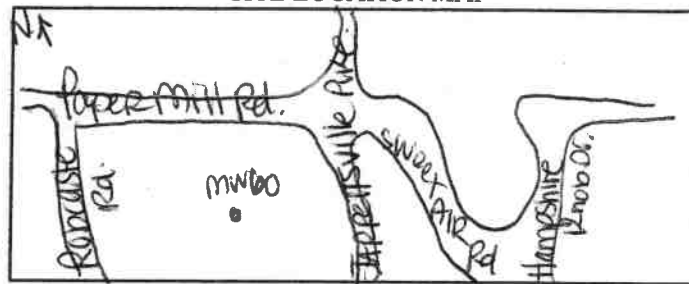

LATITUDE 39.517165

LONGITUDE 76.561483

LOG OF SEALING MATERIAL

\* TYPE OF WELL BEING ABANDONED:

☒ DRILLED ☐ JETTED  
☒ BORED ☐ HAND DUG  
☐ OTHER (specify) \_\_\_\_\_

\* USE CODE:

☐ DOMESTIC ☐ MUNICIPAL/PUBLIC  
☐ IRRIGATION ☐ INDUSTRIAL  
☒ TEST/OBSERVATION ☐ GEOTHERMAL

\* TYPE OF CASING:

☐ STEEL ☒ PLASTIC  
☐ CONCRETE ☐ OTHER (specify) \_\_\_\_\_

SIZE OF CASING: 6 INCHES IN DIAMETER

DEPTH OF WELL: 40 FEET DEEP

WAS ANY CASING REMOVED? ☒ YES ☐ NO

If yes, length removed, in feet: 2

WAS CASING RIPPED OR PERFORATED? ☐ YES ☒ NO

[Signature] MGD110  
SIGNATURE-MASTER WELL DRILLER OR SUPERVISING SANITARIAN LICENSE#

MATERIAL	FEET	
	FROM	TO
Cement Bentonite Grout	0	40
VOLUME OF MATERIAL USED		
8 ft. <sup>3</sup>		

Pursuant to § 10-624 of the State Govt. Article of the Maryland Code, personal info requested on this form is used in processing this form pursuant to COMAR 26.04.04. Failure to provide the info may result in this form not being processed. You have the right to inspect, amend, or correct this form. The Maryland Department of the Environment is subject to the Maryland Public Information Act. This form may be made available on the Internet via MDE's website and is subject to inspection or copying, in whole or in part, by the public and other governmental agencies, if not protected by federal or State Law.

(MSD) MSD / MGS  
CIRCLE ONE

6/24/24  
DATE

\*\*\*\*\*  
WATER WELL ABANDONMENT-SEALING REPORT FORM  
\*\*\*\*\*

SUBMIT COPIES OF COMPLETED FORM TO:

- \* COUNTY ENVIRONMENTAL AGENCY (contact MDE, WMA if address needed)
- \* WELL OWNER
- \* MDE, WATER MANAGEMENT ADMINISTRATION, WELL PROGRAM

DATE WELL ABANDONED: 4/18/2024 (month/day/year)

\* PERMIT NUMBER OF ABANDONED WELL (if any)

BA - 95 - 1051

\* PERMIT NUMBER OF REPLACEMENT WELL:

\* PERSON ABANDONING WELL: Steve Venias

WELL DRILLER'S LICENSE NUMBER: JG0087

\* OWNER'S NAME: Griffin Stevens

CIRCLE: MWD / MSD / MGS

\* WELL LOCATION:

COUNTY: Baltimore

NEAREST TOWN: Phoenix

TAX MAP 0035 BLOCK — PARCEL 0322

SUBDIVISION: 0000

SECTION: 3 LOT: 4

STREET ADDRESS: 14219 Robcast Rd.

LATITUDE 39.51696

LONGITUDE 76.56324

SITE LOCATION MAP

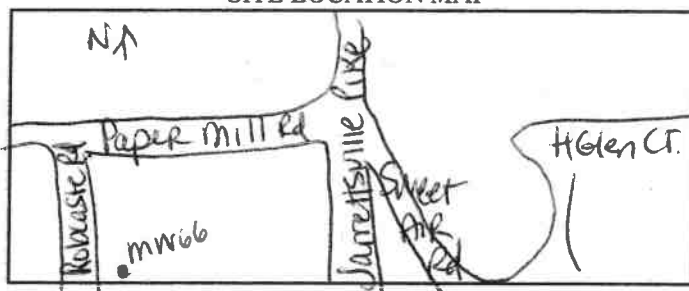

LOG OF SEALING MATERIAL

MATERIAL	FEET	
	FROM	TO
Cement Bentonite Grout	0	30
VOLUME OF MATERIAL USED		
6 ft <sup>3</sup>		

\* TYPE OF WELL BEING ABANDONED:

☐ DRILLED ☐ JETTED  
☒ BORED ☐ HAND DUG  
☐ OTHER (specify) \_\_\_\_\_

\* USE CODE:

☐ DOMESTIC ☐ MUNICIPAL/PUBLIC  
☐ IRRIGATION ☐ INDUSTRIAL  
☒ TEST/OBSERVATION ☐ GEOTHERMAL

\* TYPE OF CASING:

☐ STEEL ☒ PLASTIC  
☐ CONCRETE ☐ OTHER (specify) \_\_\_\_\_

SIZE OF CASING: 6 INCHES IN DIAMETER

DEPTH OF WELL: 30 FEET DEEP

WAS ANY CASING REMOVED? ☒ YES ☒ NO

If yes, length removed, in feet: 2

WAS CASING RIPPED OR PERFORATED? ☒ YES ☒ NO

SIGNATURE-MASTER WELL DRILLER OR SUPERVISING SANITARIAN [Signature] M&P 110

LICENSE#

MWD / MSD / MGS  
CIRCLE ONE

6/24/24  
DATE

ORIGINAL

Pursuant to § 10-624 of the State Govt. Article of the Maryland Code, personal info requested on this form is used in processing this form pursuant to COMAR 26.04.04. Failure to provide the info may result in this form not being processed. You have the right to inspect, amend, or correct this form. The Maryland Department of the Environment is subject to the Maryland Public Information Act. This form may be made available on the Internet via MDE's website and is subject to inspection or copying, in whole or in part, by the public and other governmental agencies, if not protected by federal or State Law.

Real Property Data Search ( )  
Search Result for BALTIMORE COUNTY

View Map

View GroundRent Redemption

View GroundRent Registration

Special Tax Recapture: None

Account Identifier:District - 10 Account Number - 1800014079

Owner Information

Owner Name:

GRIFFIN STEVEN B  
HENDERSON NATASHA R

Use:

RESIDENTIAL

Mailing Address:

14219 ROBCASTE RD  
PHOENIX MD 21131-1453

Principal Residence:

YES

Deed Reference:

/36546/ 00419

Location & Structure Information

Premises Address:

14219 ROBCASTE RD  
PHOENIX MD 21131-1453

Legal Description:

2.128 AC  
14219 ROBCASTE RD  
ASCOT ESTATES

Map:

Grid:

Parcel:

Neighborhood:

Subdivision:

Section:

Block:

Lot:

Assessment Year:

Plat No:

0035

0022

0322

10020025.04

0000

3

4

2023

Plat Ref: 0046/ 0047

Town: None

Primary Structure Built

Above Grade Living Area

Finished Basement Area

Property Land Area

County Use

1996

2,604 SF

850 SF

2.1200 AC

04

Stories

Basement

Type

Exterior

Quality

Full/Half Bath

Garage

Last Notice of Major Improvements

2

YES

STANDARD UNIT

SIDING/

4

3 full/ 1 half

1Att/1Det

Value Information

Base Value

Value

Phase-in Assessments

As of

As of

01/01/2023

07/01/2023

07/01/2024

Land:

150,100

272,400

Improvements

383,500

369,800

Total:

533,600

642,200

569,800

606,000

Preferential Land:

0

0

Transfer Information

Seller: TOWNSEND TANYA L

Date: 08/17/2015

Price: \$569,900

Type: ARMS LENGTH IMPROVED

Deed1: /36546/ 00419

Deed2:

Seller: STEPHANOUK PAUL

Date: 09/11/2013

Price: \$540,000

Type: ARMS LENGTH IMPROVED

Deed1: /34197/ 00090

Deed2:

Seller: MALL DAVID C

Date: 05/10/2011

Price: \$540,000

Type: ARMS LENGTH IMPROVED

Deed1: /30794/ 00063

Deed2:

Exemption Information

Partial Exempt Assessments:

Class

07/01/2023

07/01/2024

County:

000

0.00

State:

000

0.00

Municipal:

000

0.00|0.00

0.00|0.00

Special Tax Recapture: None

Homestead Application Information

Homestead Application Status: Approved 07/27/2016

Homeowners' Tax Credit Application Information

Homeowners' Tax Credit Application Status: No Application

Date:

District: **10** Account Number: **1800014079**



The information shown on this map has been compiled from deed descriptions and plats and is not a property survey. The map should not be used for legal descriptions. Users noting errors are urged to notify the Maryland Department of Planning Mapping, 301 W. Preston Street, Baltimore MD 21201.

If a plat for a property is needed, contact the local Land Records office where the property is located. Plats are also available online through the Maryland State Archives at [www.plats.net](http://www.plats.net) (<http://www.plats.net/>).

Property maps provided courtesy of the Maryland Department of Planning.

For more information on electronic mapping applications, visit the Maryland Department of Planning web site at <http://planning.maryland.gov/Pages/OurProducts/OurProducts.aspx> (<http://planning.maryland.gov/Pages/OurProducts/OurProducts.aspx>).

\*\*\*\*\*  
WATER WELL ABANDONMENT-SEALING REPORT FORM  
\*\*\*\*\*

SUBMIT COPIES OF COMPLETED FORM TO:

- \* COUNTY ENVIRONMENTAL AGENCY (contact MDE, WMA if address needed)
- \* WELL OWNER
- \* MDE, WATER MANAGEMENT ADMINISTRATION, WELL PROGRAM

DATE WELL ABANDONED: 4/17/2024 (month/day/year)

\* PERMIT NUMBER OF ABANDONED WELL (if any)

BA - 95 - 1060

\* PERMIT NUMBER OF REPLACEMENT WELL:

\* PERSON ABANDONING WELL: Steve Venius

WELL DRILLER'S LICENSE NUMBER: JGD087

\* OWNER'S NAME: Michael J Schech

CIRCLE: MWD / MSD / MGD MGD

\* WELL LOCATION:

COUNTY: Baltimore

NEAREST TOWN: Phoenix

TAX MAP 0035 BLOCK - PARCEL 0322

SUBDIVISION: 0000

SECTION: 3 LOT: 8

STREET ADDRESS: 14211 Robcaste Rd.

LATITUDE 39.51703

LONGITUDE 76.56349

SITE LOCATION MAP

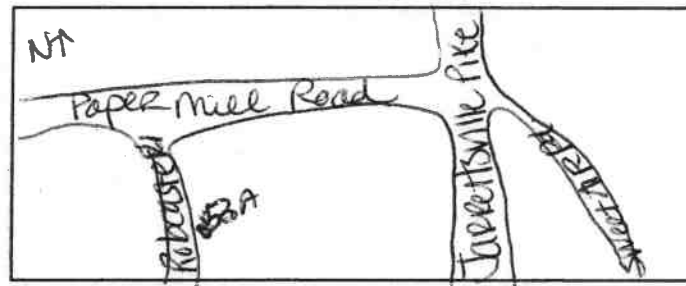

LOG OF SEALING MATERIAL

MATERIAL	FEET	
	FROM	TO
Cement Bentonite Grout	0	35
VOLUME OF MATERIAL USED		
1.75 ft <sup>3</sup>		

\* TYPE OF WELL BEING ABANDONED:

☐ DRILLED ☐ JETTED  
☒ BORED ☐ HAND DUG  
☐ OTHER (specify) \_\_\_\_\_

\* USE CODE:

☐ DOMESTIC ☐ MUNICIPAL/PUBLIC  
☒ IRRIGATION ☐ INDUSTRIAL  
☒ TEST/OBSERVATION ☐ GEOTHERMAL

\* TYPE OF CASING:

☐ STEEL ☒ PLASTIC  
☐ CONCRETE ☐ OTHER (specify) \_\_\_\_\_

SIZE OF CASING: 2 INCHES IN DIAMETER

DEPTH OF WELL: 35 FEET DEEP

WAS ANY CASING REMOVED? ☒ YES ☒ NO

If yes, length removed, in feet: 2

WAS CASING RIPPED OR PERFORATED? ☐ YES ☒ NO

SIGNATURE-MASTER WELL DRILLER OR SUPERVISING SANITARIAN [Signature] LICENSE# MGD110

CIRCLE ONE MWD / MSD / MGS

DATE 6/25/24

ORIGINAL

Pursuant to § 10-624 of the State Govt. Article of the Maryland Code, personal info requested on this form is used in processing this form pursuant to COMAR 26.04.04. Failure to provide the info may result in this form not being processed. You have the right to inspect, amend, or correct this form. The Maryland Department of the Environment is subject to the Maryland Public Information Act. This form may be made available on the Internet via MDE's website and is subject to inspection or copying, in whole or in part, by the public and other governmental agencies, if not protected by federal or State Law.

\*\*\*\*\*  
WATER WELL ABANDONMENT-SEALING REPORT FORM  
\*\*\*\*\*

SUBMIT COPIES OF COMPLETED FORM TO:

- \* COUNTY ENVIRONMENTAL AGENCY (contact MDE, WMA if address needed)
- \* WELL OWNER
- \* MDE, WATER MANAGEMENT ADMINISTRATION, WELL PROGRAM

DATE WELL ABANDONED: 4/17/2024 (month/day/year)

\* PERMIT NUMBER OF ABANDONED WELL (if any)

BA — 95 — 1059

\* PERMIT NUMBER OF REPLACEMENT WELL:

\* PERSON ABANDONING WELL: Steve Venias

WELL DRILLER'S LICENSE NUMBER: J00087

CIRCLE: MWD / MSD / MGD / Jap

\* OWNER'S NAME: Michael J Schech

\* WELL LOCATION:

COUNTY: Baltimore  
NEAREST TOWN: Phoenix  
TAX MAP: 035 BLOCK — PARCEL 0322  
SUBDIVISION: 0000  
SECTION: 3 LOT: 8  
STREET ADDRESS: 14211 Robaste Road

SITE LOCATION MAP

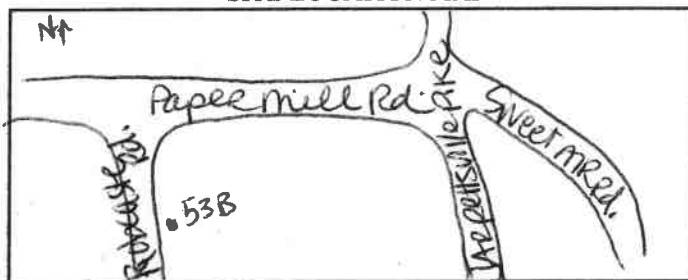

LATITUDE 39.51706

LONGITUDE 76.56354

LOG OF SEALING MATERIAL

MATERIAL	FEET	
	FROM	TO
Cement Bentonite Grout	0	55
VOLUME OF MATERIAL USED		
2.75 ft. <sup>3</sup>		

\* TYPE OF WELL BEING ABANDONED:

☒ DRILLED ☐ JETTED  
☒ BORED ☐ HAND DUG  
☐ OTHER (specify) \_\_\_\_\_

\* USE CODE:

☐ DOMESTIC ☐ MUNICIPAL/PUBLIC  
☒ IRRIGATION ☐ INDUSTRIAL  
☒ TEST/OBSERVATION ☐ GEOTHERMAL

\* TYPE OF CASING:

☐ STEEL ☒ PLASTIC  
☐ CONCRETE ☐ OTHER (specify) \_\_\_\_\_

SIZE OF CASING: 2 INCHES IN DIAMETER

DEPTH OF WELL: 55 FEET DEEP

WAS ANY CASING REMOVED? ☒ YES ☒ NO

If yes, length removed, in feet: 2

WAS CASING RIPPED OR PERFORATED? ☒ YES ☒ NO

SIGNATURE-MASTER WELL DRILLER OR SUPERVISING SANITARIAN LICENSE#

[Signature] MGD110

Pursuant to § 10-624 of the State Govt. Article of the Maryland Code, personal info requested on this form is used in processing this form pursuant to COMAR 26.04.04. Failure to provide the info may result in this form not being processed. You have the right to inspect, amend, or correct this form. The Maryland Department of the Environment is subject to the Maryland Public Information Act. This form may be made available on the Internet via MDE's website and is subject to inspection or copying, in whole or in part, by the public and other governmental agencies, if not protected by federal or State Law.

MWD / MSD / MGS  
CIRCLE ONE

DATE

6/25/24

Real Property Data Search ( )  
Search Result for BALTIMORE COUNTY

[View Map](#)

[View GroundRent Redemption](#)

[View GroundRent Registration](#)

Special Tax Recapture: None

Account Identifier:

District - 10 Account Number - 1800014083

### Owner Information

Owner Name:	SCHECH MICHAEL J	Use:	RESIDENTIAL
		Principal Residence:	YES
Mailing Address:	14211 ROBCASTE RD PHOENIX MD 21131-1453	Deed Reference:	/26677/ 00305

### Location & Structure Information

Premises Address:	14211 ROBCASTE RD PHOENIX 21131-1453	Legal Description:	1.524 AC 66385 SQ FT 14211 ROBCASTE RD ASCOT ESTATES
-------------------	---	--------------------	--

Map:	Grid:	Parcel:	Neighborhood:	Subdivision:	Section:	Block:	Lot:	Assessment Year:	Plat No:
0035	0022	0322	10020025.04	0000	3		8	2023	Plat Ref: 0046/ 0047

Town: None

Primary Structure Built	Above Grade Living Area	Finished Basement Area	Property Land Area	County Use
1996	2,308 SF		1.5200 AC	04

Stories	Basement	Type	Exterior	Quality	Full/Half Bath	Garage	Last Notice of Major Improvements
1	YES	STANDARD UNIT	FRAME/	4	2 full/ 1 half	1 Attached	

### Value Information

	Base Value	Value	Phase-in Assessments	
		As of	As of	As of
		01/01/2023	07/01/2023	07/01/2024
Land:	142,000	257,700		
Improvements	230,500	240,300		
Total:	372,500	498,000	414,333	456,167
Preferential Land:	0	0		

### Transfer Information

Seller: SCHECH MICHAEL J	Date: 02/15/2008	Price: \$0
Type: NON-ARMS LENGTH OTHER	Deed1: /26677/ 00305	Deed2:
Seller: ASCOT ESTATES INCORPORATED	Date: 01/29/1996	Price: \$85,000
Type: ARMS LENGTH VACANT	Deed1: /11403/ 00621	Deed2:
Seller:	Date:	Price:
Type:	Deed1:	Deed2:

### Exemption Information

Partial Exempt Assessments:	Class	07/01/2023	07/01/2024
County:	000	0.00	
State:	000	0.00	
Municipal:	000	0.00/0.00	0.00/0.00

Special Tax Recapture: None

### Homestead Application Information

Homestead Application Status: Approved 05/07/2008

### Homeowners' Tax Credit Application Information

Homeowners' Tax Credit Application Status: No Application

Date:

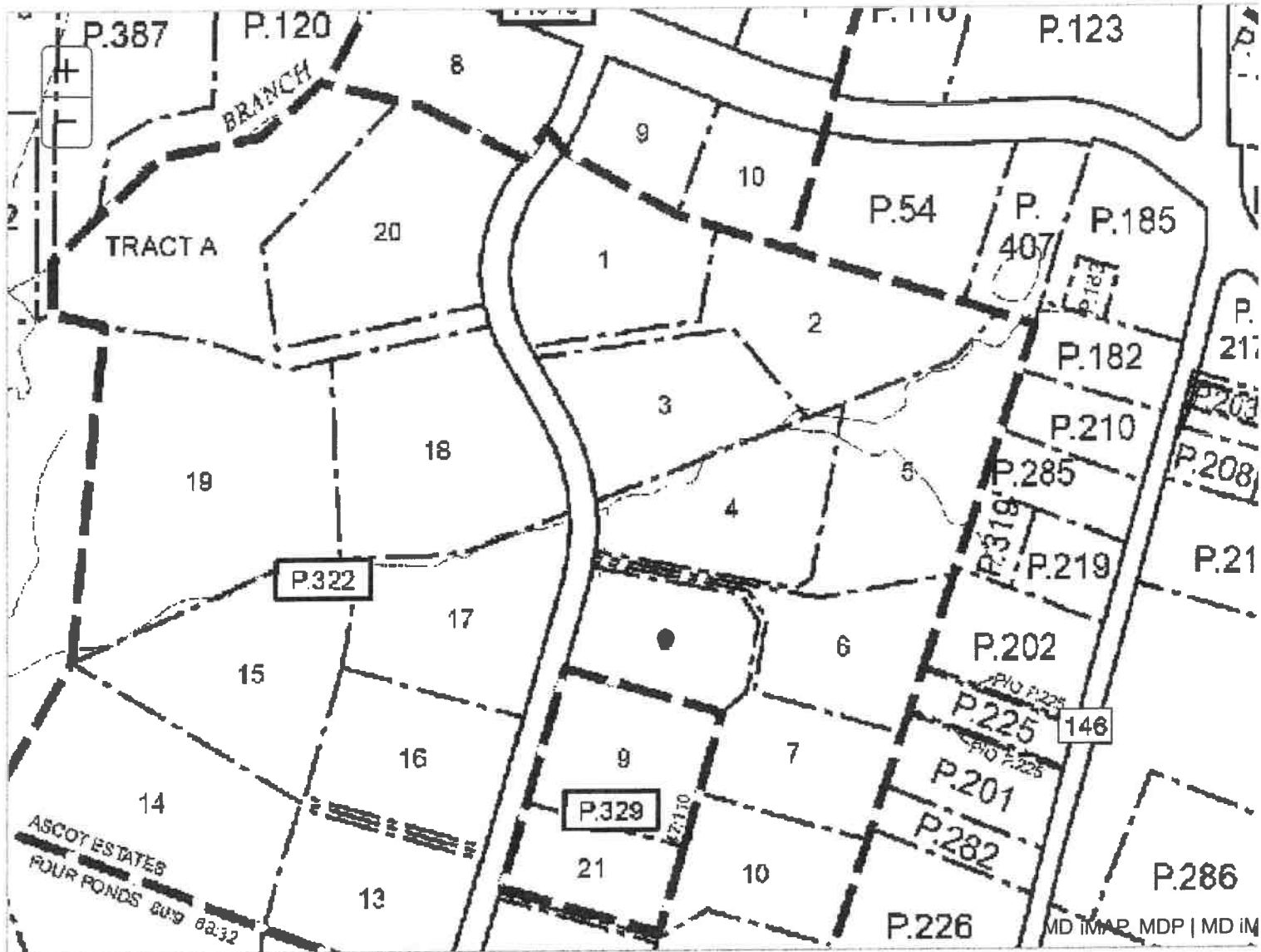
District: **10** Account Number: **1800014083**

The information shown on this map has been compiled from deed descriptions and plats and is not a property survey. The map should not be used for legal descriptions. Users noting errors are urged to notify the Maryland Department of Planning Mapping, 301 W. Preston Street, Baltimore MD 21201.

If a plat for a property is needed, contact the local Land Records office where the property is located. Plats are also available online through the Maryland State Archives at [www.plats.net](http://www.plats.net) (<http://www.plats.net>).

Property maps provided courtesy of the Maryland Department of Planning.

For more information on electronic mapping applications, visit the Maryland Department of Planning web site at <http://planning.maryland.gov/Pages/OurProducts/OurProducts.aspx> (<http://planning.maryland.gov/Pages/OurProducts/OurProducts.aspx>).



\*\*\*\*\*  
WATER WELL ABANDONMENT-SEALING REPORT FORM  
\*\*\*\*\*

SUBMIT COPIES OF COMPLETED FORM TO:

- \* COUNTY ENVIRONMENTAL AGENCY (contact MDE, WMA if address needed)
- \* WELL OWNER
- \* MDE, WATER MANAGEMENT ADMINISTRATION, WELL PROGRAM

DATE WELL ABANDONED: 5/9/2024 (month/day/year)

\* PERMIT NUMBER OF ABANDONED WELL (if any)

BA - 95 - 1058

\* PERMIT NUMBER OF REPLACEMENT WELL:

\* PERSON ABANDONING WELL: Steve Venios WELL DRILLER'S LICENSE NUMBER: JGD087

\* OWNER'S NAME: Michael J Schnech CIRCLE: MWD / MSD / MGD (JGD)

\* WELL LOCATION:

COUNTY: Baltimore

NEAREST TOWN: Phoenix

TAX MAP 0035 BLOCK - PARCEL 0322

SUBDIVISION: 6000

SECTION: 3 LOT: 8

STREET ADDRESS: 14211 Robcaste Road

LATITUDE 39.51696

LONGITUDE 76.56345

SITE LOCATION MAP

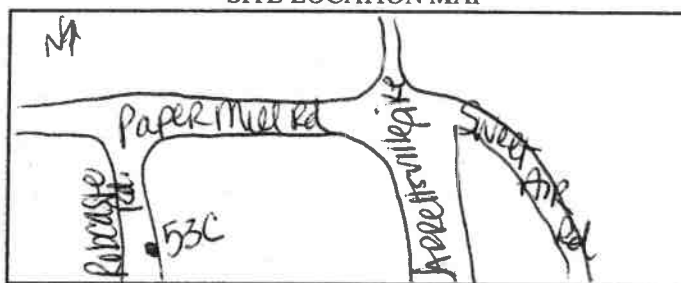

LOG OF SEALING MATERIAL

MATERIAL	FEET	
	FROM	TO
Cement Bentonite Grout	0	82
2B Stone	82	350
VOLUME OF MATERIAL USED		
70 ft. <sup>3</sup>		

\* TYPE OF WELL BEING ABANDONED:

☒ DRILLED ☐ JETTED  
☒ BORED ☐ HAND DUG  
☐ OTHER (specify) \_\_\_\_\_

\* USE CODE:

☐ DOMESTIC ☐ MUNICIPAL/PUBLIC  
☒ IRRIGATION ☐ INDUSTRIAL  
☒ TEST/OBSERVATION ☐ GEOTHERMAL

\* TYPE OF CASING:

☐ STEEL ☐ PLASTIC  
☐ CONCRETE ☐ OTHER (specify) \_\_\_\_\_

SIZE OF CASING: 6 INCHES IN DIAMETER

DEPTH OF WELL: 350 FEET DEEP

WAS ANY CASING REMOVED? ☒ YES ☐ NO

If yes, length removed, in feet: 2

WAS CASING RIPPED OR PERFORATED? ☐ YES ☒ NO

SIGNATURE-MASTER WELL DRILLER OR SUPERVISING SANITARIAN LICENSE#

[Signature] MGD110

CIRCLE ONE MWD MSD / MGS

6/25/24 DATE

ORIGINAL

Pursuant to § 10-624 of the State Govt. Article of the Maryland Code, personal info requested on this form is used in processing this form pursuant to COMAR 26.04.04. Failure to provide the info may result in this form not being processed. You have the right to inspect, amend, or correct this form. The Maryland Department of the Environment is subject to the Maryland Public Information Act. This form may be made available on the Internet via MDE's website and is subject to inspection or copying, in whole or in part, by the public and other governmental agencies, if not protected by federal or State Law.

\*\*\*\*\*  
WATER WELL ABANDONMENT-SEALING REPORT FORM  
\*\*\*\*\*

SUBMIT COPIES OF COMPLETED FORM TO:

- \* COUNTY ENVIRONMENTAL AGENCY (contact MDE, WMA if address needed)
- \* WELL OWNER
- \* MDE, WATER MANAGEMENT ADMINISTRATION, WELL PROGRAM

DATE WELL ABANDONED: 4/19/2024 (month/day/year)

\* PERMIT NUMBER OF ABANDONED WELL (if any)

BA — 95 — 1075

\* PERMIT NUMBER OF REPLACEMENT WELL:

\* PERSON ABANDONING WELL: Steve Venias

WELL DRILLER'S LICENSE NUMBER: J6D087

\* OWNER'S NAME: on street

CIRCLE: MWD / MSD / MGD / J6D

\* WELL LOCATION: Baltimore

SITE LOCATION MAP

COUNTY: \_\_\_\_\_

NEAREST TOWN: Phoenix

TAX MAP 0035 BLOCK \_\_\_\_\_ PARCEL \_\_\_\_\_

SUBDIVISION: 0000

SECTION: \_\_\_\_\_ NEAR LOT: 5

ROW STREET ADDRESS: 3508 Hampshire Glen Ct (on street)

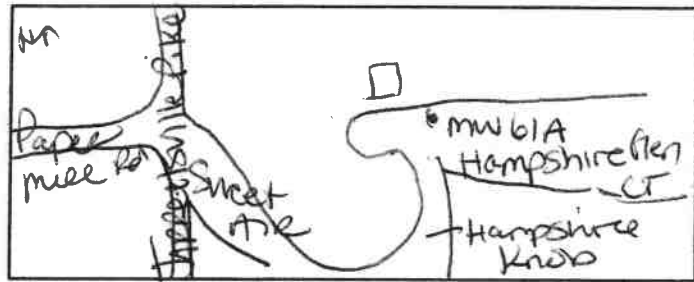

LATITUDE 39.51906 -

LONGITUDE 76.55548 -

LOG OF SEALING MATERIAL

MATERIAL	FEET	
	FROM	TO
Cement Benonite Grout	0	35
VOLUME OF MATERIAL USED		
1.75 ft <sup>3</sup>		

\* TYPE OF WELL BEING ABANDONED:

☒ DRILLED ☐ JETTED  
☒ BORED ☐ HAND DUG  
☐ OTHER (specify) \_\_\_\_\_

\* USE CODE:

☐ DOMESTIC ☐ MUNICIPAL/PUBLIC  
☐ IRRIGATION ☐ INDUSTRIAL  
☒ TEST/OBSERVATION ☐ GEOTHERMAL

\* TYPE OF CASING:

☐ STEEL ☒ PLASTIC  
☐ CONCRETE ☐ OTHER (specify) \_\_\_\_\_

SIZE OF CASING: 2 INCHES IN DIAMETER

DEPTH OF WELL: 35 FEET DEEP

WAS ANY CASING REMOVED? ☒ YES ☐ NO

If yes, length removed, in feet: 2

WAS CASING RIPPED OR PERFORATED? ☐ YES ☒ NO

SIGNATURE-MASTER WELL DRILLER OR SUPERVISING SANITARIAN [Signature] LICENSE# MCD140

MWD / MSD / MGS  
CIRCLE ONE

6/25/24  
DATE

ORIGINAL

Pursuant to § 10-624 of the State Govt. Article of the Maryland Code, personal info requested on this form is used in processing this form pursuant to COMAR 26.04.04. Failure to provide the info may result in this form not being processed. You have the right to inspect, amend, or correct this form. The Maryland Department of the Environment is subject to the Maryland Public Information Act. This form may be made available on the Internet via MDE's website and is subject to inspection or copying, in whole or in part, by the public and other governmental agencies, if not protected by federal or State Law.

[View Map](#)

[View GroundRent Redemption](#)

[View GroundRent Registration](#)

Special Tax Recapture: None

Account Identifier:

District - 10 Account Number - 2100006236

### Owner Information

Owner Name:

LIBERTINI ROBERT ISAAC  
LIBERTINI SUZANNE FREDERICK  
3508 HAMPSHIRE GLEN CT  
PHOENIX MD 21131

Use:

RESIDENTIAL  
YES

Principal Residence:

Deed Reference:

/08592/ 00567

Mailing Address:

### Location & Structure Information

Premises Address:

3508 HAMPSHIRE GLEN CT  
PHOENIX 21131

Legal Description:

1.001 AC

HAMPSHIRE

Map: Grid: Parcel: Neighborhood:  
0035 0024 0356 10020022.04

Subdivision:  
0000

Section:

Block:

Lot:

Assessment Year:

5 2023

Plat No:

Plat Ref: 0058/ 0147

Town: None

Primary Structure Built  
1992

Above Grade Living Area  
3,454 SF

Finished Basement Area

Property Land Area  
1.0000 AC

County Use  
04

Stories Basement Type  
2 YES STANDARD UNIT

Exterior  
SIDING/

Quality  
5

Full/Half Bath  
3 full/ 1 half

Garage  
1 Attached

Last Notice of Major Improvements

### Value Information

Base Value

Value

Phase-in Assessments

As of  
01/01/2023

As of  
07/01/2023

As of  
07/01/2024

Land: 162,000

245,000

Improvements 321,100

424,400

Total: 483,100

669,400

545,200

607,300

Preferential Land:

0

0

### Transfer Information

Seller: HYDES CONSTRUCTI ON COMPANY INC

Date: 09/12/1990

Price: \$78,500

Type: ARMS LENGTH IMPROVED

Deed1: /08592/ 00567

Deed2:

Seller:

Date:

Price:

Type:

Deed1:

Deed2:

Seller:

Date:

Price:

Type:

Deed1:

Deed2:

### Exemption Information

Partial Exempt Assessments:

Class

07/01/2023

07/01/2024

County:

000

0.00

State:

000

0.00

Municipal:

000

0.0000.00

0.0000.00

Special Tax Recapture: None

### Homestead Application Information

Homestead Application Status: Approved 06/18/2009

### Homeowners' Tax Credit Application Information

Homeowners' Tax Credit Application Status: No Application

Date:

**District: 10      Account Number: 2100006236**

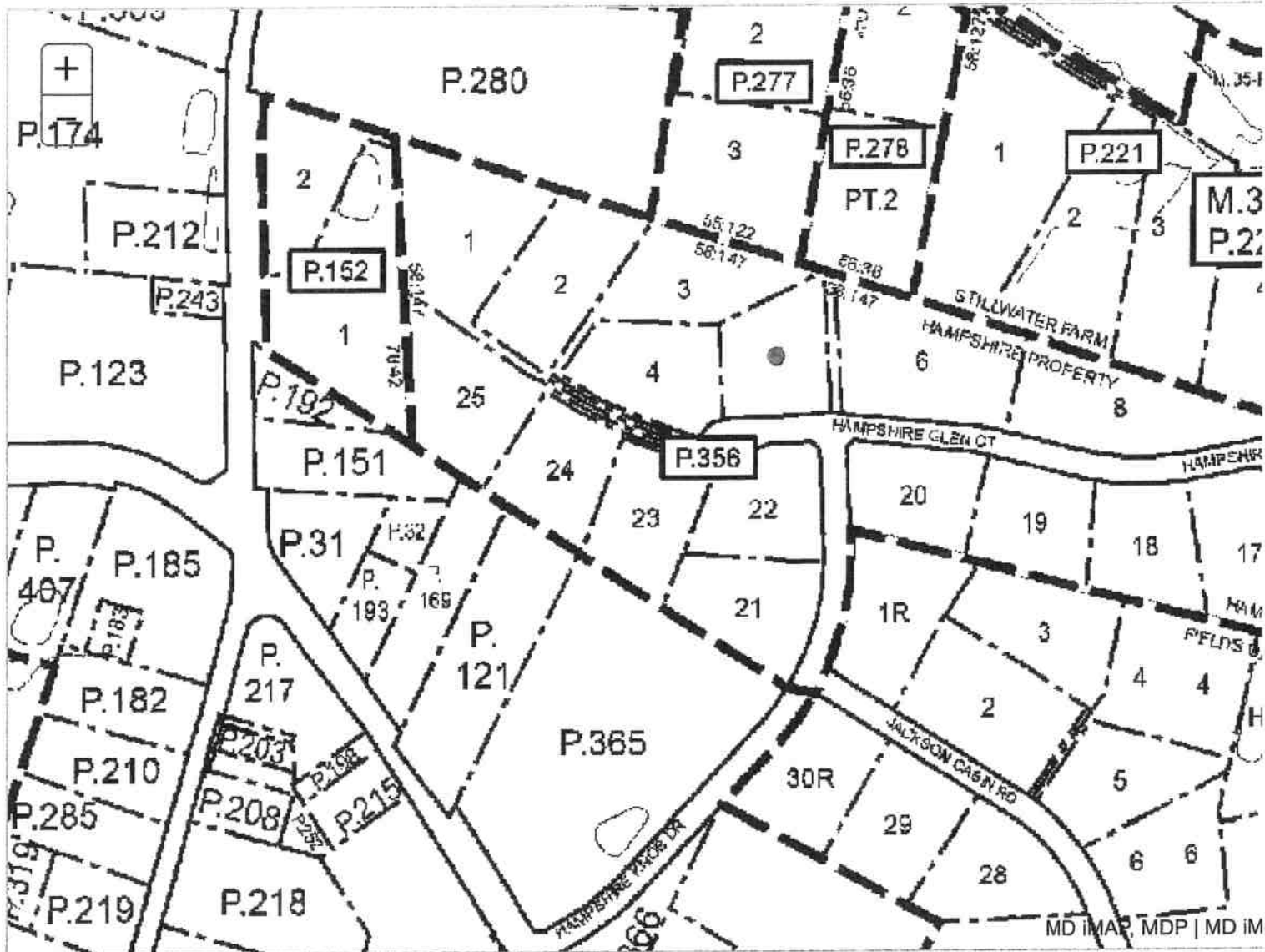

The information shown on this map has been compiled from deed descriptions and plats and is not a property survey. The map should not be used for legal descriptions. Users noting errors are urged to notify the Maryland Department of Planning Mapping, 301 W. Preston Street, Baltimore MD 21201.

If a plat for a property is needed, contact the local Land Records office where the property is located. Plats are also available online through the Maryland State Archives at [www.plats.net](http://www.plats.net) (<http://www.plats.net>).

Property maps provided courtesy of the Maryland Department of Planning.

For more information on electronic mapping applications, visit the Maryland Department of Planning web site at <http://planning.maryland.gov/Pages/OurProducts/OurProducts.aspx> (<http://planning.maryland.gov/Pages/OurProducts/OurProducts.aspx>).

WATER WELL ABANDONMENT-SEALING REPORT FORM

SUBMIT COPIES OF COMPLETED FORM TO:

- \* COUNTY ENVIRONMENTAL AGENCY (contact MDE, WMA if address needed)
- \* WELL OWNER
- \* MDE, WATER MANAGEMENT ADMINISTRATION, WELL PROGRAM

DATE WELL ABANDONED: 4/19/2024 (month/day/year)

\* PERMIT NUMBER OF ABANDONED WELL (if any)

BA - 95 - 1074

\* PERMIT NUMBER OF REPLACEMENT WELL:

\* PERSON ABANDONING WELL: Steve Venios WELL DRILLER'S LICENSE NUMBER: J6D0081

CIRCLE: MWD / MSD / MGD / JGP

\* OWNER'S NAME: on Street

SITE LOCATION MAP

\* WELL LOCATION:  
COUNTY: Baltimore  
NEAREST TOWN: Ft. Detrick  
TAX MAP 0035 BLOCK — PARCEL —  
SUBDIVISION: 0060  
SECTION: — LOT: 5  
STREET ADDRESS: 3508 Hampshire Glen Ct (on Street)

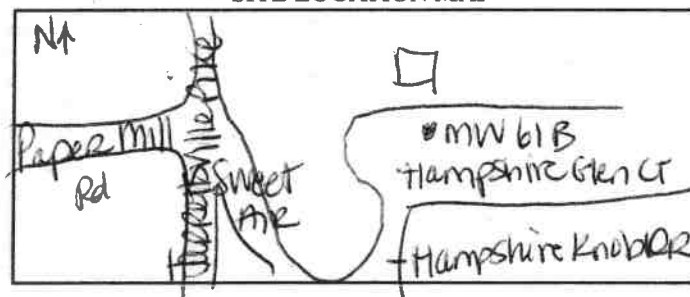

LATITUDE 39.51906

LONGITUDE 76.55545

LOG OF SEALING MATERIAL

MATERIAL	FEET	
	FROM	TO
Cement Bentonite Grout	0	55
VOLUME OF MATERIAL USED		
2.75 ft <sup>3</sup>		

\* TYPE OF WELL BEING ABANDONED:

☒ DRILLED ☐ JETTED  
☒ BORED ☐ HAND DUG  
☐ OTHER (specify) \_\_\_\_\_

\* USE CODE:

☐ DOMESTIC ☐ MUNICIPAL/PUBLIC  
☒ IRRIGATION ☐ INDUSTRIAL  
☒ TEST/OBSERVATION ☐ GEOTHERMAL

\* TYPE OF CASING:

☐ STEEL ☒ PLASTIC  
☐ CONCRETE ☐ OTHER (specify) \_\_\_\_\_

SIZE OF CASING: 2 INCHES IN DIAMETER

DEPTH OF WELL: 55 FEET DEEP

WAS ANY CASING REMOVED? ☒ YES ☒ NO

If yes, length removed, in feet: 2

WAS CASING RIPPED OR PERFORATED? ☐ YES ☒ NO

SIGNATURE-MASTER WELL DRILLER OR SUPERVISING SANITARIAN [Signature] LICENSE# MGD110

CIRCLE ONE MWD / MSD / MGS

DATE 6/25/24

Pursuant to § 10-624 of the State Govt. Article of the Maryland Code, personal info requested on this form is used in processing this form pursuant to COMAR 26.04.04. Failure to provide the info may result in this form not being processed. You have the right to inspect, amend, or correct this form. The Maryland Department of the Environment is subject to the Maryland Public Information Act. This form may be made available on the Internet via MDE's website and is subject to inspection or copying, in whole or in part, by the public and other governmental agencies, if not protected by federal or State Law.

MARYLAND DEPARTMENT OF THE ENVIRONMENT, WATER MANAGEMENT ADMINISTRATION  
1800 Washington Blvd., Baltimore, Maryland 21230 (410) 537-3784

\*\*\*\*\*  
WATER WELL ABANDONMENT-SEALING REPORT FORM  
\*\*\*\*\*

SUBMIT COPIES OF COMPLETED FORM TO:

- \* COUNTY ENVIRONMENTAL AGENCY (contact MDE, WMA if address needed)
- \* WELL OWNER
- \* MDE, WATER MANAGEMENT ADMINISTRATION, WELL PROGRAM

DATE WELL ABANDONED: 4/18/2024 (month/day/year)

\* PERMIT NUMBER OF ABANDONED WELL (if any)

BA - 95 - 1102

\* PERMIT NUMBER OF REPLACEMENT WELL:

\* PERSON ABANDONING WELL: Steve Venios WELL DRILLER'S LICENSE NUMBER: J60087

\* OWNER'S NAME: Despasquale Ricci Carl & Sally Anicia CIRCLE: MWD / MSD / MGD / JGO

\* WELL LOCATION:  
COUNTY: Baltimore  
NEAREST TOWN: Phoenix  
TAX MAP 6035 BLOCK - PARCEL 0322  
SUBDIVISION: 0000  
SECTION: 3 LOT: 18  
STREET ADDRESS: 14210 Robcaste Rd.

SITE LOCATION MAP

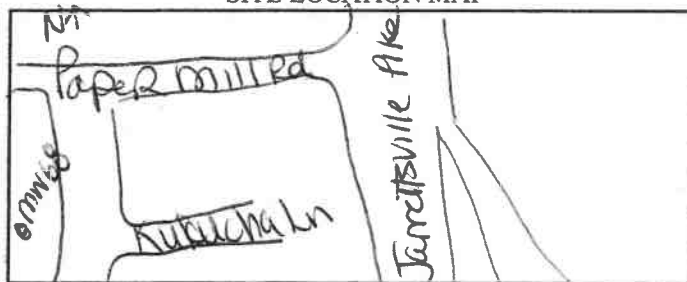

LATITUDE 39.51700

LONGITUDE 76.56410

LOG OF SEALING MATERIAL

MATERIAL	FEET	
	FROM	TO
Cement Bentonite Grout	0	30
VOLUME OF MATERIAL USED		
3 ft. <sup>3</sup>		

\* TYPE OF WELL BEING ABANDONED:

☐ DRILLED ☐ JETTED  
☒ BORED ☐ HAND DUG  
☐ OTHER (specify) \_\_\_\_\_

\* USE CODE:

☐ DOMESTIC ☐ MUNICIPAL/PUBLIC  
☒ IRRIGATION ☐ INDUSTRIAL  
☐ TEST/OBSERVATION ☐ GEOTHERMAL

\* TYPE OF CASING:

☐ STEEL ☒ PLASTIC  
☐ CONCRETE ☐ OTHER (specify) \_\_\_\_\_

SIZE OF CASING: 4 INCHES IN DIAMETER

DEPTH OF WELL: 30 FEET DEEP

WAS ANY CASING REMOVED? ☒ YES ☐ NO

If yes, length removed, in feet: 2

WAS CASING RIPPED OR PERFORATED? ☐ YES ☒ NO

SIGNATURE-MASTER WELL DRILLER OR SUPERVISING SANITARIAN [Signature] LICENSE# MGD110

Pursuant to § 10-624 of the State Govt. Article of the Maryland Code, personal info requested on this form is used in processing this form pursuant to COMAR 26.04.04. Failure to provide the info may result in this form not being processed. You have the right to inspect, amend, or correct this form. The Maryland Department of the Environment is subject to the Maryland Public Information Act. This form may be made available on the Internet via MDE's website and is subject to inspection or copying, in whole or in part, by the public and other governmental agencies, if not protected by federal or State Law.

CIRCLE ONE MWD / MSD / MGS 6/25/24  
DATE

ORIGINAL

Real Property Data Search ( )  
Search Result for BALTIMORE COUNTY

View Map

View GroundRent Redemption

View GroundRent Registration

Special Tax Recapture: None

Account Identifier:District - 10 Account Number - 1800014093

Owner Information

Owner Name:

DEPASQUALE RICCI CARL  
DEPASQUALE SALLY ALICIA

Use:

RESIDENTIAL  
YES

Mailing Address:

14210 ROBCASTE RD  
PHOENIX MD 21131

Principal Residence:

Deed Reference:

/08034/ 00031

Location & Structure Information

Premises Address:

14210 ROBCASTE RD  
PHOENIX 21131

Legal Description:

3.378 AC 147145 SQ F  
ASCOT ESTATES

Map: Grid: Parcel: Neighborhood: Subdivision: Section: Block: Lot: Assessment Year: Plat No:

0035 0022 0322 10020025.04 0000 3 18 2023 0046/ 0047

Town: None

Primary Structure Built

Above Grade Living Area

Finished Basement Area

Property Land Area

County Use

1989 3,000 SF 800 SF 3.3700 AC 04

Stories

Basement

Type

Exterior

Quality

Full/Half Bath

Garage

Last Notice of Major Improvements

2 YES STANDARD UNIT FRAME/ 5 3 full/ 1 half 1 Attached

Value Information

Base Value

Value

Phase-in Assessments

As of 01/01/2023

As of 07/01/2023

As of 07/01/2024

Land:

Improvements

Total:

Preferential Land:

166,900 385,200 552,100 0 303,000 359,100 662,100 0 588,767 625,433

Transfer Information

Seller: KIM SEONG JIN

Date: 11/23/1988

Price: \$73,000

Type: ARMS LENGTH IMPROVED

Deed1: /08034/ 00031

Deed2:

Seller:

Date:

Price:

Type:

Deed1:

Deed2:

Seller:

Date:

Price:

Type:

Deed1:

Deed2:

Exemption Information

Partial Exempt Assessments:

Class

07/01/2023

07/01/2024

County:

000

0.00

State:

000

0.00

Municipal:

000

0.00|0.00

0.00|0.00

Special Tax Recapture: None

Homestead Application Information

Homestead Application Status: Approved 05/15/2008

Homeowners' Tax Credit Application Information

Homeowners' Tax Credit Application Status: No Application

Date:

District: **10** Account Number: **1800014093**



The information shown on this map has been compiled from deed descriptions and plats and is not a property survey. The map should not be used for legal descriptions. Users noting errors are urged to notify the Maryland Department of Planning Mapping, 301 W. Preston Street, Baltimore MD 21201.

If a plat for a property is needed, contact the local Land Records office where the property is located. Plats are also available online through the Maryland State Archives at [www.plats.net](http://www.plats.net) (<http://www.plats.net>).

Property maps provided courtesy of the Maryland Department of Planning.

For more information on electronic mapping applications, visit the Maryland Department of Planning web site at <http://planning.maryland.gov/Pages/OurProducts/OurProducts.aspx> (<http://planning.maryland.gov/Pages/OurProducts/OurProducts.aspx>).



MARYLAND DEPARTMENT OF THE ENVIRONMENT, WATER MANAGEMENT ADMINISTRATION  
1800 Washington Blvd., Baltimore, Maryland 21230 (410) 537-3784

\*\*\*\*\*  
WATER WELL ABANDONMENT-SEALING REPORT FORM  
\*\*\*\*\*

SUBMIT COPIES OF COMPLETED FORM TO:

- \* COUNTY ENVIRONMENTAL AGENCY (contact MDE, WMA if address needed)
- \* WELL OWNER
- \* MDE, WATER MANAGEMENT ADMINISTRATION, WELL PROGRAM

DATE WELL ABANDONED: 4/29/2024 (month/day/year)

\* PERMIT NUMBER OF ABANDONED WELL (if any)

BA - 95 - 1101

\* PERMIT NUMBER OF REPLACEMENT WELL:

\* PERSON ABANDONING WELL: Steve Venios

WELL DRILLER'S LICENSE NUMBER: J60087

\* OWNER'S NAME: Jarrettsville Pike LLC

CIRCLE: MWD / MSD / MGD / J60

\* WELL LOCATION:

COUNTY: Baltimore

NEAREST TOWN: Phoenix

TAX MAP 035 BLOCK - PARCEL 0192

SUBDIVISION: 0000

SECTION: - LOT: -

STREET ADDRESS: 14311 Jarrettsville Pike

LATITUDE 39.519209

LONGITUDE 76.558801

SITE LOCATION MAP

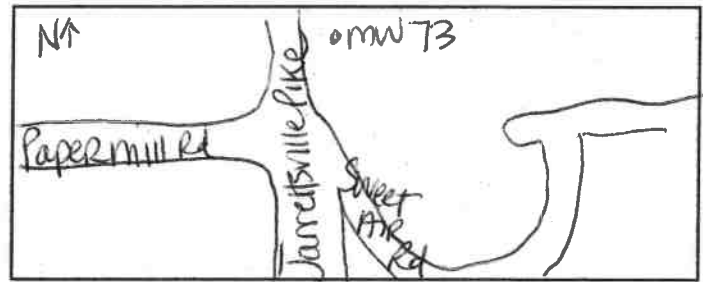

LOG OF SEALING MATERIAL

MATERIAL	FEET	
	FROM	TO
Cement Bentonite Grout	0	65
VOLUME OF MATERIAL USED		
13 ft <sup>3</sup>		

\* TYPE OF WELL BEING ABANDONED:

☒ DRILLED ☐ JETTED  
☒ BORED ☐ HAND DUG  
☒ OTHER (specify) -

\* USE CODE:

☐ DOMESTIC ☐ MUNICIPAL/PUBLIC  
☐ IRRIGATION ☐ INDUSTRIAL  
☒ TEST/OBSERVATION ☐ GEOTHERMAL

\* TYPE OF CASING:

☐ STEEL ☒ PLASTIC  
☐ CONCRETE ☐ OTHER (specify) -

SIZE OF CASING: 6 INCHES IN DIAMETER

DEPTH OF WELL: 65 FEET DEEP

WAS ANY CASING REMOVED? ☒ YES ☒ NO

If yes, length removed, in feet: 2

WAS CASING RIPPED OR PERFORATED? ☐ YES ☒ NO

SIGNATURE-MASTER WELL DRILLER OR SUPERVISING SANITARIAN [Signature] LICENSE# MCD110

CIRCLE ONE MWD / MSD / MGS

DATE 6/25/25

ORIGINAL

Pursuant to § 10-624 of the State Govt. Article of the Maryland Code, personal info requested on this form is used in processing this form pursuant to COMAR 26.04.04. Failure to provide the info may result in this form not being processed. You have the right to inspect, amend, or correct this form. The Maryland Department of the Environment is subject to the Maryland Public Information Act. This form may be made available on the Internet via MDE's website and is subject to inspection or copying, in whole or in part, by the public and other governmental agencies, if not protected by federal or State Law.

Real Property Data Search ( )  
Search Result for BALTIMORE COUNTY

View Map

Special Tax Recapture: None

View GroundRent Redemption

Account Identifier: District - 10 Account Number - 1012040050

View GroundRent Registration

Owner Information

Owner Name: JARRETTSVILLE PIKE LLC

Use: COMMERCIAL

Principal Residence: NO

Mailing Address: 13804 MANOR GLEN ROAD  
BALDWIN MD 21013-9713

Deed Reference: /15885/ 00692

Location & Structure Information

Premises Address: 14311 JARRETTSVILLE PIKE  
0-0000

Legal Description: ES JARRETTSVILLE RD  
14311 JARRETTSVILLE PIKE  
225 N PAPER MILL RD

Map:	Grid:	Parcel:	Neighborhood:	Subdivision:	Section:	Block:	Lot:	Assessment Year:	Plat No:
0035	0024	0192	10000.04	0000				2022	
Town: None									Plat Ref:

Primary Structure Built

Above Grade Living Area

Finished Basement Area

Property Land Area  
14,572 SF

County Use  
06

Stories	Basement	Type	Exterior	Quality	Full/Half Bath	Garage	Last Notice of Major Improvements	
/								

Value Information

	Base Value	Value	Phase-in Assessments	
		As of	As of	As of
		01/01/2022	07/01/2023	07/01/2024
Land:	156,900	156,900		
Improvements	0	0		
Total:	156,900	156,900	156,900	156,900
Preferential Land:	0	0		

Transfer Information

Seller: STUMPP GEORGE B	Date: 12/21/2001	Price: \$121,000
Type: ARMS LENGTH VACANT	Deed1: /15885/ 00692	Deed2:
Seller: MCCLEARY BENJAMIN GEORGE	Date: 06/25/1997	Price: \$114,000
Type: ARMS LENGTH VACANT	Deed1: /12251/ 00240	Deed2:
Seller: LINS GEORGE M	Date: 10/19/1989	Price: \$192,933
Type: ARMS LENGTH IMPROVED	Deed1: /08302/ 00344	Deed2:

Exemption Information

Partial Exempt Assessments:	Class	07/01/2023	07/01/2024
County:	000	0.00	
State:	000	0.00	
Municipal:	000	0.00 0.00	0.00 0.00
Special Tax Recapture: None			

Homestead Application Information

Homestead Application Status: No Application

Homeowners' Tax Credit Application Information

Homeowners' Tax Credit Application Status: No Application

Date:

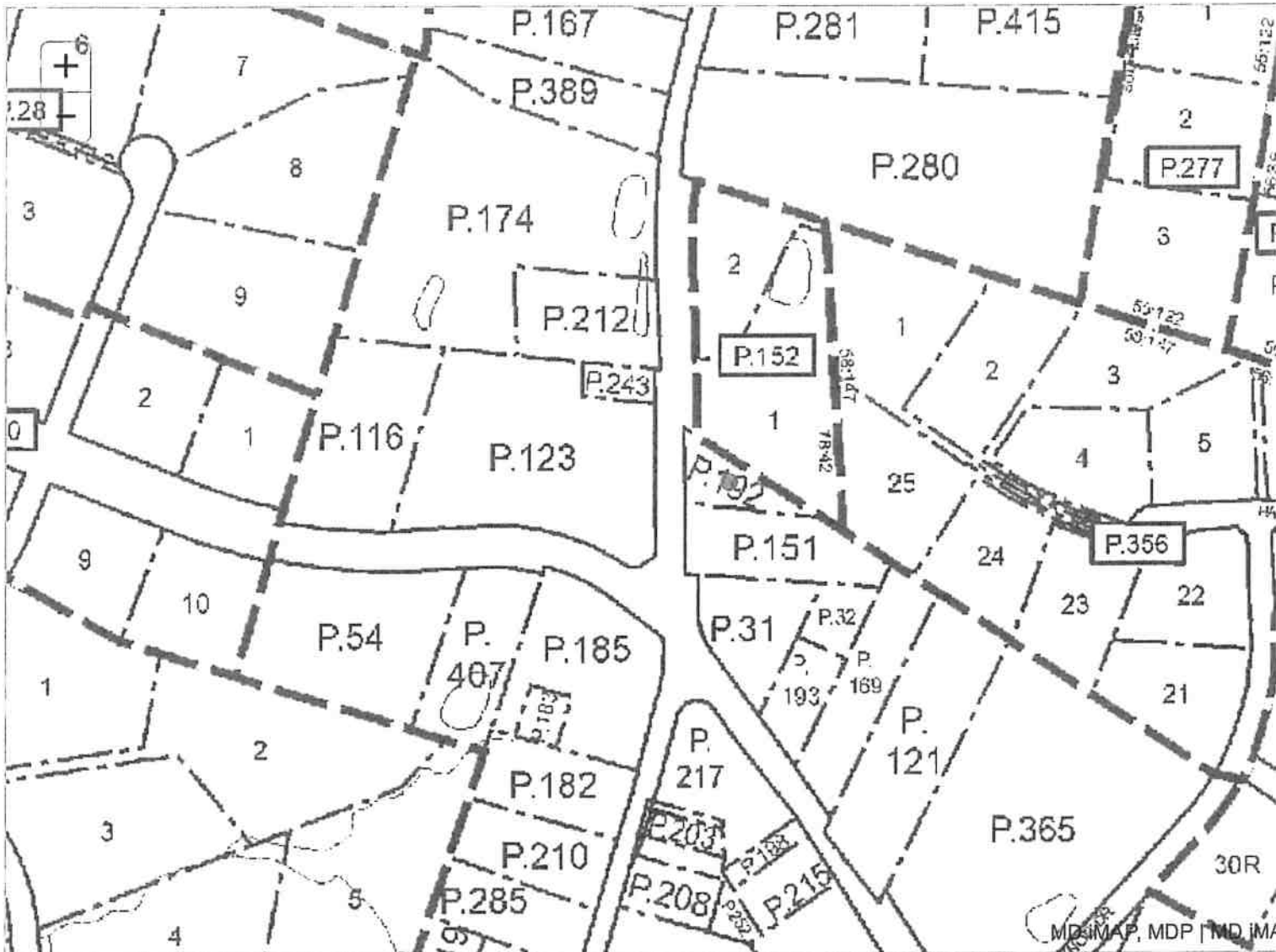
District: **10** Account Number: **1012040050**

The information shown on this map has been compiled from deed descriptions and plats and is not a property survey. The map should not be used for legal descriptions. Users noting errors are urged to notify the Maryland Department of Planning Mapping, 301 W. Preston Street, Baltimore MD 21201.

If a plat for a property is needed, contact the local Land Records office where the property is located. Plats are also available online through the Maryland State Archives at [www.plats.net](http://www.plats.net) (<http://www.plats.net>).

Property maps provided courtesy of the Maryland Department of Planning.

For more information on electronic mapping applications, visit the Maryland Department of Planning web site at <http://planning.maryland.gov/Pages/OurProducts/OurProducts.aspx> (<http://planning.maryland.gov/Pages/OurProducts/OurProducts.aspx>).

\*\*\*\*\*  
WATER WELL ABANDONMENT-SEALING REPORT FORM  
\*\*\*\*\*

SUBMIT COPIES OF COMPLETED FORM TO:

- \* COUNTY ENVIRONMENTAL AGENCY (contact MDE, WMA if address needed)
- \* WELL OWNER
- \* MDE, WATER MANAGEMENT ADMINISTRATION, WELL PROGRAM

DATE WELL ABANDONED: 4/23/2024 (month/day/year)

\* PERMIT NUMBER OF ABANDONED WELL (if any)

BA 95 1099

\* PERMIT NUMBER OF REPLACEMENT WELL:

\* PERSON ABANDONING WELL: Steve Venios WELL DRILLER'S LICENSE NUMBER: JG0087

\* OWNER'S NAME: Libertini Robert Isaac & Suzanne Frederick CIRCLE: MWD / MSD / MGD / JGD

\* WELL LOCATION:

COUNTY: Baltimore  
NEAREST TOWN: Phoenix  
TAX MAP 0035 BLOCK - PARCEL 0356  
SUBDIVISION: 0000  
SECTION: - LOT: 5  
STREET ADDRESS: 3508 Hampshire Glen Ct

LATITUDE 39.51902

LONGITUDE 76.55078

SITE LOCATION MAP

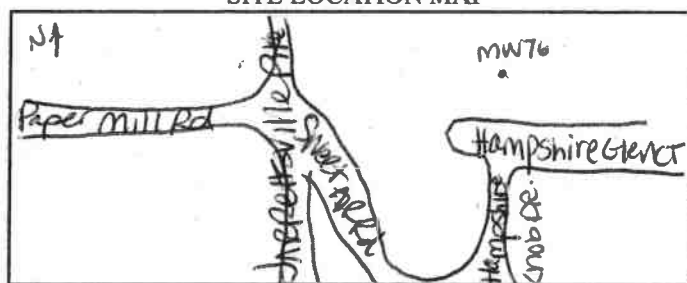

LOG OF SEALING MATERIAL

MATERIAL	FEET	
	FROM	TO
Cement Bentonite grout	0	56
VOLUME OF MATERIAL USED		
11.2 ft <sup>3</sup>		

\* TYPE OF WELL BEING ABANDONED:

☒ DRILLED ☐ JETTED  
☒ BORED ☐ HAND DUG  
☐ OTHER (specify) \_\_\_\_\_

\* USE CODE:

☐ DOMESTIC ☐ MUNICIPAL/PUBLIC  
☒ IRRIGATION ☐ INDUSTRIAL  
☐ TEST/OBSERVATION ☐ GEOTHERMAL

\* TYPE OF CASING:

☐ STEEL ☒ PLASTIC  
☐ CONCRETE ☐ OTHER (specify) \_\_\_\_\_

SIZE OF CASING: 6 INCHES IN DIAMETER

DEPTH OF WELL: 56 FEET DEEP

WAS ANY CASING REMOVED? ☒ YES ☐ NO

If yes, length removed, in feet: 2

WAS CASING RIPPED OR PERFORATED? ☐ YES ☒ NO

SIGNATURE-MASTER WELL DRILLER OR SUPERVISING SANITARIAN [Signature] LICENSE# MGD110

MWD / MSD / MGS  
CIRCLE ONE

6/25/24  
DATE

Pursuant to § 10-624 of the State Govt. Article of the Maryland Code, personal info requested on this form is used in processing this form pursuant to COMAR 26.04.04. Failure to provide the info may result in this form not being processed. You have the right to inspect, amend, or correct this form. The Maryland Department of the Environment is subject to the Maryland Public Information Act. This form may be made available on the Internet via MDE's website and is subject to inspection or copying, in whole or in part, by the public and other governmental agencies, if not protected by federal or State Law.

MARYLAND DEPARTMENT OF THE ENVIRONMENT, WATER MANAGEMENT ADMINISTRATION  
1800 Washington Blvd., Baltimore, Maryland 21230 (410) 537-3784

\*\*\*\*\*  
WATER WELL ABANDONMENT-SEALING REPORT FORM  
\*\*\*\*\*

SUBMIT COPIES OF COMPLETED FORM TO:

- \* COUNTY ENVIRONMENTAL AGENCY (contact MDE, WMA if address needed)
- \* WELL OWNER
- \* MDE, WATER MANAGEMENT ADMINISTRATION, WELL PROGRAM

DATE WELL ABANDONED: 4/23/2024 (month/day/year)

\* PERMIT NUMBER OF ABANDONED WELL (if any)

BA-95-1091

\* PERMIT NUMBER OF REPLACEMENT WELL:

\* PERSON ABANDONING WELL: Stwe Venias WELL DRILLER'S LICENSE NUMBER: JG0087

\* OWNER'S NAME: Libertini Robert / Isaac & Suzanne Frederick CIRCLE: MWD / MSD / MGD / JEO

\* WELL LOCATION: Baltimore  
COUNTY: Baltimore  
NEAREST TOWN: Phoenix  
TAX MAP 0035 BLOCK - PARCEL 0350  
SUBDIVISION: 0000  
SECTION: - LOT: 5  
STREET ADDRESS: 3508 Hampshire Glen Ct

SITE LOCATION MAP

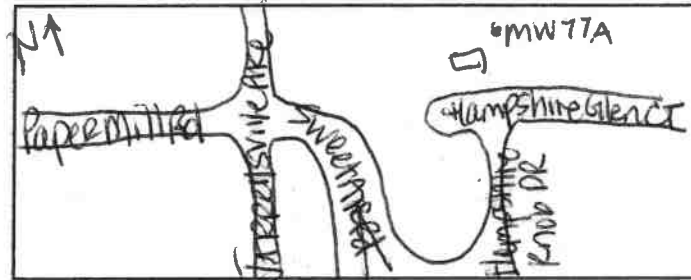

LATITUDE 39.51950  
LONGITUDE 76.55548

LOG OF SEALING MATERIAL

MATERIAL	FEET	
	FROM	TO
Cement Bentonite grout	0	25
VOLUME OF MATERIAL USED		
5 ft.3		

\* TYPE OF WELL BEING ABANDONED:

☐ DRILLED ☐ JETTED  
☒ BORED ☐ HAND DUG  
☐ OTHER (specify) \_\_\_\_\_

\* USE CODE:

☐ DOMESTIC ☐ MUNICIPAL/PUBLIC  
☒ IRRIGATION ☐ INDUSTRIAL  
☒ TEST/OBSERVATION ☐ GEOTHERMAL

\* TYPE OF CASING:

☐ STEEL ☒ PLASTIC  
☐ CONCRETE ☐ OTHER (specify) \_\_\_\_\_

SIZE OF CASING: 6 INCHES IN DIAMETER

DEPTH OF WELL: 25 FEET DEEP

WAS ANY CASING REMOVED? ☒ YES ☒ NO

If yes, length removed, in feet: 2

WAS CASING RIPPED OR PERFORATED? ☒ YES ☐ NO

SIGNATURE-MASTER WELL DRILLER OR SUPERVISING SANITARIAN [Signature] LICENSE# MD0110

CIRCLE ONE MWD / MSD / MGS 6/25/24 DATE

ORIGINAL

Pursuant to § 10-624 of the State Govt. Article of the Maryland Code, personal info requested on this form is used in processing this form pursuant to COMAR 26.04.04. Failure to provide the info may result in this form not being processed. You have the right to inspect, amend, or correct this form. The Maryland Department of the Environment is subject to the Maryland Public Information Act. This form may be made available on the Internet via MDE's website and is subject to inspection or copying, in whole or in part, by the public and other governmental agencies, if not protected by federal or State Law.

\*\*\*\*\*  
WATER WELL ABANDONMENT-SEALING REPORT FORM  
\*\*\*\*\*

SUBMIT COPIES OF COMPLETED FORM TO:

- \* COUNTY ENVIRONMENTAL AGENCY (contact MDE, WMA if address needed)
- \* WELL OWNER
- \* MDE, WATER MANAGEMENT ADMINISTRATION, WELL PROGRAM

DATE WELL ABANDONED: 4/23/2024 (month/day/year)

\* PERMIT NUMBER OF ABANDONED WELL (if any)

BA - 95 - 1096

\* PERMIT NUMBER OF REPLACEMENT WELL:

\* PERSON ABANDONING WELL: Steve Venios WELL DRILLER'S LICENSE NUMBER: J60081

\* OWNER'S NAME: Libertini Robert Isaac & Suzanne Frederick CIRCLE: MWD / MSD / MGD / J60

\* WELL LOCATION:

COUNTY: Baltimore

NEAREST TOWN: Phoenix

TAX MAP: 0035 BLOCK: - PARCEL: D356

SUBDIVISION: 6000

SECTION: - LOT: 5

STREET ADDRESS: 3508 Hampshire Glen Ct

LATITUDE 39.51950

LONGITUDE 76.55546

SITE LOCATION MAP

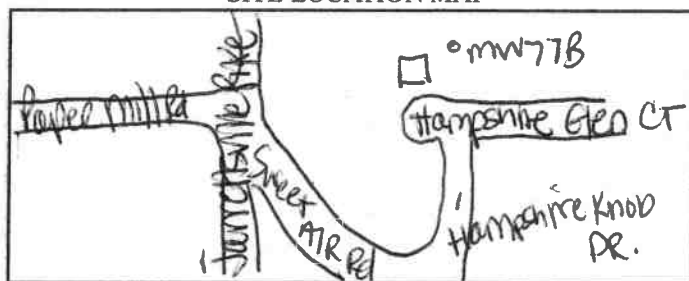

LOG OF SEALING MATERIAL

MATERIAL	FEET	
	FROM	TO
Cement Bentonite grout	0	43
VOLUME OF MATERIAL USED		
8.6 ft. <sup>3</sup>		

\* TYPE OF WELL BEING ABANDONED:

☒ DRILLED ☐ JETTED  
☒ BORED ☐ HAND DUG  
☐ OTHER (specify) \_\_\_\_\_

\* USE CODE:

☐ DOMESTIC ☐ MUNICIPAL/PUBLIC  
☐ IRRIGATION ☐ INDUSTRIAL  
☒ TEST/OBSERVATION ☐ GEOTHERMAL

\* TYPE OF CASING:

☐ STEEL ☒ PLASTIC  
☐ CONCRETE ☐ OTHER (specify) \_\_\_\_\_

SIZE OF CASING: 6 INCHES IN DIAMETER

DEPTH OF WELL: 43 FEET DEEP

WAS ANY CASING REMOVED? ☒ YES ☒ NO  
If yes, length removed, in feet: 2

WAS CASING RIPPED OR PERFORATED? ☐ YES ☒ NO

SIGNATURE-MASTER WELL DRILLER OR SUPERVISING SANITARIAN [Signature] LICENSE# MED110

CIRCLE ONE MWD / MSD / MGS

DATE 7/12/24

Pursuant to § 10-624 of the State Govt. Article of the Maryland Code, personal info requested on this form is used in processing this form pursuant to COMAR 26.04.04. Failure to provide the info may result in this form not being processed. You have the right to inspect, amend, or correct this form. The Maryland Department of the Environment is subject to the Maryland Public Information Act. This form may be made available on the Internet via MDE's website and is subject to inspection or copying, in whole or in part, by the public and other governmental agencies, if not protected by federal or State Law.

WATER WELL ABANDONMENT-SEALING REPORT FORM

SUBMIT COPIES OF COMPLETED FORM TO:

- \* COUNTY ENVIRONMENTAL AGENCY (contact MDE, WMA if address needed)
- \* WELL OWNER
- \* MDE, WATER MANAGEMENT ADMINISTRATION, WELL PROGRAM

DATE WELL ABANDONED: 4/25/2024 (month/day/year)

\* PERMIT NUMBER OF ABANDONED WELL (if any)

BA 45 -1093

\* PERMIT NUMBER OF REPLACEMENT WELL:

\* PERSON ABANDONING WELL: Steve Venios

WELL DRILLER'S LICENSE NUMBER: JG0087

\* OWNER'S NAME: Sullivan Brendan P & Emily M

CIRCLE: MWD / MSD / MGD (JG0)

\* WELL LOCATION:

COUNTY: Baltimore

NEAREST TOWN: Phoenix

TAX MAP 0035 BLOCK 1 PARCEL 0221

SUBDIVISION: 0000

SECTION: 2 LOT: 2

STREET ADDRESS: 3605B Southside Ave

SITE LOCATION MAP

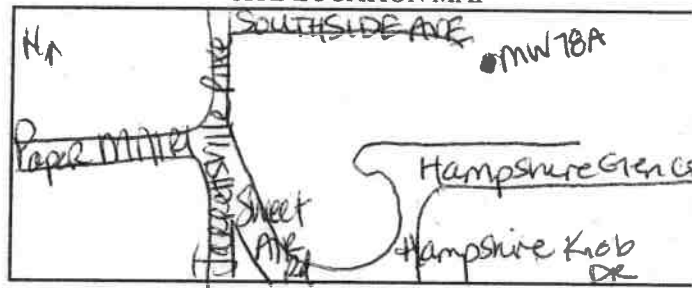

LATITUDE 39.51984

LONGITUDE 76.55424

LOG OF SEALING MATERIAL

MATERIAL	FEET	
	FROM	TO
Cement Bentonite Grout	0	22
VOLUME OF MATERIAL USED		
2.2 ft. <sup>3</sup>		

\* TYPE OF WELL BEING ABANDONED:

☒ DRILLED ☐ JETTED  
☒ BORED ☐ HAND DUG  
☐ OTHER (specify) \_\_\_\_\_

\* USE CODE:

☐ DOMESTIC ☐ MUNICIPAL/PUBLIC  
☒ IRRIGATION ☐ INDUSTRIAL  
☐ TEST/OBSERVATION ☐ GEOTHERMAL

\* TYPE OF CASING:

☐ STEEL ☒ PLASTIC  
☐ CONCRETE ☐ OTHER (specify) \_\_\_\_\_

SIZE OF CASING: 4 INCHES IN DIAMETER

DEPTH OF WELL: 22 FEET DEEP

WAS ANY CASING REMOVED? ☒ YES ☒ NO

If yes, length removed, in feet: 2

WAS CASING RIPPED OR PERFORATED? ☐ YES ☒ NO

SIGNATURE-MASTER WELL DRILLER OR SUPERVISING SANITARIAN [Signature] LICENSE# MGD110

CIRCLE ONE MWD / MSD / MGS

6/25/24 DATE

ORIGINAL

Pursuant to § 10-624 of the State Govt. Article of the Maryland Code, personal info requested on this form is used in processing this form pursuant to COMAR 26.04.04. Failure to provide the info may result in this form not being processed. You have the right to inspect, amend, or correct this form. The Maryland Department of the Environment is subject to the Maryland Public Information Act. This form may be made available on the Internet via MDE's website and is subject to inspection or copying, in whole or in part, by the public and other governmental agencies, if not protected by federal or State Law.

WATER WELL ABANDONMENT-SEALING REPORT FORM

SUBMIT COPIES OF COMPLETED FORM TO:

- \* COUNTY ENVIRONMENTAL AGENCY (contact MDE, WMA if address needed)
- \* WELL OWNER
- \* MDE, WATER MANAGEMENT ADMINISTRATION, WELL PROGRAM

DATE WELL ABANDONED: 4/25/2024 (month/day/year)

\* PERMIT NUMBER OF ABANDONED WELL (if any)

BA - 95 - 1092

\* PERMIT NUMBER OF REPLACEMENT WELL:

\* PERSON ABANDONING WELL: Steve Venios

WELL DRILLER'S LICENSE NUMBER: JG00087

CIRCLE: MWD / MSD / MGD / JG0

\* OWNER'S NAME: Sullivan Brendan P & Emily M

\* WELL LOCATION:

COUNTY: Baltimore

NEAREST TOWN: Phoenix

TAX MAP 0035 BLOCK — PARCEL 0221

SUBDIVISION: 0000

SECTION: 2 LOT: 2

STREET ADDRESS: 3605B Southside Ave

LATITUDE 39.51977

LONGITUDE 76.55427

SITE LOCATION MAP

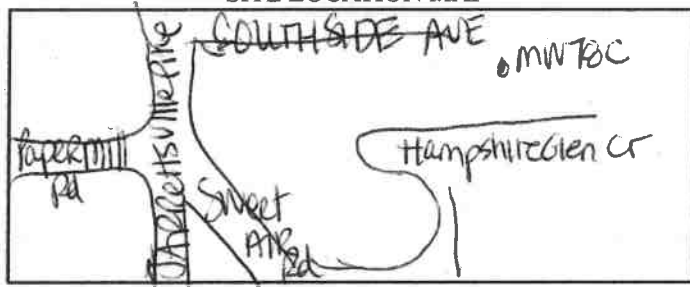

LOG OF SEALING MATERIAL

MATERIAL	FEET	
	FROM	TO
Cement	0	80
Bentonite		
Grout		
2B Stone	80	300
VOLUME OF MATERIAL USED		
<u>60 ft. 3</u>		

\* TYPE OF WELL BEING ABANDONED:

☐ DRILLED ☐ JETTED  
☒ BORED ☐ HAND DUG  
☐ OTHER (specify) \_\_\_\_\_

\* USE CODE:

☐ DOMESTIC ☐ MUNICIPAL/PUBLIC  
☒ IRRIGATION ☐ INDUSTRIAL  
☒ TEST/OBSERVATION ☐ GEOTHERMAL

\* TYPE OF CASING:

☐ STEEL ☒ PLASTIC  
☐ CONCRETE ☐ OTHER (specify) \_\_\_\_\_

SIZE OF CASING: 6 INCHES IN DIAMETER

DEPTH OF WELL: 300 FEET DEEP

WAS ANY CASING REMOVED? ☒ YES ☐ NO

If yes, length removed, in feet: 2

WAS CASING RIPPED OR PERFORATED? ☐ YES ☒ NO

SIGNATURE-MASTER WELL DRILLER OR SUPERVISING SANITARIAN [Signature] LICENSE# MGD110

CIRCLE ONE MWD / MSD / MGS

DATE 6/25/24

Pursuant to § 10-624 of the State Govt. Article of the Maryland Code, personal info requested on this form is used in processing this form pursuant to COMAR 26.04.04. Failure to provide the info may result in this form not being processed. You have the right to inspect, amend, or correct this form. The Maryland Department of the Environment is subject to the Maryland Public Information Act. This form may be made available on the Internet via MDE's website and is subject to inspection or copying, in whole or in part, by the public and other governmental agencies, if not protected by federal or State Law.



Real Property Data Search ( )  
Search Result for BALTIMORE COUNTY

View Map

Special Tax Recapture: None

View GroundRent Redemption

District - 10 Account Number - 2100005302

View GroundRent Registration

Account Identifier:

District - 10 Account Number - 2100005302

Owner Information

Owner Name:

SULLIVAN BRENDAN P  
SULLIVAN EMILY M

Mailing Address:

3605B SOUTHSIDE AVE  
JACKSONVILLE MD 21131-1734

Use:

RESIDENTIAL

Principal Residence:

YES

Deed Reference:

/13168/ 00476

Location & Structure Information

Premises Address:

3605B SOUTHSIDE AVE  
JACKSONVILLE 21131-1734

Legal Description:

1.95 AC  
3605B SOUTHSIDE AVE  
STILLWATER FARM

Map: Grid: Parcel: Neighborhood: Subdivision: Section: Block: Lot: Assessment Year: Plat No:

0035 0024 0221 10020020.04 0000 2 2 2023 0058/ 0127

Town: None

Primary Structure Built

1991

Above Grade Living Area

3,948 SF

Finished Basement Area

1200 SF

Property Land Area

1.9500 AC

County Use

04

Stories

2 1/2

Basement

YES

Type

STANDARD UNIT

Exterior

SIDING/

Quality

4

Full/Half Bath

5 full/ 2 half

Garage

1 Attached

Last Notice of Major Improvements

Value Information

Base Value

Value

Phase-in Assessments

As of

As of

As of

01/01/2023

07/01/2023

07/01/2024

Land:

98,500

192,100

Improvements

531,300

361,500

Total:

629,800

553,600

553,600

Preferential Land:

0

0

Transfer Information

Seller: EUBANKS EUGENE M,JR

Date: 09/23/1998

Price: \$412,500

Type: ARMS LENGTH IMPROVED

Deed1: /13168/ 00476

Deed2:

Seller: HUNGERFORD DAVID S

Date: 06/18/1996

Price: \$399,500

Type: ARMS LENGTH IMPROVED

Deed1: /11648/ 00133

Deed2:

Seller: KEY FEDERAL SAVINGS BANK

Date: 09/25/1992

Price: \$220,000

Type: ARMS LENGTH IMPROVED

Deed1: /09380/ 00068

Deed2:

Exemption Information

Partial Exempt Assessments:

Class

07/01/2023

07/01/2024

County:

000

0.00

State:

000

0.00

Municipal:

000

0.00|0.00

0.00|0.00

Special Tax Recapture: None

Homestead Application Information

Homestead Application Status: No Application

Homeowners' Tax Credit Application Information

Homeowners' Tax Credit Application Status: No Application

Date:

**District: 10      Account Number: 2100005302**

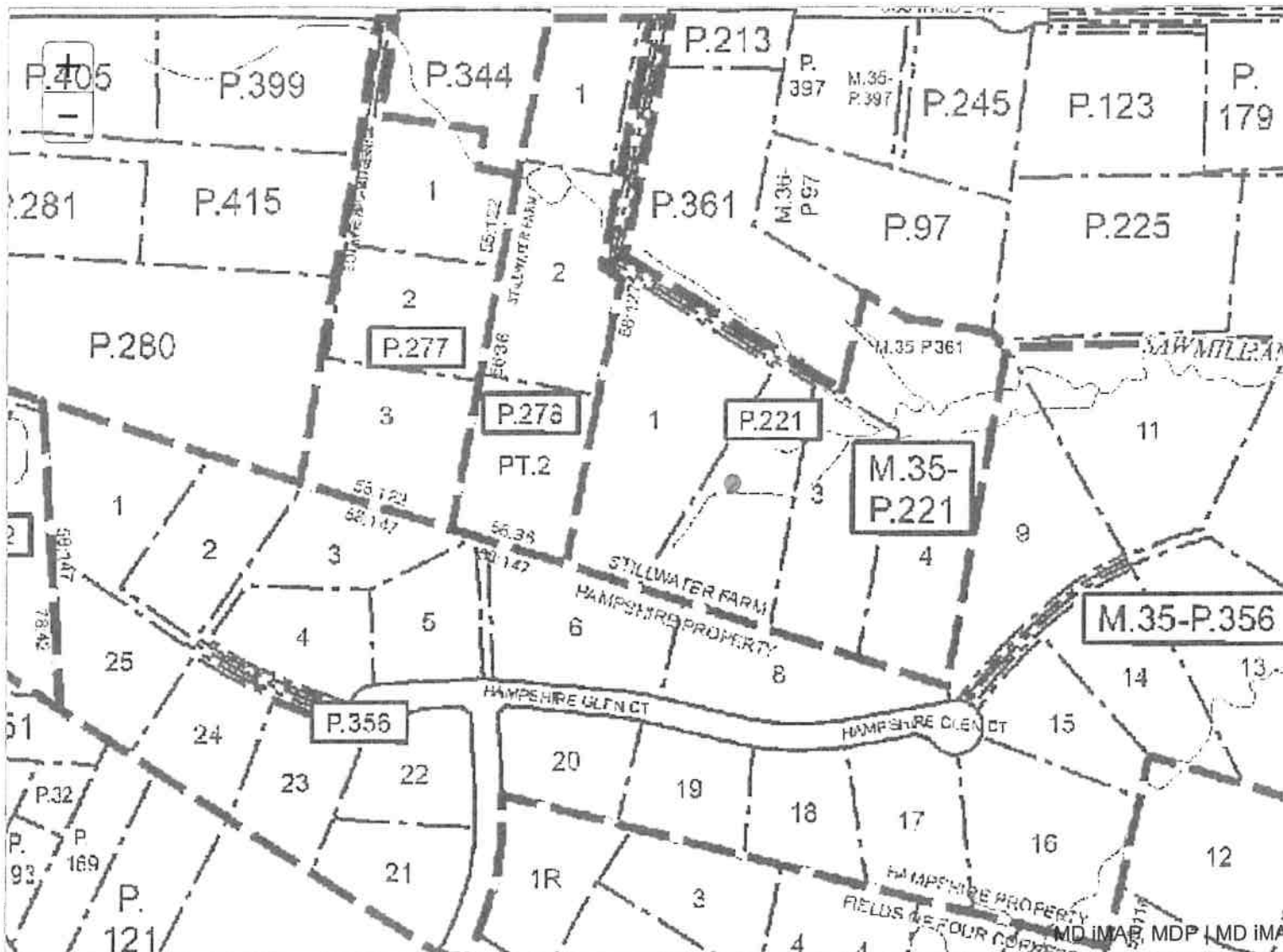

The information shown on this map has been compiled from deed descriptions and plats and is not a property survey. The map should not be used for legal descriptions. Users noting errors are urged to notify the Maryland Department of Planning Mapping, 301 W. Preston Street, Baltimore MD 21201.

If a plat for a property is needed, contact the local Land Records office where the property is located. Plats are also available online through the Maryland State Archives at [www.plats.net](http://www.plats.net) (<http://www.plats.net>).

Property maps provided courtesy of the Maryland Department of Planning.

For more information on electronic mapping applications, visit the Maryland Department of Planning web site at <http://planning.maryland.gov/Pages/OurProducts/OurProducts.aspx> (<http://planning.maryland.gov/Pages/OurProducts/OurProducts.aspx>).

WATER WELL ABANDONMENT-SEALING REPORT FORM

SUBMIT COPIES OF COMPLETED FORM TO:

- \* COUNTY ENVIRONMENTAL AGENCY (contact MDE, WMA if address needed)
- \* WELL OWNER
- \* MDE, WATER MANAGEMENT ADMINISTRATION, WELL PROGRAM

DATE WELL ABANDONED: 4/25/2024 (month/day/year)

\* PERMIT NUMBER OF ABANDONED WELL (if any)

\* PERMIT NUMBER OF REPLACEMENT WELL:

\* PERSON ABANDONING WELL: Steve Venios

WELL DRILLER'S LICENSE NUMBER: JE0087

CIRCLE: MWD / MSD / MGD / JGD

\* OWNER'S NAME: McLewee Edward TJR & Barbara G

SITE LOCATION MAP

\* WELL LOCATION:  
COUNTY: Baltimore  
NEAREST TOWN: Phoenix  
TAX MAP 0025 BLOCK — PARCEL 0356  
SUBDIVISION: 0000  
SECTION: — LOT: 6  
STREET ADDRESS: 3600 Hampshire Glen CT

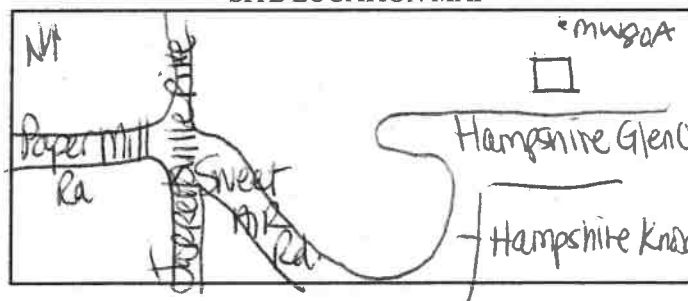

LATITUDE 39.51975

LONGITUDE 76.55500

LOG OF SEALING MATERIAL

MATERIAL	FEET	
	FROM	TO
Cement Bentonite Grout	0	35

VOLUME OF MATERIAL USED

7 ft.<sup>3</sup>

\* TYPE OF WELL BEING ABANDONED:

☒ DRILLED ☐ JETTED  
☒ BORED ☐ HAND DUG  
☐ OTHER (specify)           

\* USE CODE:

☐ DOMESTIC ☐ MUNICIPAL/PUBLIC  
☒ IRRIGATION ☐ INDUSTRIAL  
☒ TEST/OBSERVATION ☐ GEOTHERMAL

\* TYPE OF CASING:

☐ STEEL ☒ PLASTIC  
☐ CONCRETE ☐ OTHER (specify)           

SIZE OF CASING: 6 INCHES IN DIAMETER

DEPTH OF WELL: 35 FEET DEEP

WAS ANY CASING REMOVED? ☒ YES ☐ NO

If yes, length removed, in feet: 2

WAS CASING RIPPED OR PERFORATED? ☐ YES ☒ NO

SIGNATURE-MASTER WELL DRILLER OR SUPERVISING SANITARIAN [Signature] LICENSE# MOD110

CIRCLE ONE MWD / MSD / MGS

DATE 7/12/24

ORIGINAL

Pursuant to § 10-624 of the State Govt. Article of the Maryland Code, personal info requested on this form is used in processing this form pursuant to COMAR 26.04.04. Failure to provide the info may result in this form not being processed. You have the right to inspect, amend, or correct this form. The Maryland Department of the Environment is subject to the Maryland Public Information Act. This form may be made available on the Internet via MDE's website and is subject to inspection or copying, in whole or in part, by the public and other governmental agencies, if not protected by federal or State Law.

WATER WELL ABANDONMENT-SEALING REPORT FORM

SUBMIT COPIES OF COMPLETED FORM TO:

- \* COUNTY ENVIRONMENTAL AGENCY (contact MDE, WMA if address needed)
- \* WELL OWNER
- \* MDE, WATER MANAGEMENT ADMINISTRATION, WELL PROGRAM

DATE WELL ABANDONED: 4/25/2024 (month/day/year)

\* PERMIT NUMBER OF ABANDONED WELL (if any)

BA - 95 - 1218

\* PERMIT NUMBER OF REPLACEMENT WELL:

\* PERSON ABANDONING WELL: Steve Venias

WELL DRILLER'S LICENSE NUMBER: JG0087

\* OWNER'S NAME: McLewee Edward T JR & Barbara G

CIRCLE: MWD / MSD / MGD / JGD

\* WELL LOCATION:

COUNTY: Baltimore

NEAREST TOWN: Phoenix

TAX MAP 0035 BLOCK - PARCEL 0056

SUBDIVISION: 0000

SECTION: - LOT: 6

STREET ADDRESS: 3600 Hampshire Glen Cr

LATITUDE 39.519624

LONGITUDE 76.554973

SITE LOCATION MAP

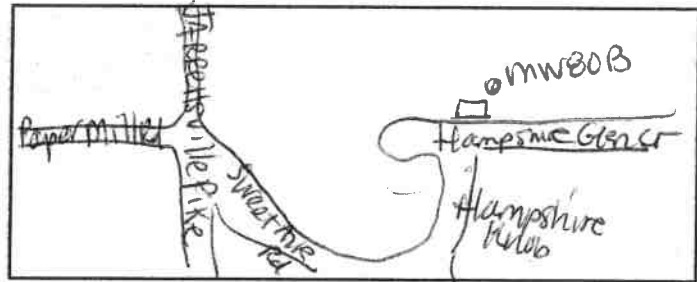

LOG OF SEALING MATERIAL

MATERIAL	FEET	
	FROM	TO
Cement Bentonite Grout	0	48.5
VOLUME OF MATERIAL USED		
9.7 ft.3		

\* TYPE OF WELL BEING ABANDONED:

☒ DRILLED ☐ JETTED  
☒ BORED ☐ HAND DUG  
☐ OTHER (specify) \_\_\_\_\_

\* USE CODE:

☐ DOMESTIC ☐ MUNICIPAL/PUBLIC  
☒ IRRIGATION ☐ INDUSTRIAL  
☒ TEST/OBSERVATION ☐ GEOTHERMAL

\* TYPE OF CASING:

☐ STEEL ☒ PLASTIC  
☐ CONCRETE ☐ OTHER (specify) \_\_\_\_\_

SIZE OF CASING: 6 INCHES IN DIAMETER

DEPTH OF WELL: 48.5 FEET DEEP

WAS ANY CASING REMOVED? ☒ YES ☐ NO

If yes, length removed, in feet: 2

WAS CASING RIPPED OR PERFORATED? ☐ YES ☒ NO

SIGNATURE [Signature] MASTER WELL DRILLER OR SUPERVISING SANITARIAN LICENSE# MD110

Pursuant to § 10-624 of the State Govt. Article of the Maryland Code, personal info requested on this form is used in processing this form pursuant to COMAR 26.04.04. Failure to provide the info may result in this form not being processed. You have the right to inspect, amend, or correct this form. The Maryland Department of the Environment is subject to the Maryland Public Information Act. This form may be made available on the Internet via MDE's website and is subject to inspection or copying, in whole or in part, by the public and other governmental agencies, if not protected by federal or State Law.

MWD / MSD / MGS  
CIRCLE ONE

6/25/24  
DATE

MARYLAND DEPARTMENT OF THE ENVIRONMENT, WATER MANAGEMENT ADMINISTRATION  
1800 Washington Blvd., Baltimore, Maryland 21230 (410) 537-3784

\*\*\*\*\*  
WATER WELL ABANDONMENT-SEALING REPORT FORM  
\*\*\*\*\*

SUBMIT COPIES OF COMPLETED FORM TO:

- \* COUNTY ENVIRONMENTAL AGENCY (contact MDE, WMA if address needed)
- \* WELL OWNER
- \* MDE, WATER MANAGEMENT ADMINISTRATION, WELL PROGRAM

DATE WELL ABANDONED: 4/25/2024 (month/day/year)

\* PERMIT NUMBER OF ABANDONED WELL (if any)

BA - 95 - 1095

\* PERMIT NUMBER OF REPLACEMENT WELL:

\* PERSON ABANDONING WELL: Steve Venios WELL DRILLER'S LICENSE NUMBER: JG0087

\* OWNER'S NAME: McGee Edward T & Barbara G CIRCLE: MWD / MSD / MGD JG00

\* WELL LOCATION:  
COUNTY: Baltimore  
NEAREST TOWN: Phoenix  
TAX MAP: 0035 BLOCK: — PARCEL: 0356  
SUBDIVISION: 000  
SECTION: — LOT: 6  
STREET ADDRESS: 3600 Hampshire Glen Cr

SITE LOCATION MAP



LATITUDE 39.51962

LONGITUDE 76.55465

LOG OF SEALING MATERIAL

MATERIAL	FEET	
	FROM	TO
Cement Bentonite Grout	0	25
VOLUME OF MATERIAL USED		
5 ft.3		

\* TYPE OF WELL BEING ABANDONED:

☒ DRILLED ☐ JETTED  
☒ BORED ☐ HAND DUG  
☐ OTHER (specify) \_\_\_\_\_

\* USE CODE:

☐ DOMESTIC ☐ MUNICIPAL/PUBLIC  
☒ IRRIGATION ☐ INDUSTRIAL  
☒ TEST/OBSERVATION ☐ GEOTHERMAL

\* TYPE OF CASING:

☐ STEEL ☒ PLASTIC  
☐ CONCRETE ☐ OTHER (specify) \_\_\_\_\_

SIZE OF CASING: 6 INCHES IN DIAMETER

DEPTH OF WELL: 25 FEET DEEP

WAS ANY CASING REMOVED? ☒ YES ☐ NO

If yes, length removed, in feet: 2

WAS CASING RIPPED OR PERFORATED? ☐ YES ☒ NO

SIGNATURE-MASTER WELL DRILLER OR SUPERVISING SANITARIAN LICENSE# MDA10

Pursuant to § 10-624 of the State Govt. Article of the Maryland Code, personal info requested on this form is used in processing this form pursuant to COMAR 26.04.04. Failure to provide the info may result in this form not being processed. You have the right to inspect, amend, or correct this form. The Maryland Department of the Environment is subject to the Maryland Public Information Act. This form may be made available on the Internet via MDE's website and is subject to inspection or copying, in whole or in part, by the public and other governmental agencies, if not protected by federal or State Law.

CIRCLE ONE MWD / MSD / MGS

4/25/24 DATE

ORIGINAL

Real Property Data Search ( )  
Search Result for BALTIMORE COUNTY

View Map

Special Tax Recapture: None

View GroundRent Redemption

Account Identifier: District - 10 Account Number - 2100006237

View GroundRent Registration

Owner Information

Owner Name:

MCLEWEE EDWARD T JR  
MCLEWEE BARBARA G

Use:

RESIDENTIAL  
YES

Mailing Address:

3600 HAMPSHIRE GLEN CT  
PHOENIX MD 21131

Principal Residence:

/08812/ 00482

Deed Reference:

/08812/ 00482

Location & Structure Information

Premises Address:

3600 HAMPSHIRE GLEN CT  
PHOENIX 21131

Legal Description:

1.602 AC  
HAMPSHIRE

Map: Grid: Parcel: Neighborhood: Subdivision: Section: Block: Lot: Assessment Year: Plat No:

0035 0024 0356 10020022.04 0000 6 2023 Plat Ref: 0058/ 0147

Town: None

Primary Structure Built

Above Grade Living Area

Finished Basement Area

Property Land Area

County Use

1991

2,524 SF

1.6000 AC

04

Stories

Basement

Type

Exterior

Quality

Full/Half Bath

Garage

Last Notice of Major Improvements

2

YES

STANDARD UNIT

SIDING/

5

2 full/ 1 half

1 Attached

Value Information

Base Value

Value

Phase-in Assessments

As of

As of

As of

01/01/2023

07/01/2023

07/01/2024

Land:

171,700

259,700

Improvements

299,700

322,800

Total:

471,400

582,500

508,433

545,467

Preferential Land:

0

0

Transfer Information

Seller: M H INVESTMENTS INC

Date: 06/07/1991

Price: \$76,000

Type: ARMS LENGTH IMPROVED

Deed1: /08812/ 00482

Deed2:

Seller:

Date:

Price:

Type:

Deed1:

Deed2:

Seller:

Date:

Price:

Type:

Deed1:

Deed2:

Exemption Information

Partial Exempt Assessments:

Class

07/01/2023

07/01/2024

County:

000

0.00

State:

000

0.00

Municipal:

000

0.00|0.00

0.00|0.00

Special Tax Recapture: None

Homestead Application Information

Homestead Application Status: Approved 05/15/2008

Homeowners' Tax Credit Application Information

Homeowners' Tax Credit Application Status: No Application

Date:

**District: 10      Account Number: 2100006237**



The information shown on this map has been compiled from deed descriptions and plats and is not a property survey. The map should not be used for legal descriptions. Users noting errors are urged to notify the Maryland Department of Planning Mapping, 301 W. Preston Street, Baltimore MD 21201.

If a plat for a property is needed, contact the local Land Records office where the property is located. Plats are also available online through the Maryland State Archives at [www.plats.net](http://www.plats.net) (<http://www.plats.net>).

Property maps provided courtesy of the Maryland Department of Planning.

For more information on electronic mapping applications, visit the Maryland Department of Planning web site at <http://planning.maryland.gov/Pages/OurProducts/OurProducts.aspx> (<http://planning.maryland.gov/Pages/OurProducts/OurProducts.aspx>).

\*\*\*\*\*  
WATER WELL ABANDONMENT-SEALING REPORT FORM  
\*\*\*\*\*

SUBMIT COPIES OF COMPLETED FORM TO:

- \* COUNTY ENVIRONMENTAL AGENCY (contact MDE, WMA if address needed)
- \* WELL OWNER
- \* MDE, WATER MANAGEMENT ADMINISTRATION, WELL PROGRAM

DATE WELL ABANDONED: 4/23/2024 (month/day/year)

\* PERMIT NUMBER OF ABANDONED WELL (if any)

BA - 95 - 1097

\* PERMIT NUMBER OF REPLACEMENT WELL:

\* PERSON ABANDONING WELL: Steve Venios WELL DRILLER'S LICENSE NUMBER: JGD087

\* OWNER'S NAME: Libertini Robert Isaac & Suzanne Frederick CIRCLE: MWD / MSD / MGD / JGD

\* WELL LOCATION:

COUNTY: Baltimore

NEAREST TOWN: Phoenix

TAX MAP 0035 BLOCK - PARCEL 0356

SUBDIVISION: 0000

SECTION: - LOT: 5

STREET ADDRESS: 3508 Hampshire Ct

LATITUDE 39.51914

LONGITUDE 76.55553

SITE LOCATION MAP

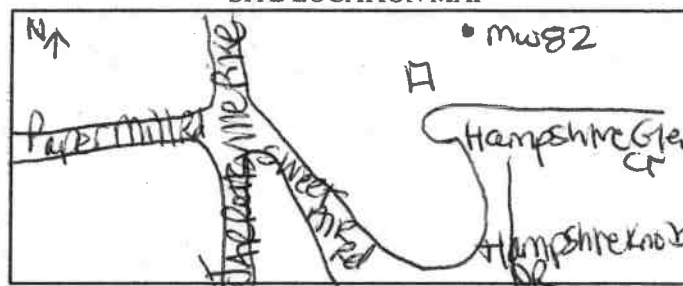

LOG OF SEALING MATERIAL

MATERIAL	FEET	
	FROM	TO
Cement Bentonite Grout	0	25
VOLUME OF MATERIAL USED		
5 ft.3		

\* TYPE OF WELL BEING ABANDONED:

☐ DRILLED ☐ JETTED  
☒ BORED ☐ HAND DUG  
☐ OTHER (specify) \_\_\_\_\_

\* USE CODE:

☐ DOMESTIC ☐ MUNICIPAL/PUBLIC  
☒ IRRIGATION ☐ INDUSTRIAL  
☒ TEST/OBSERVATION ☐ GEOTHERMAL

\* TYPE OF CASING:

☐ STEEL ☒ PLASTIC  
☐ CONCRETE ☐ OTHER (specify) \_\_\_\_\_

SIZE OF CASING: 6 INCHES IN DIAMETER

DEPTH OF WELL: 25 FEET DEEP

WAS ANY CASING REMOVED? ☒ YES ☐ NO

If yes, length removed, in feet: 2

WAS CASING RIPPED OR PERFORATED? ☐ YES ☒ NO

SIGNATURE-MASTER WELL DRILLER OR SUPERVISING SANITARIAN [Signature] LICENSE# MG0110

CIRCLE ONE MWD / MSD / MGS

DATE 6/25/24

ORIGINAL

Pursuant to § 10-624 of the State Govt. Article of the Maryland Code, personal info requested on this form is used in processing this form pursuant to COMAR 26.04.04. Failure to provide the info may result in this form not being processed. You have the right to inspect, amend, or correct this form. The Maryland Department of the Environment is subject to the Maryland Public Information Act. This form may be made available on the Internet via MDE's website and is subject to inspection or copying, in whole or in part, by the public and other governmental agencies, if not protected by federal or State Law.



MARYLAND DEPARTMENT OF THE ENVIRONMENT, WATER MANAGEMENT ADMINISTRATION  
1800 Washington Blvd., Baltimore, Maryland 21230 (410) 537-3784

\*\*\*\*\*  
WATER WELL ABANDONMENT-SEALING REPORT FORM  
\*\*\*\*\*

SUBMIT COPIES OF COMPLETED FORM TO:

- \* COUNTY ENVIRONMENTAL AGENCY (contact MDE, WMA if address needed)
- \* WELL OWNER
- \* MDE, WATER MANAGEMENT ADMINISTRATION, WELL PROGRAM

DATE WELL ABANDONED: 4/23/2024 (month/day/year)

\* PERMIT NUMBER OF ABANDONED WELL (if any)

BA - 95 - 1193

\* PERMIT NUMBER OF REPLACEMENT WELL:

\* PERSON ABANDONING WELL: Steve Venias

WELL DRILLER'S LICENSE NUMBER: JB0087

\* OWNER'S NAME: Libertini Robert Isaac & Suzanne Frederic

CIRCLE: MWD / MSD / MGD JB0

\* WELL LOCATION:

SITE LOCATION MAP

COUNTY: Baltimore  
NEAREST TOWN: Phoenix  
TAX MAP 0035 BLOCK - PARCEL 0356  
SUBDIVISION: 0000  
SECTION: - LOT: 5  
STREET ADDRESS: 3508 Hampshire Glen Ct

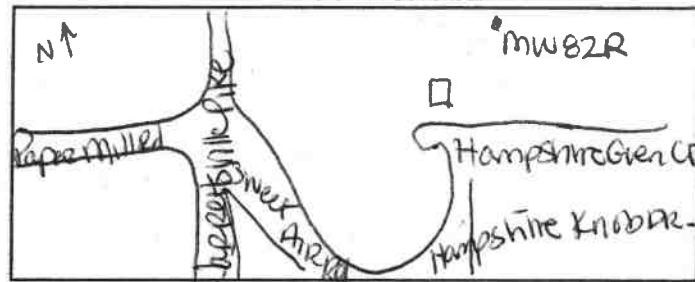

LATITUDE 39.51911

LONGITUDE 76.55562

LOG OF SEALING MATERIAL

MATERIAL	FEET	
	FROM	TO
Cement Bentonite Grout	0	46
VOLUME OF MATERIAL USED		
9.2 ft.3		

\* TYPE OF WELL BEING ABANDONED:

☐ DRILLED ☐ JETTED  
☒ BORED ☐ HAND DUG  
☐ OTHER (specify) \_\_\_\_\_

\* USE CODE:

☐ DOMESTIC ☐ MUNICIPAL/PUBLIC  
☐ IRRIGATION ☐ INDUSTRIAL  
☒ TEST/OBSERVATION ☐ GEOTHERMAL

\* TYPE OF CASING:

☐ STEEL ☒ PLASTIC  
☐ CONCRETE ☐ OTHER (specify) \_\_\_\_\_

SIZE OF CASING: 6 INCHES IN DIAMETER

DEPTH OF WELL: 46 FEET DEEP

WAS ANY CASING REMOVED? ☒ YES ☒ NO

If yes, length removed, in feet: 2

WAS CASING RIPPED OR PERFORATED? ☐ YES ☒ NO

SIGNATURE-MASTER WELL DRILLER OR SUPERVISING SANITARIAN Med110 LICENSE#

MWD / MSD / MGS

CIRCLE ONE

DATE 6/25/24

ORIGINAL

Pursuant to § 10-624 of the State Govt. Article of the Maryland Code, personal info requested on this form is used in processing this form pursuant to COMAR 26.04.04. Failure to provide the info may result in this form not being processed. You have the right to inspect, amend, or correct this form. The Maryland Department of the Environment is subject to the Maryland Public Information Act. This form may be made available on the Internet via MDE's website and is subject to inspection or copying, in whole or in part, by the public and other governmental agencies, if not protected by federal or State Law.

\*\*\*\*\*  
WATER WELL ABANDONMENT-SEALING REPORT FORM  
\*\*\*\*\*

SUBMIT COPIES OF COMPLETED FORM TO:

- \* COUNTY ENVIRONMENTAL AGENCY (contact MDE, WMA if address needed)
- \* WELL OWNER
- \* MDE, WATER MANAGEMENT ADMINISTRATION, WELL PROGRAM

DATE WELL ABANDONED: 4/23/2024 (month/day/year)

\* PERMIT NUMBER OF ABANDONED WELL (if any)

BA - 95 - 1098

\* PERMIT NUMBER OF REPLACEMENT WELL:

\* PERSON ABANDONING WELL: Steve Venios WELL DRILLER'S LICENSE NUMBER: JG0087

\* OWNER'S NAME: Libertini Robert Isaac & Suzanne Frederick CIRCLE: MWD / MSD / MGD (MGD)

\* WELL LOCATION:  
COUNTY: Baltimore  
NEAREST TOWN: Phoenix  
TAX MAP 0035 BLOCK - PARCEL 0356  
SUBDIVISION: 0000  
SECTION: - LOT: 5  
STREET ADDRESS: 3508 Hampshire Glen Ct

SITE LOCATION MAP

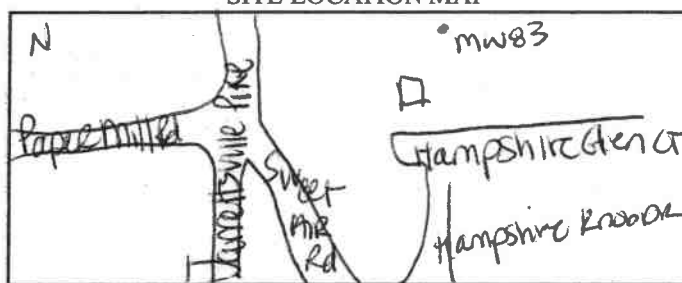

LATITUDE 39.51943

LONGITUDE 76.55550

LOG OF SEALING MATERIAL

MATERIAL	FEET	
	FROM	TO
Cement Bentonite Grout	0	25
VOLUME OF MATERIAL USED		
5 ft.3		

\* TYPE OF WELL BEING ABANDONED:

☐ DRILLED ☐ JETTED  
☒ BORED ☐ HAND DUG  
☐ OTHER (specify) \_\_\_\_\_

\* USE CODE:

☐ DOMESTIC ☐ MUNICIPAL/PUBLIC  
☒ IRRIGATION ☐ INDUSTRIAL  
☐ TEST/OBSERVATION ☐ GEOTHERMAL

\* TYPE OF CASING:

☐ STEEL ☒ PLASTIC  
☐ CONCRETE ☐ OTHER (specify) \_\_\_\_\_

SIZE OF CASING: 6 INCHES IN DIAMETER

DEPTH OF WELL: 25 FEET DEEP

WAS ANY CASING REMOVED? ☒ YES ☐ NO

If yes, length removed, in feet: 2

WAS CASING RIPPED OR PERFORATED? ☐ YES ☒ NO

SIGNATURE-MASTER WELL DRILLER OR SUPERVISING SANITARIAN J.R. LICENSE# MGD110

CIRCLE ONE MWD / MSD / MGS

CIRCLE ONE

DATE 6/25/24

ORIGINAL

Pursuant to § 10-624 of the State Govt. Article of the Maryland Code, personal info requested on this form is used in processing this form pursuant to COMAR 26.04.04. Failure to provide the info may result in this form not being processed. You have the right to inspect, amend, or correct this form. The Maryland Department of the Environment is subject to the Maryland Public Information Act. This form may be made available on the Internet via MDE's website and is subject to inspection or copying, in whole or in part, by the public and other governmental agencies, if not protected by federal or State Law.

\*\*\*\*\*  
WATER WELL ABANDONMENT-SEALING REPORT FORM  
\*\*\*\*\*

SUBMIT COPIES OF COMPLETED FORM TO:

- \* COUNTY ENVIRONMENTAL AGENCY (contact MDE, WMA if address needed)
- \* WELL OWNER
- \* MDE, WATER MANAGEMENT ADMINISTRATION, WELL PROGRAM

DATE WELL ABANDONED: 4/23/2024 (month/day/year)

\* PERMIT NUMBER OF ABANDONED WELL (if any)

BA - 95 - 1192

\* PERMIT NUMBER OF REPLACEMENT WELL:

\* PERSON ABANDONING WELL: Steve Venios WELL DRILLER'S LICENSE NUMBER: JG0087

\* OWNER'S NAME: Libertini Robert Isaac & Suzanne Frederick CIRCLE: MWD / MSD / MGD / JGD

\* WELL LOCATION:  
COUNTY: Baltimore  
NEAREST TOWN: Phoenix  
TAX MAP 035 BLOCK - PARCEL 6350  
SUBDIVISION: 0000  
SECTION: - LOT: 5  
STREET ADDRESS: 3508 Hampshire Glen Ct.

SITE LOCATION MAP

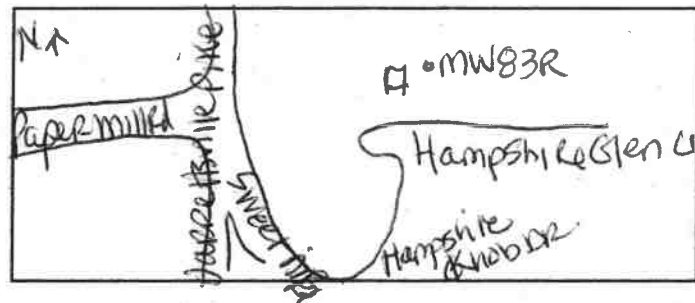

LOG OF SEALING MATERIAL

MATERIAL	FEET	
	FROM	TO
Cement Bentonite Grout	0	50
VOLUME OF MATERIAL USED		
10 ft. 3		

\* TYPE OF WELL BEING ABANDONED:

☒ DRILLED ☐ JETTED  
☒ BORED ☐ HAND DUG  
☐ OTHER (specify) \_\_\_\_\_

\* USE CODE:

☐ DOMESTIC ☐ MUNICIPAL/PUBLIC  
☐ IRRIGATION ☐ INDUSTRIAL  
☒ TEST/OBSERVATION ☐ GEOTHERMAL

\* TYPE OF CASING:

☐ STEEL ☒ PLASTIC  
☐ CONCRETE ☐ OTHER (specify) \_\_\_\_\_

SIZE OF CASING: 6 INCHES IN DIAMETER

DEPTH OF WELL: 50 FEET DEEP

WAS ANY CASING REMOVED? ☒ YES ☐ NO

If yes, length removed, in feet: 2

WAS CASING RIPPED OR PERFORATED? ☒ YES ☐ NO

SIGNATURE-MASTER WELL DRILLER OR SUPERVISING SANITARIAN [Signature] LICENSE# M60110

CIRCLE ONE MWD / MSD / MGS

DATE 6/25/24

ORIGINAL

Pursuant to § 10-624 of the State Govt. Article of the Maryland Code, personal info requested on this form is used in processing this form pursuant to COMAR 26.04.04. Failure to provide the info may result in this form not being processed. You have the right to inspect, amend, or correct this form. The Maryland Department of the Environment is subject to the Maryland Public Information Act. This form may be made available on the Internet via MDE's website and is subject to inspection or copying, in whole or in part, by the public and other governmental agencies, if not protected by federal or State Law.

\*\*\*\*\*  
WATER WELL ABANDONMENT-SEALING REPORT FORM  
\*\*\*\*\*

SUBMIT COPIES OF COMPLETED FORM TO:

- \* COUNTY ENVIRONMENTAL AGENCY (contact MDE, WMA if address needed)
- \* WELL OWNER
- \* MDE, WATER MANAGEMENT ADMINISTRATION, WELL PROGRAM

DATE WELL ABANDONED: 4/23/2024 (month/day/year)

\* PERMIT NUMBER OF ABANDONED WELL (if any)

BA -95 -1177

\* PERMIT NUMBER OF REPLACEMENT WELL:

\* PERSON ABANDONING WELL: Steve Venios WELL DRILLER'S LICENSE NUMBER: JG0087

CIRCLE: MWD / MSD / MGD / JGO

\* OWNER'S NAME: Hbertini Robert Isaac & Suzanne Frederick

\* WELL LOCATION:

COUNTY: Baltimore

NEAREST TOWN: Phoenix

TAX MAP 0035 BLOCK - PARCEL 0356

SUBDIVISION: 0000

SECTION: - LOT: 5

STREET ADDRESS: 3508 Hampshire Glen Ct

LATITUDE 39.51946

LONGITUDE 76.55604

SITE LOCATION MAP

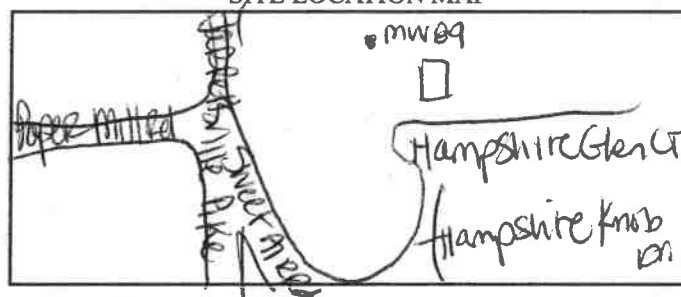

LOG OF SEALING MATERIAL

MATERIAL	FEET	
	FROM	TO
Cement Bentonite Grout	0	40
VOLUME OF MATERIAL USED		
4 ft. <sup>3</sup>		

\* TYPE OF WELL BEING ABANDONED:

☐ DRILLED ☐ JETTED  
☒ BORED ☐ HAND DUG  
☐ OTHER (specify) \_\_\_\_\_

\* USE CODE:

☐ DOMESTIC ☐ MUNICIPAL/PUBLIC  
☐ IRRIGATION ☐ INDUSTRIAL  
☒ TEST/OBSERVATION ☐ GEOTHERMAL

\* TYPE OF CASING:

☐ STEEL ☒ PLASTIC  
☐ CONCRETE ☐ OTHER (specify) \_\_\_\_\_

SIZE OF CASING: 4 INCHES IN DIAMETER

DEPTH OF WELL: 40 FEET DEEP

WAS ANY CASING REMOVED? ☒ YES ☐ NO

If yes, length removed, in feet: 2

WAS CASING RIPPED OR PERFORATED? ☐ YES ☒ NO

SIGNATURE-MASTER WELL DRILLER OR SUPERVISING SANITARIAN Q. R. H. LICENSE# M00110

ORIGINAL

Pursuant to § 10-624 of the State Govt. Article of the Maryland Code, personal info requested on this form is used in processing this form pursuant to COMAR 26.04.04. Failure to provide the info may result in this form not being processed. You have the right to inspect, amend, or correct this form. The Maryland Department of the Environment is subject to the Maryland Public Information Act. This form may be made available on the Internet via MDE's website and is subject to inspection or copying, in whole or in part, by the public and other governmental agencies, if not protected by federal or State Law.

CIRCLE ONE MWD / MSD / MGS 6/25/24 DATE

MARYLAND DEPARTMENT OF THE ENVIRONMENT, WATER MANAGEMENT ADMINISTRATION  
1800 Washington Blvd., Baltimore, Maryland 21230 (410) 537-3784

\*\*\*\*\*  
WATER WELL ABANDONMENT-SEALING REPORT FORM  
\*\*\*\*\*

SUBMIT COPIES OF COMPLETED FORM TO:

- \* COUNTY ENVIRONMENTAL AGENCY (contact MDE, WMA if address needed)
- \* WELL OWNER
- \* MDE, WATER MANAGEMENT ADMINISTRATION, WELL PROGRAM

DATE WELL ABANDONED: 4/23/2024 (month/day/year)

\* PERMIT NUMBER OF ABANDONED WELL (if any)

BA - 95 - 1144

\* PERMIT NUMBER OF REPLACEMENT WELL:

\* PERSON ABANDONING WELL: Steve Venias

WELL DRILLER'S LICENSE NUMBER: JE0087

\* OWNER'S NAME: Exxon Mobil Corporation

CIRCLE: MWD / MSD / MGD JE0

\* WELL LOCATION:

COUNTY: Baltimore

NEAREST TOWN: Phoenix

TAX MAP 0035 BLOCK --- PARCEL 0356

SUBDIVISION: 6000

SECTION: --- LOT: 25

STREET ADDRESS: 3501 Hampshire Glen CT

LATITUDE 39.519147

LONGITUDE 76.557698

SITE LOCATION MAP

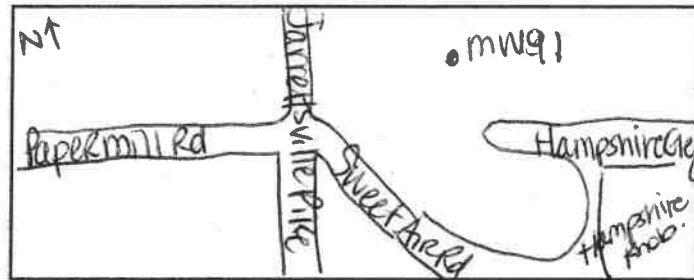

LOG OF SEALING MATERIAL

MATERIAL	FEET	
	FROM	TO
Cement Bentonite Grout	0	75
VOLUME OF MATERIAL USED		
15 ft. <sup>3</sup>		

\* TYPE OF WELL BEING ABANDONED:

☒ DRILLED ☐ JETTED  
☐ BORED ☐ HAND DUG  
☐ OTHER (specify) \_\_\_\_\_

\* USE CODE:

☐ DOMESTIC ☐ MUNICIPAL/PUBLIC  
☒ IRRIGATION ☐ INDUSTRIAL  
☒ TEST/OBSERVATION ☐ GEOTHERMAL

\* TYPE OF CASING:

☐ STEEL ☒ PLASTIC  
☐ CONCRETE ☐ OTHER (specify) \_\_\_\_\_

SIZE OF CASING: 6 INCHES IN DIAMETER

DEPTH OF WELL: 75 FEET DEEP

WAS ANY CASING REMOVED? ☒ YES ☐ NO

If yes, length removed, in feet: 2

WAS CASING RIPPED OR PERFORATED? ☐ YES ☒ NO

SIGNATURE-MASTER WELL DRILLER OR SUPERVISING SANITARIAN MD110 LICENSE#

MWD / MSD / MGS  
CIRCLE ONE

7/11/24  
DATE

ORIGINAL

Pursuant to § 10-624 of the State Govt. Article of the Maryland Code, personal info requested on this form is used in processing this form pursuant to COMAR 26.04.04. Failure to provide the info may result in this form not being processed. You have the right to inspect, amend, or correct this form. The Maryland Department of the Environment is subject to the Maryland Public Information Act. This form may be made available on the Internet via MDE's website and is subject to inspection or copying, in whole or in part, by the public and other governmental agencies, if not protected by federal or State Law.

WATER WELL ABANDONMENT-SEALING REPORT FORM

SUBMIT COPIES OF COMPLETED FORM TO:

- \* COUNTY ENVIRONMENTAL AGENCY (contact MDE, WMA if address needed)
- \* WELL OWNER
- \* MDE, WATER MANAGEMENT ADMINISTRATION, WELL PROGRAM

DATE WELL ABANDONED: 4/29/2024 (month/day/year)

\* PERMIT NUMBER OF ABANDONED WELL (if any)

\* PERMIT NUMBER OF REPLACEMENT WELL:

\* PERSON ABANDONING WELL: Steve Veritas

WELL DRILLER'S LICENSE NUMBER: J60087

\* OWNER'S NAME: Exxon Mobile Corp

CIRCLE: MWD / MSD / MGD

\* WELL LOCATION:

SITE LOCATION MAP

COUNTY: Baltimore  
NEAREST TOWN: Phoenix  
TAX MAP: 35 BLOCK - PARCEL 6356  
SUBDIVISION: 0000  
SECTION: 1 LOT: 25  
STREET ADDRESS: 3501 Hampshire Glen Ct.

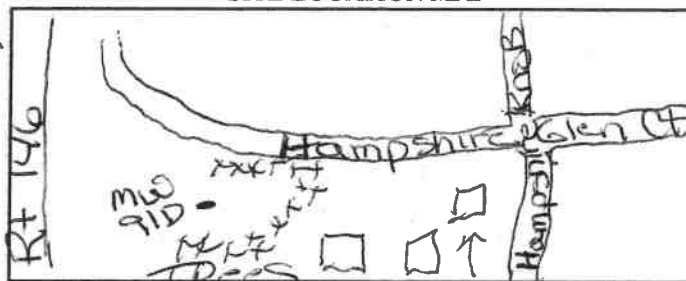

LATITUDE 39.51916

LONGITUDE 76.55773

LOG OF SEALING MATERIAL

\* TYPE OF WELL BEING ABANDONED:

☐ DRILLED ☐ JETTED  
☒ BORED ☐ HAND DUG  
☐ OTHER (specify) \_\_\_\_\_

\* USE CODE:

☐ DOMESTIC ☐ MUNICIPAL/PUBLIC  
☐ IRRIGATION ☐ INDUSTRIAL  
☒ TEST/OBSERVATION ☐ GEOTHERMAL

\* TYPE OF CASING:

☒ STEEL ☐ PLASTIC  
☐ CONCRETE ☐ OTHER (specify) \_\_\_\_\_

MATERIAL	FEET	
	FROM	TO
Cement Bentonite Grout	0	420
VOLUME OF MATERIAL USED		
84 ft. <sup>3</sup>		

SIZE OF CASING: 6 INCHES IN DIAMETER

DEPTH OF WELL: 420 FEET DEEP

WAS ANY CASING REMOVED? ☒ YES ☐ NO

If yes, length removed, in feet: 2

WAS CASING RIPPED OR PERFORATED? ☐ YES ☒ NO

SIGNATURE-MASTER WELL DRILLER OR SUPERVISING SANITARIAN [Signature] LICENSE# M60110

CIRCLE ONE MWD MSD / MGS

DATE 7/11/2024

ORIGINAL

Pursuant to § 10-624 of the State Govt. Article of the Maryland Code, personal info requested on this form is used in processing this form pursuant to COMAR 26.04.04. Failure to provide the info may result in this form not being processed. You have the right to inspect, amend, or correct this form. The Maryland Department of the Environment is subject to the Maryland Public Information Act. This form may be made available on the Internet via MDE's website and is subject to inspection or copying, in whole or in part, by the public and other governmental agencies, if not protected by federal or State Law.

MW91  
MW91D  
MW 107

Real Property Data Search ()  
Search Result for BALTIMORE COUNTY

[View Map](#)

[View GroundRent Redemption](#)

[View GroundRent Registration](#)

Special Tax Recapture: None

Account Identifier:

District - 10 Account Number - 2100006254

**Owner Information**

Owner Name:

EXXON MOBIL CORPORATION

Use:

RESIDENTIAL

Principal Residence:

NO

Mailing Address:

PROPERTY TAX DIVISION  
PO BOX 64106  
SPRING GAP TX 77387-4106

Deed Reference:

/28889/ 00166

**Location & Structure Information**

Premises Address:

3501 HAMPSHIRE GLEN CT  
PHOENIX 21131-

Legal Description:

1.318 AC

HAMPSHIRE

Map: Grid: Parcel: Neighborhood:

0035 0024 0356 10020022.04

Subdivision:

0000

Section:

Block:

Lot:

25

Assessment Year:

2023

Plat No:

Plat Ref: 0058/ 0147

Town: None

Primary Structure Built

Above Grade Living Area

Finished Basement Area

Property Land Area

1.3100 AC

County Use

04

Stories

Basement

Type

Exterior

Quality

Full/Half Bath

Garage

Last Notice of Major Improvements

/

**Value Information**

Base Value

Value

Phase-In Assessments

As of  
01/01/2023

As of  
07/01/2023

As of  
07/01/2024

Land:

157,000

242,500

Improvements

0

0

Total:

157,000

242,500

185,500

214,000

Preferential Land:

0

0

**Transfer Information**

Seller: KOUKIDES HARRY C

Type: ARMS LENGTH VACANT

Date: 11/19/2009

Deed1: /28889/ 00166

Price: \$387,500

Deed2:

Seller: HAMPSHIRE BROOKS LTD PARTNERSHIP

Type: ARMS LENGTH IMPROVED

Date: 11/07/1988

Deed1: /08019/ 00443

Price: \$66,000

Deed2:

Seller:

Date:

Price:

Type:

Deed1:

Deed2:

**Exemption Information**

Partial Exempt Assessments:

Class

07/01/2023

07/01/2024

County:

000

0.00

State:

000

0.00

Municipal:

000

0.00|0.00

0.00|0.00

Special Tax Recapture: None

**Homestead Application Information**

Homestead Application Status: No Application

**Homeowners' Tax Credit Application Information**

Homeowners' Tax Credit Application Status: No Application

Date:

**District: 10      Account Number: 2100006254**

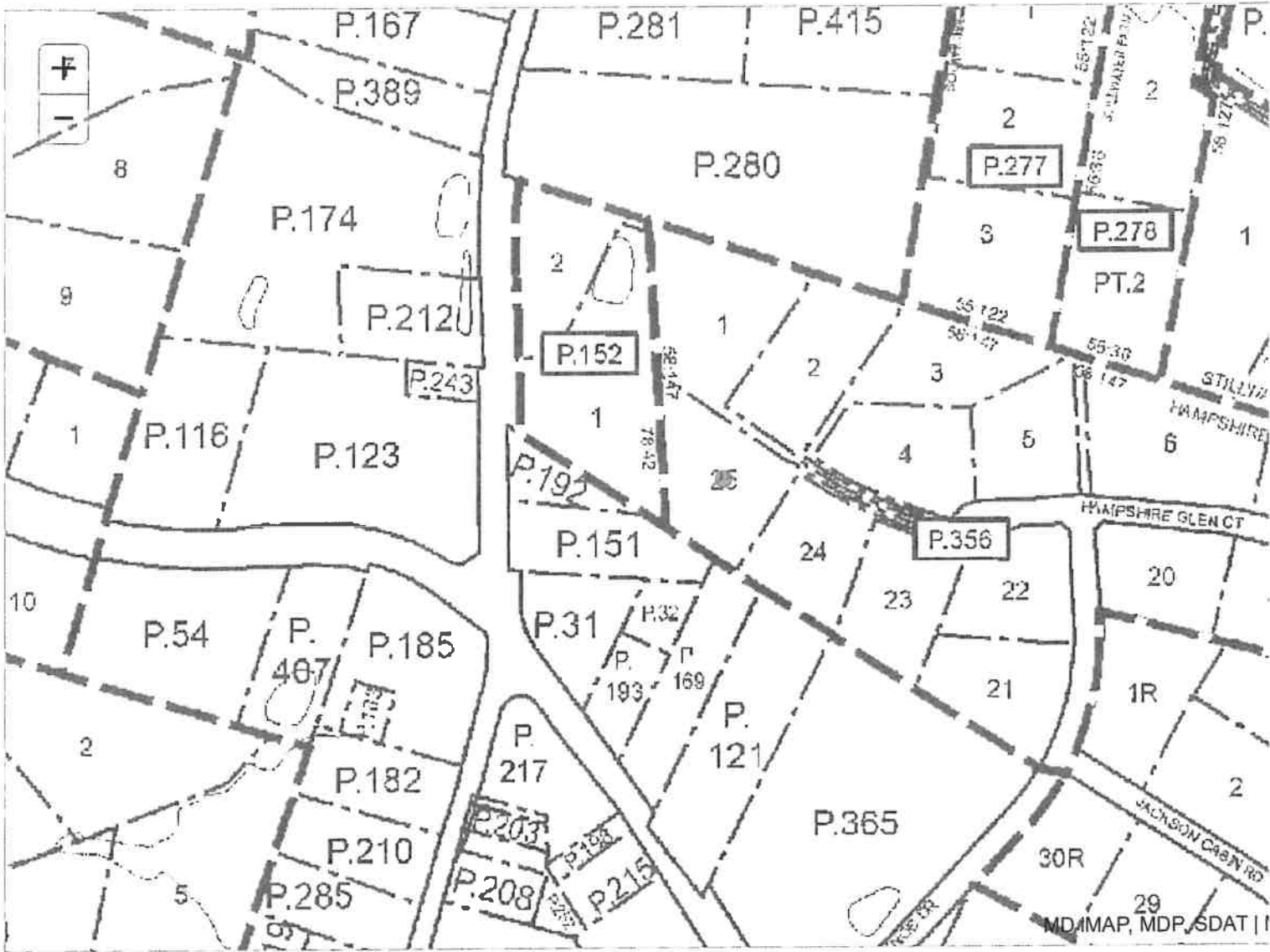

The information shown on this map has been compiled from deed descriptions and plats and is not a property survey. The map should not be used for legal descriptions. Users noting errors are urged to notify the Maryland Department of Planning Mapping, 301 W. Preston Street, Baltimore MD 21201.

If a plat for a property is needed, contact the local Land Records office where the property is located. Plats are also available online through the Maryland State Archives at [www.plats.net](http://www.plats.net) (<http://www.plats.net>).

Property maps provided courtesy of the Maryland Department of Planning.

For more information on electronic mapping applications, visit the Maryland Department of Planning web site at <http://planning.maryland.gov/Pages/OurProducts/OurProducts.aspx> (<http://planning.maryland.gov/Pages/OurProducts/OurProducts.aspx>).



MARYLAND DEPARTMENT OF THE ENVIRONMENT, WATER MANAGEMENT ADMINISTRATION  
1800 Washington Blvd., Baltimore, Maryland 21230 (410) 537-3784

\*\*\*\*\*  
WATER WELL ABANDONMENT-SEALING REPORT FORM  
\*\*\*\*\*

SUBMIT COPIES OF COMPLETED FORM TO:

- \* COUNTY ENVIRONMENTAL AGENCY (contact MDE, WMA if address needed)
- \* WELL OWNER
- \* MDE, WATER MANAGEMENT ADMINISTRATION, WELL PROGRAM

DATE WELL ABANDONED: 4/19/2024 (month/day/year)

MW92A

\* PERMIT NUMBER OF ABANDONED WELL (if any)

BA — 95 — 2061

\* PERMIT NUMBER OF REPLACEMENT WELL:

\* PERSON ABANDONING WELL: Steve Venios

WELL DRILLER'S LICENSE NUMBER: JG D087

CIRCLE: MWD / MSD / MGD / JGD

\* OWNER'S NAME: ON ROAD

SITE LOCATION MAP

\* WELL LOCATION:  
COUNTY: Baltimore  
NEAREST TOWN: Phoenix  
TAX MAP 0635 BLOCK PARCEL 0356  
SUBDIVISION: \_\_\_\_\_  
SECTION: \_\_\_\_\_ LOT: \_\_\_\_\_  
STREET ADDRESS: Hampshire Glen CT

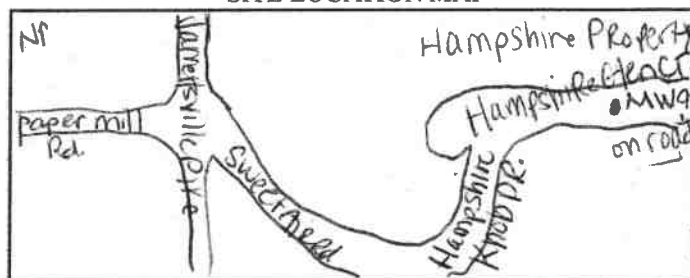

LATITUDE 39.518900

LONGITUDE 76.552528

LOG OF SEALING MATERIAL

MATERIAL	FEET	
	FROM	TO
Cement bentonite Grout	0	40
VOLUME OF MATERIAL USED		
4 ft. <sup>3</sup>		

\* TYPE OF WELL BEING ABANDONED:

\_\_\_\_ DRILLED \_\_\_\_\_ JETTED  
☒ BORED \_\_\_\_\_ HAND DUG  
\_\_\_\_ OTHER (specify) \_\_\_\_\_

\* USE CODE:

\_\_\_\_ DOMESTIC \_\_\_\_\_ MUNICIPAL/PUBLIC  
\_\_\_\_ IRRIGATION \_\_\_\_\_ INDUSTRIAL  
☒ TEST/OBSERVATION \_\_\_\_\_ GEOTHERMAL

\* TYPE OF CASING:

\_\_\_\_ STEEL \_\_\_\_\_ PLASTIC  
\_\_\_\_ CONCRETE \_\_\_\_\_ OTHER (specify) \_\_\_\_\_

SIZE OF CASING: 4 INCHES IN DIAMETER

DEPTH OF WELL: 40 FEET DEEP

WAS ANY CASING REMOVED? ☒ YES \_\_\_\_\_ NO

If yes, length removed, in feet: 2

WAS CASING RIPPED OR PERFORATED? \_\_\_\_\_ YES ☒ NO

SIGNATURE MASTER WELL DRILLER OR SUPERVISING SANITARIAN LICENSE#

MWD 110

CIRCLE ONE

7/12/24

DATE

ORIGINAL

Pursuant to § 10-624 of the State Govt. Article of the Maryland Code, personal info requested on this form is used in processing this form pursuant to COMAR 26.04.04. Failure to provide the info may result in this form not being processed. You have the right to inspect, amend, or correct this form. The Maryland Department of the Environment is subject to the Maryland Public Information Act. This form may be made available on the Internet via MDE's website and is subject to inspection or copying, in whole or in part, by the public and other governmental agencies, if not protected by federal or State Law.

MARYLAND DEPARTMENT OF THE ENVIRONMENT, WATER MANAGEMENT ADMINISTRATION  
1800 Washington Blvd., Baltimore, Maryland 21230 (410) 537-3784

\*\*\*\*\*  
WATER WELL ABANDONMENT-SEALING REPORT FORM  
\*\*\*\*\*

SUBMIT COPIES OF COMPLETED FORM TO:

- \* COUNTY ENVIRONMENTAL AGENCY (contact MDE, WMA if address needed)
- \* WELL OWNER
- \* MDE, WATER MANAGEMENT ADMINISTRATION, WELL PROGRAM

DATE WELL ABANDONED: 4/19/2024 (month/day/year)

\* PERMIT NUMBER OF ABANDONED WELL (if any)

\* PERMIT NUMBER OF REPLACEMENT WELL:

\* PERSON ABANDONING WELL: Steve Venios

WELL DRILLER'S LICENSE NUMBER: JG00087

\* OWNER'S NAME: On Road

CIRCLE: MWD / MSD / MGD / JG0

\* WELL LOCATION: Baltimore

SITE LOCATION MAP

COUNTY: Baltimore

NEAREST TOWN: Phoenix

TAX MAP 0035 BLOCK - PARCEL -

SUBDIVISION: -

SECTION: - LOT: -

STREET ADDRESS: Hampshire Glen CT

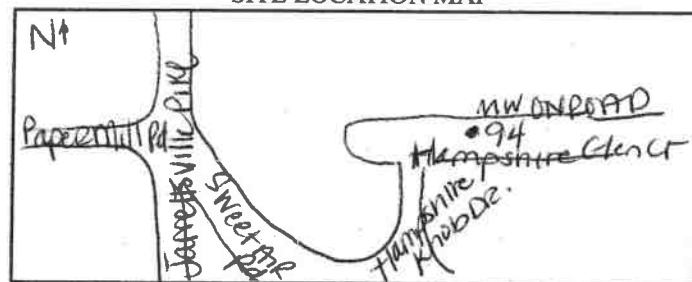

LATITUDE 39.519024

LONGITUDE 76.544722

LOG OF SEALING MATERIAL

MATERIAL	FEET	
	FROM	TO
Cement Bentonite Grout	0	37
VOLUME OF MATERIAL USED		
1.85 ft <sup>3</sup>		

\* TYPE OF WELL BEING ABANDONED:

☐ DRILLED ☐ JETTED  
☒ BORED ☐ HAND DUG  
☐ OTHER (specify) -

\* USE CODE:

☐ DOMESTIC ☐ MUNICIPAL/PUBLIC  
☐ IRRIGATION ☐ INDUSTRIAL  
☒ TEST/OBSERVATION ☐ GEOTHERMAL

\* TYPE OF CASING:

☐ STEEL ☒ PLASTIC  
☐ CONCRETE ☐ OTHER (specify) -

SIZE OF CASING: 2 INCHES IN DIAMETER

DEPTH OF WELL: 37 FEET DEEP

WAS ANY CASING REMOVED? ☒ YES ☐ NO

If yes, length removed, in feet: 2

WAS CASING RIPPED OR PERFORATED? ☐ YES ☒ NO

SIGNATURE-MASTER WELL DRILLER OR SUPERVISING SANITARIAN JG00087 LICENSE#

Pursuant to § 10-624 of the State Govt. Article of the Maryland Code, personal info requested on this form is used in processing this form pursuant to COMAR 26.04.04. Failure to provide the info may result in this form not being processed. You have the right to inspect, amend, or correct this form. The Maryland Department of the Environment is subject to the Maryland Public Information Act. This form may be made available on the Internet via MDE's website and is subject to inspection or copying, in whole or in part, by the public and other governmental agencies, if not protected by federal or State Law.

MWD / MSD / MGS  
CIRCLE ONE

7/12/24  
DATE

ORIGINAL

\*\*\*\*\*  
WATER WELL ABANDONMENT-SEALING REPORT FORM  
\*\*\*\*\*

SUBMIT COPIES OF COMPLETED FORM TO:

- \* COUNTY ENVIRONMENTAL AGENCY (contact MDE, WMA if address needed)
- \* WELL OWNER
- \* MDE, WATER MANAGEMENT ADMINISTRATION, WELL PROGRAM

DATE WELL ABANDONED: 4/25/2024 (month/day/year)

\* PERMIT NUMBER OF ABANDONED WELL (if any)

BA - 95 - 2073

\* PERMIT NUMBER OF REPLACEMENT WELL:

\* PERSON ABANDONING WELL: Steve Venias

WELL DRILLER'S LICENSE NUMBER: JD087

\* OWNER'S NAME: Brenden P and Emily M Sullivan

CIRCLE: MWD / MSD / MGD / JED

\* WELL LOCATION:

COUNTY: Baltimore

NEAREST TOWN: Phoenix

TAX MAP 6035 BLOCK — PARCEL 0221

SUBDIVISION: 0000

SECTION: 2 LOT: 2

STREET ADDRESS: 3605B Southside Ave

LATITUDE 39.520142

LONGITUDE 76.553791

SITE LOCATION MAP

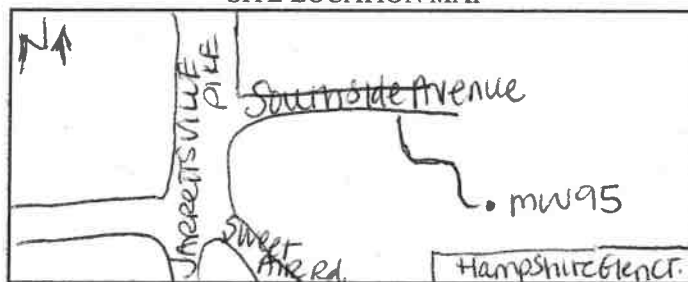

LOG OF SEALING MATERIAL

MATERIAL	FEET	
	FROM	TO
Cement Bentonite Grout	0	21
VOLUME OF MATERIAL USED		
1.05 ft. <sup>3</sup>		

\* TYPE OF WELL BEING ABANDONED:

☐ DRILLED ☐ JETTED  
☒ BORED ☐ HAND DUG  
☐ OTHER (specify) \_\_\_\_\_

\* USE CODE:

☐ DOMESTIC ☐ MUNICIPAL/PUBLIC  
☐ IRRIGATION ☐ INDUSTRIAL  
☒ TEST/OBSERVATION ☐ GEOTHERMAL

\* TYPE OF CASING:

☐ STEEL ☒ PLASTIC  
☐ CONCRETE ☐ OTHER (specify) \_\_\_\_\_

SIZE OF CASING: 2 INCHES IN DIAMETER

DEPTH OF WELL: 21 FEET DEEP

WAS ANY CASING REMOVED? ☒ YES ☐ NO

If yes, length removed, in feet: 2

WAS CASING RIPPED OR PERFORATED? ☐ YES ☒ NO

SIGNATURE-MASTER WELL DRILLER OR SUPERVISING SANITARIAN LICENSE#

[Signature]

MGD/10

MWD / MSD / MGS  
CIRCLE ONE

7/12/2024  
DATE

ORIGINAL

Pursuant to § 10-624 of the State Govt. Article of the Maryland Code, personal info requested on this form is used in processing this form pursuant to COMAR 26.04.04. Failure to provide the info may result in this form not being processed. You have the right to inspect, amend, or correct this form. The Maryland Department of the Environment is subject to the Maryland Public Information Act. This form may be made available on the Internet via MDE's website and is subject to inspection or copying, in whole or in part, by the public and other governmental agencies, if not protected by federal or State Law.

[View Map](#)

[View GroundRent Redemption](#)

[View GroundRent Registration](#)

**Special Tax Recapture:** None

**Account Identifier:**

**District - 10 Account Number - 2100005302**

### Owner Information

**Owner Name:**

SULLIVAN BRENDAN P  
SULLIVAN EMILY M

**Use:**

RESIDENTIAL

**Principal Residence:**

YES

**Mailing Address:**

3605B SOUTHSIDE AVE  
JACKSONVILLE MD 21131-1734

**Deed Reference:**

/13168/ 00476

### Location & Structure Information

**Premises Address:**

3605B SOUTHSIDE AVE  
JACKSONVILLE 21131-1734

**Legal Description:**

1.95 AC  
3605B SOUTHSIDE AVE  
STILLWATER FARM

<b>Map:</b>	<b>Grid:</b>	<b>Parcel:</b>	<b>Neighborhood:</b>	<b>Subdivision:</b>	<b>Section:</b>	<b>Block:</b>	<b>Lot:</b>	<b>Assessment Year:</b>	<b>Plat No:</b>
0035	0024	0221	10020020.04	0000	2		2	2023	<b>Plat Ref:</b> 0058/ 0127
<b>Town:</b> None									

<b>Primary Structure Built</b>	<b>Above Grade Living Area</b>	<b>Finished Basement Area</b>	<b>Property Land Area</b>	<b>County Use</b>
1991	3,948 SF	1200 SF	1.9500 AC	04

<b>Stories</b>	<b>Basement</b>	<b>Type</b>	<b>Exterior</b>	<b>Quality</b>	<b>Full/Half Bath</b>	<b>Garage</b>	<b>Last Notice of Major Improvements</b>
2 1/2	YES	STANDARD UNIT	SIDING/	4	5 full/ 2 half	1 Attached	

### Value Information

	<b>Base Value</b>	<b>Value</b>	<b>Phase-in Assessments</b>	
		As of 01/01/2023	As of 07/01/2024	As of 07/01/2025
<b>Land:</b>	98,500	192,100		
<b>Improvements</b>	531,300	361,500		
<b>Total:</b>	629,800	553,600	553,600	553,600
<b>Preferential Land:</b>	0	0		

### Transfer Information

<b>Seller:</b> EUBANKS EUGENE M,JR	<b>Date:</b> 09/23/1998	<b>Price:</b> \$412,500
<b>Type:</b> ARMS LENGTH IMPROVED	<b>Deed1:</b> /13168/ 00476	<b>Deed2:</b>
<b>Seller:</b> HUNGERFORD DAVID S	<b>Date:</b> 06/18/1996	<b>Price:</b> \$399,500
<b>Type:</b> ARMS LENGTH IMPROVED	<b>Deed1:</b> /11648/ 00133	<b>Deed2:</b>
<b>Seller:</b> KEY FEDERAL SAVINGS BANK	<b>Date:</b> 09/25/1992	<b>Price:</b> \$220,000
<b>Type:</b> ARMS LENGTH IMPROVED	<b>Deed1:</b> /09380/ 00068	<b>Deed2:</b>

### Exemption Information

<b>Partial Exempt Assessments:</b>	<b>Class</b>	07/01/2024	07/01/2025
<b>County:</b>	000	0.00	
<b>State:</b>	000	0.00	
<b>Municipal:</b>	000	0.00/0.00	0.00/0.00

**Special Tax Recapture:** None

### Homestead Application Information

**Homestead Application Status:** No Application

### Homeowners' Tax Credit Application Information

**Homeowners' Tax Credit Application Status:** No Application

**Date:**

**District: 10      Account Number: 2100005302**

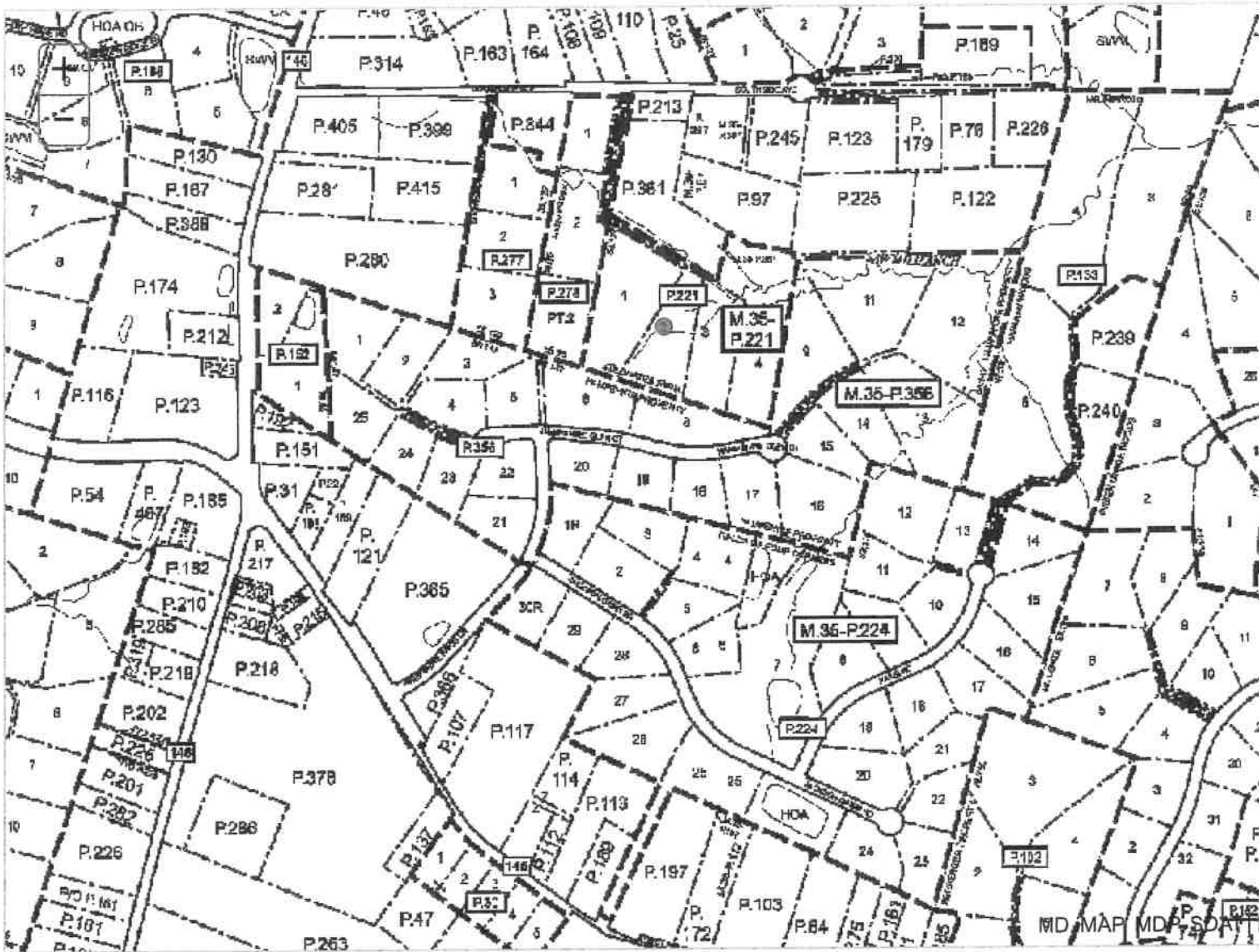

The information shown on this map has been compiled from deed descriptions and plats and is not a property survey. The map should not be used for legal descriptions. Users noting errors are urged to notify the Maryland Department of Planning Mapping, 301 W. Preston Street, Baltimore MD 21201.

If a plat for a property is needed, contact the local Land Records office where the property is located. Plats are also available online through the Maryland State Archives at [www.plats.net](http://www.plats.net) (<http://www.plats.net>).

Property maps provided courtesy of the Maryland Department of Planning.

For more information on electronic mapping applications, visit the Maryland Department of Planning web site at <http://planning.maryland.gov/Pages/OurProducts/OurProducts.aspx> (<http://planning.maryland.gov/Pages/OurProducts/OurProducts.aspx>).

\*\*\*\*\*  
WATER WELL ABANDONMENT-SEALING REPORT FORM  
\*\*\*\*\*

SUBMIT COPIES OF COMPLETED FORM TO:

- \* COUNTY ENVIRONMENTAL AGENCY (contact MDE, WMA if address needed)
- \* WELL OWNER
- \* MDE, WATER MANAGEMENT ADMINISTRATION, WELL PROGRAM

DATE WELL ABANDONED: 4/18/2024 (month/day/year)

\* PERMIT NUMBER OF ABANDONED WELL (if any)

BA - 95 - 1197

\* PERMIT NUMBER OF REPLACEMENT WELL:

\* PERSON ABANDONING WELL: Steve Venios

WELL DRILLER'S LICENSE NUMBER: JG0087

\* OWNER'S NAME: Steven B Griffin

CIRCLE: MWD / MSD / MGD / JGO

\* WELL LOCATION:

COUNTY: Baltimore

NEAREST TOWN: Phoenix

TAX MAP 0035 BLOCK 0000 PARCEL 0322

SUBDIVISION: 0000

SECTION: 3 LOT: 4

STREET ADDRESS: 14219 Rowcastle Rd.

LATITUDE 39.516881

LONGITUDE 76.563219

SITE LOCATION MAP

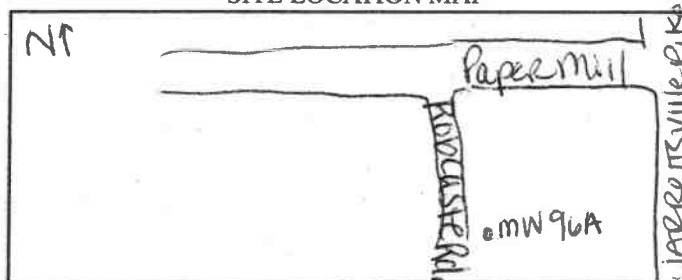

LOG OF SEALING MATERIAL

MATERIAL	FEET	
	FROM	TO
Cement. Bentonite Grout	0	25
VOLUME OF MATERIAL USED		
2.5 ft. <sup>3</sup>		

\* TYPE OF WELL BEING ABANDONED:

☐ DRILLED ☐ JETTED  
☒ BORED ☐ HAND DUG  
☐ OTHER (specify) \_\_\_\_\_

\* USE CODE:

☐ DOMESTIC ☐ MUNICIPAL/PUBLIC  
☐ IRRIGATION ☐ INDUSTRIAL  
☒ TEST/OBSERVATION ☐ GEOTHERMAL

\* TYPE OF CASING:

☐ STEEL ☒ PLASTIC  
☐ CONCRETE ☐ OTHER (specify) \_\_\_\_\_

SIZE OF CASING: 4 INCHES IN DIAMETER

DEPTH OF WELL: 25 FEET DEEP

WAS ANY CASING REMOVED? ☒ YES ☐ NO

If yes, length removed, in feet: 2

WAS CASING RIPPED OR PERFORATED? ☒ YES ☐ NO

SIGNATURE-MASTER WELL DRILLER OR SUPERVISING SANITARIAN [Signature] LICENSE# MGD110

CIRCLE ONE MWD / MSD / MGS

DATE 7/12/24

ORIGINAL

Pursuant to § 10-624 of the State Govt. Article of the Maryland Code, personal info requested on this form is used in processing this form pursuant to COMAR 26.04.04. Failure to provide the info may result in this form not being processed. You have the right to inspect, amend, or correct this form. The Maryland Department of the Environment is subject to the Maryland Public Information Act. This form may be made available on the Internet via MDE's website and is subject to inspection or copying, in whole or in part, by the public and other governmental agencies, if not protected by federal or State Law.

[View Map](#)

[View GroundRent Redemption](#)

[View GroundRent Registration](#)

**Special Tax Recapture:** None

**Account Identifier:**

District - 10 Account Number - 1800014079

### Owner Information

**Owner Name:**

GRIFFIN STEVEN B  
HENDERSON NATASHA R

**Use:**

RESIDENTIAL

**Principal Residence:**

YES

**Mailing Address:**

14219 ROBCASTE RD  
PHOENIX MD 21131-1453

**Deed Reference:**

/36546/ 00419

### Location & Structure Information

**Premises Address:**

14219 ROBCASTE RD  
PHOENIX MD 21131-1453

**Legal Description:**

2.128 AC  
14219 ROBCASTE RD  
ASCOT ESTATES

**Map:** 0035 **Grid:** 0022 **Parcel:** 0322  
**Neighborhood:** 10020025.04

**Subdivision:** 0000

**Section:** 3

**Block:**

**Lot:** 4 **Assessment Year:** 2023

**Plat No:**

**Plat Ref:** 0046/ 0047

**Town:** None

**Primary Structure Built**  
1996

**Above Grade Living Area**  
2,604 SF

**Finished Basement Area**  
850 SF

**Property Land Area**  
2.1200 AC

**County Use**  
04

**Stories** 2 **Basement** YES **Type** STANDARD UNIT

**Exterior** SIDING/ **Quality** 4

**Full/Half Bath** 3 full/ 1 half

**Garage** 1Att/1Det

**Last Notice of Major Improvements**

### Value Information

	Base Value	Value	Phase-in Assessments	
		As of	As of	As of
		01/01/2023	07/01/2024	07/01/2025
<b>Land:</b>	150,100	272,400		
<b>Improvements</b>	383,500	369,800		
<b>Total:</b>	533,600	642,200	606,000	642,200
<b>Preferential Land:</b>	0	0		

### Transfer Information

**Seller:** TOWNSEND TANYA L  
**Type:** ARMS LENGTH IMPROVED  
**Seller:** STEPHANOUK PAUL  
**Type:** ARMS LENGTH IMPROVED  
**Seller:** MALL DAVID C  
**Type:** ARMS LENGTH IMPROVED

**Date:** 08/17/2015  
**Deed1:** /36546/ 00419  
**Date:** 09/11/2013  
**Deed1:** /34197/ 00090  
**Date:** 05/10/2011  
**Deed1:** /30794/ 00063

**Price:** \$569,900  
**Deed2:**  
**Price:** \$540,000  
**Deed2:**  
**Price:** \$540,000  
**Deed2:**

### Exemption Information

<b>Partial Exempt Assessments:</b>	<b>Class</b>	07/01/2024	07/01/2025
<b>County:</b>	000	0.00	
<b>State:</b>	000	0.00	
<b>Municipal:</b>	000	0.00 0.00	0.00 0.00

**Special Tax Recapture:** None

### Homestead Application Information

**Homestead Application Status:** Approved 07/27/2016

### Homeowners' Tax Credit Application Information

**Homeowners' Tax Credit Application Status:** No Application

**Date:**



**District: 10      Account Number: 1800014079**

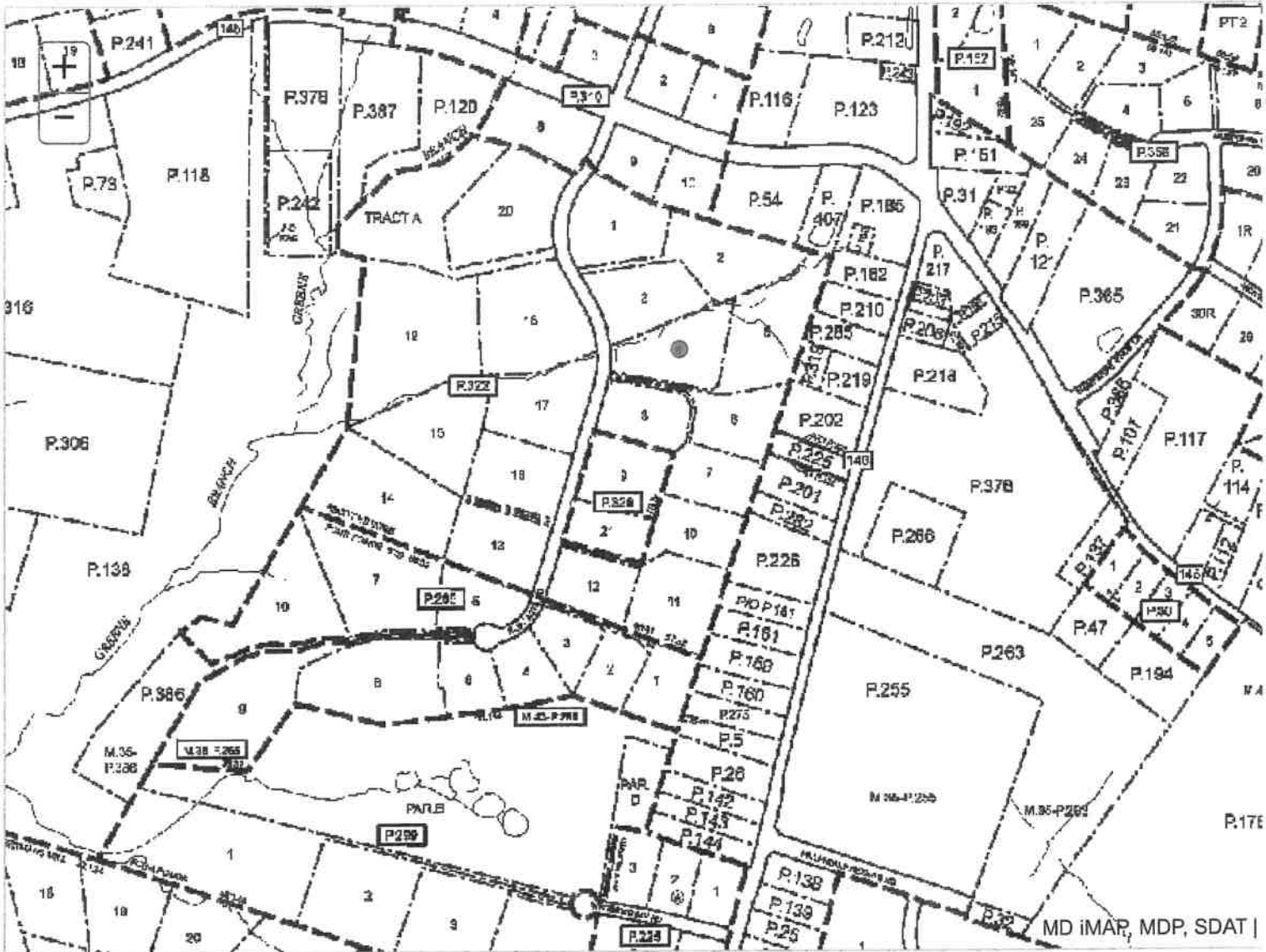

The information shown on this map has been compiled from deed descriptions and plats and is not a property survey. The map should not be used for legal descriptions. Users noting errors are urged to notify the Maryland Department of Planning Mapping, 301 W. Preston Street, Baltimore MD 21201.

If a plat for a property is needed, contact the local Land Records office where the property is located. Plats are also available online through the Maryland State Archives at [www.plats.net](http://www.plats.net) (<http://www.plats.net>).

Property maps provided courtesy of the Maryland Department of Planning.

For more information on electronic mapping applications, visit the Maryland Department of Planning web site at <http://planning.maryland.gov/Pages/OurProducts/OurProducts.aspx> (<http://planning.maryland.gov/Pages/OurProducts/OurProducts.aspx>).



[View Map](#)

[View GroundRent Redemption](#)

[View GroundRent Registration](#)

**Special Tax Recapture:** None

**Account Identifier:**

District - 10 Account Number - 1800014078

### Owner Information

**Owner Name:**

TIZARD STEVEN  
TIZARD TRACEY

**Use:**

RESIDENTIAL

**Principal Residence:**

YES

**Mailing Address:**

14221 ROBCASTE RD  
PHOENIX MD 21131-1453

**Deed Reference:**

/14003/ 00584

### Location & Structure Information

**Premises Address:**

14221 ROBCASTE RD  
PHOENIX 21131-1453

**Legal Description:**

2.139 AC  
14221 ROBCASTE RD  
ASCOT ESTATES

**Map:** 0035 **Grid:** 0022 **Parcel:** 0322  
**Neighborhood:** 10020025.04

**Subdivision:** 0000

**Section:** 3

**Block:** 3

**Lot:** 3 **Assessment Year:** 2023

**Plat No:**

**Plat Ref:** 0046/ 0047

**Town:** None

**Primary Structure Built**  
1994

**Above Grade Living Area**  
2,910 SF

**Finished Basement Area**

**Property Land Area**  
2.1300 AC

**County Use**  
04

**Stories**  
2

**Basement**  
YES

**Type**  
STANDARD UNIT

**Exterior**  
SIDING/

**Quality**  
4

**Full/Half Bath**  
2 full/ 1 half

**Garage**  
1 Attached

**Last Notice of Major Improvements**

### Value Information

	Base Value	Value	Phase-in Assessments	
		As of	As of	As of
		01/01/2023	07/01/2024	07/01/2025
<b>Land:</b>	150,200	272,600		
<b>Improvements</b>	316,100	300,100		
<b>Total:</b>	466,300	572,700	537,233	572,700
<b>Preferential Land:</b>	0	0		

### Transfer Information

**Seller:** RUPPERT JOHN WILLIAM,3RD

**Type:** ARMS LENGTH IMPROVED

**Date:** 06/28/1999

**Deed1:** /14003/ 00584

**Price:** \$355,000

**Deed2:**

**Seller:** ASCOT ESTATES INCORPORATED

**Type:** ARMS LENGTH IMPROVED

**Date:** 12/19/1995

**Deed1:** /11353/ 00724

**Price:** \$281,118

**Deed2:**

**Seller:**

**Date:**

**Price:**

**Type:**

**Deed1:**

**Deed2:**

### Exemption Information

<b>Partial Exempt Assessments:</b>	<b>Class</b>	07/01/2024	07/01/2025
<b>County:</b>	000	0.00	
<b>State:</b>	000	0.00	
<b>Municipal:</b>	000	0.00/0.00	0.00/0.00

**Special Tax Recapture:** None

### Homestead Application Information

**Homestead Application Status:** Approved 12/31/2012

### Homeowners' Tax Credit Application Information

**Homeowners' Tax Credit Application Status:** No Application

**Date:**

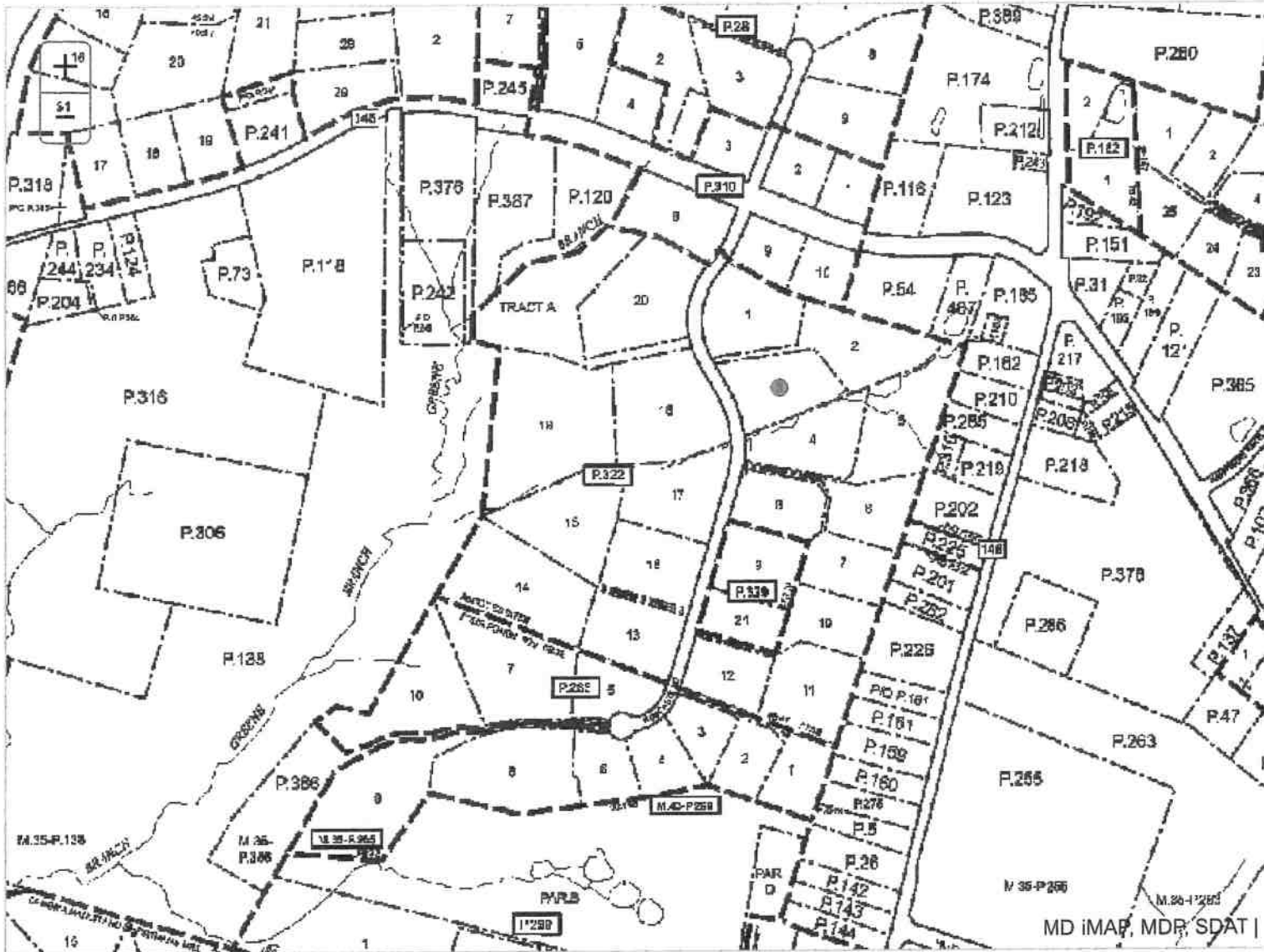
District: **10** Account Number: **1800014078**

The information shown on this map has been compiled from deed descriptions and plats and is not a property survey. The map should not be used for legal descriptions. Users noting errors are urged to notify the Maryland Department of Planning Mapping, 301 W. Preston Street, Baltimore MD 21201.

If a plat for a property is needed, contact the local Land Records office where the property is located. Plats are also available online through the Maryland State Archives at [www.plats.net](http://www.plats.net) (<http://www.plats.net>).

Property maps provided courtesy of the Maryland Department of Planning.

For more information on electronic mapping applications, visit the Maryland Department of Planning web site at <http://planning.maryland.gov/Pages/OurProducts/OurProducts.aspx> (<http://planning.maryland.gov/Pages/OurProducts/OurProducts.aspx>).

MARYLAND DEPARTMENT OF THE ENVIRONMENT, WATER MANAGEMENT ADMINISTRATION  
1800 Washington Blvd., Baltimore, Maryland 21230 (410) 537-3784

\*\*\*\*\*  
WATER WELL ABANDONMENT-SEALING REPORT FORM  
\*\*\*\*\*

SUBMIT COPIES OF COMPLETED FORM TO:

- \* COUNTY ENVIRONMENTAL AGENCY (contact MDE, WMA if address needed)
- \* WELL OWNER
- \* MDE, WATER MANAGEMENT ADMINISTRATION, WELL PROGRAM

DATE WELL ABANDONED: 4/18/2024 (month/day/year)

\* PERMIT NUMBER OF ABANDONED WELL (if any)

BA — 95 — 1135

\* PERMIT NUMBER OF REPLACEMENT WELL:

\* PERSON ABANDONING WELL: Steve Venias

WELL DRILLER'S LICENSE NUMBER: J6D087

\* OWNER'S NAME: Steven and Tracey Tizard

CIRCLE: MWD / MSD / MGD / J6D

\* WELL LOCATION:

COUNTY: Baltimore

NEAREST TOWN: Phoenix

TAX MAP 0035 BLOCK — PARCEL 0322

SUBDIVISION: 0000

SECTION: 3 LOT: 3

STREET ADDRESS: 14221 Robcaste Rd.

LATITUDE 39.517353

LONGITUDE 76.563058

SITE LOCATION MAP

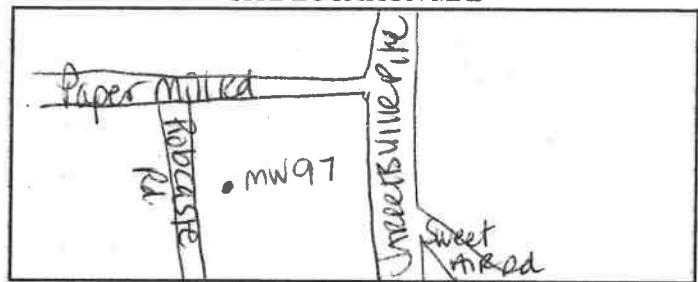

LOG OF SEALING MATERIAL

MATERIAL	FEET	
	FROM	TO
Cement Bentonite Grout	0	24
VOLUME OF MATERIAL USED		
2.4 ft. <sup>3</sup>		

\* TYPE OF WELL BEING ABANDONED:

☐ DRILLED ☐ JETTED  
☒ BORED ☐ HAND DUG  
☐ OTHER (specify) \_\_\_\_\_

\* USE CODE:

☐ DOMESTIC ☐ MUNICIPAL/PUBLIC  
☒ IRRIGATION ☐ INDUSTRIAL  
☒ TEST/OBSERVATION ☐ GEOTHERMAL

\* TYPE OF CASING:

☐ STEEL ☒ PLASTIC  
☐ CONCRETE ☐ OTHER (specify) \_\_\_\_\_

SIZE OF CASING: 4 INCHES IN DIAMETER

DEPTH OF WELL: 24 FEET DEEP

WAS ANY CASING REMOVED? ☒ YES ☐ NO

If yes, length removed, in feet: 2

WAS CASING RIPPED OR PERFORATED? ☐ YES ☒ NO

SIGNATURE-MASTER WELL DRILLER OR SUPERVISING SANITARIAN LICENSE#

MGD10

CIRCLE ONE

CIRCLE ONE

7/12/24

DATE

ORIGINAL

Pursuant to § 10-624 of the State Govt. Article of the Maryland Code, personal info requested on this form is used in processing this form pursuant to COMAR 26.04.04. Failure to provide the info may result in this form not being processed. You have the right to inspect, amend, or correct this form. The Maryland Department of the Environment is subject to the Maryland Public Information Act. This form may be made available on the Internet via MDE's website and is subject to inspection or copying, in whole or in part, by the public and other governmental agencies, if not protected by federal or State Law.