



# Maryland

## Department of the Environment

Larry Hogan, Governor  
Boyd K. Rutherford, Lt. Governor

Ben Grumbles, Secretary  
Horacio Tablada, Deputy Secretary

October 5, 2020

Herrington Partnership LLP  
c/o Jed Dickman  
PO Box 40  
Tracys Landing, Maryland 20779

**Via email:** [jed@herringtonharbour.com](mailto:jed@herringtonharbour.com) and [April.E.Sparkman@usace.army.mil](mailto:April.E.Sparkman@usace.army.mil)

Re: Agency Interest Number: 101768  
Tracking Number: 201861826  
Tidal Authorization Number: 20-WQC-0034

Dear Mr. Dickman:

Your project did not qualify for approval under the Maryland State Programmatic General Permit (MDSPGP); therefore, a separate review and issuance of the federal permit will be required by the U.S. Army Corps of Engineers. The federal permit is not attached.

Additionally, your project required a Wetlands License to be approved and issued by the Maryland Board of Public Works (BPW). The Wetlands License will be sent to you by the BPW's Wetlands Administrator.

A project that does not qualify for approval under the MDSPGP requires an individual Water Quality Certification (WQC) to be issued by the Maryland Department of the Environment, which is attached. Please take a moment to read and review your WQC to ensure that you understand the limits of the authorized work and all of the general and special conditions.

You should not begin any work until you have obtained all necessary State, local, and federal authorizations. Please contact Melissa McCanna at [melissa.mccanna@maryland.gov](mailto:melissa.mccanna@maryland.gov) or 410-537-4053 with any questions.

Sincerely,

A handwritten signature in blue ink, appearing to read "Danielle Spendiff".

Danielle Spendiff, Chief  
Western Region  
Tidal Wetlands Division



STATE OF MARYLAND  
DEPARTMENT OF THE ENVIRONMENT  
WATER AND SCIENCE ADMINISTRATION  
WATER QUALITY CERTIFICATION

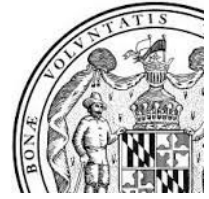

20-WQC-0034

EFFECTIVE DATE: **January 29, 2020**  
EXPIRATION DATE: **January 28, 2023**  
CERTIFICATION HOLDER: **Herrington Partnership LLP**  
ADDRESS: **PO Box 40**  
**Tracys Landing, Maryland 20779**  
PROJECT LOCATION: **389 Deale Rd (RTE 256)**  
**Deale, MD 20751**  
**Tracys Creek in Anne Arundel**

**UNDER AUTHORITY OF SECTION 401 OF THE FEDERAL WATER POLLUTION CONTROL ACT AND ITS AMENDMENTS AND IN ACCORDANCE WITH §9-313 THROUGH §9-323, INCLUSIVE, OF THE ENVIRONMENT ARTICLE, ANNOTATED CODE OF MARYLAND, THE WATER AND SCIENCE ADMINISTRATION (“ADMINISTRATION”) HAS DETERMINED THAT THE REGULATED ACTIVITY DESCRIBED IN STATE TIDAL WETLANDS LICENSE NUMBER 18-WL-1087 (“LICENSE”) WILL NOT VIOLATE MARYLAND’S WATER QUALITY STANDARDS, IF CONDUCTED IN ACCORDANCE WITH THE CONDITIONS OF THIS CERTIFICATION AND WITH ALL TERMS AND CONDITIONS OF THE LICENSE. A COPY OF THE LICENSE, INCLUDING APPROVED PROJECT DRAWINGS AND OTHER ATTACHMENTS, IS ATTACHED HERETO AND IS HEREBY INCORPORATED BY REFERENCE.**

THIS CERTIFICATION DOES NOT RELIEVE THE APPLICANT OF RESPONSIBILITY FOR OBTAINING ANY OTHER APPROVALS, LICENSES, OR PERMITS IN ACCORDANCE WITH FEDERAL, STATE, OR LOCAL REQUIREMENTS AND DOES NOT AUTHORIZE COMMENCEMENT OF THE PROPOSED PROJECT. A COPY OF THIS REQUIRED CERTIFICATION HAS BEEN SENT TO THE CORPS OF ENGINEERS.

THE CERTIFICATION HOLDER SHALL COMPLY WITH THE CONDITIONS LISTED BELOW.

### **SPECIAL CONDITIONS**

- A. The terms and conditions of Tidal Wetlands License No. **18-WL-1087** are hereby incorporated, by reference, into this Water Quality Certification. The Certification Holder shall comply with these conditions to ensure that the authorized activities will not result in a violation of the State's water quality standards.

## GENERAL CONDITIONS

- A. The proposed project shall be constructed in a manner which will not violate Maryland's Water Quality Standards as set forth in COMAR 26.08.02. The applicant is to notify this Department ten (10) days prior to commencing work. Verbal notification is to be followed by written notice within ten (10) days.
- B. The Maryland Department of the Environment has determined that the proposed activities comply with, and will be conducted in a manner consistent with the State's Coastal Zone Management Program, as required by Section 307 of the Federal Coastal Zone Management Act of 1972, as amended.
- C. If the authorized work is not performed by the property owner, all work performed under this Tidal Wetlands License shall be conducted by a marine contractor licensed by the Marine Contractors Licensing Board (MCLB) in accordance with Title 17 of the Environment Article of Annotated Code of Maryland. A list of licensed marine contractors may be obtained by contacting the MCLB at 410-537-3249, by e-mail at [MDE.MCLB@maryland.gov](mailto:MDE.MCLB@maryland.gov) or by accessing the Maryland Department of the Environment, Environmental Boards webpage.
- D. The Certification Holder shall ensure the proposed project shall be constructed in accordance with the authorized plan and any authorized revisions.
- E. The Certification Holder shall ensure that all fill and construction materials not used in the project shall be removed and disposed of in a manner which will prevent their entry into waters of this State.
- F. The Certification Holder shall notify the Water and Science Administration, Tidal Wetlands Division, in writing, upon transferring property ownership or responsibility for compliance with these conditions to another person. The new owner/operator shall request, in writing, transfer of this Water Quality Certification to his/her name.
- G. The Certification Holder shall allow representatives of the Maryland Department of the Environment to inspect the authorized activities.
- H. The Certification Holder shall ensure that a copy of this Permit, including the approved plans, is available at the site until the authorized work is complete.
- I. The Certification does not relieve the Certification holder from the responsibility of obtaining all necessary federal, State, and local government authorizations.
- J. The Certification Holder shall comply with all Critical Area requirements and obtain all necessary authorizations from local jurisdiction. This Certification does not constitute authorization for disturbance in the 100-foot Critical Area Buffer. "Disturbance" in the Buffer means clearing, grading, construction activities, or removal of any size of tree or vegetation. Any anticipated Buffer disturbance requires prior written approval, before commencement of land disturbing activity, from local jurisdiction in the form of a Buffer Management Plan.

Failure to comply with these conditions shall constitute reason for suspension or revocation of the Water Quality Certification, and legal proceedings may be instituted against the Certification Holder in accordance with the Annotated Code of Maryland. In granting this certification, the Department reserves the right to inspect the operations and records regarding this project at anytime

**CERTIFICATION APPROVED**



---

D. Lee Currey, Director  
Water and Science Administration

10/6/2020

---

Date

Tracking Number: 201861826  
Agency Interest Number: 101768

Effective Date: January 29, 2020

Enclosure: Executed Tidal Wetlands License No. **18-WL-1087** with all plans and attachments.

cc: WMA Inspection & Compliance Program

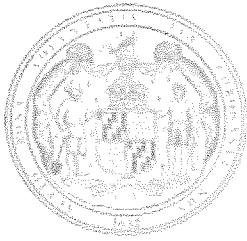

William Morgante, PWS  
Wetlands Administrator

State of Maryland  
**Board of Public Works**  
Wetlands Administration  
Post Office Box 1510 Annapolis, Maryland 21404  
410-260-7791

Larry Hogan  
Governor

Nancy K. Kopp  
Treasurer

Peter Franchot  
Comptroller

John T. Gontrum, Esq.  
Executive Secretary

**WETLANDS LICENSE NO. 18-1087**

**HERRINGTON PARTNERSHIP LLP**

The Maryland Board of Public Works authorizes you to:

- I. Hydraulically and/or mechanically maintenance dredge 26.8 acres of marina to a depth of 7 feet below mean low water.
- II. Deposit approximately 10,000 cubic yards of dredged material at an approved upland disposal site on Licensee's property.
- III. Provide for periodic maintenance dredging for six years.
- IV. Construct a new 150-foot long by 8-foot wide timber pier called Dock S, extending a maximum of 150 feet channelward of the mean high-water line.
- V. Reconfigure Docks P, O, N, H, G and F.
- VI. Make minor changes to Docks B and C.
- VII. Create a 50-foot long by 17-foot wide travel well.
- VIII. Expand three existing travel lift wells:
  - a. From 50 feet long by 18 feet wide to 71 feet long by 21 feet wide;
  - b. From 62 feet long by 20 feet wide to 85 feet long by 26 feet wide; and
  - c. From 40 feet long by 16 feet wide to 65 feet long by 21 feet wide.
- IX. Construct and backfill 900 linear feet of replacement timber bulkhead within a maximum of 18 inches channelward of a deteriorated bulkhead.
- X. Place 500 feet of riprap revetment within a maximum of 4 feet channelward of the mean high-water line.
- XI. Place 250 feet of riprap revetment within a maximum of 4 feet channelward of the mean high-water line.
- XII. Place 288 feet of riprap revetment within a maximum of 4 feet channelward of the mean high-water line.
- XIII. Place 288 feet of low-profile sill within a maximum of 25 feet channelward of the mean high-water line.
- XIV. Fill, grade, and plant marsh vegetation along 288 feet of eroding shoreline with 275 cubic yards of sand.

*Tracys Creek at 389 Deale Road, Tracys Landing, Anne Arundel County, MD*

Issuance of this Tidal Wetlands License constitutes the State's determination that the authorized activities are consistent with the Maryland Coastal Zone Management Program, as required by Section 307 of the Federal Coastal Zone Management Act of 1972, as amended [16 U.S.C. §1456]. Accordingly, the State

concurs with the Licensee's certification in the Joint Permit Application that the project complies with and will be conducted in a manner consistent with the Maryland CZMP.

**THIS LICENSE AUTHORIZES YOU TO PERFORM THE WORK ONLY IF YOU COMPLY WITH THE FOLLOWING SPECIAL CONDITION(S):**

- A. No dredging shall be performed from March 1 through June 15, inclusive, for the dredging aspect of this application of any year.
- B. No boats shall be docked outside of the approved Marina Basin Line, as depicted on the authorized plans for this License.
- C. If hydraulic dredging is performed, the dredged material placement site (DMP) shall be constructed to limit turbidity in the discharge to waters of the State. A turbidity sample of the discharge water shall be performed every hour of active pumping to the DMP or when there is an observed change in the clarity of the water. Turbidity in the discharge may not exceed 150 units at any time or 50 units as a monthly average. Units shall be measured in Nephelometer Turbidity Units. A logbook of all turbidity monitoring shall be kept on site. The dredger shall have a person at the discharge point of the DMP in constant radio communication. If a problem is incurred, the dredging operation shall be immediately shut down until the reason for the problem can be ascertained and rectified.
- D. Licensee shall conduct subsequent maintenance dredging within the scope of this license in terms of authorized dredge area and authorized depths. Licensee shall:
  - a. Dredge no more than 500 cubic yards of material at each maintenance dredging.
  - b. Comply with all applicable conditions of this license.
  - c. Submit a detailed dredged material disposal plan to be approved by Maryland Department of the Environment's (MDE) Water and Science Administration, Tidal Wetlands Division, prior to the start of dredging.
- E. Licensee shall construct the marsh establishment area in accordance with the following conditions:
  - a. Licensee shall use clean substrate fill material, no more than 10% of which shall pass through a standard number 100 sieve.
  - b. The marsh establishment area shall be planted within one year following completion of the filling operation. Maintenance planting and debris removal shall be performed as needed.
  - c. The marsh establishment project shall be maintained as a wetland, with non-nuisance species aerial coverage of at least 85% for three consecutive years. If 85% coverage is not attained, the reasons for failure shall be determined, corrective measures shall be taken, and the area shall be replanted.
- F. There shall be no shellfish harvesting or storage within the waters of the marina.
- G. Licensee shall transport all dredged material in watertight trucks. No dredged materials shall be discharged onto the roadways of the state.

**THIS LICENSE AUTHORIZES YOU TO PERFORM THE WORK ONLY IF YOU COMPLY WITH THE FOLLOWING STANDARD CONDITIONS:**

- 1. Licensee shall conduct the authorized work in accordance with the plans and drawings dated August 2019, which are hereby incorporated into this License.
- 2. Until the authorized work is complete, Licensee shall have available at the site a copy of this License including the plans and drawings.

3. This License constitutes Maryland's authorization to conduct the authorized work under the State Tidal Wetlands Law. This License does not bestow any other federal, State, or local government authorization.
4. Licensee shall have all proposed work above Mean High Water reviewed and authorized by the local county Department of Planning and Zoning or applicable agency.
5. Licensee shall notify MDE's Inspection and Compliance Program by phone (410-537-3510) AND in writing (MDE, Inspection and Compliance Program, 1800 Washington Boulevard, Baltimore, MD 21230) of the following:
  - start date at least five business days before beginning work; and
  - completion date no more than five business days after project completion.
6. If MDE has issued a Water Quality Certification with respect to the authorized work, Licensee shall comply with all conditions of that certification.
7. Licensee shall conduct the authorized work in accordance with Critical Area Commission requirements. This License does not authorize disturbance in the Buffer. If authorized work will disturb the Buffer, Licensee shall have a Commission-approved or locally-approved Buffer Management Plan before beginning the authorized work.

"Buffer" means the 100-foot Critical Area Buffer and any expanded area that is immediately landward of the mean high water line of the tidal waters or is immediately landward of tidal wetlands. The Buffer includes expanded contiguous area if the contiguous area includes steep slopes, hydric soil, or highly erodible soil, or otherwise meets the criteria of COMAR 27.01.09.01.E(7). "Disturbance" means any alteration or change to the land including any amount of clearing. Clearing includes vegetation removal, grading, and construction activity.
8. Licensee may not fill, dredge, or otherwise alter or destroy tidal marsh or its vegetation unless this License specifically authorizes the activity.
9. Licensee may not stockpile material in State tidal wetlands or State tidal waters of the U.S.
10. Licensee shall allow unfettered public use of State wetlands and State tidal waters of the U.S.
11. This License does not transfer a property interest of the State.
12. Licensee shall file a Miss Utility ticket for the proposed work at least 10 days before beginning work. *Miss Utility: 800-257-7777*
13. Licensee shall ensure that structures (for example, piers and piles) removed from the site are taken to an upland disposal facility approved by MDE's Inspection and Compliance Program.
14. If the authorized work impacts more than 5,000 square feet or includes 100 or more cubic yards of fill, Licensee shall conduct the authorized work in accordance with a locally-approved Soil Erosion and Sediment Control Plan.
15. If the authorized work is not performed by the property owner, all work performed under this Tidal Wetlands License shall be conducted by a marine contractor licensed by the Marine Contractors Licensing Board (MCLB) in accordance with Title 17 of the Environment Article of Annotated Code of Maryland. A list of licensed marine contactors may be obtained by contacting the MCLB at 410-537-3249, by email at [MDE.MCLB@maryland.gov](mailto:MDE.MCLB@maryland.gov) or by accessing the *Maryland Department of the Environment, Environmental Boards webpage*.
16. Licensee shall allow State officials and employees to make inspections at reasonable times and cooperate with those inspections.

- 17. This License is granted only to the Licensee. Licensee may transfer the license only with written approval from the Board of Public Works. If the Board of Public Works approves the transfer, the transferee is subject to all License terms and conditions.
- 18. Licensee shall indemnify, defend, and save harmless the State of Maryland, its officials, officers, and employees from and against any and all liability, suits, claims, and actions of whatever kind, caused by or arising from, the work this License authorizes.
- 19. The Board of Public Works or its Wetlands Administrator may modify, suspend, or revoke this License in its reasonable discretion.
- 20. This License expires January 29, 2026. If the authorized work is not completed by the expiration date, all activity must stop.

Note: A three-year license may be renewed for one additional three-year term if the Licensee requests an extension before the expiration date and all other conditions are met. A six-year license may not be renewed; instead Licensee must reapply to MDE for a new license. Contact the Board of Public Works to determine if this License may be extended.  
 Board of Public Works: 410-260-7791

By the authority of the Board of Public Works:

---

John T. Gontrum  
 Executive Secretary

Effective Date: January 29, 2020  
 Approved as: Secretary's Agenda Item 3  
 Board of Public Works Meeting Date: January 29, 2020

I accept this License and all its conditions.

August 26, 2020  
 Date

S. Hamilton Chaney  
 Licensee (Signature)

S. HAMILTON CHANEY  
 Name (Printed)

Managing Member  
 Title

hamilton@herringtonharbour.com  
 Email (To receive completed license.)



**SCOPE OF WORK**

SEE SHEETS AND 1 AND 2 FOR SCOPE OF WORK

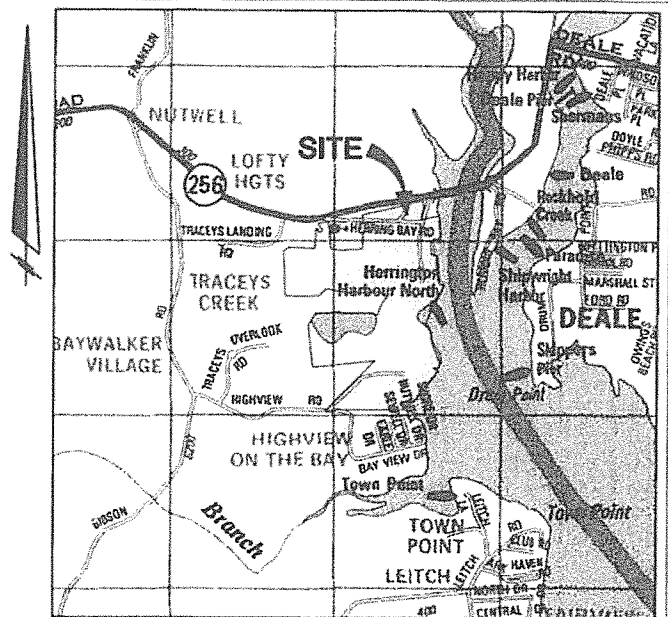

Copyright ADC The Map People  
Permitted Use Number 203011635

**VICINITY MAP**  
SCALE: 1" = 2000'



MDE #: 8-WL-1087  
AI #: 101768  
PLAN DATE: 9/9/19  
SHEET 1 OF 26

**EROSION CONTROL**

900 L.F.: REPLACEMENT BULKHEAD (18" MAX.)  
(SEE SHEETS 4, 5, AND 15))

~~312 L.F.: TOE PROTECTION ALONG LOW PROFILE  
BULKHEAD PROTECTING EXISTING MARSH  
(SEE SHEET 12)~~

500 L.F.: 4' STONE REVETMENT  
(SEE SHEET 6) *and 19, 20*

250 L.F.: 4' STONE REVETMENT  
(SEE SHEET 8) *and 19, 20*

3,000 S.F.: WETLAND PLANTING (ALTERNIFLORA)

275 C.Y.: SAND FILL

291 C.Y.: BULKHEAD FILL

10,000 C.Y.; 26.8 AC.: HYDRAULIC AND/OR MECHANICAL MAINTENANCE DREDGING

**GENERAL NOTES**

1. THE PROPERTY SHOWN HEREON IS BASED ON A FIELD SURVEY BY RONALD W. JOHNSON ASSOCIATES, INC.
2. ELEVATIONS AND CONTOURS SHOWN HEREON ARE BASED ON AN AERIAL SURVEY BY POTOMAC AERIAL SURVEYS, FREDERICK, MD.
3. MEAN TIDAL RANGE IS 1.0 FEET (NGVD 29).
4. A PORTION OF THE EXISTING MARINA WAS PREVIOUSLY APPROVED UNDER WETLANDS LICENSE NO. 05-WL-0231.
5. REVETMENT SHALL EXTEND NO FURTHER CHANNELWARD OF MHW THAN NECESSARY TO MAINTAIN A 2:1 SLOPE.
6. THESE DRAWINGS ARE FOR OUTLINE PURPOSES ONLY. DESIGN DRAWINGS ARE TO BE PROVIDED.

**ADJOINING PROPERTY OWNERS**

HIGHVIEW COMMUNITY ASSOC.  
HIGHVIEW ROAD  
TRACEYS LANDING, MD 20779

STATE OF MARYLAND  
HIGHWAY ADMINISTRATION  
138 DEFENSE HWY.  
ANNAPOLIS, MD 21401

MARYLAND DEPARTMENT OF THE ENVIRONMENT &  
BALTIMORE DISTRICT CORPS. OF ENGINEERS  
LICENSE & PERMIT EXHIBIT

**HERRINGTON HARBOUR NORTH**

TAX MAP 77; BLOCKS 11 & 12; PARCEL 89

8TH TAX DISTRICT  
SCALE: AS SHOWN

PAGE 1 OF 26

A.A. CO., MD  
AUGUST, 2019

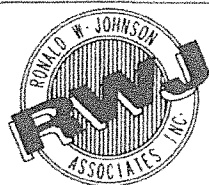

**Ronald W. Johnson Associates, Inc.**  
Consulting Engineers, Land Planners, Surveyors

2661 Riva Road Building 400, Suite 420 Annapolis, MD 21401  
410.841.5221 410.266.6612 Fax 410.841.5124

**SCOPE OF WORK**

B DOCK: 5 EA. MOORING PILES ✓  
 4 EA. 4' X 11' FINGER PIER EXTENSIONS ✓  
 DEMO: 5 EA. MOORING PILES ✓

C DOCK: 22' X 30' DECKING

F DOCK: 4 EA. MOORING PILES ✓  
 2 EA. 40' X 4' FINGER PIER EXTENSIONS ✓

G DOCK: 8' x 472' COLLECTOR PIER ✓  
 40 EA. MOORING PILES ✓  
 20 EA. 4' X 40' FINGER PIER ✓  
 1 EA. 1630 S.F. T-HEAD ✓  
 1 EA. 8' X 53' PEDESTRIAN PIER ✓  
 1 EA. 8' X 124' PEDESTRIAN PIER (G-H) ✓  
 88' SLOTTED TIMBER BREAKWATERS ✓  
 DEMO: 500'± EXISTING COLLECTOR PIER ✓  
 124'± PEDESTRIAN PIER ✓  
 54 EA. MOORING PILES ✓  
 22 EA. FINGER PIERS ✓  
 68'± T-HEAD ✓

H DOCK: 8' x 444' COLLECTOR PIER ✓  
 36 EA. MOORING PILES ✓  
 9 EA. 4' X 40' FINGER PIER ✓  
 1 EA. 4' X 73' FINGER PIER ✓  
 2 EA. 4' X 60' FINGER PIER ✓  
 1 EA. 4' X 55' FINGER PIER ✓  
 1 EA. 4' X 53' FINGER PIER ✓  
 3 EA. 4' X 50' FINGER PIER ✓  
 1 EA. 8' X 40' T-HEAD ✓  
 1 EA. 8' X 65' T-HEAD ✓  
 1 EA. 8' X 189' PEDESTRIAN PIER (H-I) ✓  
 113' SLOTTED TIMBER BREAKWATERS ✓  
 DEMO: 445'± EXISTING COLLECTOR PIER ✓  
 52 EA. MOORING PILES ✓  
 23 EA. FINGER PIERS ✓  
 79'± T-HEAD ✓

N DOCK: 8' x 284' COLLECTOR PIER ✓  
 28 EA. MOORING PILES ✓  
 12 EA. 4' X 30' FINGER PIER ✓  
 DEMO: 214'± EXISTING COLLECTOR PIER ✓  
 44 EA. MOORING PILES ✓  
 16 EA. TAPERED FINGER PIERS ✓

O DOCK: 8' x 299' COLLECTOR PIER ✓  
 28 EA. MOORING PILES ✓  
 14 EA. 4' x 30' FINGER PIER ✓  
 DEMO: 296'± EXISTING COLLECTOR PIER ✓  
 48 EA. MOORING PILES ✓  
 16 EA. TAPERED FINGER PIERS ✓

P DOCK: 8' x 314' COLLECTOR PIER ✓  
 30 EA. MOORING PILES ✓  
 9 EA. 4' x 30' FINGER PIER ✓  
 5 EA. 4' x 35' FINGER PIER ✓  
 DEMO: 303'± EXISTING COLLECTOR PIER ✓  
 50 EA. MOORING PILES ✓  
 18 EA. TAPERED FINGER PIERS ✓

S DOCK: 8' x 185' PEDESTRIAN PIER ✓

TRAVEL WELLS:  
 REPLACE EXISTING 50'X18'± WITH 71'X21'  
 (NEAR L-DOCK) (SEE SHEET 4 & 11)  
 REPLACE EXISTING 62'X20'± WITH 85'X26'  
 (NEAR L-DOCK) (SEE SHEET 5 & 11)  
 ADD NEW 50'X17' (NEAR E-DOCK)  
 (SEE SHEET 6 & 7)  
 REPLACE EXISTING 40'X16'± WITH 65'X21'  
 (NEAR E-DOCK) (SEE SHEET 6 & 7)  
*Cross-sections Sheets 21-24*



MDE #: 18-WL-1087  
 AI #: 101768  
 PLAN DATE: 9/9/19  
 SHEET 2 OF 26

MARYLAND DEPARTMENT OF THE ENVIRONMENT &  
 BALTIMORE DISTRICT CORPS. OF ENGINEERS  
 LICENSE & PERMIT EXHIBIT

**HERRINGTON HARBOUR NORTH**

TAX MAP 77; BLOCKS 11 & 12; PARCEL 89

8TH TAX DISTRICT  
 SCALE: AS SHOWN

PAGE 2 OF 26

A.A. CO., MD  
 AUGUST, 2019

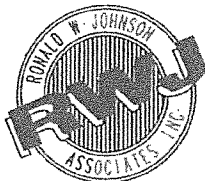

**Ronald W. Johnson Associates, Inc.**  
 Consulting Engineers, Land Planners, Surveyors

2661 Riva Road Building 400, Suite 420 Annapolis, MD 21401  
 410.841.5221 410.266.6612 Fax 410.841.5124

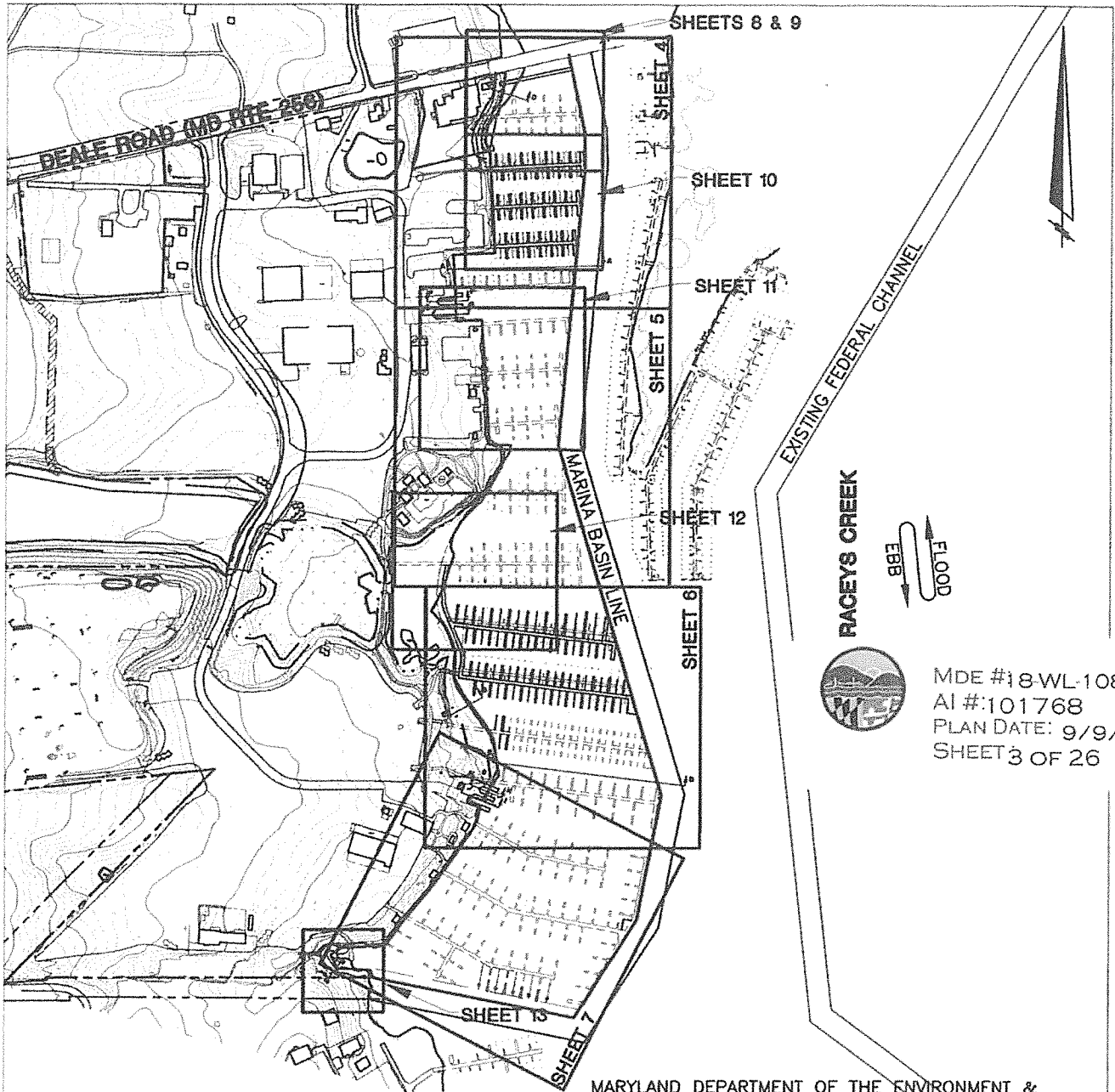

MDE #18-WL-1087  
 AI #:101768  
 PLAN DATE: 9/9/19  
 SHEET 3 OF 26

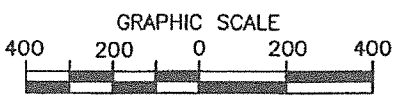
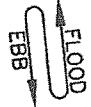

MARYLAND DEPARTMENT OF THE ENVIRONMENT &  
 BALTIMORE DISTRICT CORPS. OF ENGINEERS  
 LICENSE & PERMIT EXHIBIT  
**HERRINGTON HARBOUR NORTH**  
 TAX MAP 77; BLOCKS 11 & 12; PARCEL 89  
 8TH TAX DISTRICT  
 SCALE: 1" = 400'      PAGE 3 OF 26      A.A. CO., MD  
 AUGUST, 2019

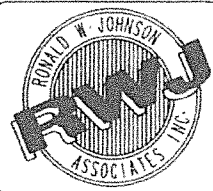

**Ronald W. Johnson Associates, Inc.**  
 Consulting Engineers, Land Planners, Surveyors

2661 Riva Road Building 400, Suite 420 Annapolis, MD 21401  
 410.841.5221 410.266.6612 Fax 410.841.5124

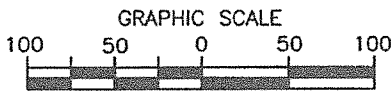
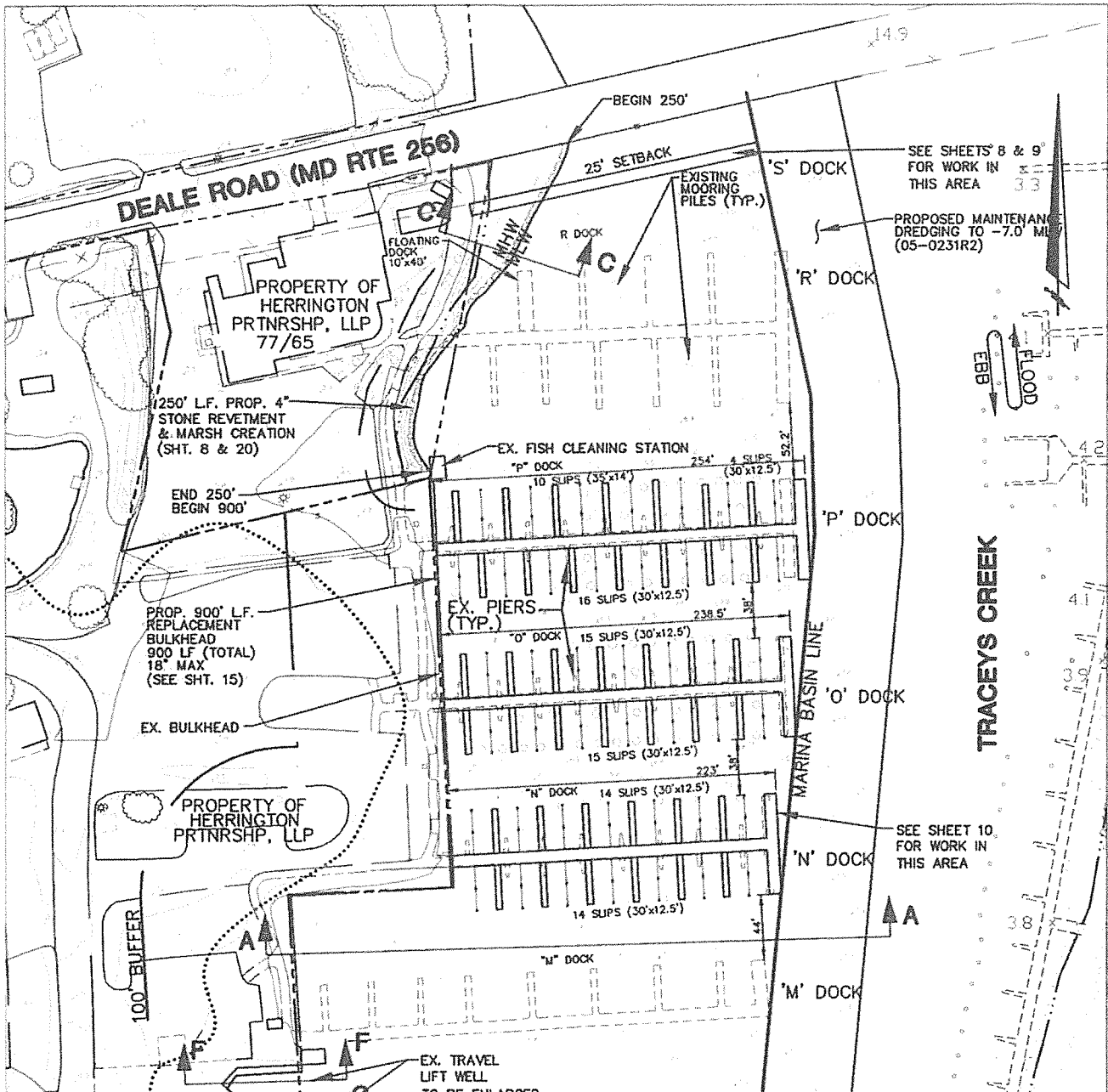

1 inch = 100 ft.

MARYLAND DEPARTMENT OF THE ENVIRONMENT & BALTIMORE DISTRICT CORPS. OF ENGINEERS  
 LICENSE & PERMIT EXHIBIT  
**HERRINGTON HARBOUR NORTH**  
 TAX MAP 77; BLOCKS 11 & 12; PARCEL 89  
 8TH TAX DISTRICT SCALE: 1" = 100'  
 PAGE 4 OF 26 A.A. CO., MD AUGUST, 2019

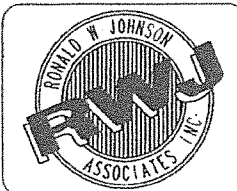

**Ronald W. Johnson Associates, Inc.**  
 Consulting Engineers, Land Planners, Surveyors

2661 Riva Road Building 400, Suite 420 Annapolis, MD 21401  
 410.841.5221 410.266.6612 Fax 410.841.5124



MDE #: AI #: 18-WL-1087  
 PLAN DATE: 10/7/18  
 SHEET 9/9/19  
 4 OF 26

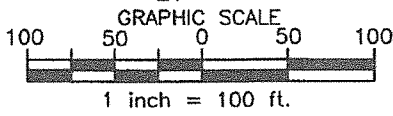
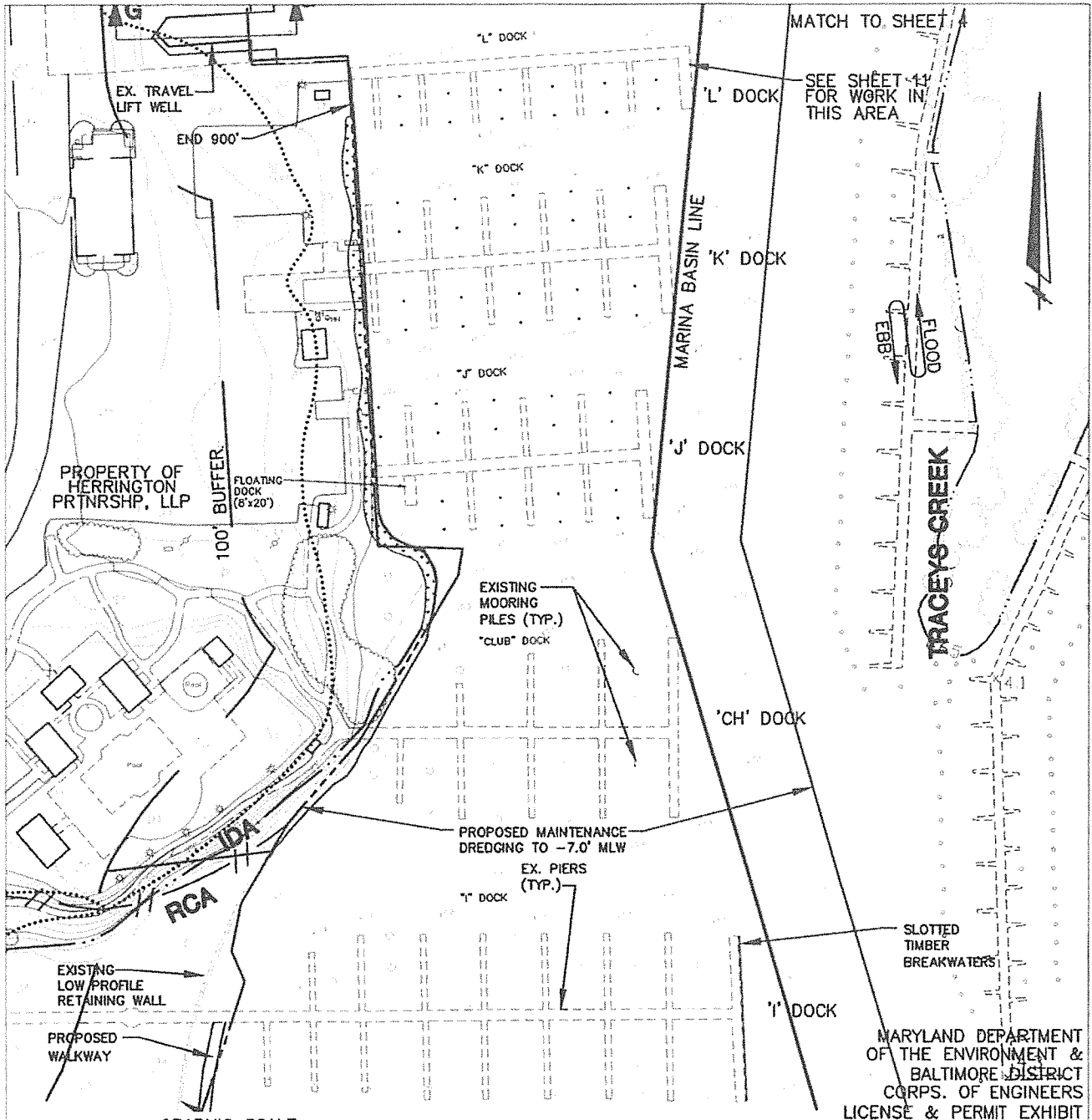

**HERRINGTON HARBOUR NORTH**

TAX MAP 77; BLOCKS 11 & 12; PARCEL 89  
8TH TAX DISTRICT  
SCALE: 1" = 100'

MARYLAND DEPARTMENT OF THE ENVIRONMENT & BALTIMORE DISTRICT CORPS. OF ENGINEERS LICENSE & PERMIT EXHIBIT



**Ronald W. Johnson Associates, Inc.**  
Consulting Engineers, Land Planners, Surveyors

2661 Riva Road Building 400, Suite 420 Annapolis, MD 21401  
410.841.5221 410.266.6612 Fax 410.841.5124



MDE #: 8-WL-1087  
AI #: 101768  
PLAN DATE: 9/9/19  
SHEET 5 OF 26

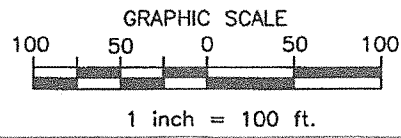
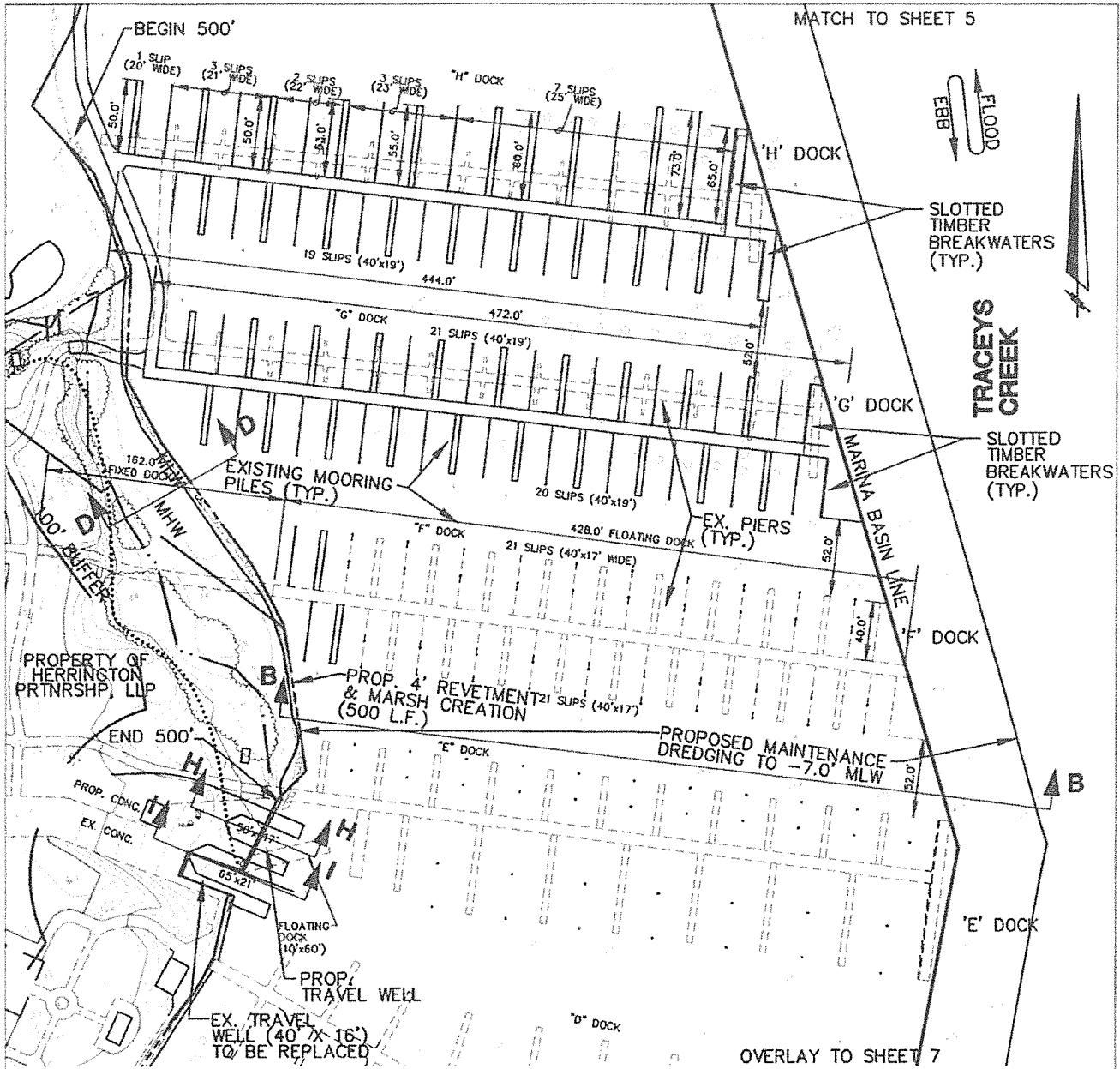

MARYLAND DEPARTMENT OF THE ENVIRONMENT &  
BALTIMORE DISTRICT CORPS. OF ENGINEERS  
LICENSE & PERMIT EXHIBIT

**HERRINGTON HARBOUR NORTH**  
TAX MAP 77; BLOCKS 11 & 12; PARCEL 89  
8TH TAX DISTRICT  
SCALE: 1" = 100'

PAGE 6 OF 26  
A.A. CO., MD  
AUGUST, 2019



**Ronald W. Johnson Associates, Inc.**  
Consulting Engineers, Land Planners, Surveyors

2661 Riva Road Building 400, Suite 420 Annapolis, MD 21401  
410.841.5221 410.266.6612 Fax 410.841.5124



MDE #i8-WL-1087  
AI #: 101768  
PLAN DATE: 9/9/19  
SHEET 6 OF 26

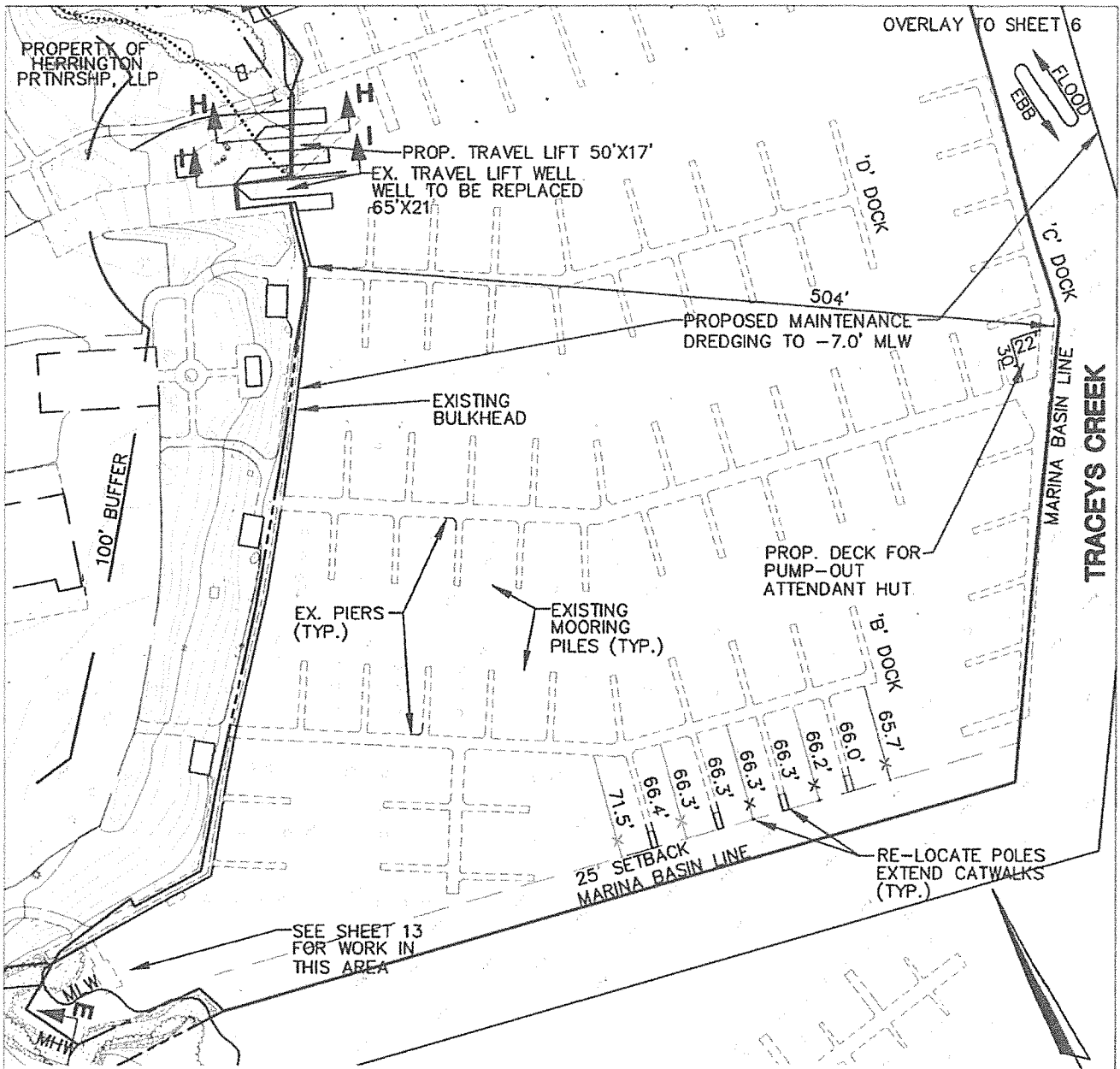

OVERLAY TO SHEET 6

PROPERTY OF  
HERRINGTON  
PARTNERSHIP, LLP

PROP. TRAVEL LIFT 50'X17'  
EX. TRAVEL LIFT WELL  
WELL TO BE REPLACED  
65'X21'

504'  
PROPOSED MAINTENANCE  
DREDGING TO -7.0' MLW

EXISTING  
BULKHEAD

100' BUFFER

EX. PIERS  
(TYP.)

EXISTING  
MOORING  
PILES (TYP.)

PROP. DECK FOR  
PUMP-OUT  
ATTENDANT HUT.

B. DOCK  
65.7'

25' SETBACK  
MARINA BASIN LINE

RE-LOCATE POLES  
EXTEND CATWALKS  
(TYP.)

SEE SHEET 13  
FOR WORK IN  
THIS AREA

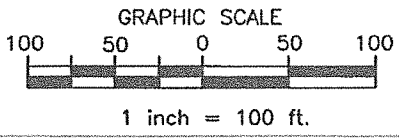

MARYLAND DEPARTMENT OF THE ENVIRONMENT &  
BALTIMORE DISTRICT CORPS. OF ENGINEERS  
LICENSE & PERMIT EXHIBIT

### HERRINGTON HARBOUR NORTH

TAX MAP 77; BLOCKS 11 & 12; PARCEL 89

8TH TAX DISTRICT  
SCALE: 1" = 100'

PAGE 7 OF 26

A.A. CO., MD  
AUGUST, 2019



**Ronald W. Johnson Associates, Inc.**  
Consulting Engineers, Land Planners, Surveyors

2661 Riva Road Building 400, Suite 420 Annapolis, MD 21401  
410.841.5221 410.266.6612 Fax 410.841.5124



MDE #: 18-WL-1087  
AI #: 101768  
PLAN DATE: 9/9/19  
SHEET 7 OF 26

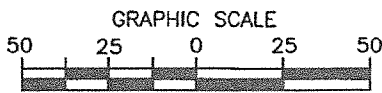
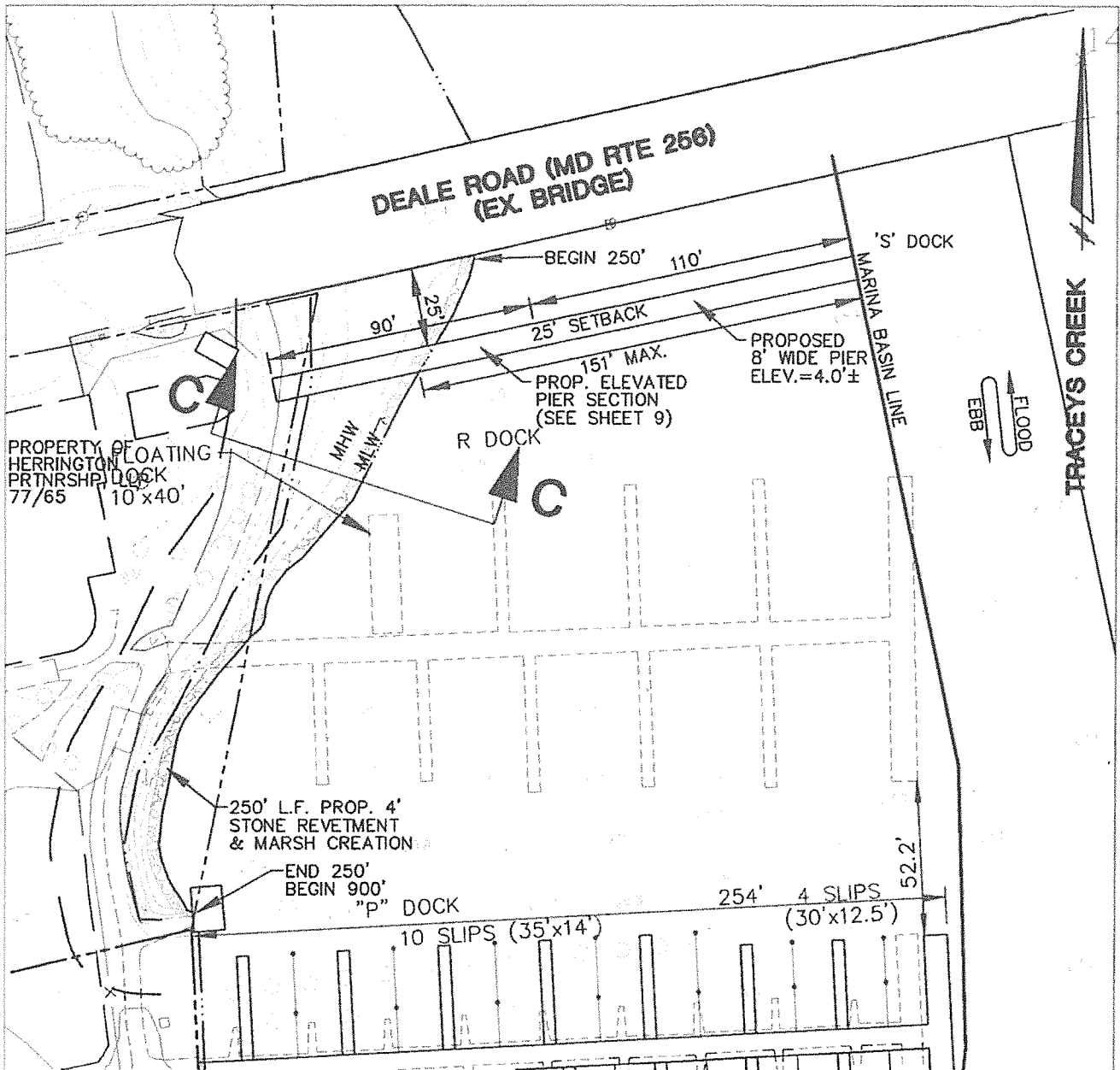

1 inch = 50 ft.

MARYLAND DEPARTMENT OF THE ENVIRONMENT &  
BALTIMORE DISTRICT CORPS. OF ENGINEERS  
LICENSE & PERMIT EXHIBIT

### HERRINGTON HARBOUR NORTH

TAX MAP 77; BLOCKS 11 & 12; PARCEL 89

8TH TAX DISTRICT  
SCALE: 1" = 50'

PAGE 8 OF 26

A.A. CO., MD  
AUGUST, 2019

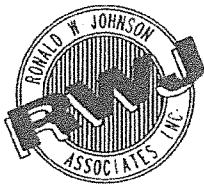

**Ronald W. Johnson Associates, Inc.**  
Consulting Engineers, Land Planners, Surveyors

2661 Riva Road Building 400, Suite 420 Annapolis, MD 21401  
410.841.5221 410.266.6612 Fax 410.841.5124



MDE #:8-WL-1087  
AI #:101768  
PLAN DATE: 9/9/19  
SHEET 8 OF 26



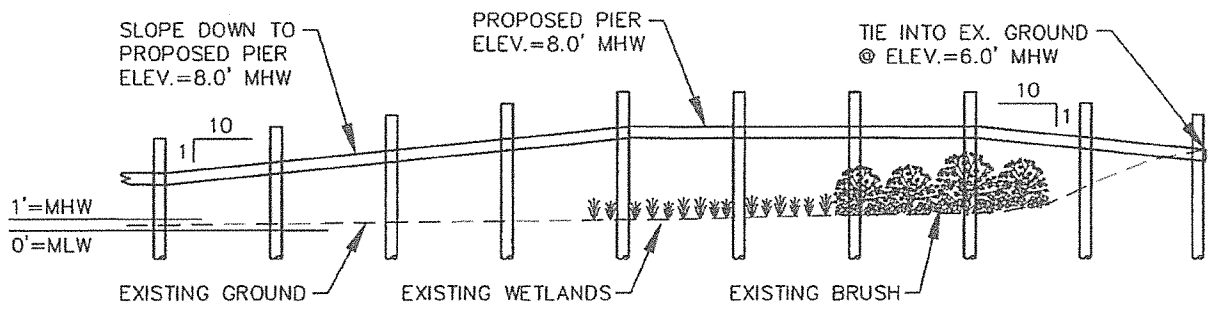

**PROPOSED ELEVATED PIER SECTION**

SCALE: 1" = 15'

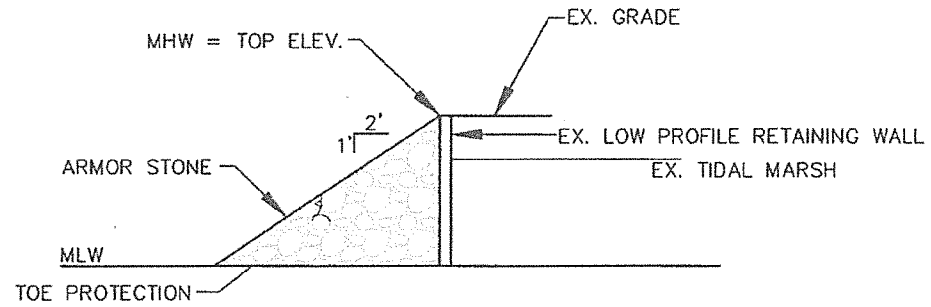

NOTE: ARMOR STONE TO FACE OF EX. LOW PROFILE RETAINING WALL FROM TOP OF LOW PROFILE RETAINING WALL TO SUBSTRATE.

**TYPICAL REVETMENT SECTION**

NTS

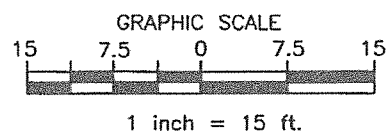

MARYLAND DEPARTMENT OF THE ENVIRONMENT &  
 BALTIMORE DISTRICT CORPS. OF ENGINEERS  
 LICENSE & PERMIT EXHIBIT  
**HERRINGTON HARBOUR NORTH**  
 TAX MAP 77; BLOCKS 11 & 12; PARCEL 89  
 8TH TAX DISTRICT  
 SCALE: 1" = 15'

A.A. CO., MD  
 AUGUST, 2019

PAGE 9 OF 26

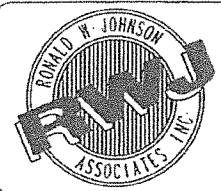

**Ronald W. Johnson Associates, Inc.**  
 Consulting Engineers, Land Planners, Surveyors

2661 Riva Road Building 400, Suite 420 Annapolis, MD 21401  
 410.841.5221 410.266.6612 Fax 410.841.5124



MDE #: 18-WL-1087  
 AI #: 101768  
 PLAN DATE: 9/9/19  
 SHEET 9 OF 26

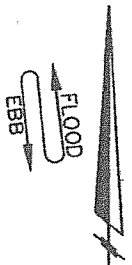
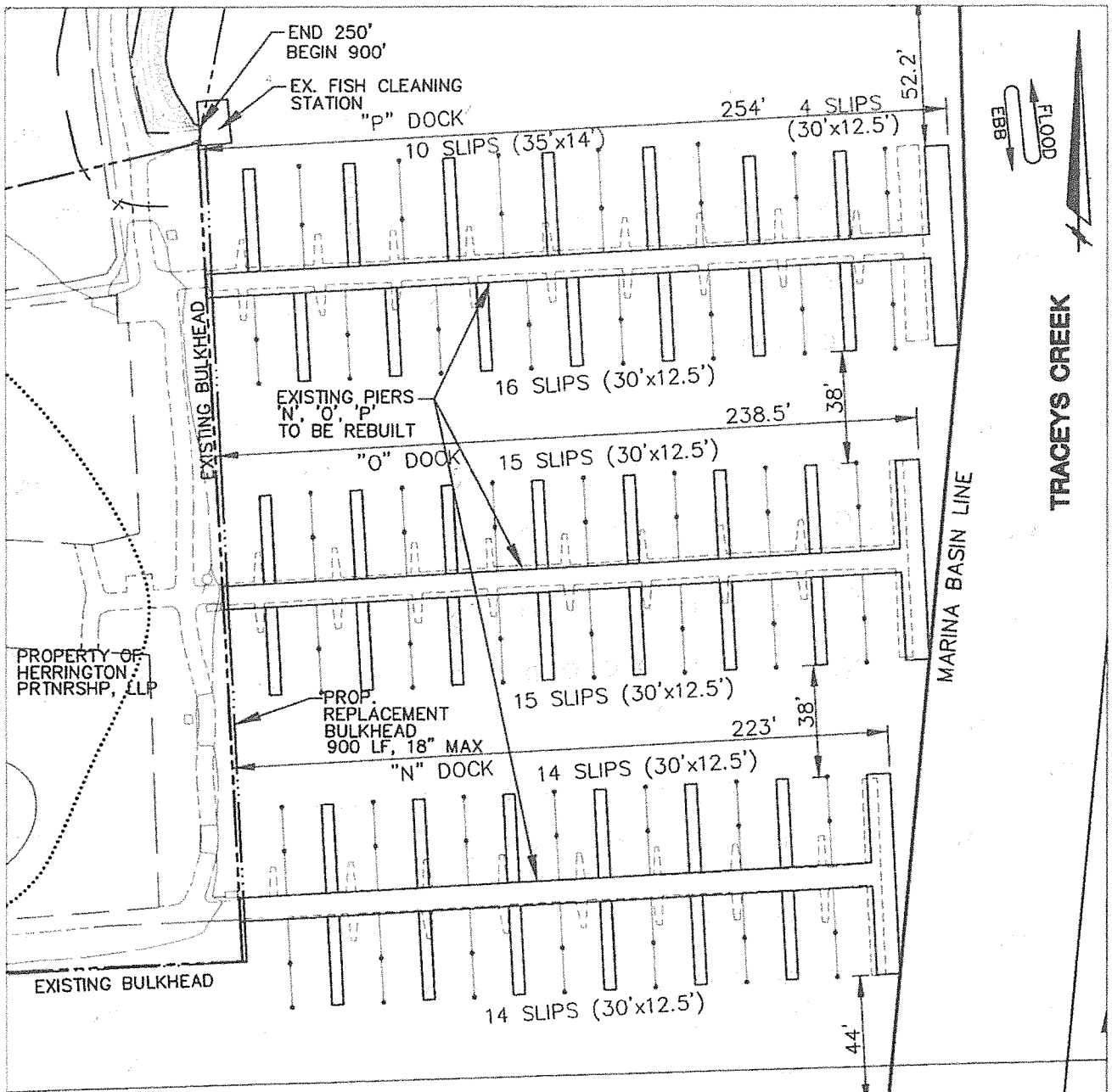

TRACEYS CREEK

MARINA BASIN LINE

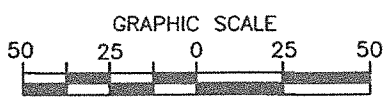

1 inch = 50 ft.

MARYLAND DEPARTMENT OF THE ENVIRONMENT & BALTIMORE DISTRICT CORPS. OF ENGINEERS  
 LICENSE & PERMIT EXHIBIT  
**HERRINGTON HARBOUR NORTH**  
 TAX MAP 77; BLOCKS 11 & 12; PARCEL 89  
 8TH TAX DISTRICT A.A. CO., MD  
 SCALE: 1" = 50' PAGE 10 OF 26 AUGUST, 2019

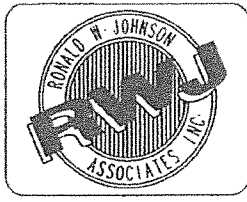

**Ronald W. Johnson Associates, Inc.**  
 Consulting Engineers, Land Planners, Surveyors

2661 Riva Road Building 400, Suite 420 Annapolis, MD 21401  
 410.841.5221 410.266.6612 Fax 410.841.5124



MDE #: 18-WL-1087  
 AI #: 101768  
 PLAN DATE: 9/9/19  
 SHEET 10 OF 26

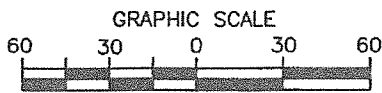
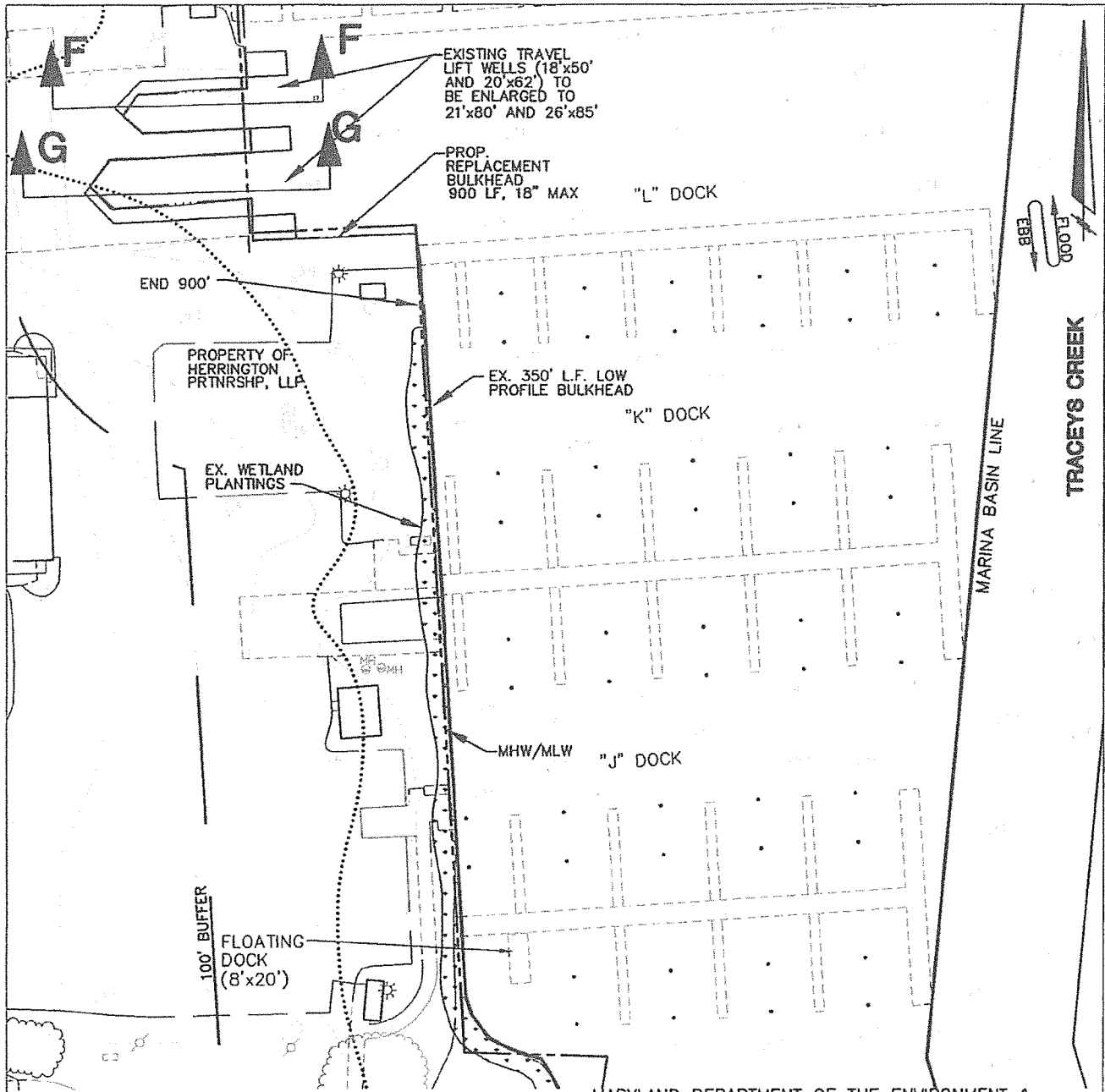

1 inch = 60 ft.

MARYLAND DEPARTMENT OF THE ENVIRONMENT & BALTIMORE DISTRICT CORPS. OF ENGINEERS LICENSE & PERMIT EXHIBIT

**HERRINGTON HARBOUR NORTH**

TAX MAP 77; BLOCKS 11 & 12; PARCEL 89

8TH TAX DISTRICT SCALE: 1" = 60'

PAGE 11 OF 26

A.A. CO., MD AUGUST, 2019

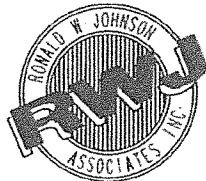

**Ronald W. Johnson Associates, Inc.**  
 Consulting Engineers . Land Planners . Surveyors

2661 Riva Road Building 400, Suite 420 Annapolis, MD 21401  
 410.841.5221 410.266.6612 Fax 410.841.5124



MDE #: AI #: 18WL-1087  
 PLAN DATE: 10/7/68  
 SHEET: 9/9/19  
 11 OF 26

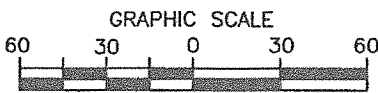
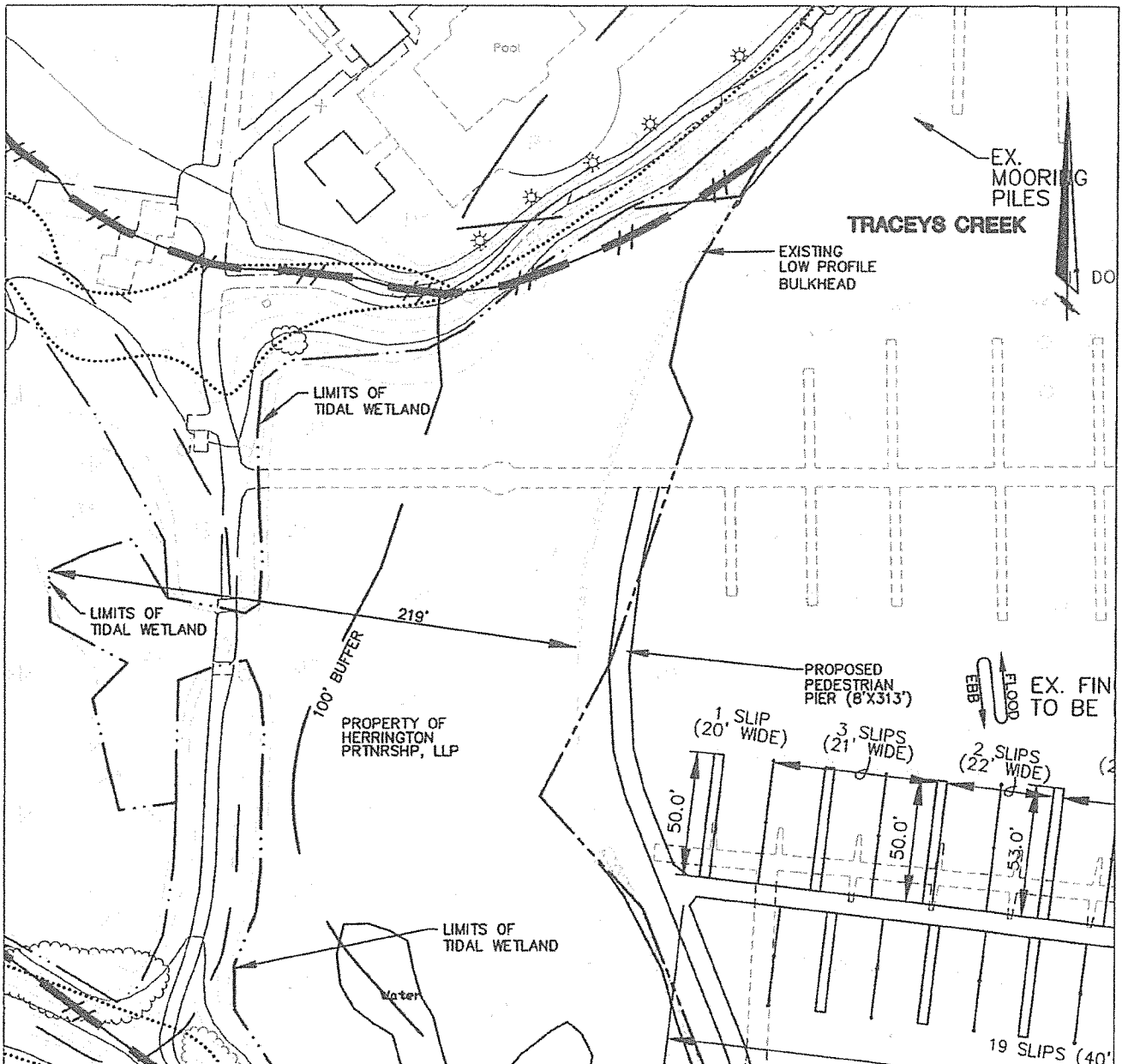

1 inch = 60 ft.

MARYLAND DEPARTMENT OF THE ENVIRONMENT &  
BALTIMORE DISTRICT CORPS. OF ENGINEERS  
LICENSE & PERMIT EXHIBIT

### HERRINGTON HARBOUR NORTH

TAX MAP 77; BLOCKS 11 & 12; PARCEL 89

8TH TAX DISTRICT

A.A. CO., MD

SCALE: 1" = 60'

PAGE 12 OF 26

AUGUST, 2019

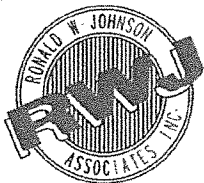

**Ronald W. Johnson Associates, Inc.**  
Consulting Engineers, Land Planners, Surveyors

2661 Riva Road Building 400, Suite 420 Annapolis, MD 21401  
410.841.5221 410.266.6612 Fax 410.841.5124



MDE # 18-WL-1087  
AI # 101768  
PLAN DATE 9/9/19  
SHEET 12 OF 26

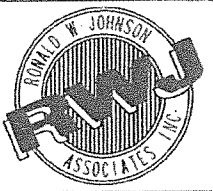
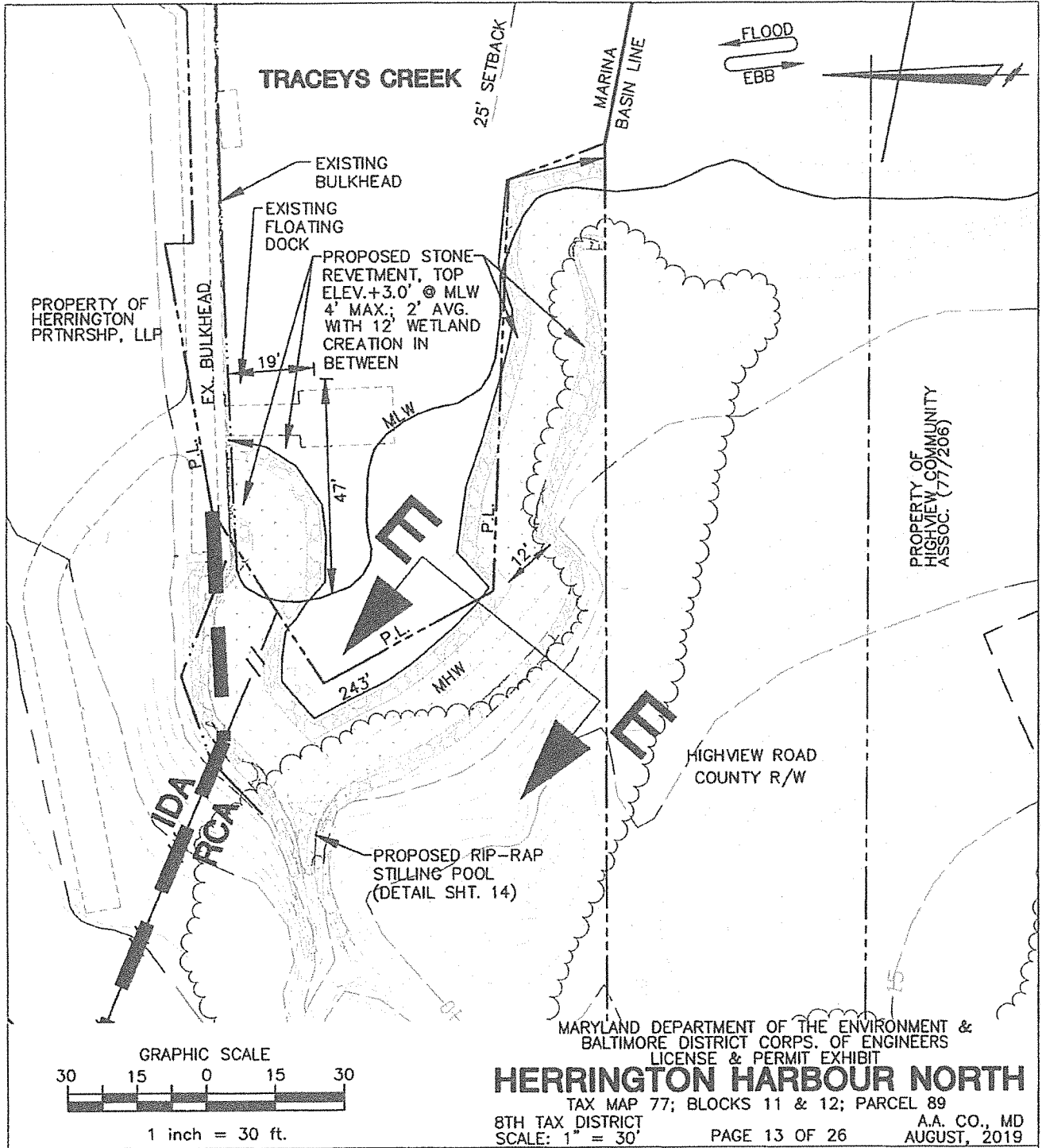

**Ronald W. Johnson Associates, Inc.**  
 Consulting Engineers, Land Planners, Surveyors

2661 Riva Road Building 400, Suite 420 Annapolis, MD 21401  
 410.841.5221 410.266.6612 Fax 410.841.5124



MDE #8-WL-1087  
 AI #101768  
 PLAN DATE 9/9/19  
 SHEET 13 OF 26

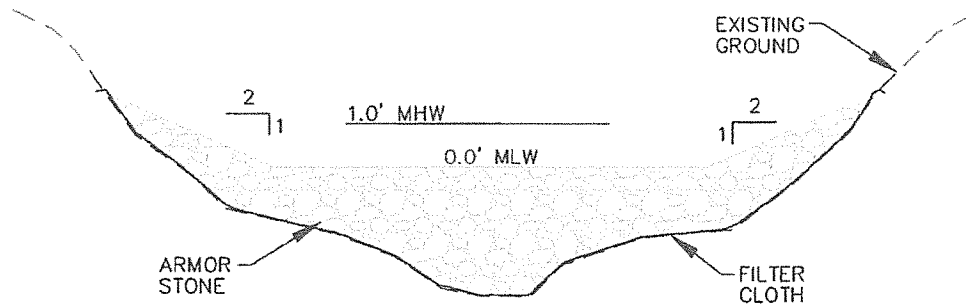

**TYPICAL STILLING POOL SECTION**

SCALE: 1" = 4'

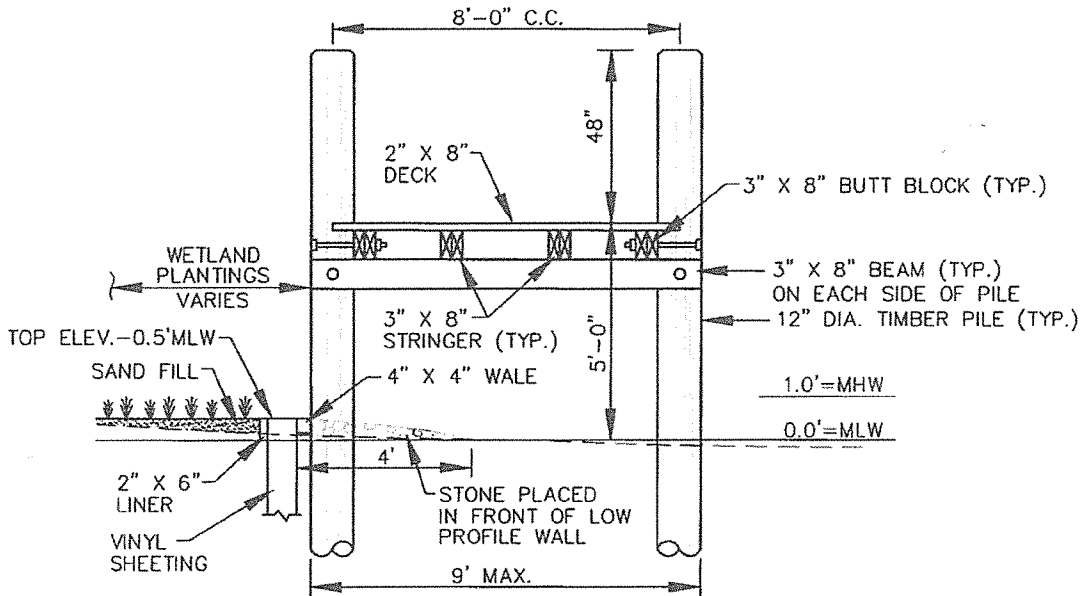

**LOW PROFILE RETAINING WALL/WALKWAY SECTION**

SCALE: 1" = 4'

MARYLAND DEPARTMENT OF THE ENVIRONMENT &  
BALTIMORE DISTRICT CORPS. OF ENGINEERS  
LICENSE & PERMIT EXHIBIT

**HERRINGTON HARBOUR NORTH**

TAX MAP 77; BLOCKS 11 & 12; PARCEL 89  
8TH TAX DISTRICT  
SCALE: 1" = 30'

A.A. CO., MD  
AUGUST, 2019

PAGE 14 OF 26

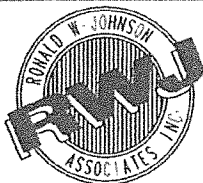

**Ronald W. Johnson Associates, Inc.**  
Consulting Engineers, Land Planners, Surveyors

2661 Riva Road Building 400, Suite 420 Annapolis, MD 21401  
410.841.5221 410.266.6612 Fax 410.841.5124



MDE #8-WL-1087  
AI #101768  
PLAN DATE 9/9/19  
SHEET 14 OF 26

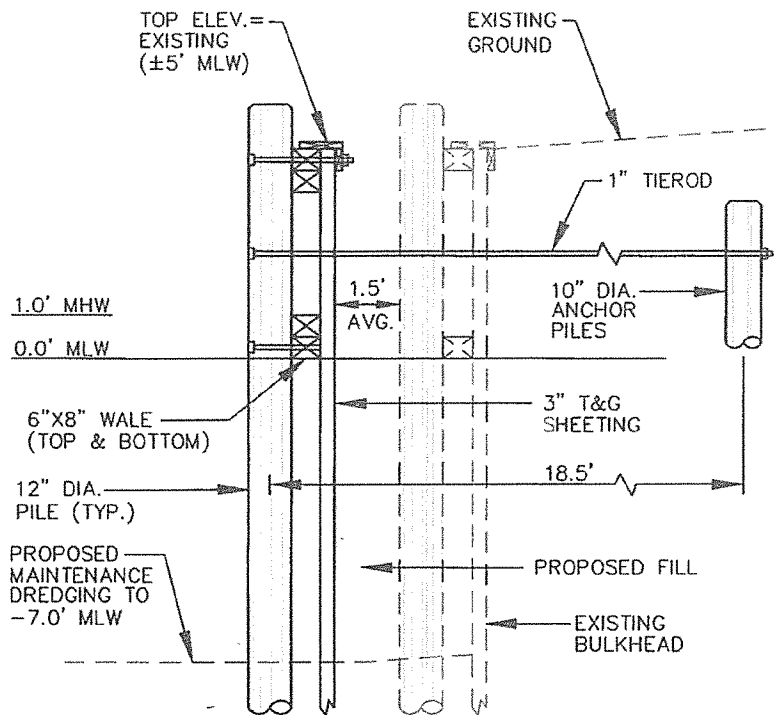

**TYPICAL BULKHEAD SECTION**

SCALE: 1" = 4'

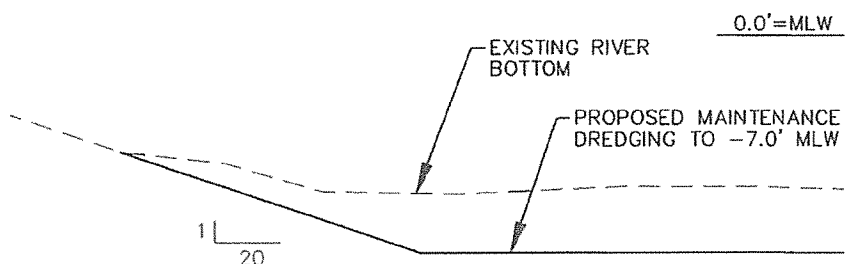

**TYPICAL DREDGE SECTION**

SCALE: 1" = 4'

MARYLAND DEPARTMENT OF THE ENVIRONMENT &  
 BALTIMORE DISTRICT CORPS. OF ENGINEERS  
 LICENSE & PERMIT EXHIBIT  
**HERRINGTON HARBOUR NORTH**  
 TAX MAP 77; BLOCKS 11 & 12; PARCEL 89  
 8TH TAX DISTRICT A.A. CO., MD  
 SCALE: 1" = 30' PAGE 15 OF 26 AUGUST, 2019

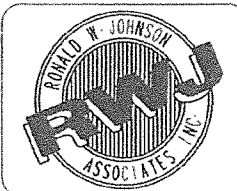

**Ronald W. Johnson Associates, Inc.**  
 Consulting Engineers, Land Planners, Surveyors

2661 Riva Road Building 400, Suite 420 Annapolis, MD 21401  
 410.841.5221 410.266.6612 Fax 410.841.5124



MDE #8-WL-1087  
 AI #101768  
 PLAN DATE 9/9/19  
 SHEET 15 OF 26

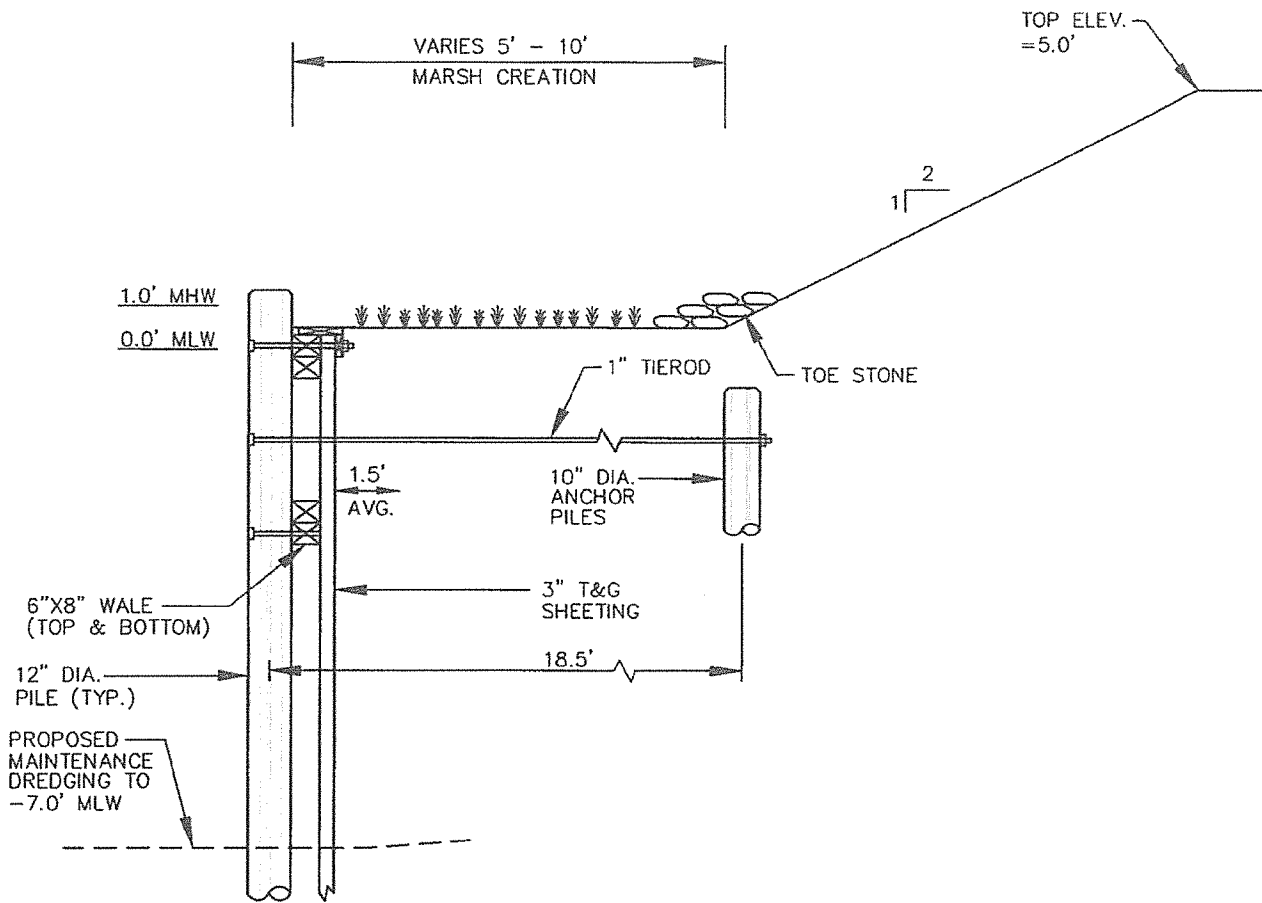

**LOW PROFILE BULKHEAD SECTION**

SCALE: 1" = 4'

MARYLAND DEPARTMENT OF THE ENVIRONMENT &  
BALTIMORE DISTRICT CORPS. OF ENGINEERS  
LICENSE & PERMIT EXHIBIT

**HERRINGTON HARBOUR NORTH**

TAX MAP 77; BLOCKS 11 & 12; PARCEL 89  
8TH TAX DISTRICT A.A. CO., MD  
SCALE: AS SHOWN PAGE 16 OF 26 AUGUST, 2019



**Ronald W. Johnson Associates, Inc.**  
Consulting Engineers, Land Planners, Surveyors

2661 Riva Road Building 400, Suite 420 Annapolis, MD 21401  
410.841.5221 410.266.6612 Fax 410.841.5124



MDE #18-WL-1087  
AI #101768  
PLAN DATE 9/9/19  
SHEET 16 OF 26



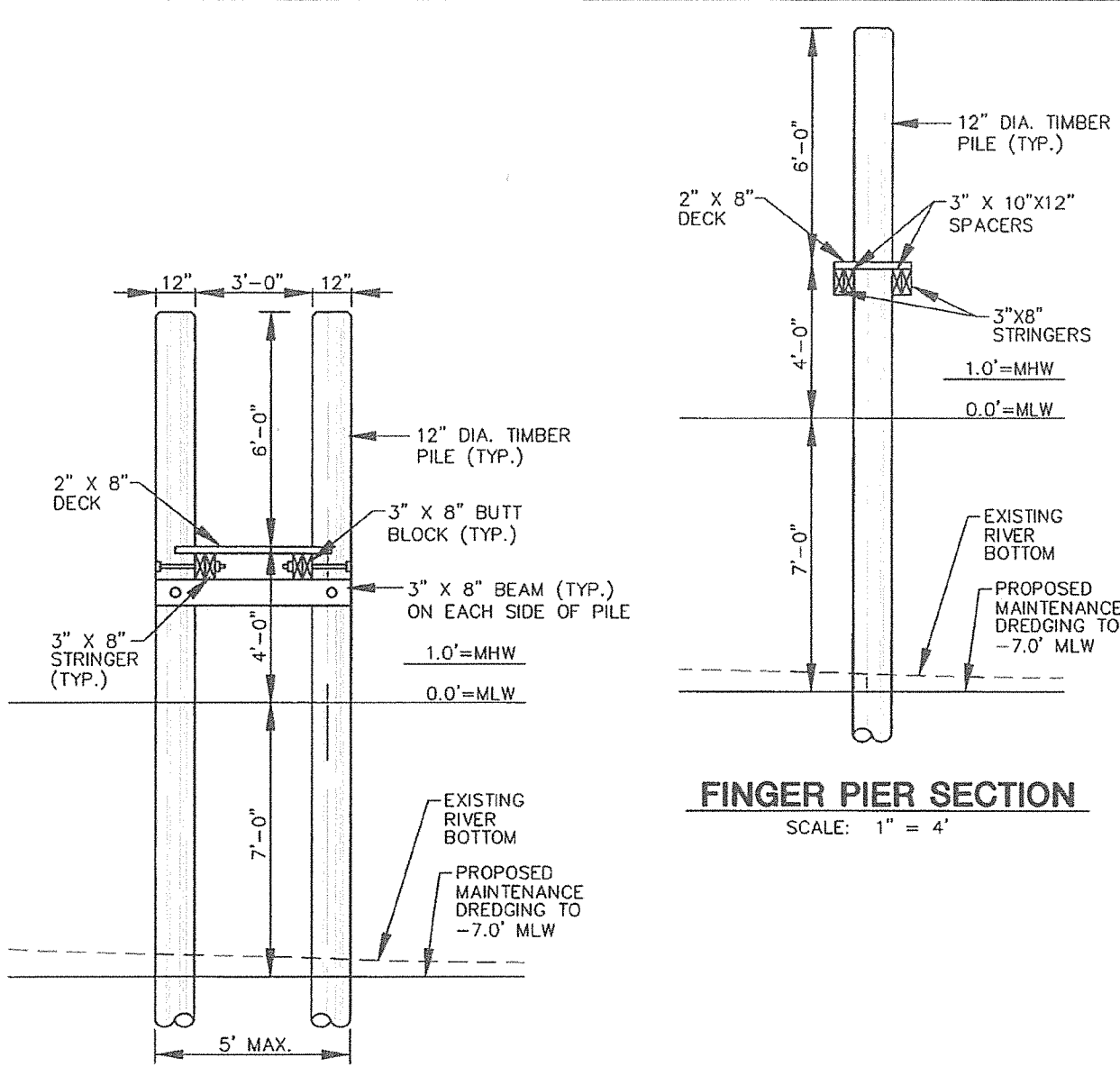

**FULL LENGTH FINGER PIER SECTION**

SCALE: 1" = 4'

**FINGER PIER SECTION**

SCALE: 1" = 4'

MARYLAND DEPARTMENT OF THE ENVIRONMENT &  
BALTIMORE DISTRICT CORPS. OF ENGINEERS  
LICENSE & PERMIT EXHIBIT

**HERRINGTON HARBOUR NORTH**

TAX MAP 77; BLOCKS 11 & 12; PARCEL 89  
8TH TAX DISTRICT A.A. CO., MD  
SCALE: AS SHOWN PAGE 17 OF 26 AUGUST, 2019

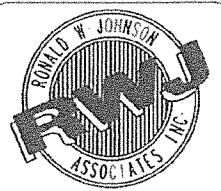

**Ronald W. Johnson Associates, Inc.**  
Consulting Engineers, Land Planners, Surveyors

2661 Riva Road Building 400, Suite 420 Annapolis, MD 21401  
410.841.5221 410.266.6612 Fax 410.841.5124



MDE #: 8-WL-1087  
AI #: 101768  
PLAN DATE 9/9/19  
SHEET 17 OF 26

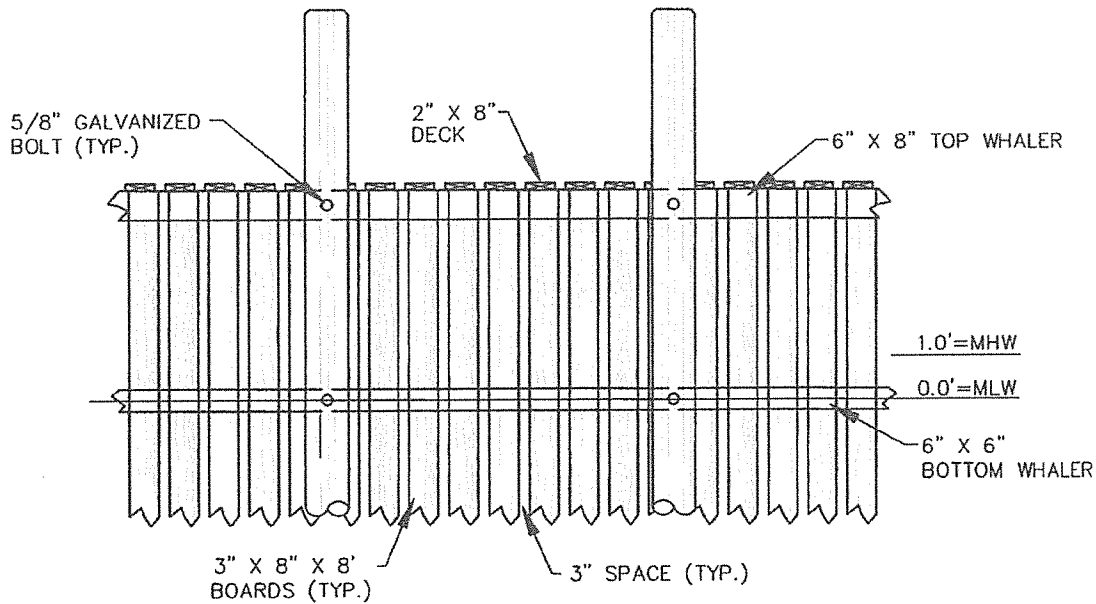

**PROFILE**

SCALE: 1" = 4'



MDE #18WL-1087  
 AI #101768  
 PLAN DATE 9/9/19  
 SHEET 18 OF 26

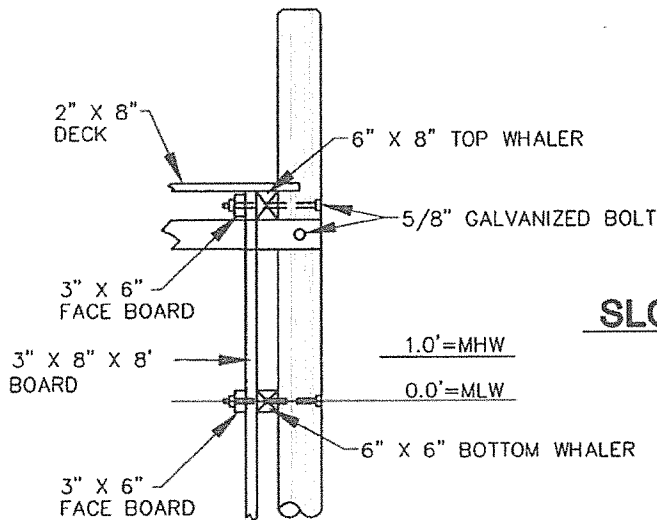

**SECTION**

SCALE: 1" = 4'

**SLOTTED TIMBER BREAKWATER  
 FOR F, G, H, & I DOCKS**

MARYLAND DEPARTMENT OF THE ENVIRONMENT &  
 BALTIMORE DISTRICT CORPS. OF ENGINEERS  
 LICENSE & PERMIT EXHIBIT

**HERRINGTON HARBOUR NORTH**

TAX MAP 77; BLOCKS 11 & 12; PARCEL 89

8TH TAX DISTRICT  
 SCALE: AS SHOWN

PAGE 18 OF 26

A.A. CO., MD  
 AUGUST, 2019

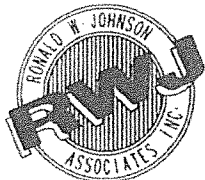

**Ronald W. Johnson Associates, Inc.**  
 Consulting Engineers, Land Planners, Surveyors

2661 Riva Road Building 400, Suite 420 Annapolis, MD 21401  
 410.841.5221 410.266.6612 Fax 410.841.5124

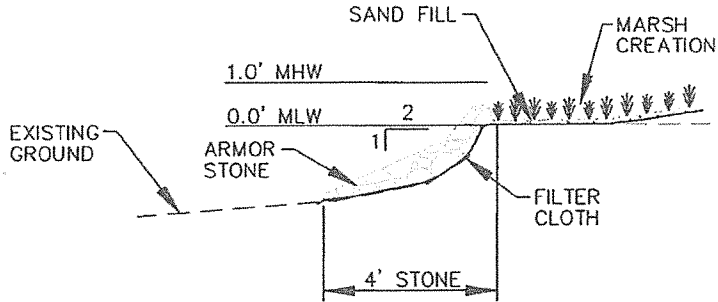

**250' & 500' TYPICAL REVETMENT AND MARSH CREATION SECTION**

SCALE: 1" = 4'



MDE #8-WL-1087  
 AI #101768  
 PLAN DATE 9/9/19  
 SHEET 19 OF 26

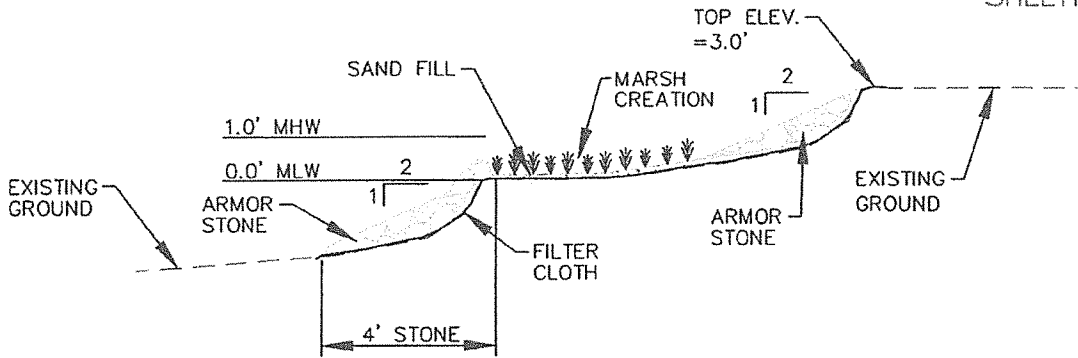

**TYPICAL REVETMENT AND MARSH CREATION SECTION**

SCALE: 1" = 4'

MARYLAND DEPARTMENT OF THE ENVIRONMENT &  
 BALTIMORE DISTRICT CORPS. OF ENGINEERS  
 LICENSE & PERMIT EXHIBIT

**HERRINGTON HARBOUR NORTH**

TAX MAP 77; BLOCKS 11 & 12; PARCEL 89

8TH TAX DISTRICT  
 SCALE: AS SHOWN

PAGE 19 OF 26

A.A. CO., MD  
 AUGUST, 2019

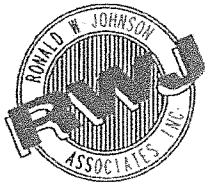

**Ronald W. Johnson Associates, Inc.**  
 Consulting Engineers . Land Planners . Surveyors

2661 Riva Road Building 400, Suite 420 Annapolis, MD 21401  
 410.841.5221 410.266.6612 Fax 410.841.5124

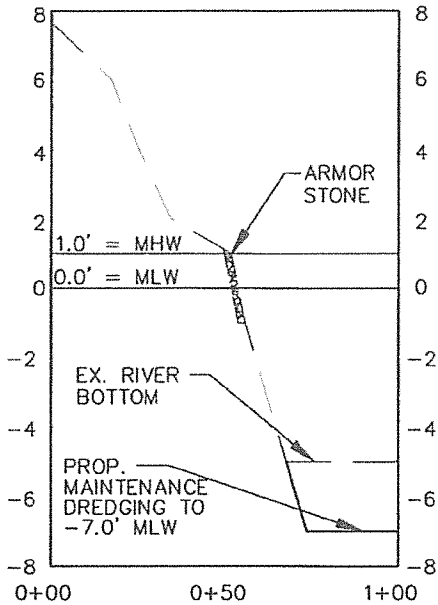

SECTION 'C-C'

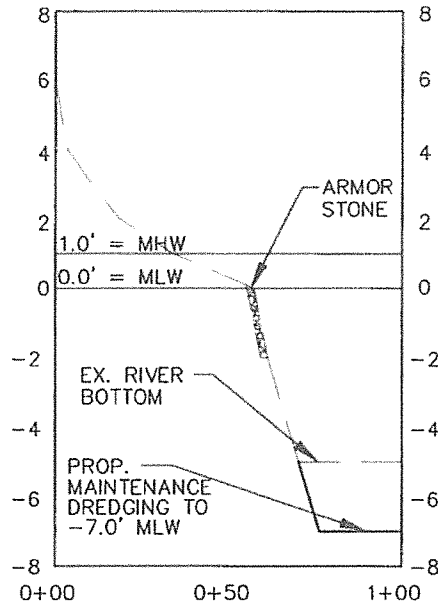

SECTION 'D-D'

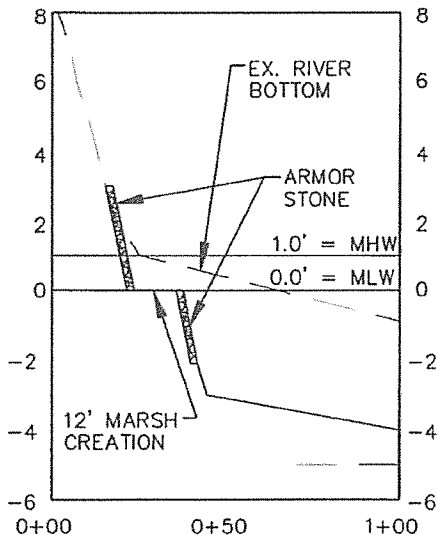

SECTION 'E-E'

**CROSS SECTIONS**

1" = 50'

MARYLAND DEPARTMENT OF THE ENVIRONMENT &  
BALTIMORE DISTRICT CORPS. OF ENGINEERS  
LICENSE & PERMIT EXHIBIT

**HERRINGTON HARBOUR NORTH**

TAX MAP 77; BLOCKS 11 & 12; PARCEL 89

8TH TAX DISTRICT  
SCALE: AS SHOWN

PAGE 20 OF 26

A.A. CO., MD  
AUGUST, 2019



**Ronald W. Johnson Associates, Inc.**  
Consulting Engineers . Land Planners . Surveyors

2661 Riva Road Building 400, Suite 420 Annapolis, MD 21401  
410.841.5221 410.266.6612 Fax 410.841.5124



MDE #8WL-1087  
AI #101768  
PLAN DATE 9/9/19  
SHEET 20 OF 26

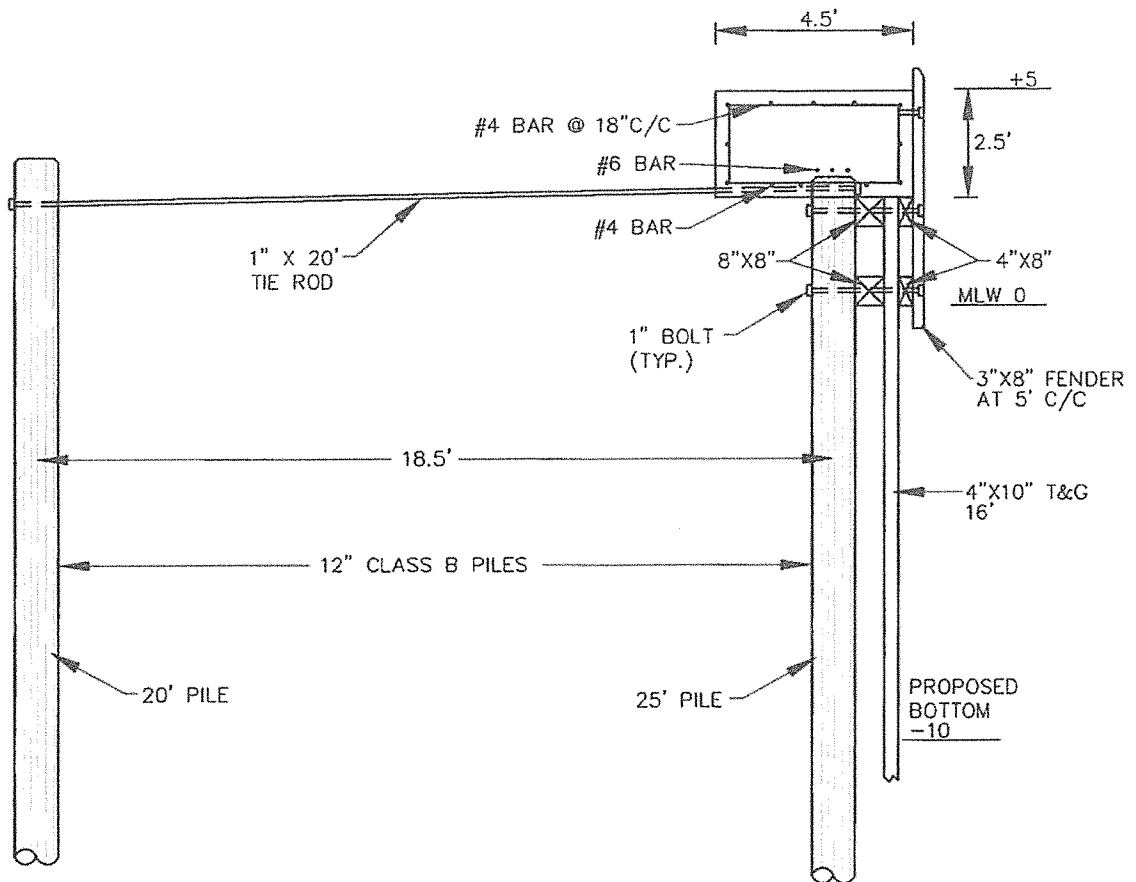

**TRAVEL WELL SECTION**

SCALE: 1" = 4'

MARYLAND DEPARTMENT OF THE ENVIRONMENT &  
BALTIMORE DISTRICT CORPS. OF ENGINEERS  
LICENSE & PERMIT EXHIBIT

**HERRINGTON HARBOUR NORTH**

TAX MAP 77; BLOCKS 11 & 12; PARCEL 89

8TH TAX DISTRICT  
SCALE: AS SHOWN

PAGE 21 OF 26

A.A. CO., MD  
AUGUST, 2019

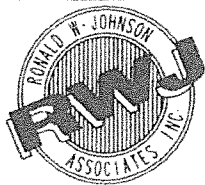

**Ronald W. Johnson Associates, Inc.**  
Consulting Engineers . Land Planners . Surveyors

2661 Riva Road Building 400, Suite 420 Annapolis, MD 21401  
410.841.5221 410.266.6612 Fax 410.841.5124



MDE #:8-WL-1087  
AI #101768  
PLAN DATE 9/9/19  
SHEET 21 OF 26

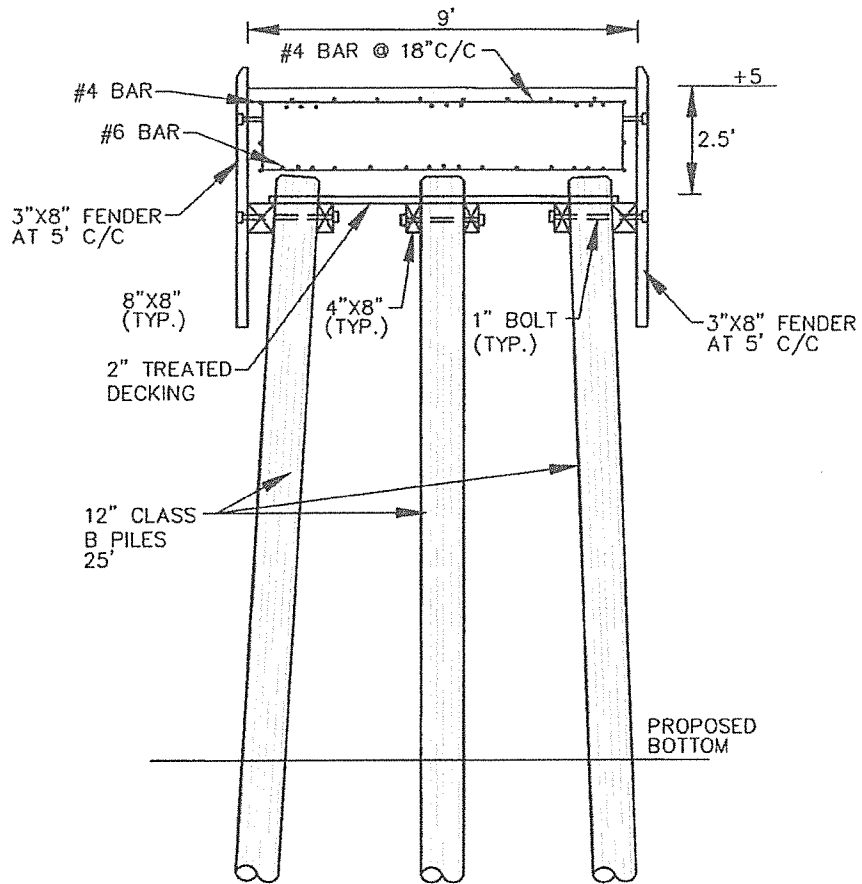

**TRAVEL WELL SECTION**

SCALE: 1" = 4'

MARYLAND DEPARTMENT OF THE ENVIRONMENT &  
BALTIMORE DISTRICT CORPS. OF ENGINEERS  
LICENSE & PERMIT EXHIBIT

**HERRINGTON HARBOUR NORTH**

TAX MAP 77; BLOCKS 11 & 12; PARCEL 89

8TH TAX DISTRICT  
SCALE: AS SHOWN

PAGE 22 OF 26

A.A. CO., MD  
AUGUST, 2019

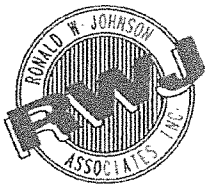

**Ronald W. Johnson Associates, Inc.**

Consulting Engineers, Land Planners, Surveyors

2661 Riva Road Building 400, Suite 420 Annapolis, MD 21401

410.841.5221 410.266.6612 Fax 410.841.5124



MDE #18-WL-1087  
AI #:101768  
PLAN DATE: 9/9/19  
SHEET 22 OF 26

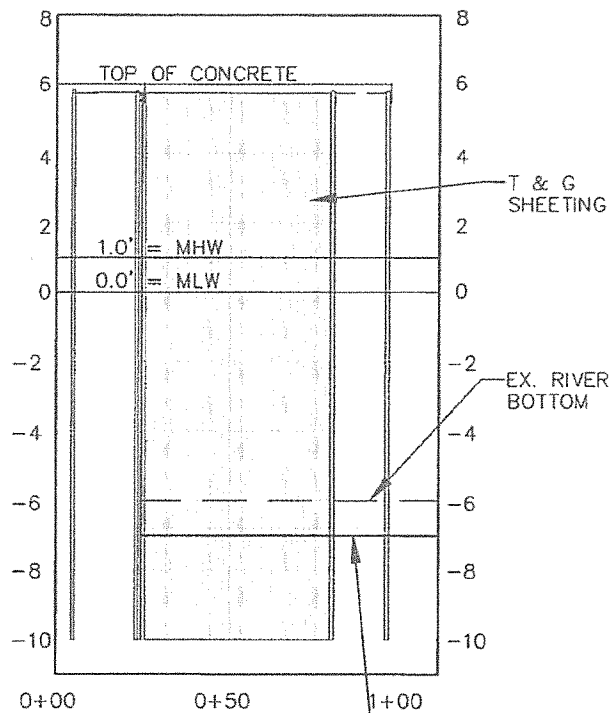

SECTION 'F-F'

PROP. MAINTENANCE DREDGING TO -7.0' MLW

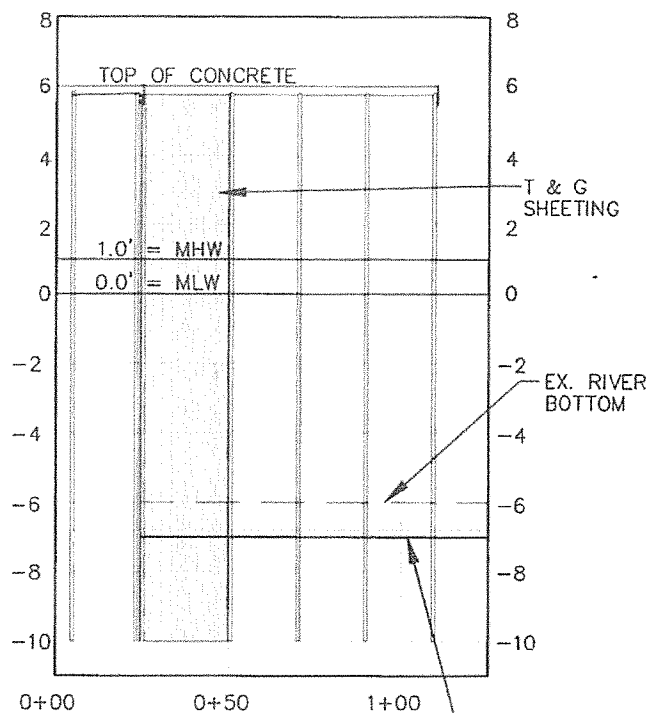

SECTION 'G-G'

PROP. MAINTENANCE DREDGING TO -7.0' MLW



MDE #18-WL-1087  
 AI #:101768  
 PLAN DATE 9/9/19  
 SHEET 23 OF 26

**CROSS SECTIONS**

1" = 50'

MARYLAND DEPARTMENT OF THE ENVIRONMENT &  
 BALTIMORE DISTRICT CORPS. OF ENGINEERS  
 LICENSE & PERMIT EXHIBIT

**HERRINGTON HARBOUR NORTH**

TAX MAP 77; BLOCKS 11 & 12; PARCEL 89  
 8TH TAX DISTRICT A.A. CO., MD  
 SCALE: AS SHOWN PAGE 23 OF 26 AUGUST, 2019

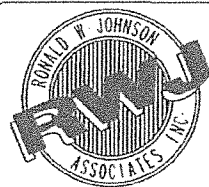

**Ronald W. Johnson Associates, Inc.**  
 Consulting Engineers, Land Planners, Surveyors

2661 Riva Road Building 400, Suite 420 Annapolis, MD 21401  
 410.841.5221 410.266.6612 Fax 410.841.5124

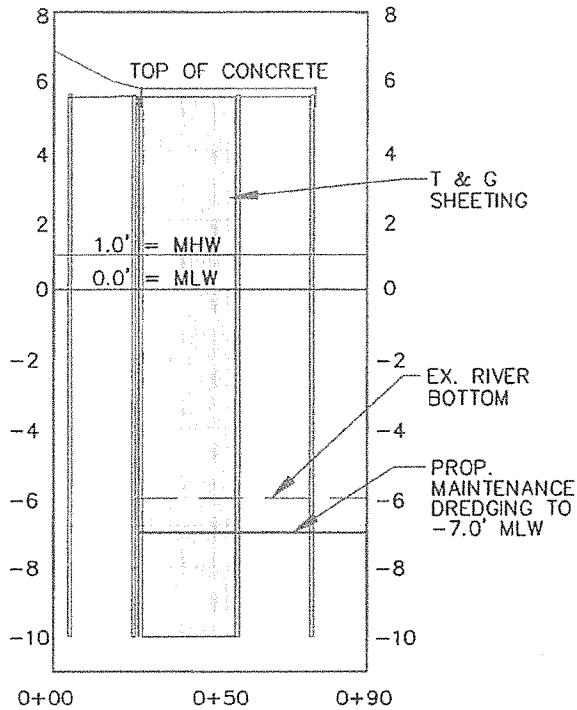

SECTION 'H-H'

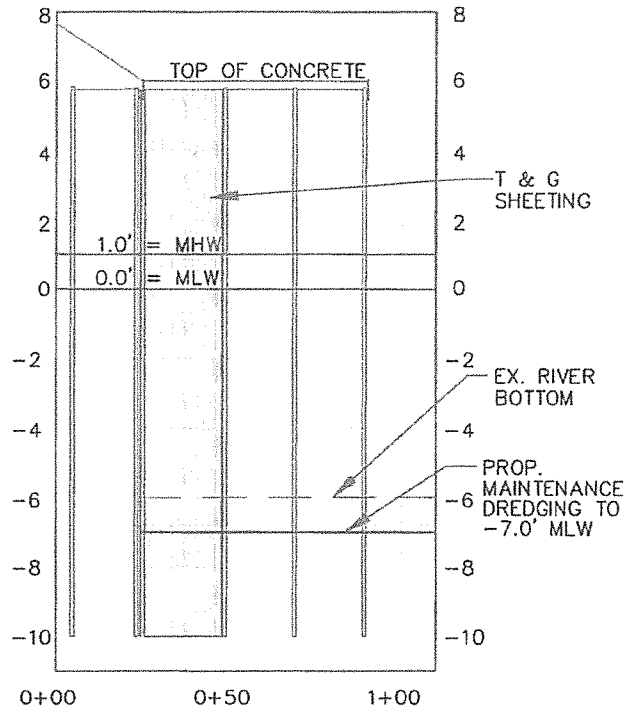

SECTION 'I-I'



MDE #18-WL-1087  
 AI #:101768  
 PLAN DATE 9/9/19  
 SHEET 24 OF 26

**CROSS SECTIONS**

1" = 50'

MARYLAND DEPARTMENT OF THE ENVIRONMENT &  
 BALTIMORE DISTRICT CORPS. OF ENGINEERS  
 LICENSE & PERMIT EXHIBIT  
**HERRINGTON HARBOUR NORTH**  
 TAX MAP 77; BLOCKS 11 & 12; PARCEL 89  
 8TH TAX DISTRICT A.A. CO., MD  
 SCALE: AS SHOWN PAGE 24 OF 26 AUGUST, 2019

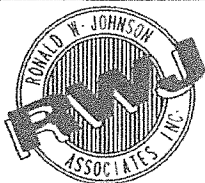

**Ronald W. Johnson Associates, Inc.**  
 Consulting Engineers, Land Planners, Surveyors

2661 Riva Road Building 400, Suite 420 Annapolis, MD 21401  
 410.841.5221 410.266.6612 Fax 410.841.5124



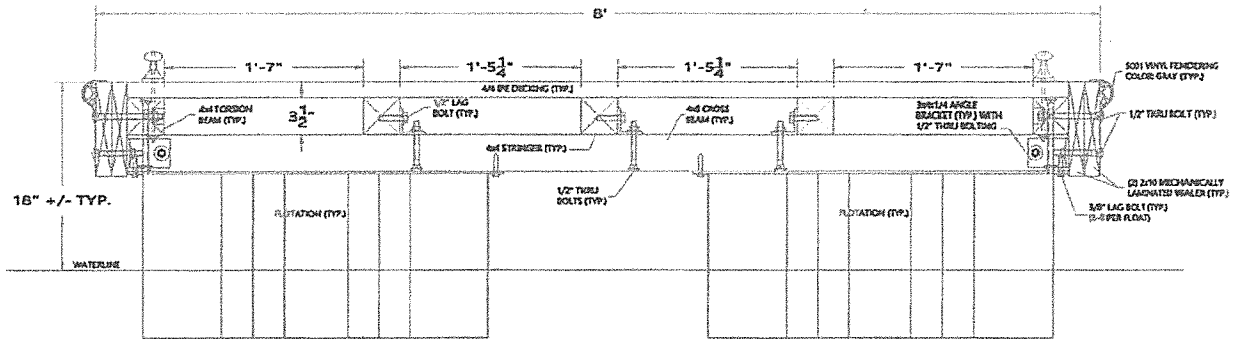

8' CROSS SECTION

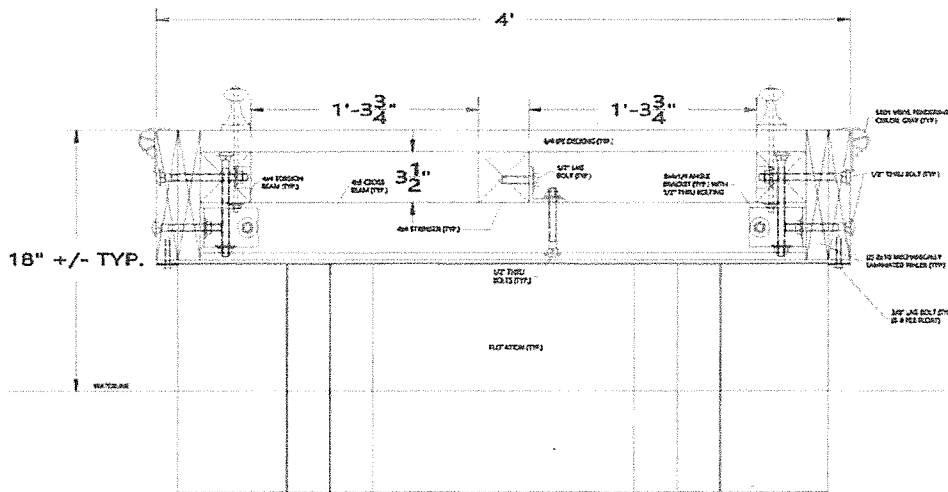

4' CROSS SECTION

**F-DOCK FLOATING PIER CROSS SECTIONS**

NOT TO SCALE

MARYLAND DEPARTMENT OF THE ENVIRONMENT &  
BALTIMORE DISTRICT CORPS. OF ENGINEERS  
LICENSE & PERMIT EXHIBIT

**HERRINGTON HARBOUR NORTH**

TAX MAP 77; BLOCKS 11 & 12; PARCEL 89

8TH TAX DISTRICT  
SCALE: AS SHOWN

PAGE 25 OF 26

A.A. CO., MD  
AUGUST, 2019

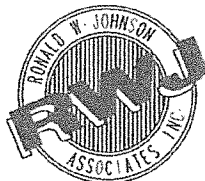

**Ronald W. Johnson Associates, Inc.**  
Consulting Engineers, Land Planners, Surveyors

2661 Riva Road Building 400, Suite 420 Annapolis, MD 21401  
410.841.5221 410.266.6612 Fax 410.841.5124



MDE #18-WL-1087  
AI #: 101768  
PLAN DATE: 9/9/19  
SHEET 25 OF 26

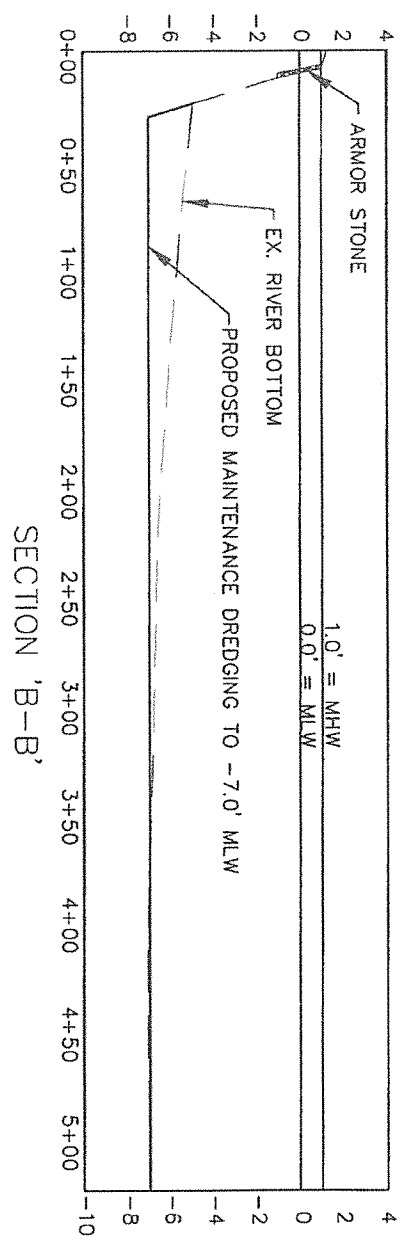
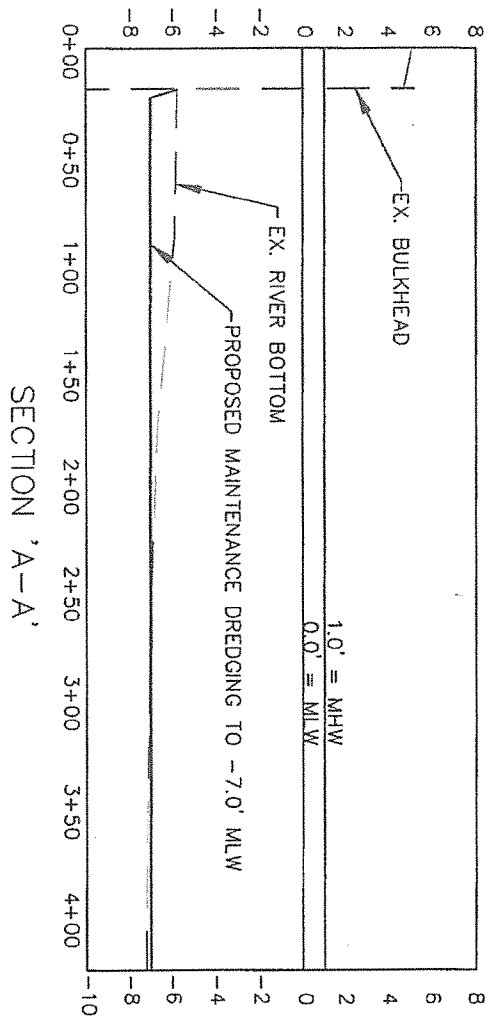

**DREDGING CROSS SECTIONS**

1" = 80'

MARYLAND DEPARTMENT OF THE ENVIRONMENT &  
 BALTIMORE DISTRICT CORPS. OF ENGINEERS  
 LICENSE & PERMIT EXHIBIT  
**HERRINGTON HARBOUR NORTH**  
 TAX MAP 77; BLOCKS 11 & 12; PARCEL 89  
 8TH TAX DISTRICT A.A. CO., MD  
 SCALE: AS SHOWN PAGE 26 OF 26 AUGUST, 2019



**Ronald W. Johnson Associates, Inc.**  
 Consulting Engineers, Land Planners, Surveyors

2661 Riva Road Building 400, Suite 420 Annapolis, MD 21401  
 410.841.5221 410.266.6612 Fax 410.841.5124



MDE #: 18-WL-1087  
 AI #: 101768  
 PLAN DATE: 9/9/19  
 SHEET 26 OF 26

Herrington Harbor 18-WL-1087, AI 101768

## **ATTACHMENT A**

### **ADJACENT PROPERTY OWNERS NOTIFIED IN PUBLIC NOTICE PROCESS**

Highview Community Association

421 Highview Road

Tracy's Landing, MD 20779

District Engineer

State Highway Administration

138 Defense Highway

Annapolis, MD 21401